

THE INFORMATION CONTAINED IN THIS DRAWING IS THE SOLE PROPERTY OF L-COM, INC. ANY REPRODUCTION IN PART OR WHOLE WITHOUT THE WRITTEN PERMISSION OF L-COM, INC. IS PROHIBITED.

REVISIONS			
REV	DESCRIPTION	DATE	APPROVED
E	ECN 3773: CN RELEASE, NEW FORMAT	12/30/08	D.FRISIELLO

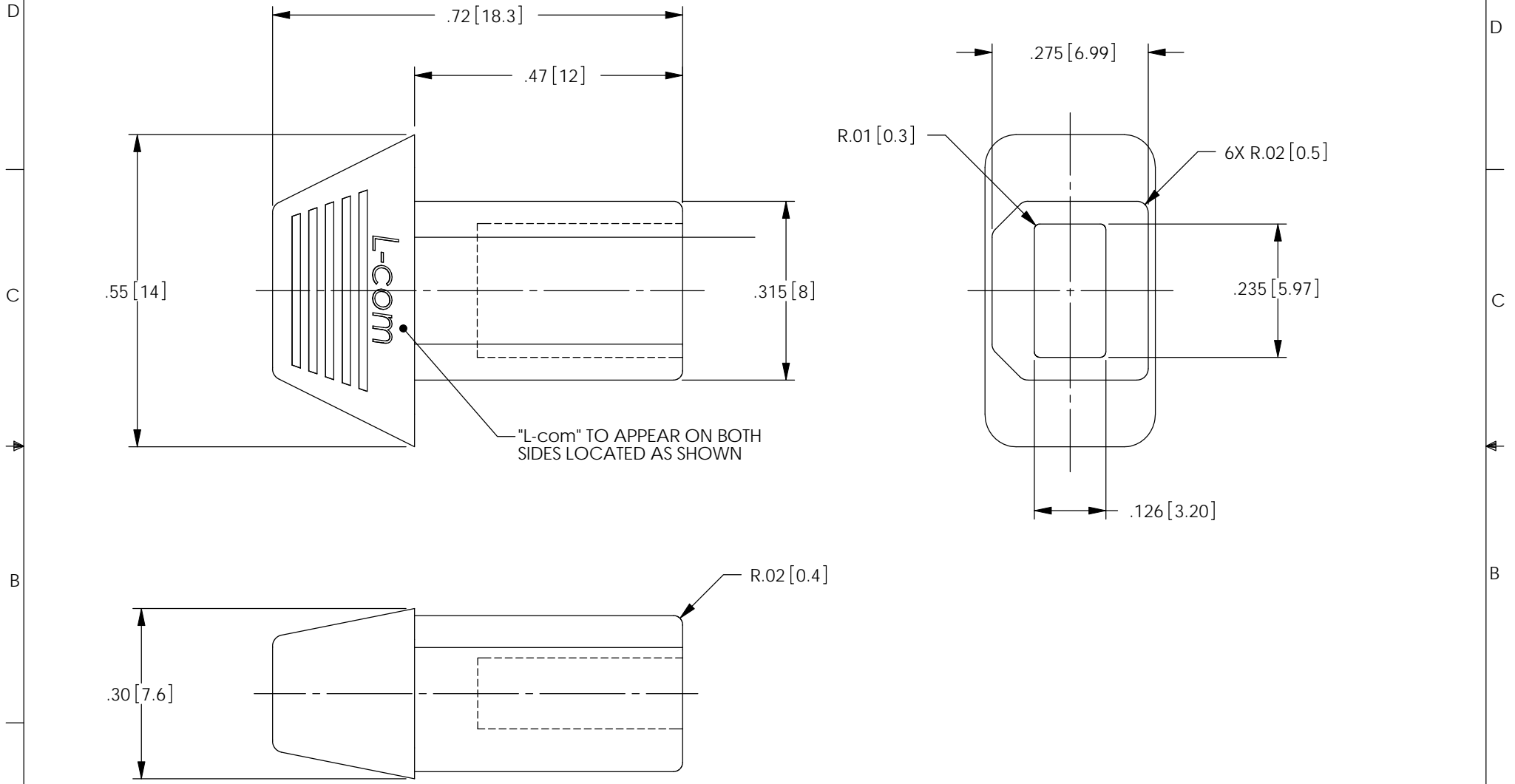

NOTES:

MATERIAL: ABS, COLOR BLACK.
 ROHS COMPLIANT
 PACKAGING: 10 PIECES PER BAG.
 ALL DIMENSIONS ARE FOR REFERENCE ONLY.

UNLESS OTHERWISE SPECIFIED, DIMENSIONS ARE IN INCHES [mm] DIMENSIONAL TOLERANCES: .X = ±.1 .XX = ±.01 .XXX = ±.005 ANGULAR TOLERANCES: ALL = ± 1°	APPROVALS	DATE		45 BEECHWOOD DRIVE NORTH ANDOVER, MA 01845	
	DRAWN BY C.MCCORMICK	11/24/2003			
	CHECKED BY D.APRHAM	11/24/2003	CATEGORY	USB	
	APPROVED BY R.CARRICK	11/24/2003	PRODUCT DESCRIPTION	DUST CAP; USB TYPE "B" JACK	
PROJECTION 	COLOR VARIATIONS MAY OCCUR	SIZE A	FSCM NO. 43321	DWG. NO. CAPUSB-B	REV. E
REF	SCALE: NONE	CAD FILE: CAPUSB-B.SLDDRW	SHEET 1 OF 1		