

THE INFORMATION CONTAINED IN THIS DRAWING IS THE SOLE PROPERTY OF L-COM, INC. ANY REPRODUCTION IN PART OR WHOLE WITHOUT THE WRITTEN PERMISSION OF L-COM, INC. IS PROHIBITED.

REVISIONS			
REV	DESCRIPTION	DATE	APPROVED
A	INITIAL RELEASE	7/30/07	D.FRISIELLO
B	ECN 5567: NEW FORMAT, ADDED ROHS STAMP & PACKAGING NOTE	6/27/11	D.FRISIELLO

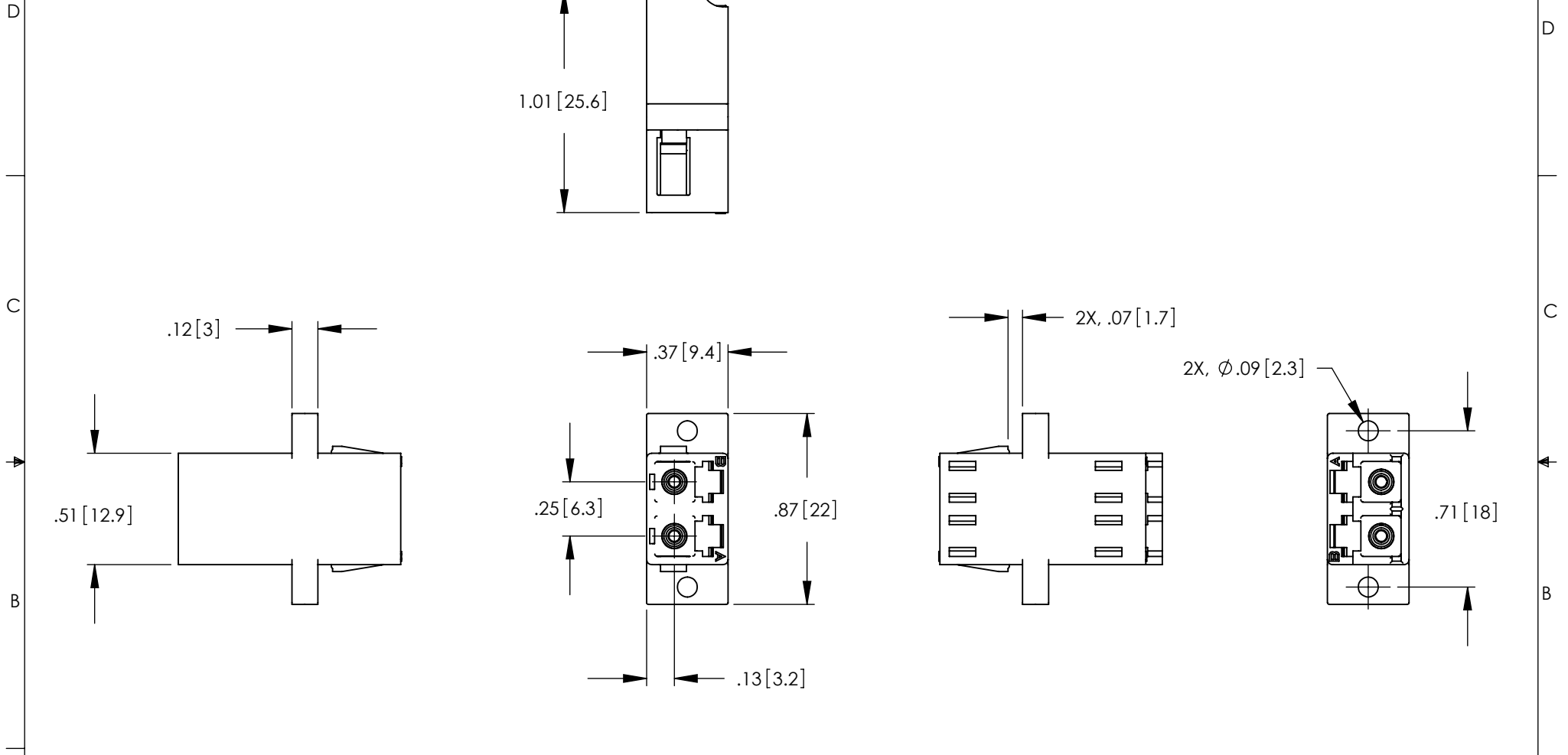

NOTES:

MATERIALS:
 HOUSING MATERIAL: PVC, UL94V-0.
 HOUSING COLOR: BLACK.
 SLEEVE: CERAMIC.

MISCELLANEOUS:
 SHIPPED WITH DUST CAPS INSTALLED (NOT SHOWN).

COMPONENT SHALL BE INDIVIDUALLY PACKAGED IN ACCORDANCE WITH L-COM SPECIFICATION PS-0031.

RoHS Compliant ✓

UNLESS OTHERWISE SPECIFIED, DIMENSIONS ARE IN INCHES [mm] OVERALL CABLE LENGTH TOLERANCE: ≤12 [305] = +1 [25] / -0 >12 [305] ≤60 [1524] = +2 [51] / -0 >60 [1524] ≤120 [3048] = +4 [102] / -0 >120 [3048] ≤300 [7620] = +6 [152] / -0 >300 [7620] = +3% / -0% ALL OTHER DIMENSIONAL TOLERANCES: .X = ±.2 .XX = ±.02 .XXX = ±.005	APPROVALS DRAWN BY D.FRISIELLO CHECKED BY P.McNEIL APPROVED BY P.McNEIL	DATE 7/30/07 7/30/07 7/30/07	45 BEECHWOOD DRIVE NORTH ANDOVER, MA 01845
	CONFIGURATION DETAILS OF UNDIMENSIONED FEATURES MAY VARY		
PROJECTION 	COLOR VARIATIONS MAY OCCUR	SIZE A	FSCM NO. 43321 DWG. NO. FOA-801 SCALE: NONE CAD FILE: FOA-801.SLDDRW
		PRODUCT DESCRIPTION LC COUPLER, DUPLEX SINGLE MODE	SHEET 1 OF 1