

13 12 11 10 9 8 7 6 5 4 3 2 1

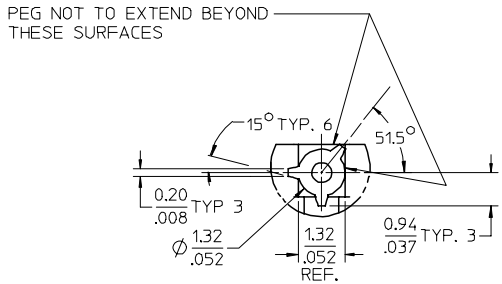

DETAIL "Z"
SCALE 10:1
PEG TYP.

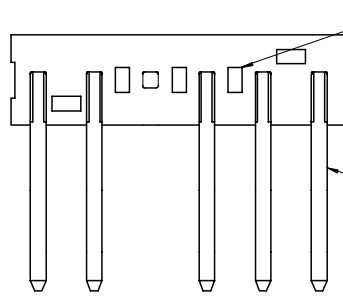

SEE NOTE 7
CKT NO. 1

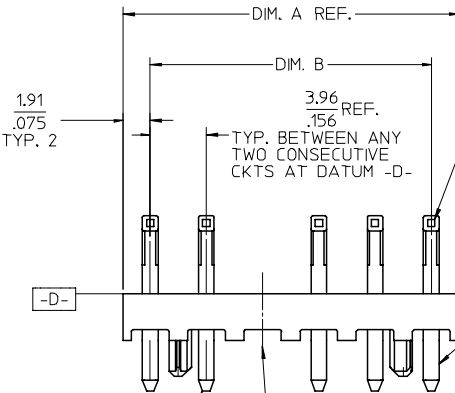
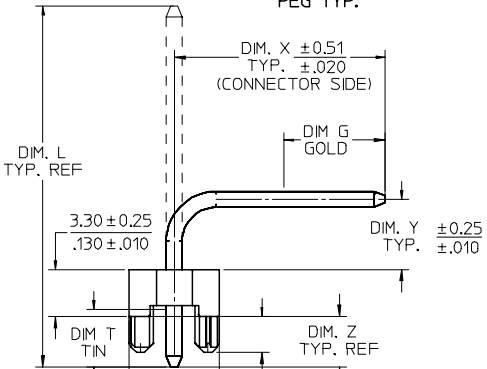

CENTERLINE OF PIN AT TIP NOT TO VARY FROM CENTERLINE OF PIN AT DATUM -D- BY MORE THAN 0.20/.008 IN EITHER DIRECTION

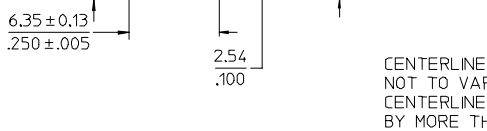

CENTERLINE OF PIN AT TIP NOT TO VARY FROM CENTERLINE OF PIN AT DATUM -D- BY MORE THAN 0.13/.005 IN EITHER DIRECTION
VOIDED CKT. SEE CHART FOR LOCATION

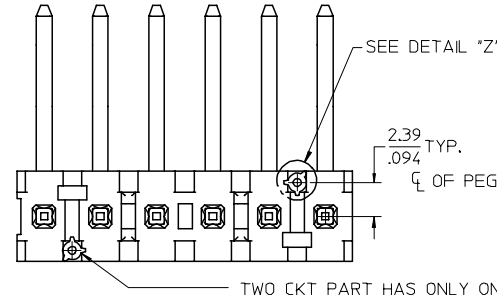
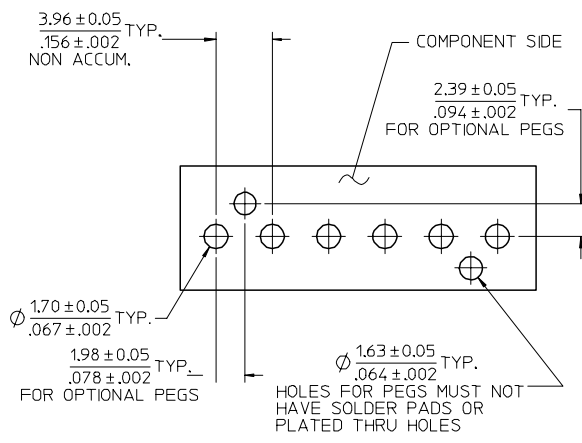

- NOTES:
- MATERIAL: GLASS FILLED POLYESTER, 94V-0, MOLDED NATURAL (WHITE).
 - FINISH: (102) OVERALL TIN: (0.00508)/.000200 MIN. OVER COPPER UNDERPLATE: (0.00254)/.000100 MIN. (208) SELECT GOLD: (0.00038)/.000015 MIN. *SELECT TIN: (0.00254)/.000100 MIN. OVERALL NICKEL UNDERPLATE: (0.00127)/.000050 MIN. (228) SELECT GOLD: (0.00076)/.000030 MIN. *SELECT TIN: (0.00254)/.000100 MIN. OVERALL NICKEL UNDERPLATE: (0.00127)/.000050 MIN. (501) OVERALL GOLD: (0.00051)/.000020 MIN. OVER NICKEL UNDERPLATE: (0.00076)/.000030 MIN.
 - THE PRIMARY SHIPPING CARTON WILL BE LABELED "COMPLIANT TO RoHS DIRECTIVE 2002/95/EC AND ELV ANNEX II OF DIRECTIVE 2000/53/EC". CARTONS WITHOUT THIS LABEL MAY CONTAIN PRODUCT WITH TIN/LEAD PLATINGS.
 - PRODUCT SPECIFICATION: PS-08-50
 - PACKAGING SPECIFICATION: SEE CHARTS
 - PARTS ARE STACKABLE END TO END ON (3.96)/.156 CENTERS.
 - FOR PARTS WITHOUT PEGS, SEE DRAWING SDA-41772.
 - EXPANSION SLOTS TO BE THRU-SLOTS, AS SHOWN, FOR 4 THRU 18 CKT. PARTS.
 - SOLDERABILITY: WHEN PARTS ARE SOLDERED AT A TEMPERATURE OF (230 C) OR 446 F FOR 5 SECONDS, EACH SOLDERED SURFACE SHALL BE A MINIMUM OF 95% COVERED WITH A SMOOTH CONTINUOUS ADHERENT COATING. FOR OTHER INFORMATION SEE SMES-152.
 - PIN PUSH OUT FORCE: PRIOR TO SOLDERING, A 3 POUND MINIMUM FORCE (IN EITHER DIRECTION) SHALL BE REQUIRED TO PUSH THE PIN OUT OF THE HEADER.
 - 6 CIRCUIT PART SHOWN.
 - THIS PART CONFORMS TO CLASS B REQUIREMENTS OF COSMETIC SPECIFICATION PS-45499-002.

NO. OF CKTS.	DIM. A	DIM. B	NO. OF PEGS
2	7.77 .306	3.96±0.05 .156±.002	1
3	11.73 .462	7.92±0.08 .312±.003	2
4	15.70 .618	11.89±0.08 .468±.003	2
5	19.66 .774	15.85±0.10 .624±.004	2
6	23.62 .930	19.81±0.10 .780±.004	2
7	27.58 1.086	23.77±0.10 .936±.004	2
8	31.55 1.242	27.74±0.13 1.092±.005	2
9	35.51 1.398	31.70±0.13 1.248±.005	2
10	39.47 1.554	35.66±0.13 1.404±.005	2
11	43.43 1.710	39.62±0.15 1.560±.006	2
12	47.40 1.866	43.59±0.15 1.716±.006	2
13	51.36 2.022	47.55±0.15 1.872±.006	2
14	55.32 2.178	51.51±0.18 2.028±.007	2
15	59.28 2.334	55.47±0.18 2.184±.007	2
16	63.25 2.490	59.44±0.18 2.340±.007	2
17	67.21 2.646	63.40±0.20 2.496±.008	2
18	71.17 2.802	67.36±0.20 2.652±.008	2

RECOMMENDED PC BOARD HOLE LAYOUT
FOR CORRECT ORIENTATION OF PARTS WITH VOIDS, ELIMINATE CORRESPONDING PCB HOLE.

QUALITY SYMBOLS	DESCRIPTION
□=0	
▽=0	

UPDATE NOTES	DATE
FC NO: UCP2007-2132	2007/03/21
DRAWN:RIDER	2007/03/21
CHKD:ADERR	2007/03/27
APPR:FSM TH	2007/03/28

2-*	1
1	11
SHT.	REV.

GENERAL TOLERANCES (UNLESS SPECIFIED)	DIMENSION STYLE	SCALE	DESIGN UNITS	THIRD ANGLE PROJECTION
mm INCH	MM/IN	4:1	INCH	THIRD ANGLE PROJECTION
4 PLACES ± --- ± ---	DRAWN BY SAMIEC	DATE 1988/08/19	TITLE	FLAT HEADER ASSY (3.96)/.156 CENTERS, BENT SQ PINS, W/ PEGS
3 PLACES ± --- ± ---	CHECKED BY	DATE		
2 PLACES ± --- ± ---	PATEL	1988/08/19		
1 PLACE ± --- ± ---	APPROVED BY	DATE		
ANGULAR ±1/2°	LENZ	1988/08/19		
DRAFT WHERE APPLICABLE MUST REMAIN WITHIN DIMENSIONS	MATERIAL NO.	DOCUMENT NO.	MOLEX INCORPORATED	
	SEE CHART	SD-42472-001	SHEET NO. 1 OF *	
	THIS DRAWING CONTAINS INFORMATION THAT IS PROPRIETARY TO MOLEX INCORPORATED AND SHOULD NOT BE USED WITHOUT WRITTEN PERMISSION			

12 11 10 9 8 7 6 5 4 3 2 1

ENG. NO: A-42472-0155/0171			ENG. NO: A-42472-0189/0200			ENG. NO: A-42472-0201/0217			ENG. NO: A-42472-0218/0234		
HEADER NUMBER	41770-0019/0035		HEADER NUMBER	41770-0019/0035		HEADER NUMBER	41770-0019/0035		HEADER NUMBER	41770-0019/0035	
PIN NUMBER	2161-16(102)		PIN NUMBER	2161-16(102)		PIN NUMBER	2161-23(102)		PIN NUMBER	2161-62 (102)	
PLATING	102		PLATING	102		PLATING	102		PLATING	102	
DIM. L	(25.40)/1.000		DIM. L	(25.40)/1.000		DIM. L	(31.24)/1.230		DIM. L	(24.89)/.980	
DIM. X	(14.86)/.585		DIM. X	(14.86)/.585		DIM. X	(20.70)/.815		DIM. X	(14.86)/.585	
DIM. G (GOLD)	N/A		DIM. G (GOLD)	N/A		DIM. G (GOLD)	N/A		DIM. G (GOLD)	N/A	
DIM. Y	(4.95)/.195		DIM. Y	(4.95)/.195		DIM. Y	(4.95)/.195		DIM. Y	(4.45)/.175	
DIM. Z	(3.56)/.140		DIM. Z	(3.56)/.140		DIM. Z	(3.56)/.140		DIM. Z	(3.56)/.140	
DIM. T (TIN)	OVERALL		DIM. T (TIN)	OVERALL		DIM. T (TIN)	OVERALL		DIM. T (TIN)	OVERALL	
ANGLE W	90°		ANGLE W	90°		ANGLE W	90°		ANGLE W	90°	
VOID CKTS	2		VOID CKTS	7		VOID CKTS			VOID CKTS		
PACKAGING	PK-42472-002 (BULK)		PACKAGING	PK-42472-002 (BULK)		PACKAGING	PK-42472-002 (BULK)		PACKAGING	PK-42472-002 (BULK)	
CKTS	EDP NO.	ENG. NO.	CKTS	EDP NO.	ENG. NO.	CKTS	EDP NO.	ENG. NO.	CKTS	EDP NO.	ENG. NO.
02			02			02		A-42472-0201	02	26-62-3028	A-42472-0218
03	26-62-3030	A-42472-0156	03			03		A-42472-0202	03	26-62-3038	A-42472-0219
04	26-62-3040	A-42472-0157	04			04		A-42472-0203	04	26-62-3048	A-42472-0220
05	26-62-3050	A-42472-0158	05			05		A-42472-0204	05	26-62-3058	A-42472-0221
06	26-62-3060	A-42472-0159	06			06		A-42472-0205	06	26-62-3068	A-42472-0222
07	26-62-3070	A-42472-0160	07		A-42472-0189	07		A-42472-0206	07	26-62-3078	A-42472-0223
08	26-62-3080	A-42472-0161	08		A-42472-0190	08		A-42472-0207	08	26-62-3088	A-42472-0224
09	26-62-3090	A-42472-0162	09		A-42472-0191	09		A-42472-0208	09	26-62-3098	A-42472-0225
10	26-62-3100	A-42472-0163	10	26-62-3106	A-42472-0192	10		A-42472-0209	10	26-62-3108	A-42472-0226
11	26-62-3110	A-42472-0164	11		A-42472-0193	11		A-42472-0210	11	26-62-3118	A-42472-0227
12	26-62-3120	A-42472-0165	12		A-42472-0194	12		A-42472-0211	12	26-62-3128	A-42472-0228
13	26-62-3130	A-42472-0166	13		A-42472-0195	13		A-42472-0212	13	26-62-3138	A-42472-0229
14	26-62-3140	A-42472-0167	14		A-42472-0196	14		A-42472-0213	14	26-62-3148	A-42472-0230
15	26-62-3150	A-42472-0168	15		A-42472-0197	15	26-62-3157	A-42472-0214	15	26-62-3158	A-42472-0231
16	26-62-3160	A-42472-0169	16		A-42472-0198	16		A-42472-0215	16	26-62-3168	A-42472-0232
17	26-62-3170	A-42472-0170	17		A-42472-0199	17		A-42472-0216	17	26-62-3178	A-42472-0233
18	26-62-3180	A-42472-0171	18		A-42472-0200	18		A-42472-0217	18	26-62-3188	A-42472-0234

REV: I	ECR/ECN INFORMATION EC No: UCP2007-0341 DATE: 2006-08-07	TITLE: FLAT HEADER ASSEMBLY (3.96)/.156 CENTERS BENT SQ PINS, W/ PEGS	SHEET No. - 4 -
DOCUMENT NUMBER: SD-42472-001		CREATED / REVISED BY: PRIDDER	CHECKED BY: ADERR
		APPROVED BY: FSMITH	

