



# PolySwitch® PTC Devices

Overcurrent Protection Device

Raychem Circuit Protection Products

308 Constitution Drive  
Menlo Park, CA 94025-1164  
Phone: 800-227-4856  
www.circuitprotection.com

PRODUCT: nanoSMDC050F/13.2

DOCUMENT: SCD 25269  
REV LETTER: J  
REV DATE: 15-Apr-11  
PAGE NO.: 1 OF 1

## Specification Status: Released

### Maximum Electrical Rating

Voltage: 13.2V<sub>DC</sub>

Short Circuit Current: 100A

#### Notes:

1. All terminations are tin plated.
2. Drawing not to scale

#### Marking:



M

PART IDENTIFICATION

MANUFACTURER'S MARK

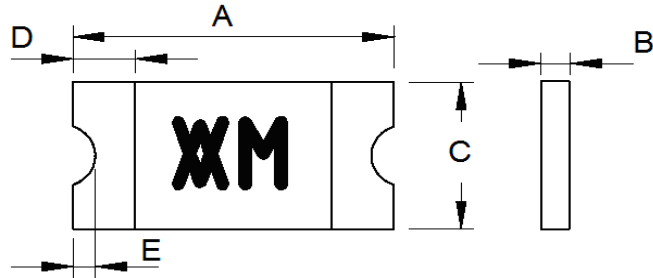

TABLE I. DIMENSIONS:

mm:  
in:

A		B		C		D		E
MIN	MAX	MIN	MAX	MIN	MAX	MIN	MAX	MIN
3.00	3.40	0.50	0.74	1.37	1.80	0.25	0.75	0.076
(0.118)	(0.134)	(0.019)	(0.029)	(0.054)	(0.071)	(0.010)	(0.030)	(0.003)

TABLE II. PERFORMANCE RATINGS:

CURRENT RATINGS**						TIME TO TRIP**	RESISTANCE VALUES		TRIPPED-STATE POWER DISSIPATION**
AMPERES AT 0°C		AMPERES AT 25°C		AMPERES AT 60°C		SECONDS AT 25°C, 8.0A	OHMS AT 25°C		WATTS AT 25°C, 13.2V
HOLD	TRIP	HOLD	TRIP	HOLD	TRIP	MAX	MIN	MAX*	MAX
0.61	1.24	0.50	1.10	0.35	0.75	0.1	0.20	0.75	0.8

\*Maximum resistance is measured 1 hour after reflow.

\*\* Values specified were determined using PCB's with 0.030"X1.5 ounce copper traces.

Agency Recognitions:  
Reference Documents:  
Precedence:  
Effectivity:  
CAUTION:

UL, CSA, TÜV  
PS300  
This specification takes precedence over documents referenced herein.  
Reference documents shall be the issue in effect on the date of invitation for bid.  
Operation beyond the rated voltage or current may result in rupture, electrical arcing or flame

### Materials Information

ROHS Compliant

Directive 2002/95/EC  
Compliant

ELV Compliant

Directive 2000/53/EC  
Compliant

Pb-Free



Halogen Free\*



\* Halogen Free refers to: Br≤900ppm, Cl≤900ppm, Br+Cl≤1500ppm