

LOC	DIST	REV	DATE	BY	APPV
H	-	1	12AUG2011	JvdH	TdB

NOTES:

- △ MATERIALS:
 CAGE ASSEMBLY: NICKEL SILVER, 0.25 THICK
 EMI SPRINGS: COPPER ALLOY
 FRONT FLANGE: ZINC ALLOY
 HEAT SINK: ALUMINUM
 HEAT SINK CLIP: STAINLESS STEEL
- △ PITCH BETWEEN PORTS OF ONE 1X3 CAGE ASSEMBLY.
- △ SPACING BETWEEN CAGES ON THE SAME PC BOARD, TO BE SPECIFIED BY CUSTOMER, MUST COMPLY WITH MINIMUM DIMENSIONS SHOWN.
- △ REFERENCE APPLICATION SPEC 114-..... FOR RECOMMENDED DRILL HOLE DIAMETER AND PLATING THICKNESS.
- △ DATUMS AND BASIC DIMENSIONS ESTABLISHED BY CUSTOMER.
- △ DIMENSION C IS THE NOMINAL THICKNESS OF CUSTOMER SUPPLIED PC BOARD.
 MINIMUM SINGLE SIDED PC BOARD THICKNESS: 1.45mm
 MINIMUM DOUBLE SIDED PC BOARD THICKNESS: 2.2mm PER QSFP
- △ HEAT SINKS AND CLIPS SHIPPED ASSEMBLED TO CAGE ASSEMBLY.
 CAGE ASSEMBLY MAY BE PRESSED INTO THE PCB AS SHIPPED.
- △ DATUM [-A-] IS TOP SURFACE OF PC BOARD.
- △ DIMENSION APPLIES WITH MODULE INSERTED IN CAGE.
- △ UNPLATED THRU HOLE.
- △ MATES WITH QSFP MSA COMPATIBLE TRANSCEIVER.
- △ SURFACE TRACES PERMITTED WITHIN THIS AREA EXCEPT WHERE CAGE STANDOFFS, SHOWN IN DETAIL S, CONTACT PC BOARD.
- △ BASELINE FOR THESE DIMENSIONS IS THE CENTER OF COMPLIANT PIN HOLE.
- △ DATE CODE (YYWW) MARKED ON TOP OF CAGE AND CONCEALED BY HEAT SINKS APPLIES TO CAGE ASSEMBLY ONLY.
- △ REFERENCE APP SPEC 114-..... FOR GASKET THICKNESS CALCULATION.
- △ FINISH:
 EMI SPRINGS: 2µm MINIMUM TIN
 FRONT FLANGE: 3µm MINIMUM TIN OVER 1.27µm MINIMUM NICKEL OVER 5.08µm MINIMUM COPPER
 HEAT SINK: NICKEL.

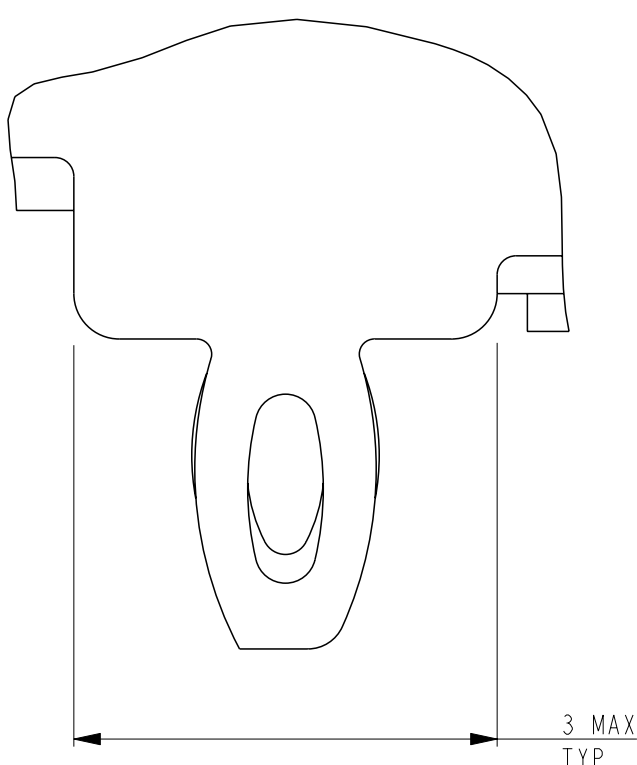

DETAIL S
 SCALE 20:1

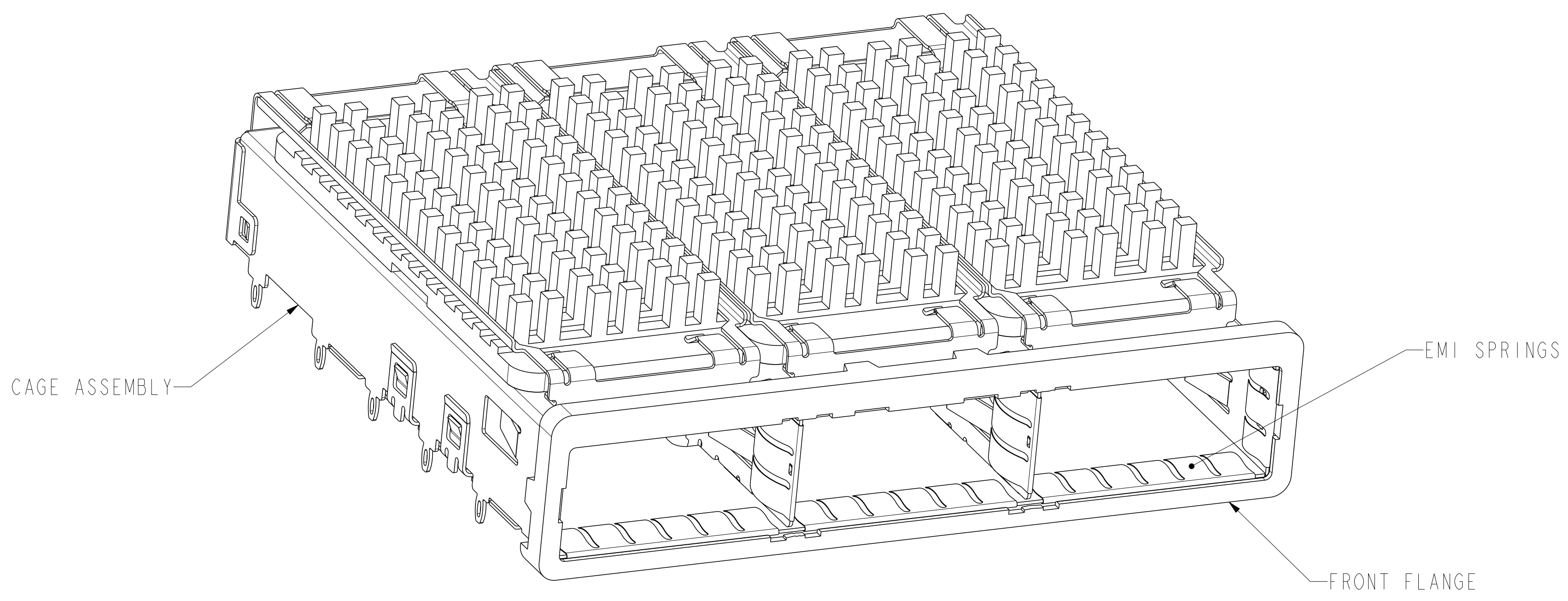
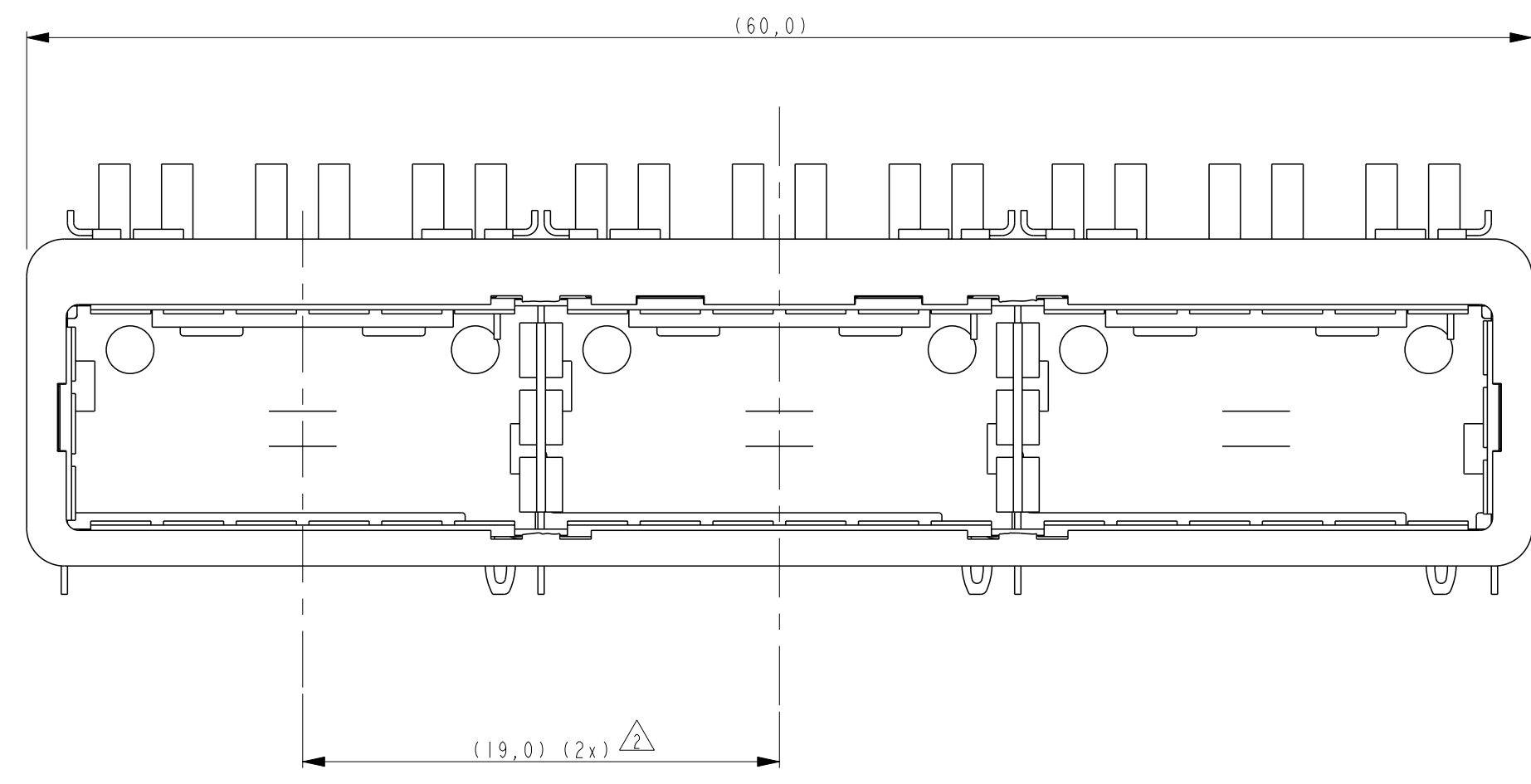
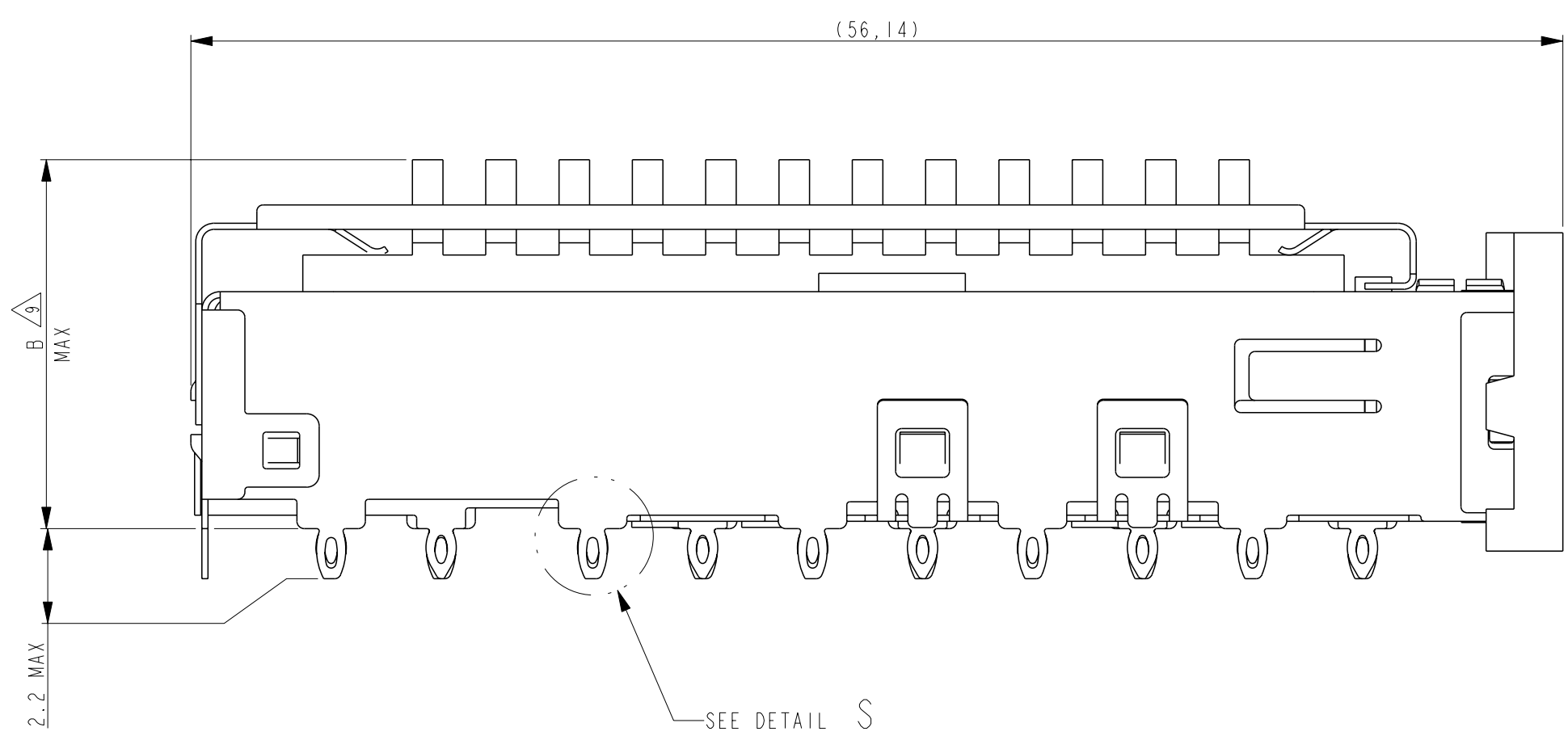

PRELIMINARY PART
 NOT RELEASED FOR PRODUCTION
 THIS PRODUCT HAS NOT COMPLETED
 VALIDATION TESTING

23.0	NETWORKING	2173239-3
16.0	SAN	2173239-2
13.7	PCI	2173239-1
B	HEAT SINK PROFILE	PART NUMBER

THIS DRAWING IS A CONTROLLED DOCUMENT.		DWN	2AUG2011
DIMENSIONS:		CHK	J. W. D. HELLDEN
mm	TOLERANCES UNLESS OTHERWISE SPECIFIED:	APPV	R. VERBET
1 PLC	±	DATE	12AUG2011
2 PLC	±0.1	NAME	T. BOER
3 PLC	±0.1	PRODUCT SPEC	114-.....
4 PLC	±0.013	APPLICATION SPEC	108-.....
ANGLES	±0.0001	WEIGHT	114-.....
FINISH	±	SCALE	CAGE CODE
		DRAWING NO	RESTRICTED TO
		A1 00779 C=2173239	
		CUSTOMER DRAWING	SCALE 1:1 SHEET 1 OF 5 REV 1

LOC	DIST	REV	DESCRIPTION	DATE	DWN	APVD
H	-	-	SEE SHEET 1	-	-	-

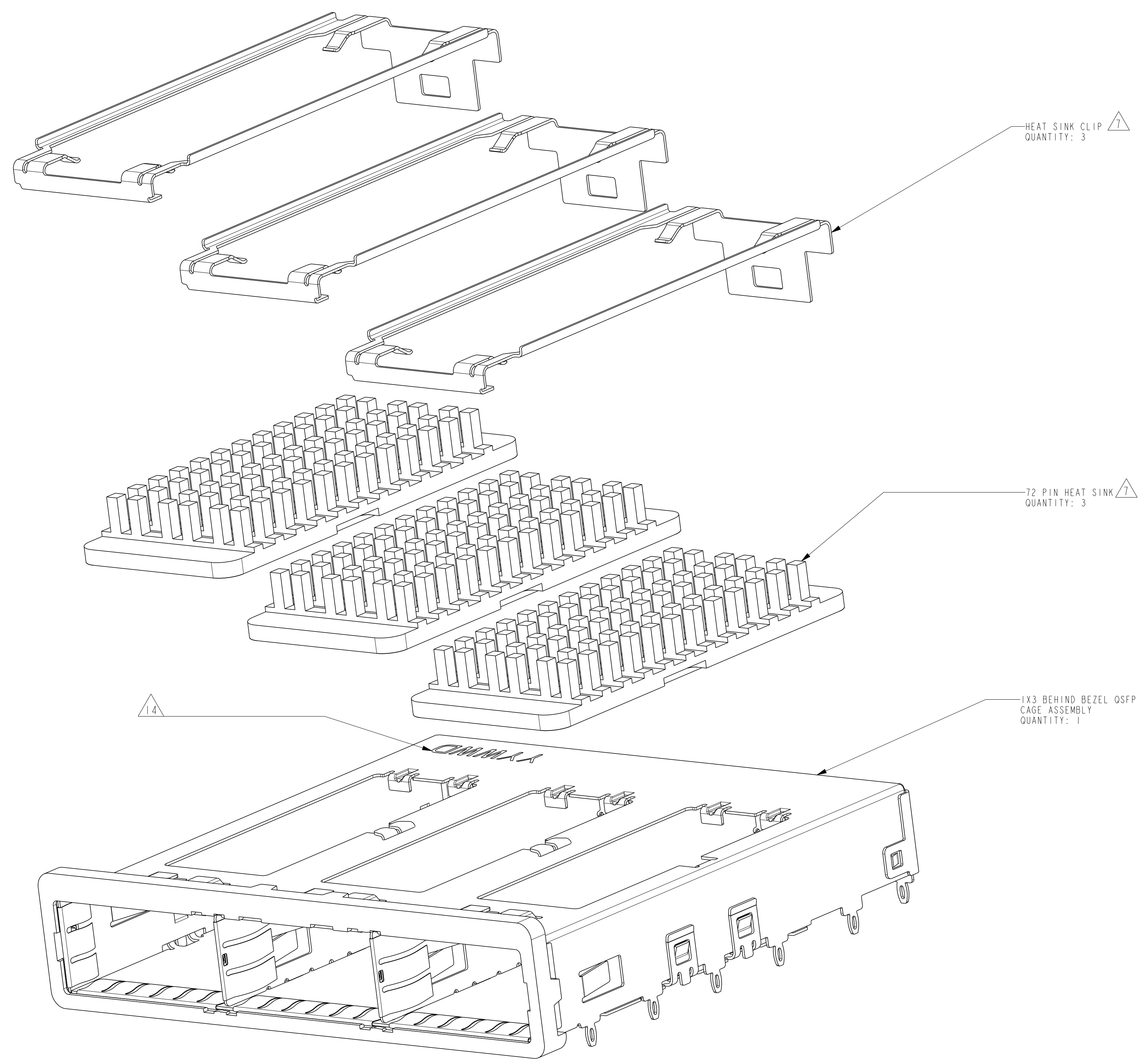

**PRELIMINARY PART
 NOT RELEASED FOR PRODUCTION**
**THIS PRODUCT HAS NOT COMPLETED
 VALIDATION TESTING**

THIS DRAWING IS A CONTROLLED DOCUMENT.		DWN	J. V. D. HEIJDEN	12AUG2011	TE Connectivity	
DIMENSIONS:		CHK	R. VERBEEF	12AUG2011		
mm	9 PLC ±0.1 3 PLC ±0.1 5 PLC ±0.013 4 PLC ±0.0001 ANGLES ±0.0001 FINISH ±0.0001	APVD	T. D. BOER	15AUG2011	NAME	1X3 CAGE ASSEMBLY, BEHIND BEZEL, W/ HEAT SINKS, 2QSFP+
		PRODUCT SPEC		108----	SIZE	A1
MATERIAL		APPLICATION SPEC		114-----	CAGE CODE	00779
		WEIGHT			DRAWING NO	C=2173239
		CUSTOMER DRAWING			RESTRICTED TO	
		SCALE		1:1	SHEET	2 OF 5
		REV				

LOC	DIST	REV	DATE	BY	APPD
H	-	1	-	-	-
REVISIONS			DESCRIPTION	DATE	DWN
			SEE SHEET 1	-	-

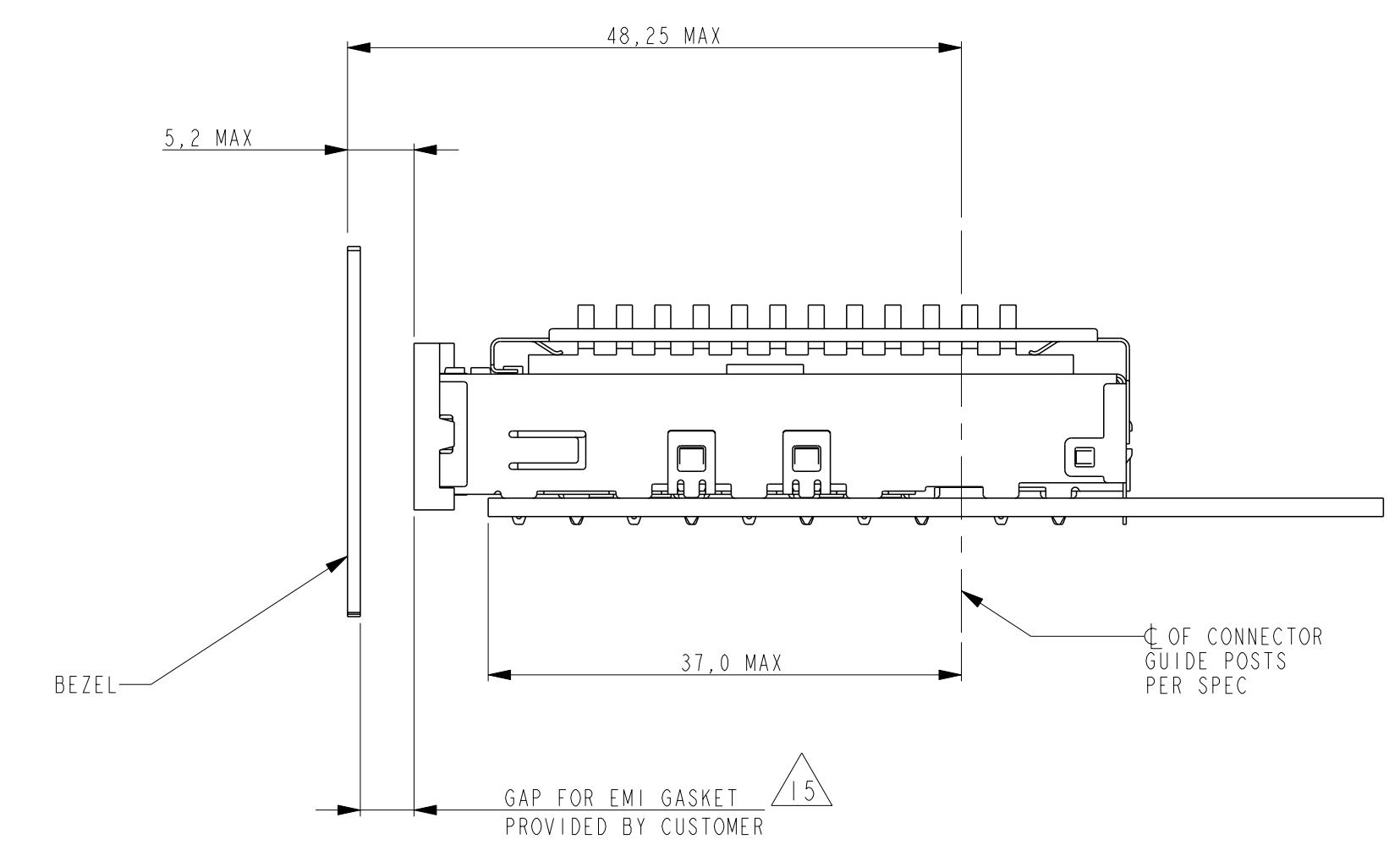
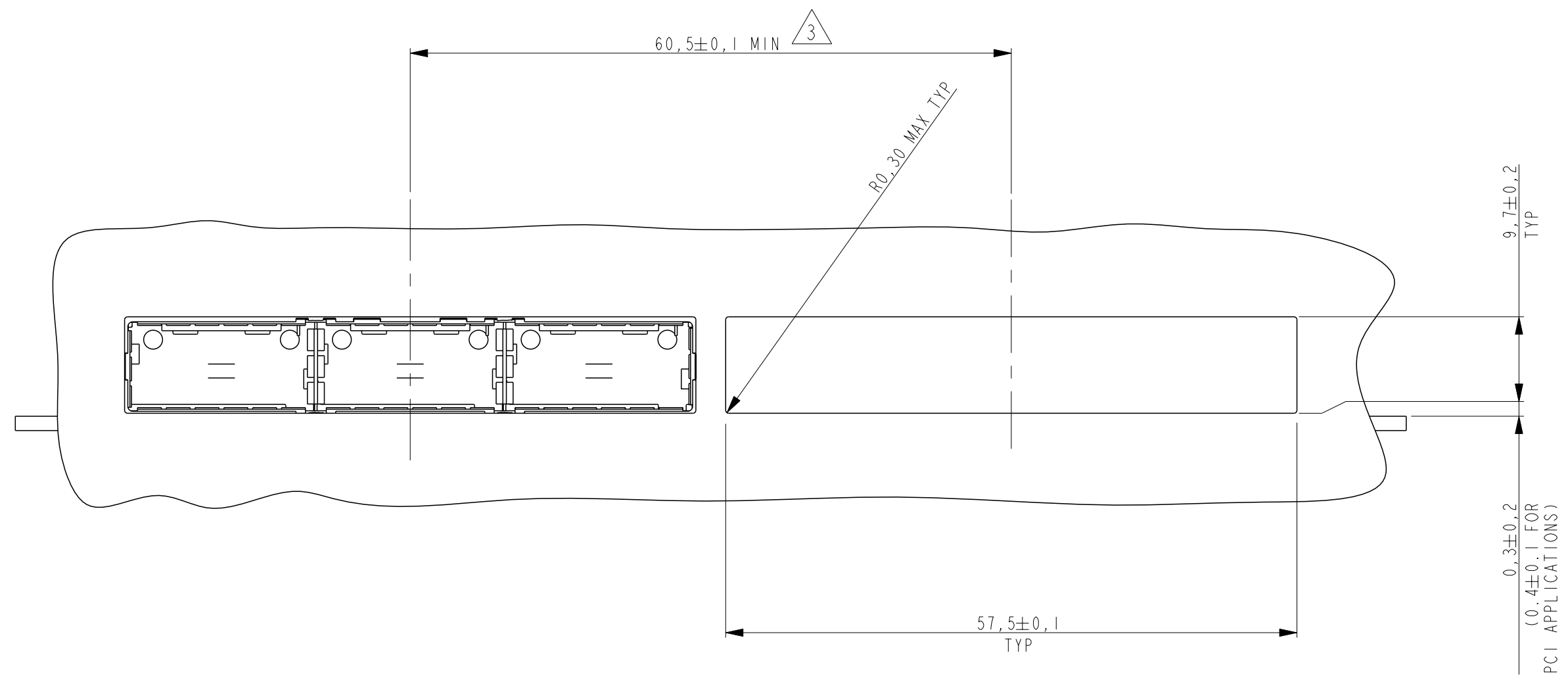

ONE SIDED CONFIGURATION
 SCALE 2:1

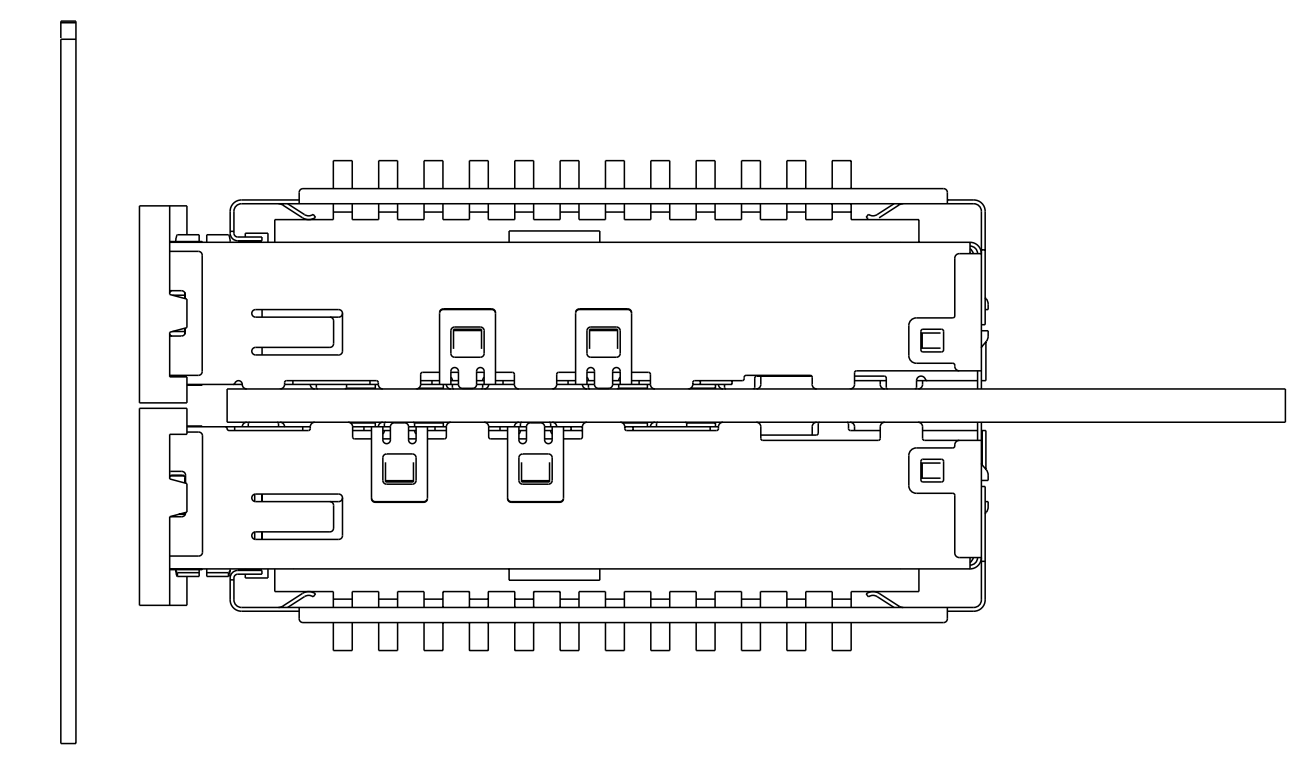
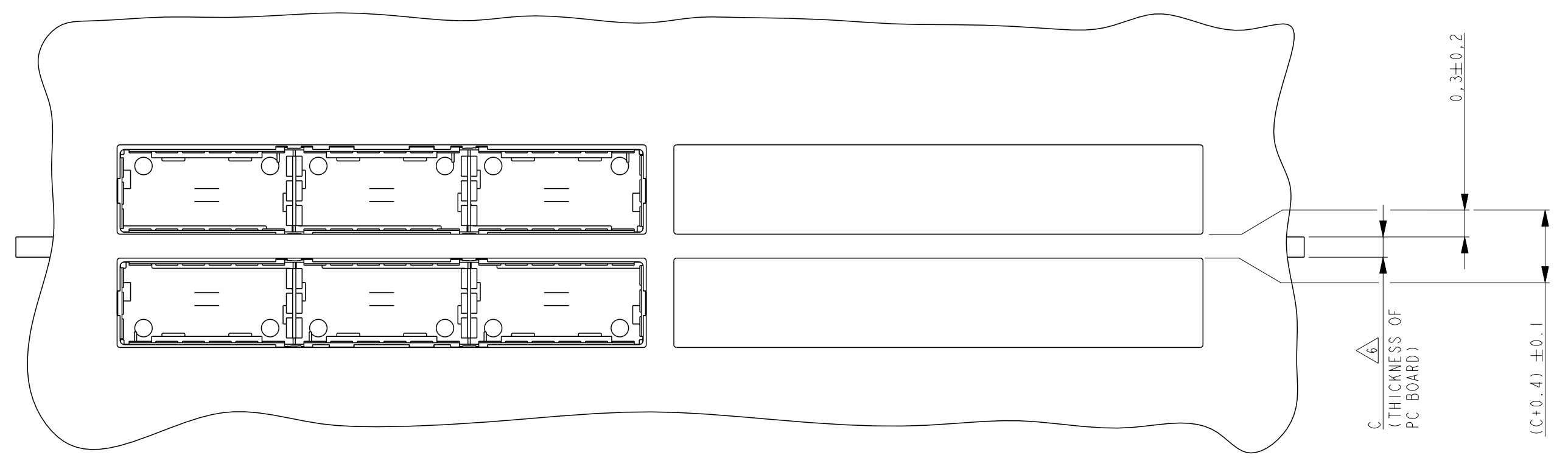

BELLY TO BELLY CONFIGURATION SIMILAR TO ONE SIDED EXCEPT WHERE NOTED
 SCALE 2:1

**PRELIMINARY PART
 NOT RELEASED FOR PRODUCTION**

**THIS PRODUCT HAS NOT COMPLETED
 VALIDATION TESTING**

THIS DRAWING IS A CONTROLLED DOCUMENT.		DWN	J. V. D. HEIJDEN	12AUG2011
DIMENSIONS:		CHK	R. VERBEEF	12AUG2011
mm	9 PLC ±0.1	APVD	T. D. BOER	15AUG2011
	1 PLC ±0.1	PRODUCT SPEC		
	2 PLC ±0.1	APPLICATION SPEC		
	3 PLC ±0.013	114°		
	4 PLC ±0.0001	114°		
	ANGLES ±0.0001	WEIGHT		
MATERIAL	FINISH	CUSTOMER DRAWING		
		NAME		RESTRICTED TO
		1X3 CAGE ASSEMBLY, BEHIND BEZEL, W/ HEAT SINKS, 2QSFP+		
		SIZE	CAGE CODE	DRAWING NO
		A1	00779	C=2173239
		SCALE	SHEET	REV
		1:1	3 OF 5	

LOC	DIST	REV	DATE	BY	APPD
H	-	1	-	-	-

REVISIONS		DATE	BY	APPD
1	SEE SHEET 1	-	-	-

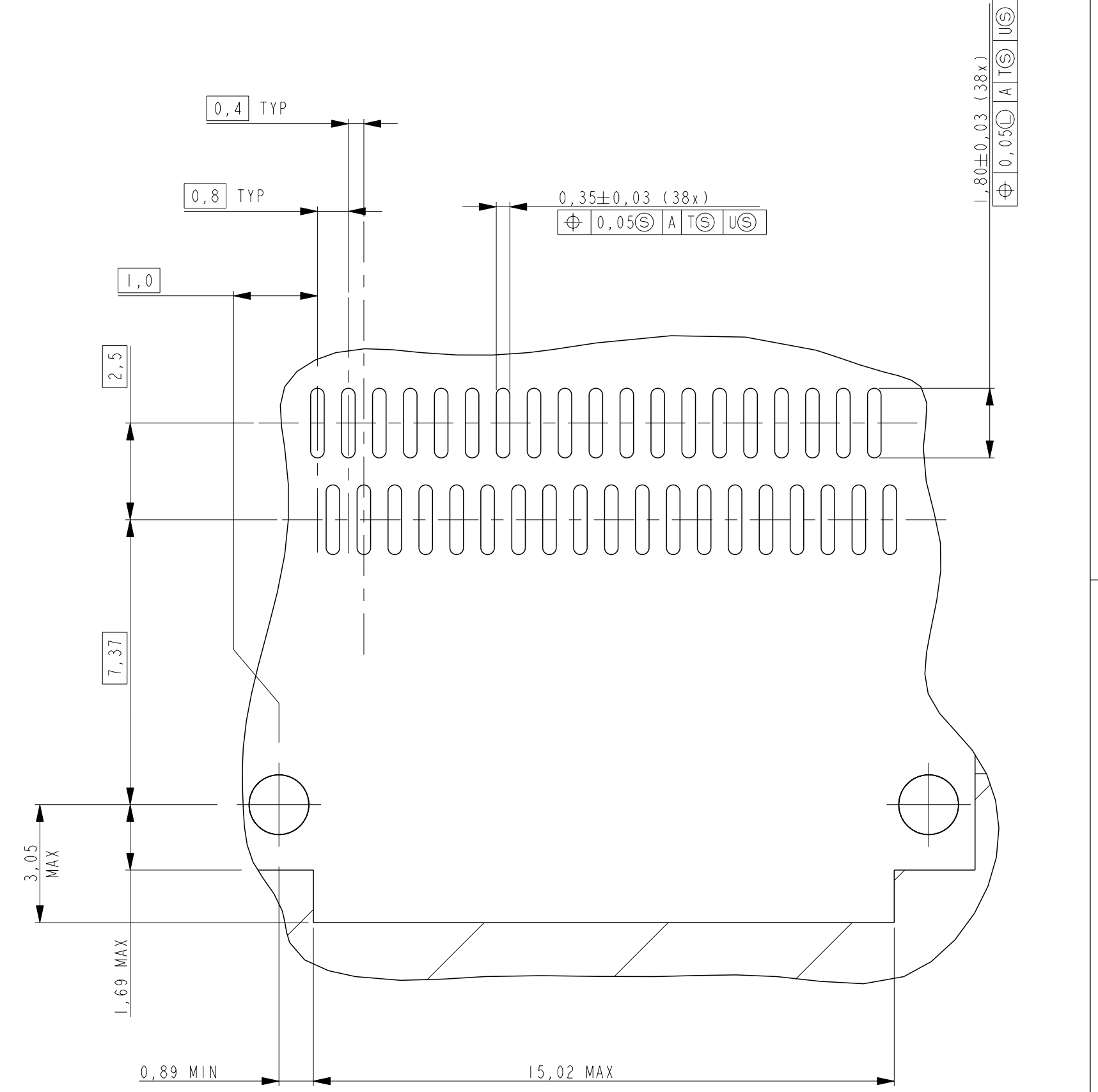
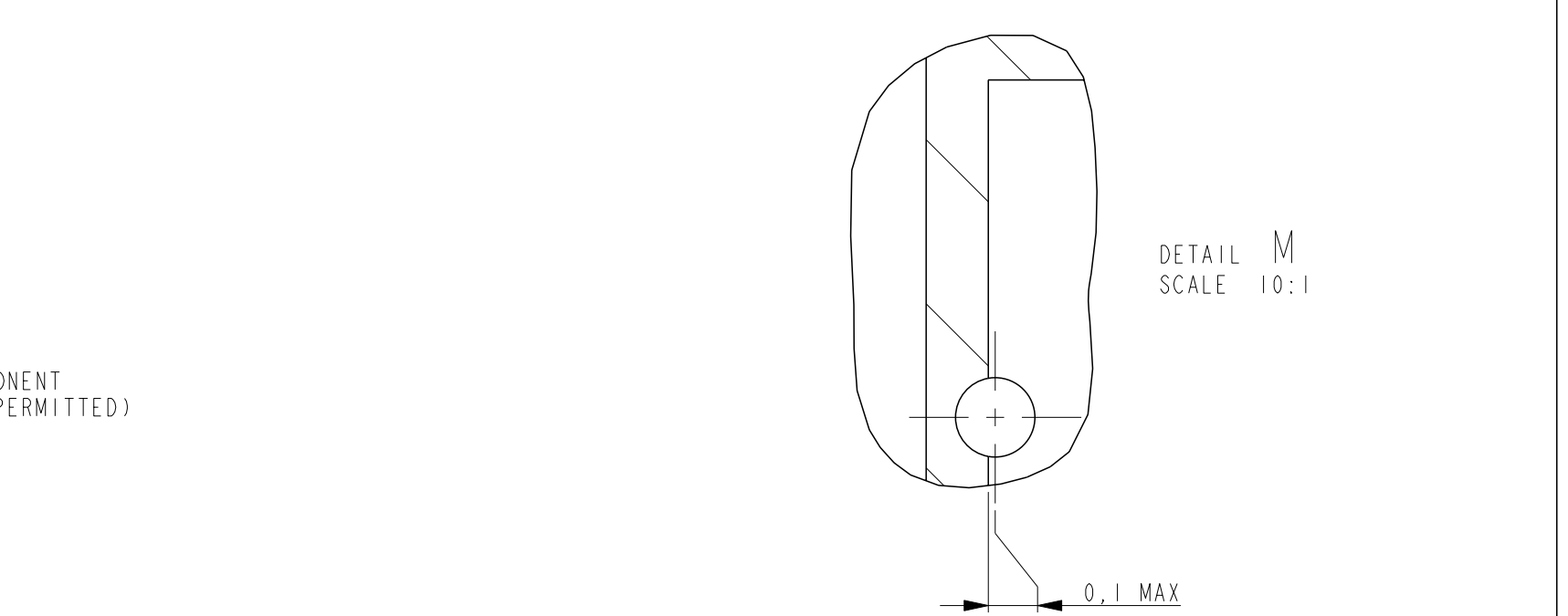
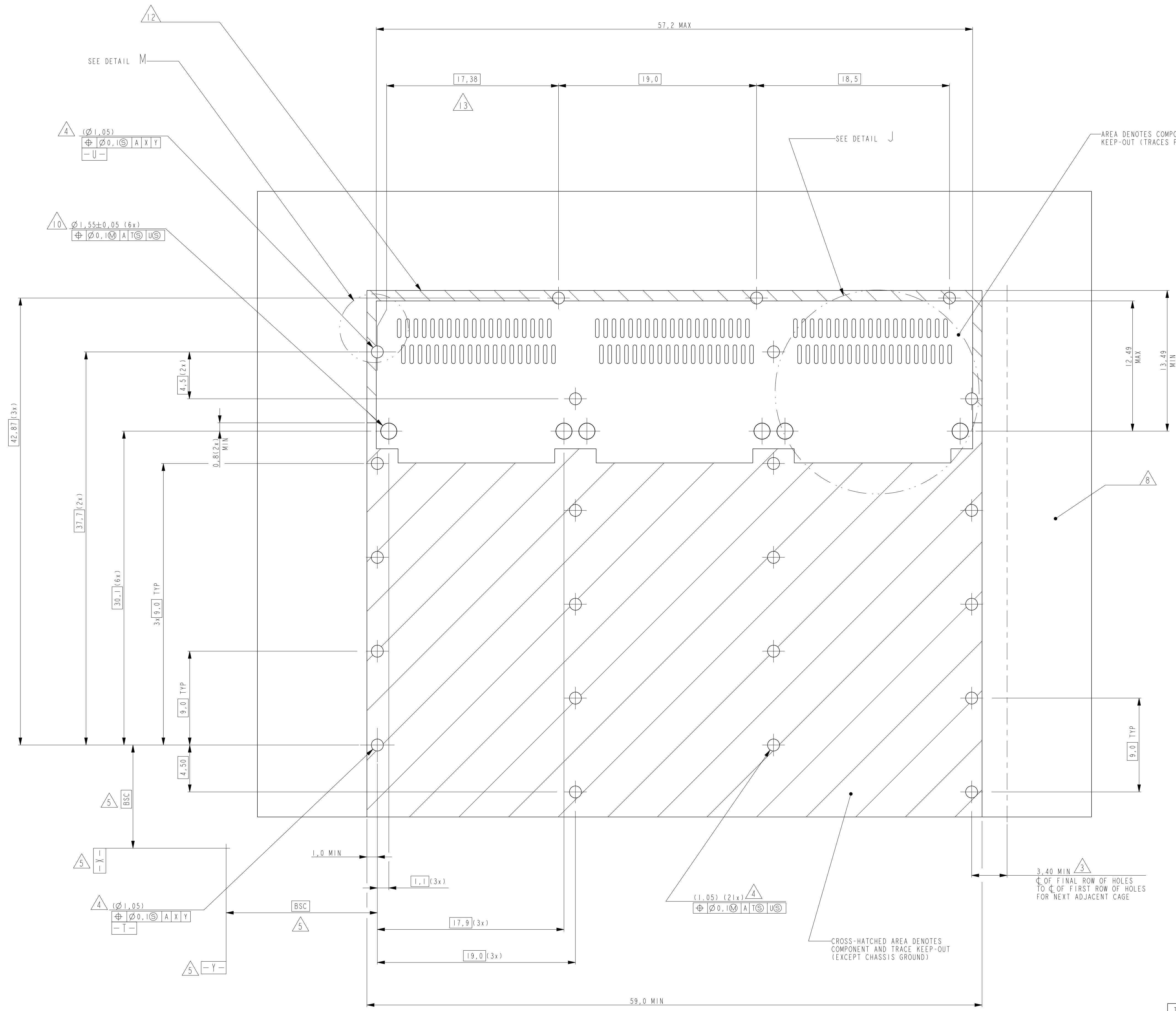

RECOMMENDED PC BOARD LAYOUT
 SINGLE SIDE MOUNT CONFIGURATION
 SCALE 5:1

**PRELIMINARY PART
 NOT RELEASED FOR PRODUCTION**
 THIS PRODUCT HAS NOT COMPLETED
 VALIDATION TESTING

THIS DRAWING IS A CONTROLLED DOCUMENT.		DWN	J.V.D. HEIJDE	12AUG2011
DIMENSIONS:		CHK	R. VERBEEF	12AUG2011
mm	TOLERANCES UNLESS OTHERWISE SPECIFIED:	APVD	T.D. BOER	15AUG2011
Ø	0 PLC ±	NAME	1X3 CAGE ASSEMBLY, BEHIND BEZEL, W/ HEAT SINKS, 2QSFP+	
∅	1 PLC ±0.1	PRODUCT SPEC	108----	
∅	2 PLC ±0.1	APPLICATION SPEC	114----	
∅	3 PLC ±0.013	WEIGHT	A1 00779 C=2173239	
∅	4 PLC ±0.001	RESTRICTED TO	-	
∅	ANGLES ±	SCALE	5:1 SHEET 4 OF 5	
MATERIAL	FINISH	CUSTOMER DRAWING	REV	

LOC	DIST	REV	DATE	BY	APPD
H	-	1	-	-	-

REVISIONS		
DESCRIPTION	DATE	BY
SEE SHEET 1	-	-

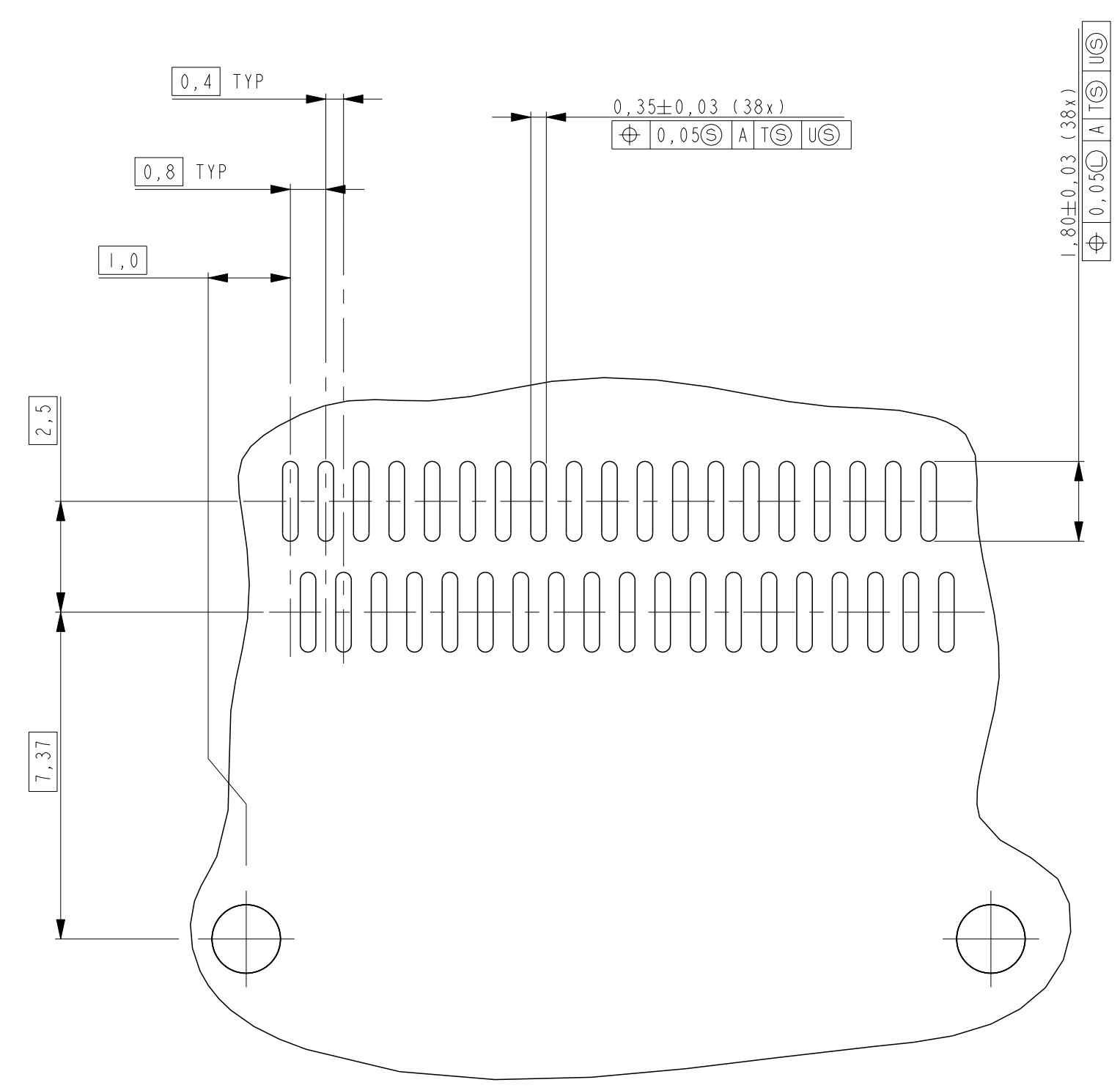
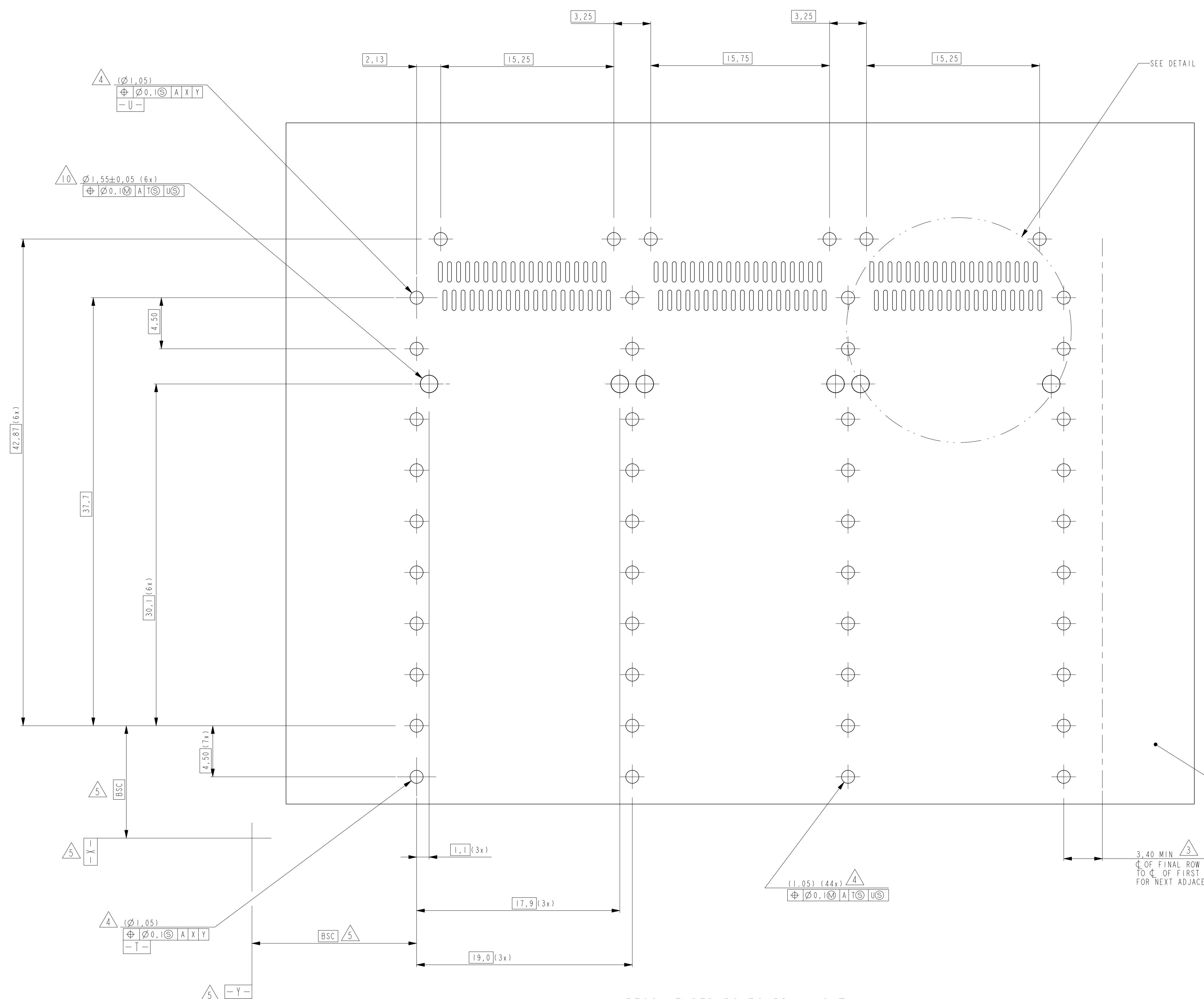

DETAIL K
 3 PLACES
 SCALE 8:1

RECOMMENDED PC BOARD LAYOUT
 BELLY TO BELLY CONFIGURATION
 SEE SHEET 4 FOR COMPONENT
 AND TRACE KEEP-OUTS
 SCALE 5:1

PRELIMINARY PART
 NOT RELEASED FOR PRODUCTION
 THIS PRODUCT HAS NOT COMPLETED
 VALIDATION TESTING

THIS DRAWING IS A CONTROLLED DOCUMENT.		DWN	J.V.D. HEIJDEN	12AUG2011
DIMENSIONS:		CHK	R. VERBEEF	12AUG2011
mm	TOLERANCES UNLESS OTHERWISE SPECIFIED:	APVD	T.D. BOER	15AUG2011
Ø	9 PLC ±0.1	NAME		
PLC	2 PLC ±0.1	1X3 CAGE ASSEMBLY, BEHIND BEZEL,		
PLC	3 PLC ±0.1	W/ HEAT SINKS, 2QSFP+		
PLC	4 PLC ±0.013	SIZE CAGE CODE DRAWING NO		
PLC	5 PLC ±0.001	A1 00779 C=2173239		
ANGLES	FINISH	RESTRICTED TO		
114°	WEIGHT	-		
CUSTOMER DRAWING	SCALE	1:1 SHEET 5 OF 5 REV 1		