

PART NO.

D600ML Series

REVISIONS

ECN #	REV	DESCRIPTION	DRAWN	DATE	CHECKD	DATE	APPRVD	DATE
-	A	RELEASED	SID	10/4/12	AMU	10/4/12		24/4/12

Metallised Plastic

D609

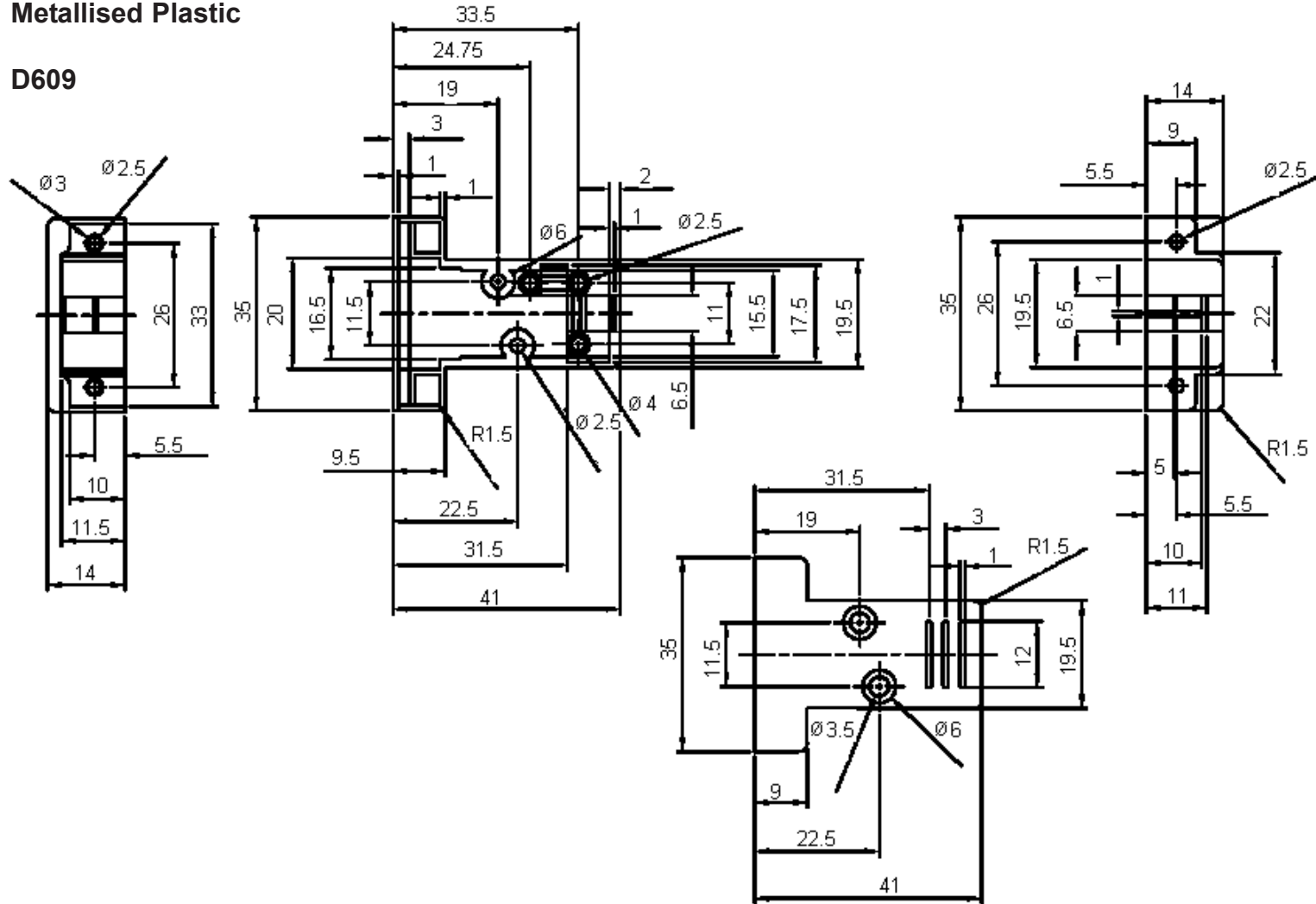

Features:

- Nickel plated ABS shell
- Enhanced shielding of cables from RFI / EMI
- Knockout for top or side cable entry
- Supplied with two 59 mm and two 13 mm jackscrews

Dimensions : Millimetres

Important Notice : This data sheet and its contents (the "Information") belong to the members of the Premier Farnell group of companies (the "Group") or are licensed to it. No licence is granted for the use of it other than for information purposes in connection with the products to which it relates. No licence of any intellectual property rights is granted. The Information is subject to change without notice and replaces all data sheets previously supplied. The Information supplied is believed to be accurate but the Group assumes no responsibility for its accuracy or completeness, any error in or omission from it or for any use made of it. Users of this data sheet should check for themselves the information and the suitability of the products for their purpose and not make any assumptions based on information included or omitted. Liability for loss or damage resulting from any reliance on the Information or use of it (including liability resulting from negligence or where the Group was aware of the possibility of such loss or damage arising) is excluded. This will not operate to limit or restrict the Group's liability for death or personal injury resulting from its negligence. Multicomp is the registered trademark of the Group. © Premier Farnell plc 2012.

TOLERANCES:

UNLESS OTHERWISE SPECIFIED, DIMENSIONS ARE FOR REFERENCE PURPOSES ONLY.

DRAWN BY:	DATE:
ASH	10/04/12
CHECKED BY:	DATE:
AMU	10/04/12
APPROVED BY:	DATE:
	24/04/12

DRAWING TITLE:

1D600ML Series - EMI / RFI Shielded 'D' Shells

SIZE	DWG NO.	ELECTRONIC FILE	REV
A	M10000240	209826_DWG	A
SCALE: NTS	U.O.M.: mm	SHEET: 1 OF 5	

PART NO.

D600ML Series

REVISIONS

ECN #	REV	DESCRIPTION	DRAWN	DATE	CHECKD	DATE	APPRVD	DATE
-	A	RELEASED	SID	10/4/12	AMU	10/4/12		24/4/12

D615

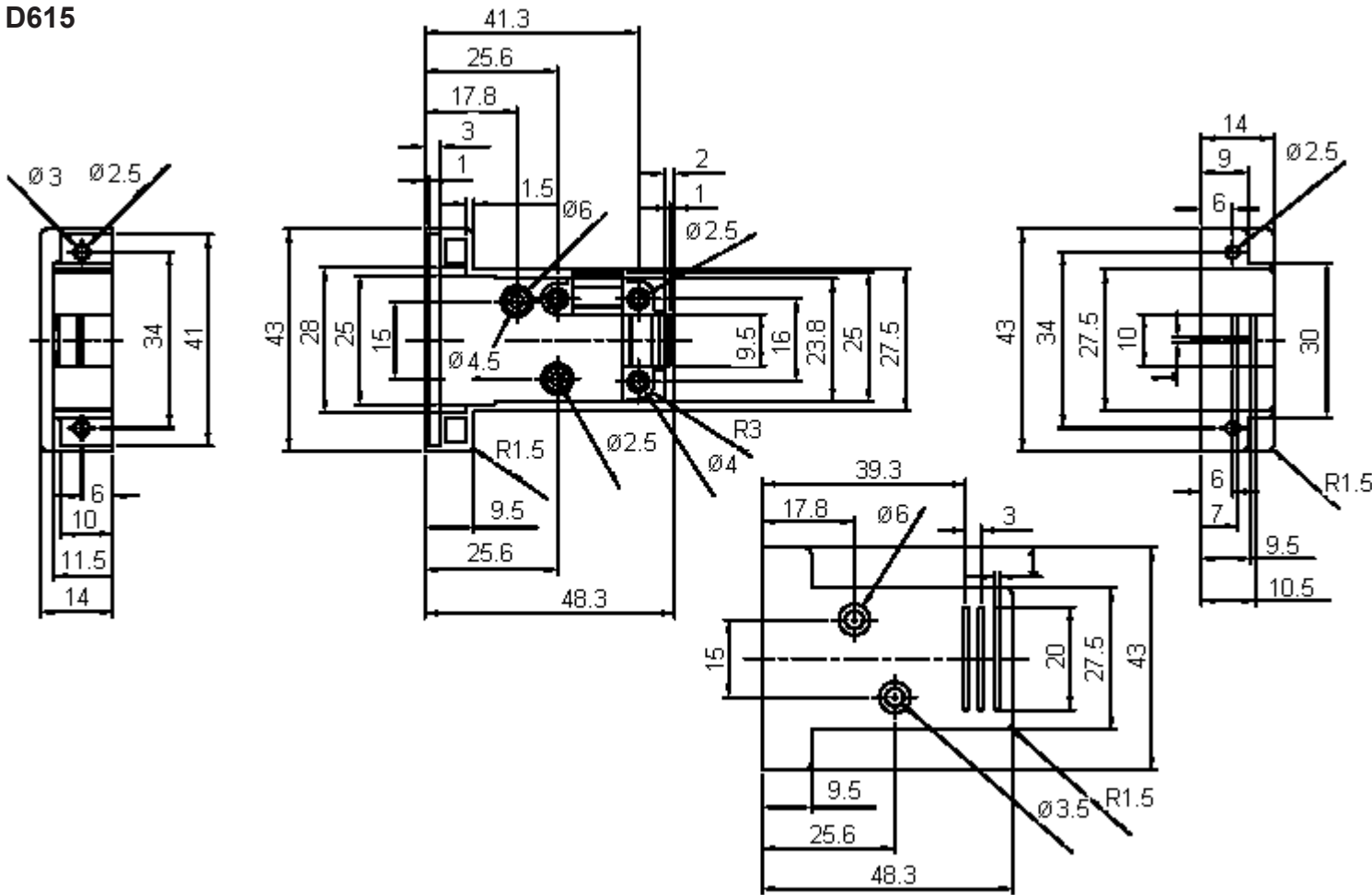

Dimensions : Millimetres

Important Notice : This data sheet and its contents (the "Information") belong to the members of the Premier Farnell group of companies (the "Group") or are licensed to it. No licence is granted for the use of it other than for information purposes in connection with the products to which it relates. No licence of any intellectual property rights is granted. The Information is subject to change without notice and replaces all data sheets previously supplied. The Information supplied is believed to be accurate but the Group assumes no responsibility for its accuracy or completeness, any error in or omission from it or for any use made of it. Users of this data sheet should check for themselves the information and the suitability of the products for their purpose and not make any assumptions based on information included or omitted. Liability for loss or damage resulting from any reliance on the Information or use of it (including liability resulting from negligence or where the Group was aware of the possibility of such loss or damage arising) is excluded. This will not operate to limit or restrict the Group's liability for death or personal injury resulting from its negligence. Multicomp is the registered trademark of the Group. © Premier Farnell plc 2012.

TOLERANCES:

UNLESS OTHERWISE SPECIFIED, DIMENSIONS ARE FOR REFERENCE PURPOSES ONLY.

DRAWN BY:	DATE:
ASH	10/04/12
CHECKED BY:	DATE:
AMU	10/04/12
APPROVED BY:	DATE:
	24/04/12

DRAWING TITLE:

1D600ML Series - EMI / RFI Shielded 'D' Shells

SIZE A	DWG NO. M10000240	ELECTRONIC FILE 209826_DWG	REV A
SCALE: NTS		U.O.M.: mm	SHEET: 2 OF 5

PART NO.

D600ML Series

REVISIONS

ECN #	REV	DESCRIPTION	DRAWN	DATE	CHECKD	DATE	APPRVD	DATE
-	A	RELEASED	SID	10/4/12	AMU	10/4/12		24/4/12

D625

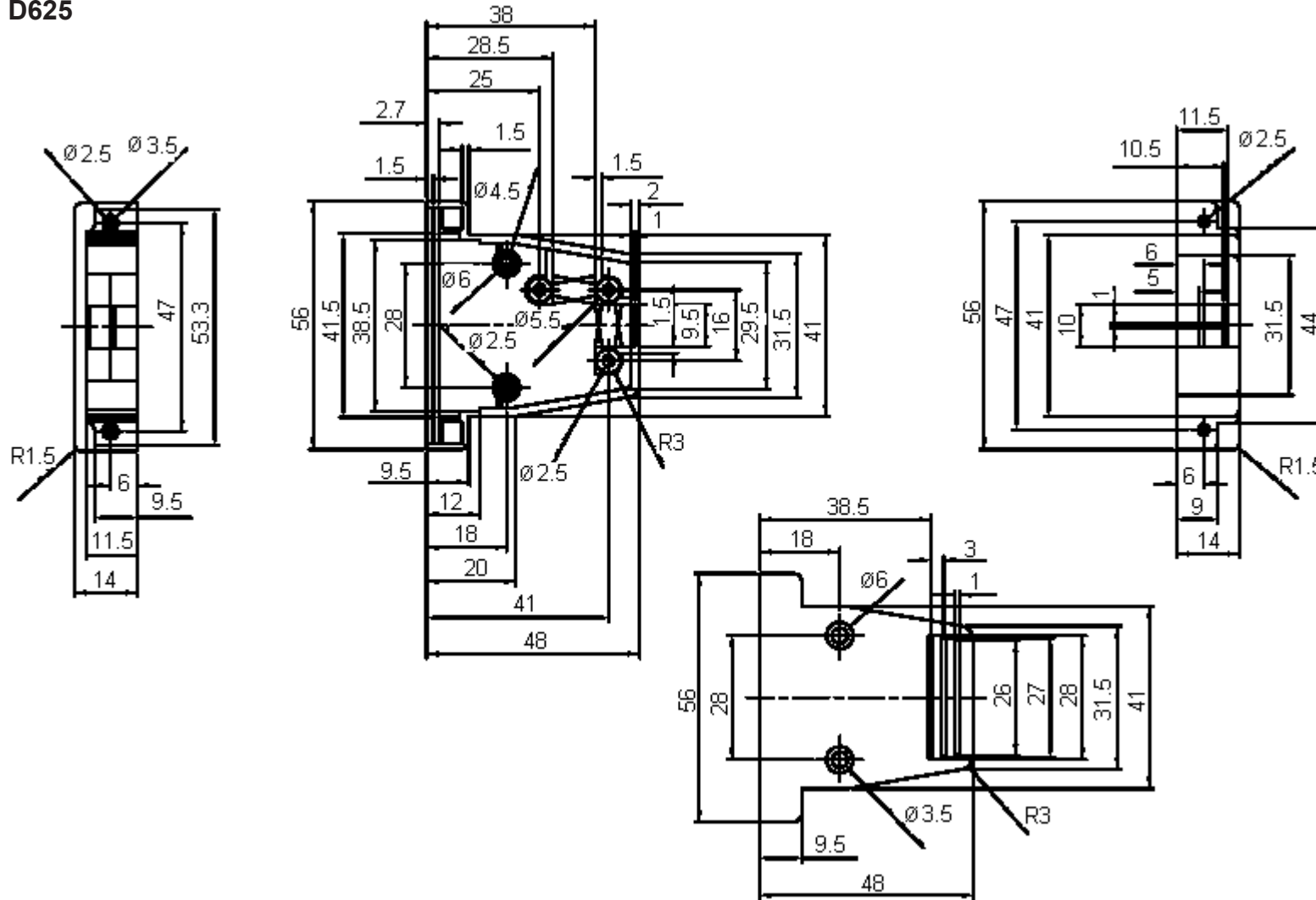

Dimensions : Millimetres

Important Notice : This data sheet and its contents (the "Information") belong to the members of the Premier Farnell group of companies (the "Group") or are licensed to it. No licence is granted for the use of it other than for information purposes in connection with the products to which it relates. No licence of any intellectual property rights is granted. The Information is subject to change without notice and replaces all data sheets previously supplied. The Information supplied is believed to be accurate but the Group assumes no responsibility for its accuracy or completeness, any error in or omission from it or for any use made of it. Users of this data sheet should check for themselves the information and the suitability of the products for their purpose and not make any assumptions based on information included or omitted. Liability for loss or damage resulting from any reliance on the Information or use of it (including liability resulting from negligence or where the Group was aware of the possibility of such loss or damage arising) is excluded. This will not operate to limit or restrict the Group's liability for death or personal injury resulting from its negligence. Multicomp is the registered trademark of the Group. © Premier Farnell plc 2012.

TOLERANCES:
UNLESS OTHERWISE SPECIFIED, DIMENSIONS ARE FOR REFERENCE PURPOSES ONLY.

DRAWN BY:	DATE:
ASH	10/04/12
CHECKED BY:	DATE:
AMU	10/04/12
APPROVED BY:	DATE:
	24/04/12

DRAWING TITLE:			
1D600ML Series - EMI / RFI Shielded 'D' Shells			
SIZE	DWG NO.	ELECTRONIC FILE	REV
A	M10000240	209826_DWG	A
SCALE: NTS		U.O.M.: mm	SHEET: 3 OF 5



PART NO.

D600ML Series

REVISIONS

ECN #	REV	DESCRIPTION	DRAWN	DATE	CHECKD	DATE	APPRVD	DATE
-	A	RELEASED	SID	10/4/12	AMU	10/4/12		24/4/12

D637

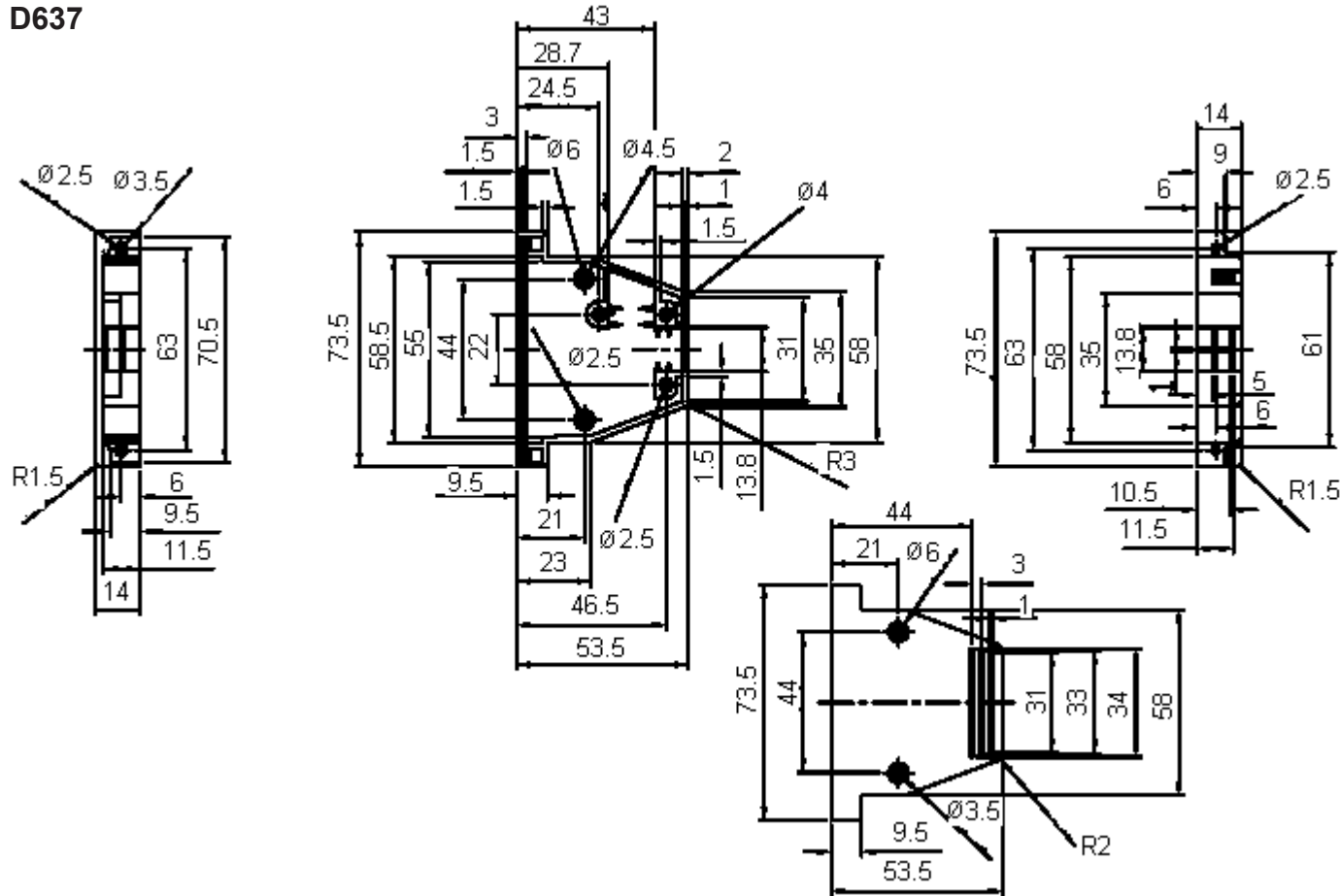

Dimensions : Millimetres

Important Notice : This data sheet and its contents (the "Information") belong to the members of the Premier Farnell group of companies (the "Group") or are licensed to it. No licence is granted for the use of it other than for information purposes in connection with the products to which it relates. No licence of any intellectual property rights is granted. The Information is subject to change without notice and replaces all data sheets previously supplied. The Information supplied is believed to be accurate but the Group assumes no responsibility for its accuracy or completeness, any error in or omission from it or for any use made of it. Users of this data sheet should check for themselves the Information and the suitability of the products for their purpose and not make any assumptions based on information included or omitted. Liability for loss or damage resulting from any reliance on the Information or use of it (including liability resulting from negligence or where the Group was aware of the possibility of such loss or damage arising) is excluded. This will not operate to limit or restrict the Group's liability for death or personal injury resulting from its negligence. Multicomp is the registered trademark of the Group. © Premier Farnell plc 2012.

TOLERANCES:
UNLESS OTHERWISE SPECIFIED, DIMENSIONS ARE FOR REFERENCE PURPOSES ONLY.

DRAWN BY:	DATE:
ASH	10/04/12
CHECKED BY:	DATE:
AMU	10/04/12
APPROVED BY:	DATE:
	24/04/12

DRAWING TITLE:			
1D600ML Series - EMI / RFI Shielded 'D' Shells			
SIZE	DWG NO.	ELECTRONIC FILE	REV
A	M10000240	209826_DWG	A
SCALE: NTS		U.O.M.: mm	SHEET: 4 OF 5



PART NO.

D600ML Series

REVISIONS

ECN #	REV	DESCRIPTION	DRAWN	DATE	CHECKD	DATE	APPRVD	DATE
-	A	RELEASED	SID	10/4/12	AMU	10/4/12		24/4/12

Specification Table

Number of Ways	Dimensions			Maximum Cable Entry	Part Number
	Height	Width	Depth		
9	41	35	17	6 × 5.5	D609ML
15	48	43		9 × 5	D615ML
25	48	57		9 × 6	D625ML
37	54	74		13 × 6	D637ML

Dimensions : Millimetres

www.element14.com
www.farnell.com
www.newark.com

Important Notice : This data sheet and its contents (the "Information") belong to the members of the Premier Farnell group of companies (the "Group") or are licensed to it. No licence is granted for the use of it other than for information purposes in connection with the products to which it relates. No licence of any intellectual property rights is granted. The Information is subject to change without notice and replaces all data sheets previously supplied. The Information supplied is believed to be accurate but the Group assumes no responsibility for its accuracy or completeness, any error in or omission from it or for any use made of it. Users of this data sheet should check for themselves the information and the suitability of the products for their purpose and not make any assumptions based on information included or omitted. Liability for loss or damage resulting from any reliance on the Information or use of it (including liability resulting from negligence or where the Group was aware of the possibility of such loss or damage arising) is excluded. This will not operate to limit or restrict the Group's liability for death or personal injury resulting from its negligence. Multicomp is the registered trademark of the Group. © Premier Farnell plc 2012.

TOLERANCES:
UNLESS OTHERWISE SPECIFIED, DIMENSIONS ARE FOR REFERENCE PURPOSES ONLY.

DRAWN BY:	DATE:
ASH	10/04/12
CHECKED BY:	DATE:
AMU	10/04/12
APPROVED BY:	DATE:
	24/04/12

DRAWING TITLE:			
1D600ML Series - EMI / RFI Shielded 'D' Shells			
SIZE	DWG NO.	ELECTRONIC FILE	REV
A	M10000240	209826_DWG	A
SCALE: NTS		U.O.M.: mm	SHEET: 5 OF 5