

H:9`B: CFA 5HC B`7C B H5-B98`B`H:G`8F5K B: `G`H:9`GC @
 DFC D9FHC: @7CA Z-B7`5B MF9DFC 81 7HC B`B D5FHC F K <C @
 K H:C I H H:9K F H B B D9FA GGC B C: @7CA Z-B7`GDFC <6+98`

Fc<G'7ca d'JUbhU

F9J GC BG			
F9J	89G7 F-DHC B	85H9	5DDFCJ 98
9	97B`-...: F9H FB98 @7CA @C: C HC D%7C BB97HC F	%@) #&S	8: F G9@C
:	97B) , . 58898 @9B: H: \$+) A 2F9J @98 K #9A 5D/ D57?5: B: BC H9	%@+ #9%	8: F G9@C
:	97B) : (. F9J @98 @7CA @C: C HC B'9K 9GH	%#% #9%	8: F G9@C
<	97B)* & + 58898 7C B H57 HD@5HB: BC H71 D85H98 : CFA 5H	\$: #% #9%	8: D

8

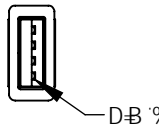

"D%"
 I G6`G9F 9G`5`"D@;
 7C B H5 7HG` \$`±B 7 <9G
 ; C @8 D@5HB;
 △

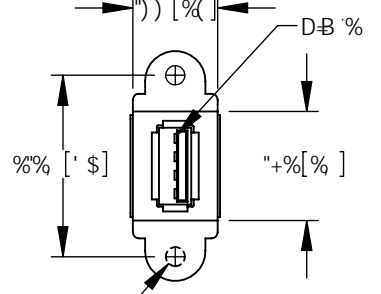
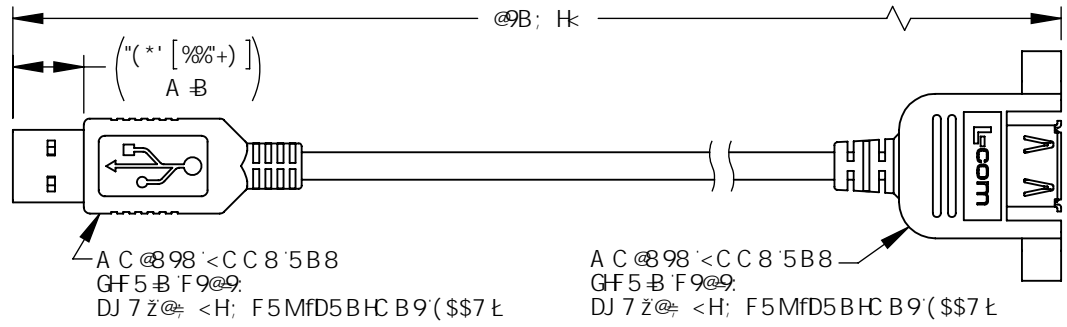

&L ž (! \$1 B 7 I &6
 H: F 95 8 98`B G9F H
 f9A 698 8 98 Ł
 D9A`"G P 6 ! ((\$! ("
 C F 9E I J 5 @B H

">%"
 I G6`G9F 9G`5`"F 97 9DH5 7 @
 D5B9@A C I B H
 7C B H5 7HG` \$`±B 7 <9G
 ; C @8 D@5HB;
 △

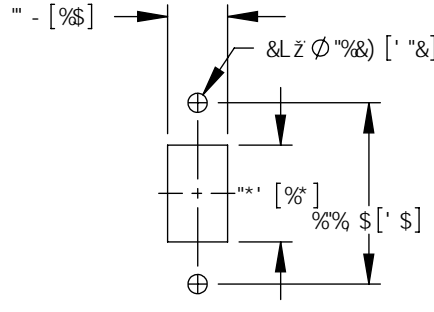

F97 C A A 9B 8 98
 D5B9@71 HC I H

A C 89@ B I A 69F	@9B; Hk A 9H PFG O 99H Q
I DA 55!\$`A	\$"" O: , Q
I DA 55!\$)A	\$") O%*(Q
I DA 55!\$+)A	\$"+) Q&(* Q
I DA 55!\$%A	%\$`O "& , Q
I DA 55!&A	&`\$`O") * Q
I DA 55!`A	` "\$`O", (Q
I DA 55!(A	(" \$`O "%&Q
I DA 55!)A) "\$`O * "(Q

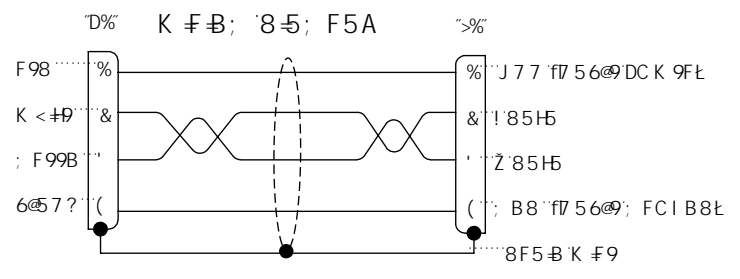

5

BC H9G
 %"" 7 5 6 @ 5 G9A 6 @ M G < 5 @ @ < 5 J 9` * \$ \$ G < 9 @ 8` H9FA` B 5 HC B`
 &"" 7 5 6 @ 5 G9A 6 @ M G < 5 @ @ A 99H I G6` &` \$` F 9E I` # 9A 9B HC`
 '"" 7 5 6 @ 5 G9A 6 @ M G < 5 @ @ 69` H9G H98 : C F` 7 C B H B I` # M
 (" " A C I B H B ;` < 5 F 8 K 5 F 9` B 7 @ 8 98 . & L` . (! (\$` L` "" , @` " " D < @ @ D G < 8` G 7 F 9 K
) "" 7 5 6 @ 5 G9A 6 @ M G < 5 @ @ 69` B 8 J` # I 5 @ M D 5 7 ? 5 ; 98` B
 "" " 5 7 7 C F 8 5 B 7 9 K` # K` @ 7 C A` G D 97 ÷ 7 5 H C B` D G ` \$ \$` %`

I B @9GC H: 9F K @9 D97 ÷ 982 8 A 9B GC B G 5 F 9 B` B 7 < 9G Q a a Q C J 9 F 5 @ 7 5 6 @ 9 @ 9 B: H: H C @ 9 F 5 B 7 9 . @ & O S) O I 2 % Q) O # I \$ 2 % & O S) O @ 5 O @ & (O I 2 & O % O # I \$ 2 % S O @ & O % @ S O S (O I 2 (O @ S O # I \$ 2 % S O S (O @ S S O` 85 O I 2` O @ 8 O # I \$ 2 % S O` 85 O I 2) # I \$	5DDFCJ 5@G 85F5K B @M B` F G 9 @ C 7< 97 798 @M 5DDFCJ 98 @M GGA # :	85H9 (# % # . (# % # . (# % # .	Global Connectivity () 6997 < K C C 8 8 F # 9 B C F H: 5 B B C J 9 F Z A 5 \$ % ()
5 @ C H: 9 F 8 A 9 B G C B 5 @ H C @ F 5 B 7 9 G L 1 -` & L L 1 -` \$ & L L L 1 -` \$ \$	7 C B : = I F 5 H C B 8 9 F 5 @ G C : I B 8 A 9 B G C B 9 8 : 9 5 H F 9 G A 5 M J 5 F M	75H9: CFM I G6	DFC 81 7 H 8 9 7 F-DHC B I G6` 5` D@ ;` HC` 5` F 97 9DHDB @A H H: K F 8
DFC > 97 HC B 	7 C @ F J 5 F 5 H C B G A 5 M C 7 7 I F	G 9 J 5 (' & % I DA 55 <	G 7 5 @ 9 . B C B 9 7 5 8 : @ 9 : " I DA 55` O @ 8 8 F K G< 99H % C : %

6

5

7

6

8

8