

THIS DRAWING IS UNPUBLISHED
 VERTRAULICHE UNVEROFFENTLICHTE ZEICHNUNG
 © COPYRIGHT 2009 Tyco Electronics AMP GmbH
 RELEASED FOR PUBLICATION
 FREI FUER VEROFFENTLICHUNG
 29.Oct. 2009
 ALL RIGHTS RESERVED.
 ALLE RECHTE VORBEHALTEN.

LOC	DIST	REVISIONS AENDERUNGEN					
AI	-	P	LTR	DESCRIPTION BESCHREIBUNG	DATE	DWN	APVD
PROJEKT NR.:			C1	OUTLINE OF SEALING CHANGED	11DEC2012	KHH	PK

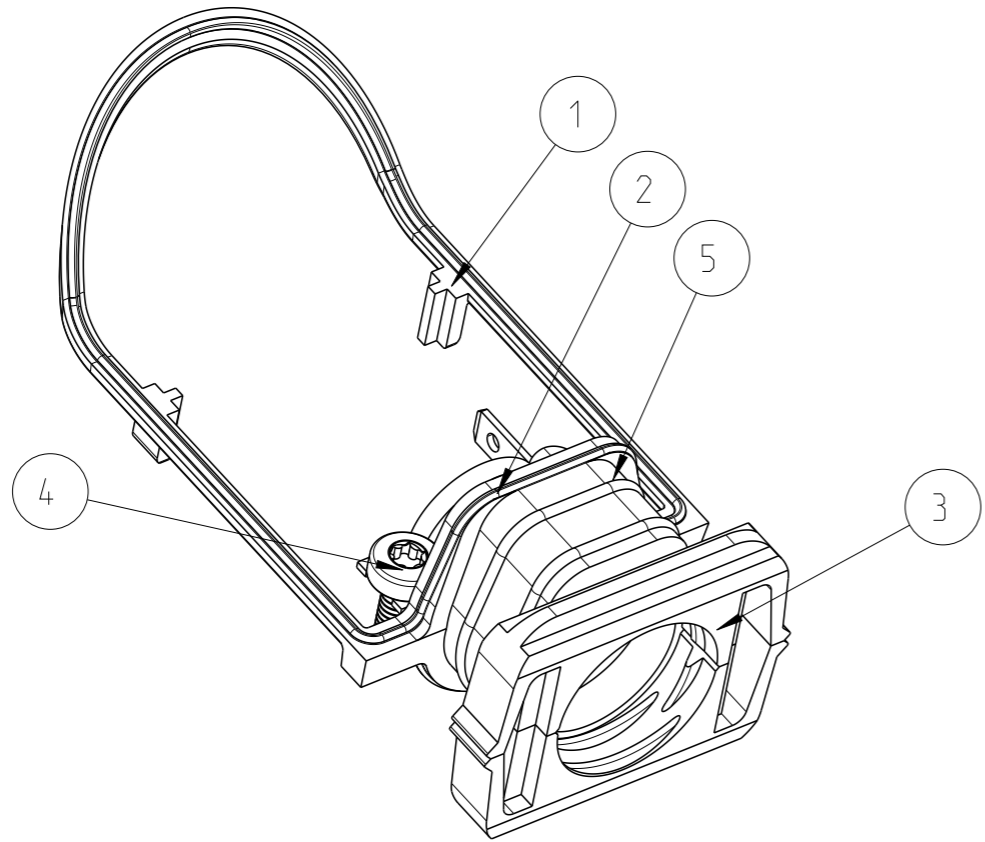

Notes

- 1 SUITABLE HOUSINGS: SERIES HC26
CUSTOMER DRAWING: 1103439, 1103440, 1103467, 1103470
- 2 STANDARDS:
DIN EN 61984, DIN EN 60664-1
- 3 PACKAGING:
40 SETS IN A CARTON
- 4 WIRE SIZE 12.0-12.5

PN/QTY	DESCRIPTION	MATERIAL	SURFACE/COLOR	NOTE	ITEM
- 2	SCREW FOR PLASTICS	STEEL	ZINC PLATED	WN5452, 10IP 2.5x8	5
2 -	SCREW FOR METAL	STEEL	ZINC PLATED	WN5152, 8IP2,5x8	4
2 2	STRAIN RELIEF	PBT-GF10	BLUE	SERIES HC26, WIRE SIZE 13MM	3
1 1	SCREEN TERMINATION	COPPER ALLOY	TIN PLATED	SERIES HC26, CONN. HSG.	2
1 1	SEALING	FKM 70	GREY	SERIES HC26, CIRC., HSG., WIRE SIZE 11.5-12MM	1

PARTS LIST

DIESE ZEICHNUNG IST EIN KONTROLLIERTES DOKUMENT. BEMASSUNGEN UND TOLERANZEN GEMAESS GPS (ISO STANDARDS).		TOLERANCING ISO 8015 TOLERIERUNG ISO 8015	
THIS DRAWING IS A CONTROLLED DOCUMENT. DIMENSIONING AND TOLERANCING PER GPS (ISO STANDARDS).		TE Connectivity	
DIMENSIONS: MASSEINHEITEN: MM 		STE TE Connectivity ACCESSORY KIT SERIES HC26 POWER 4 NET	
TOLERANCES UNLESS OTHERWISE SPECIFIED: ALLGEMEINTOLERANZEN 0 PLC ±- 1 PLC ±- 2 PLC ±- 3 PLC ±- 4 PLC ±- ANGLES/WINKEL ±1° FINISH/OBERFLAECHE/FARBE -		DWN 29OCT2009 R.SCHNEIDER CHK 29OCT2009 T.VETTER APVD 29OCT2009 T.SCHNURPFIL PRODUCT SPEC PRODUKTSPEZ. 108-74097 APPLICATION SPEC VERARBEITUNGSSPEZ. 114-74103 WEIGHT GEWICHT -	
MATERIAL -		SIZE A3	CAGE CODE 00779
		DRAWING NO. ZEICHNUNGS-NR. C=1103483	RESTRICTED TO NUR FUER -
Customer Drawing		/KUNDENZEICHNUNG	SCALE MASSSTAB 2:1
		SHEET BLATT 1 OF VON 1	REV C1