

DASH NO.	M CODE	MADE FROM
----------	--------	-----------

GSD

1075-1

REVISIONS

ISSUE	CHANGES
10	CN 39452 E DCT 5/4/6
11	CN 39620 A DCT 9/13/6

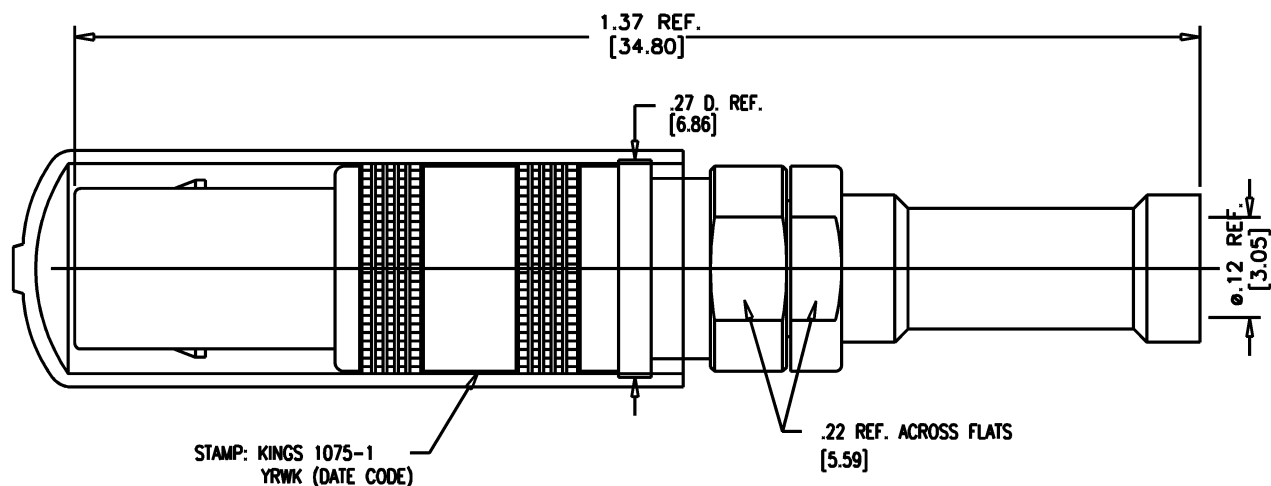

NOTES:

- FOR USE WITH M17/119-RG174, M17/094-RG179 & M17/113-RG316 CABLE.
- FOR CABLING INSTRUCTIONS SEE CP-459.
- FOR CRIMPING USE DIE KTH-2082.
- CONTACT MAY BE CRIMPED ON M17/119-RG174 & M17/113-RG316 CABLES, BUT MUST BE SOLDERED ON BALANCE OF CABLE GROUP.
- MATERIALS:
INSULATORS: TEFLON, ASTM-D4894
K-GRIP SLEEVE: COM. BRONZE, ASTM-B140
K-LOC BODY: BER. COPPER, ASTM-B-196
ALL OTHER METAL PARTS: BRASS, ASTM-B16
- FINISHES:
CENTER CONTACT: HARD GOLD PLATE, PER ASTM-B488
ALL OTHER METAL PARTS: NICKEL
- ELECTRICAL CHARACTERISTICS:
NOMINAL IMPEDANCE: 50 OHMS
WORKING VOLTAGE: 500 VRMS
- DIMENSIONS IN INCHES [MM].

SCALE 6:1	
APPROX SURFACE AREA	
USED ON	
REF:	
PLUG, K-LOC	
DRAWN DCT	DATE 4/26/6
DESIGN MJB	DATE 04/22/91
APPR.	DATE

KINGS
ELECTRONICS CO., INC.
ROCK HILL, SOUTH CAROLINA 29730

1075-1

GSD