



DOUGHTY ENGINEERING LTD

# DATA SHEET

**TITLE:**  
TOUGHBOX WITH 6 X 15A  
CONNECTORS

**PART NOS:**  
T78235

**MATERIAL:**  
MILD STEEL

**WEIGHT:**

**SWL:**  
N/A

**FINISH:**  
SATIN BLACK POWDER PAINT

**NOTES:**  
  
OTHER VARIANTS AVAILABLE

**STRICTLY  
FOR  
REFERENCE  
PURPOSES  
ONLY**



THIRD ANGLE PROJECTION

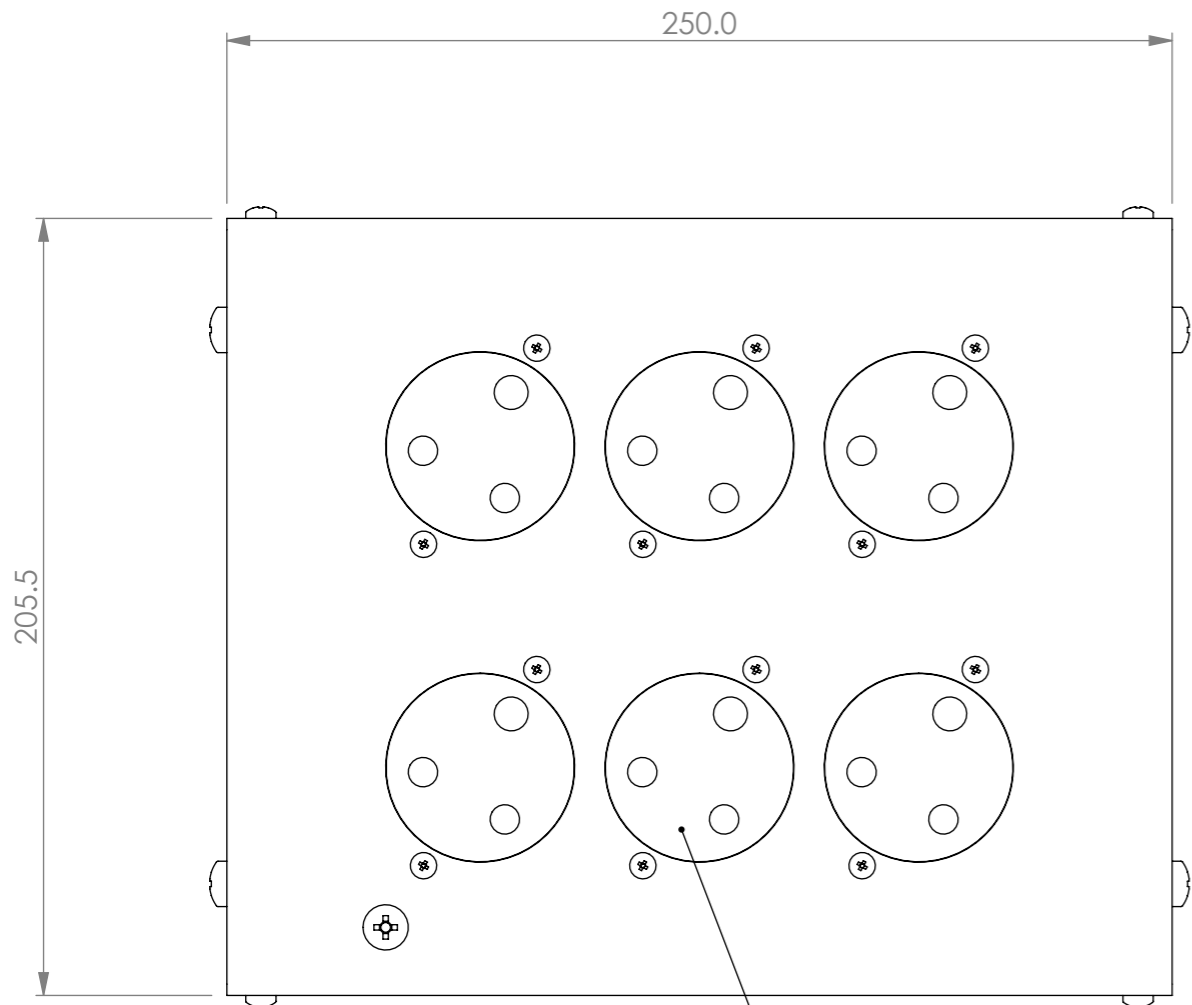

SOCKET INSERT 15A  
IN 6 POSNS.

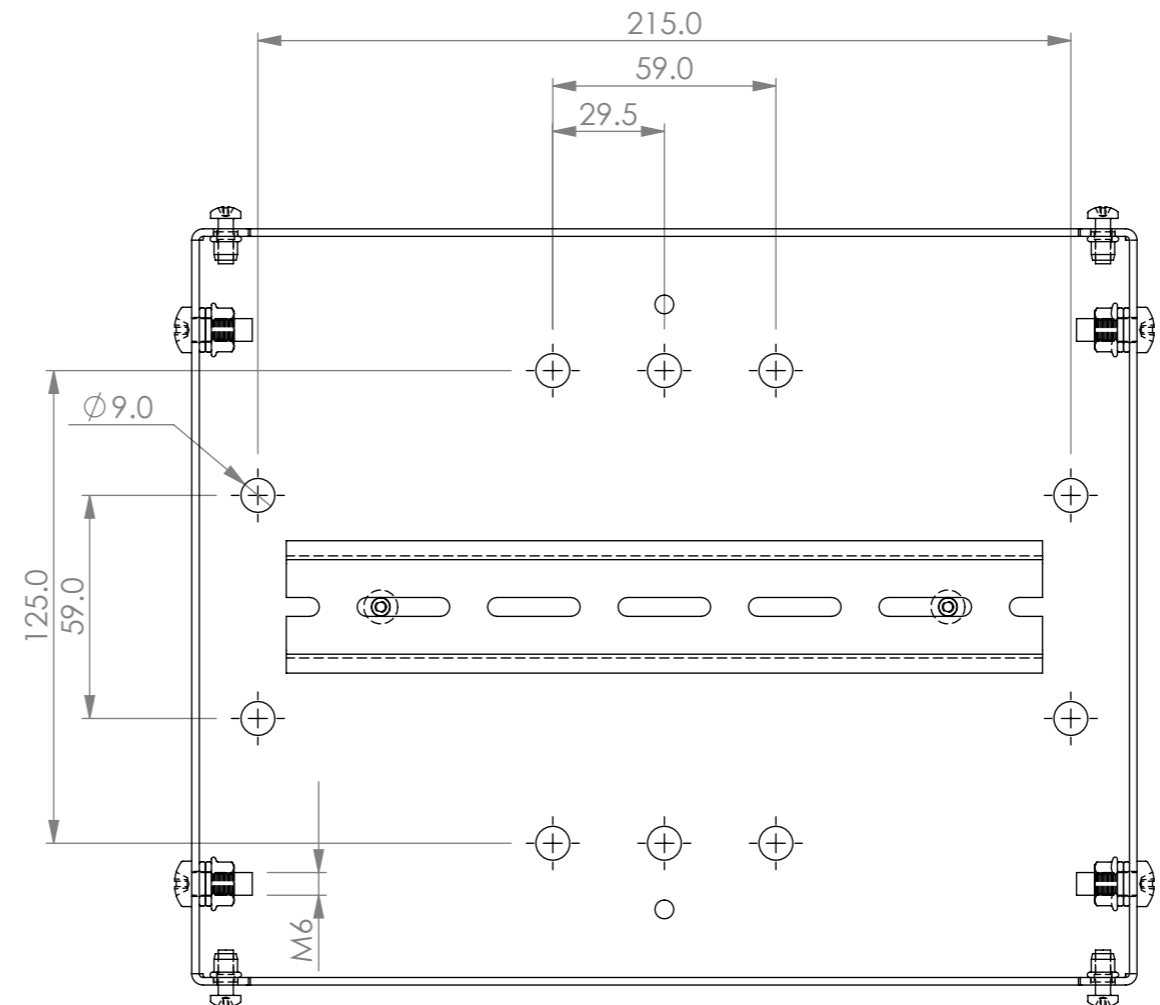

LID REMOVED

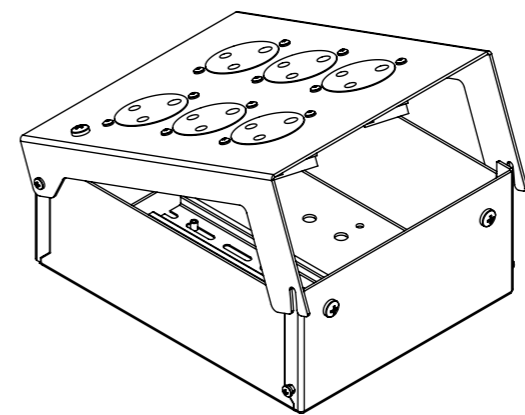
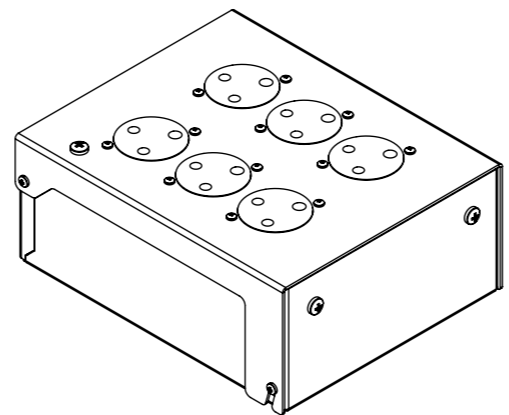
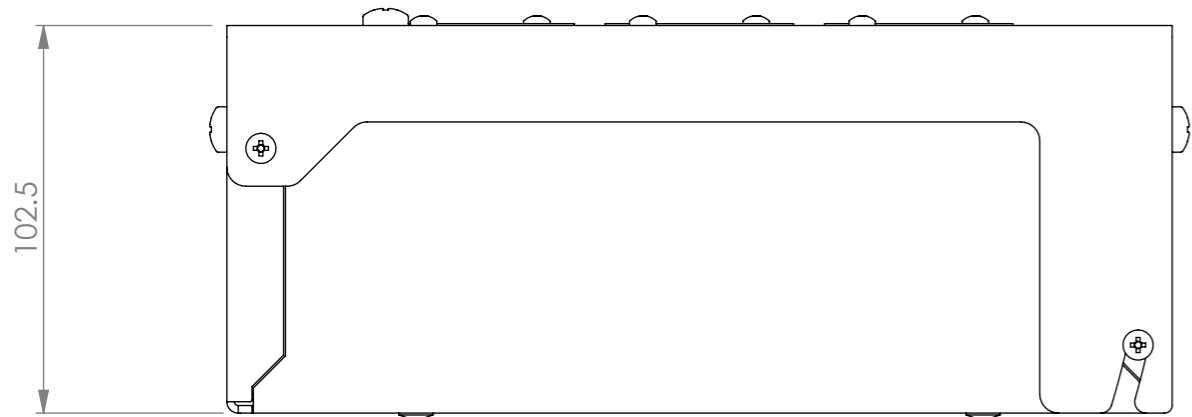

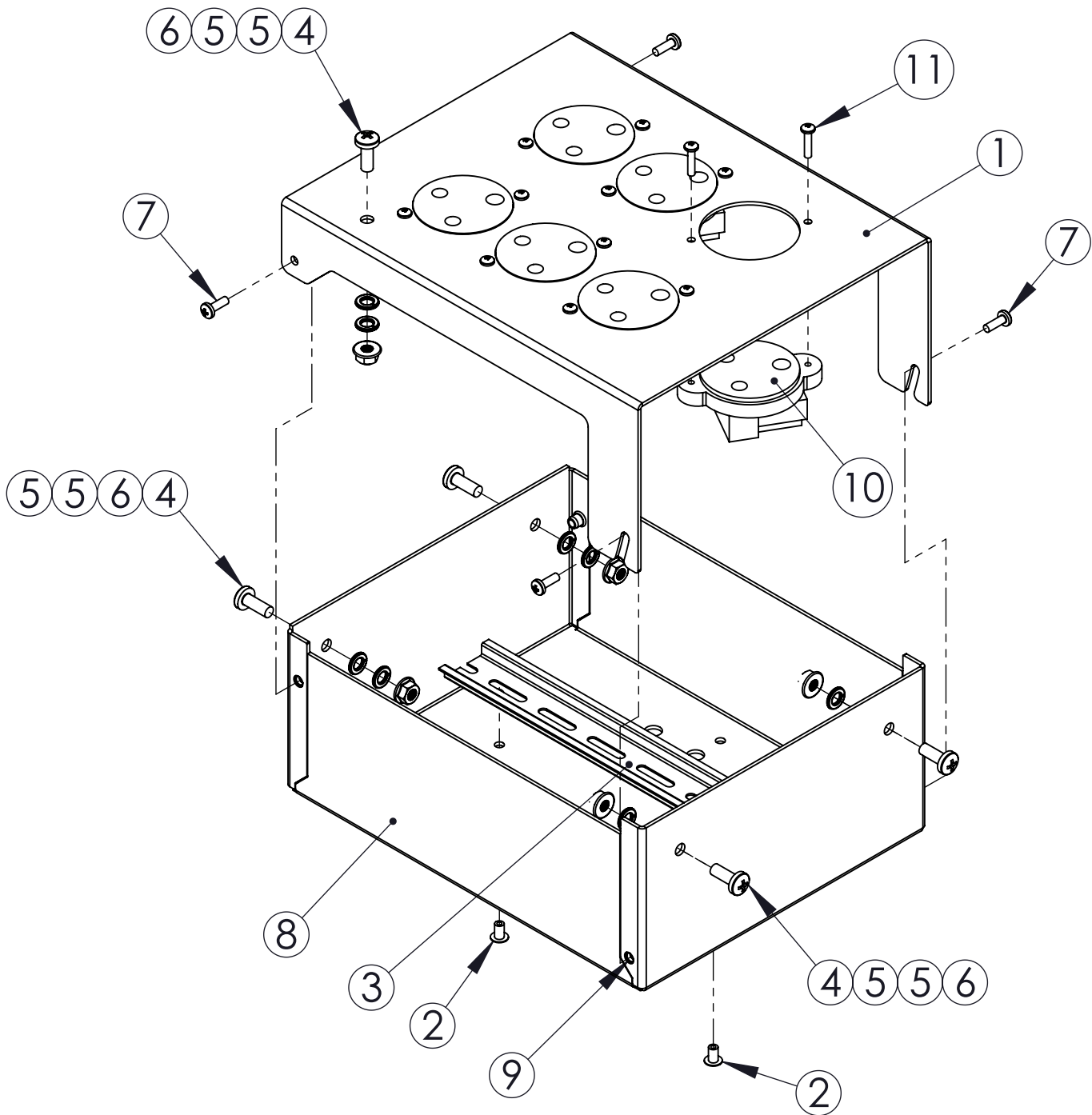

ITEM NO.	PART NUMBER	DESCRIPTION	QTY
1	T78215	ENCLOSURE LID WITH 6 X 15A CUT-OUTS	1
2	F2005	4.8 X 8 ALUMINIUM RIVET	2
3	TH2400	35MM DIN RAIL 200MM LG	1
4	F592	M6 X 16 SCREW PAN HD POZI ZINC & B	5
5	F900	M6 SPRING WASHER BZP	10
6	F598	M6 FLANGED NUT BZP	5
7	F731	SCREW M4 X 12 PAN HD POZI ZINC & B	4
8	T78200	TERMINAL BOX BODY	1
9	F3008	RIV-NUT M4	4
10	S2719	SOCKET INSERT 15A	6
11	F3019	M3.5 X 16 SCREW PAN POZI ZINC & B	12

T78235

## TOUGHBOX WITH 6 X 15A CONNECTORS



NOT TO SCALE

DRAWN

AW

DATE

06/11/2013

Rev

2