

THIS DRAWING IS UNPUBLISHED. RELEASED FOR PUBLICATION FEB ,2006.

© COPYRIGHT 2006 By - ALL RIGHTS RESERVED.

LOC	DIST	REVISIONS					
E	B	P	LTR	DESCRIPTION	DATE	DWN	APVD
		D		ECO-14-000688	31JUL2014	RZ	MY

- NOTES:**
- 1 PACKAGE ONE COMPLETE CONNECTOR IN HEAT SEALED, LABELED BAG/ 500 PER SHIPPING BOX. LABELED PER TEC-107-115
  - 2 100 TRAY PACK IN ACCORDANCE WITH AMP SPEC 107-3275
  - 3 Au PLATING
  - 4 HAND TOOL : 9-1478240-0
  - 5 DIE SET : 9-1478248-0
  - 6 ELECTRICAL CHARACTERISTICS  
 FREQUENCY RANGE: DC - 6 GHz  
 NOMINAL IMPEDANCE: 50 Ohm  
 INSULATION RESISTANCE: 1000 MOhm  
 WORKING VOLTAGE: 335 Volts RMS at Sea Level  
 DIELECTRIC WITHSTAND VOLTAGE: 1000 Volts RMS Max  
 CONTACT RESISTANCE:  
   CENTRE CONTACT: 5.00 mOhm Max  
   OUTER CONTACT: 2.50 mOhm Max  
 VSWR @ 4GHz: 1.63:1 Max  
 INSERTION LOSS dB @ x 1.0 GHz: 0.20 Max
  - 7 MECHANICAL CHARACTERISTICS  
 CABLE RETENTION FORCE: 32N Min  
 "RG178B/U, 196A/U:"  
 DURABILITY: 500 Cycles Min
  - 8 ENVIRONMENTAL CHARACTERISTICS  
 OPERATING TEMPERATURE: -65 to +165 DegC
  - 9 FOR TECHNICAL DATA REFER TO YOUR LOCAL TE CONNECTIVITY SALES OFFICE
  - 10 ALL DIMENSIONS ARE NOMINAL FOR REFERENCE ONLY UNLESS OTHERWISE STATED

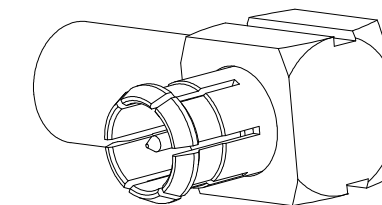

SCALE: NTS

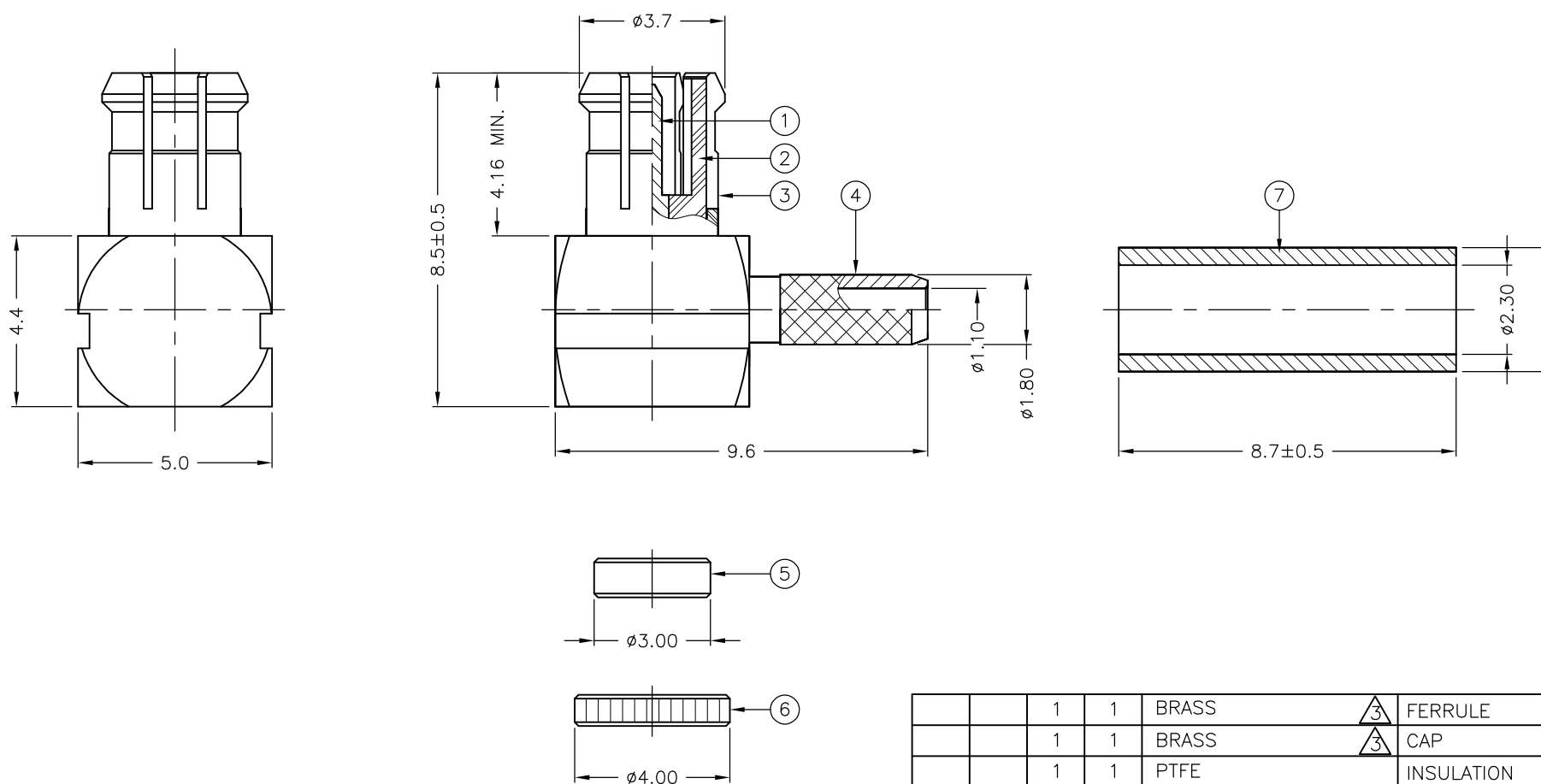

QTY	UNIT	MATERIAL	DESCRIPTION	ITEM	
1	1	BRASS	FERRULE	7	
1	1	BRASS	CAP	6	
1	1	PTFE	INSULATION	5	
1	1	BRASS	BODY II	4	
1	1	BERYLLIUM COPPER	BODY I	3	
1	1	PTFE	INSULATION	2	
1	1	BRASS	CONTACT	1	
6--0	1--0		MATERIAL	DESCRIPTION	ITEM
QUANTITY PER ASSY		PARTS LIST			

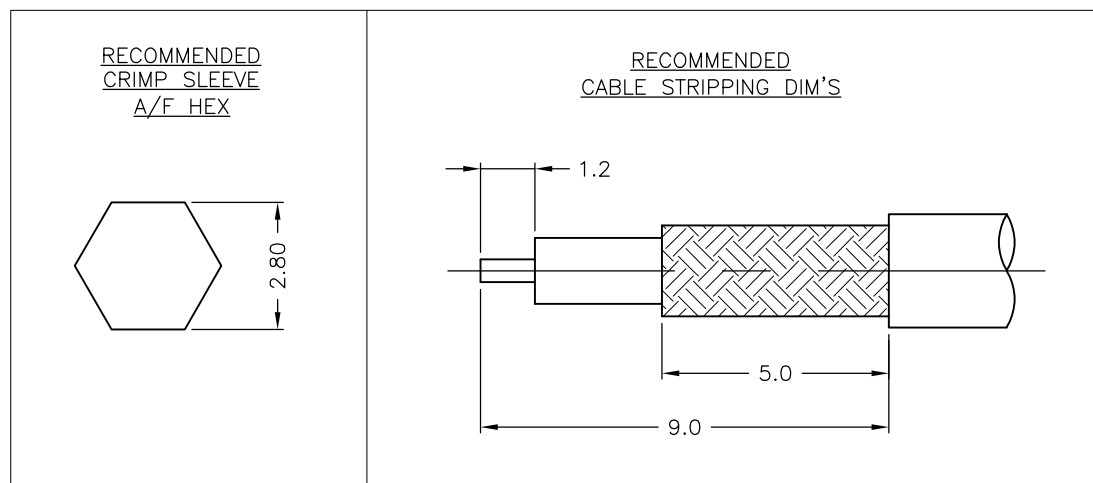

THIS DRAWING IS A CONTROLLED DOCUMENT.

DIMENSIONS: mm	TOLERANCES UNLESS OTHERWISE SPECIFIED:	DWN J.SANDWELL 06FEB06	 TE Connectivity MCX ELBOW PLUG CRIMP 50 OHM RG178B/U, 196A/U, URM110
	0 PLC ± -	CHK S.PARLOW 06FEB06	
	1 PLC ± 0.2	APVD F.WHEELER-KING 06FEB06	
	2 PLC ± 0.1	PRODUCT SPEC 108-3640	
	3 PLC ± -	APPLICATION SPEC 411-3251	SIZE A3
	4 PLC ± -	WEIGHT -	CAGE CODE 00779
	ANGLES ± -		DRAWING NO C-1337584
MATERIAL SEE TABLE	FINISH -		RESTRICTED TO -
		CUSTOMER DRAWING	SCALE NTS
			SHEET 1 OF 1
			REV D