

PRODUCT NUMBER	PLATING OPT.	HSG FRAME COLOR
10112634-101	OPTION 1	BLACK
10112634-101LF	OPTION 2	BLACK
10112634-121	OPTION 1	NATURAL
10112634-121LF	OPTION 2	NATURAL

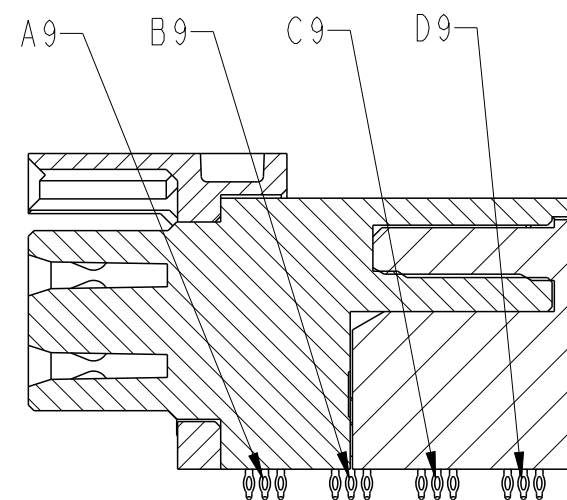

SECTION Z-Z

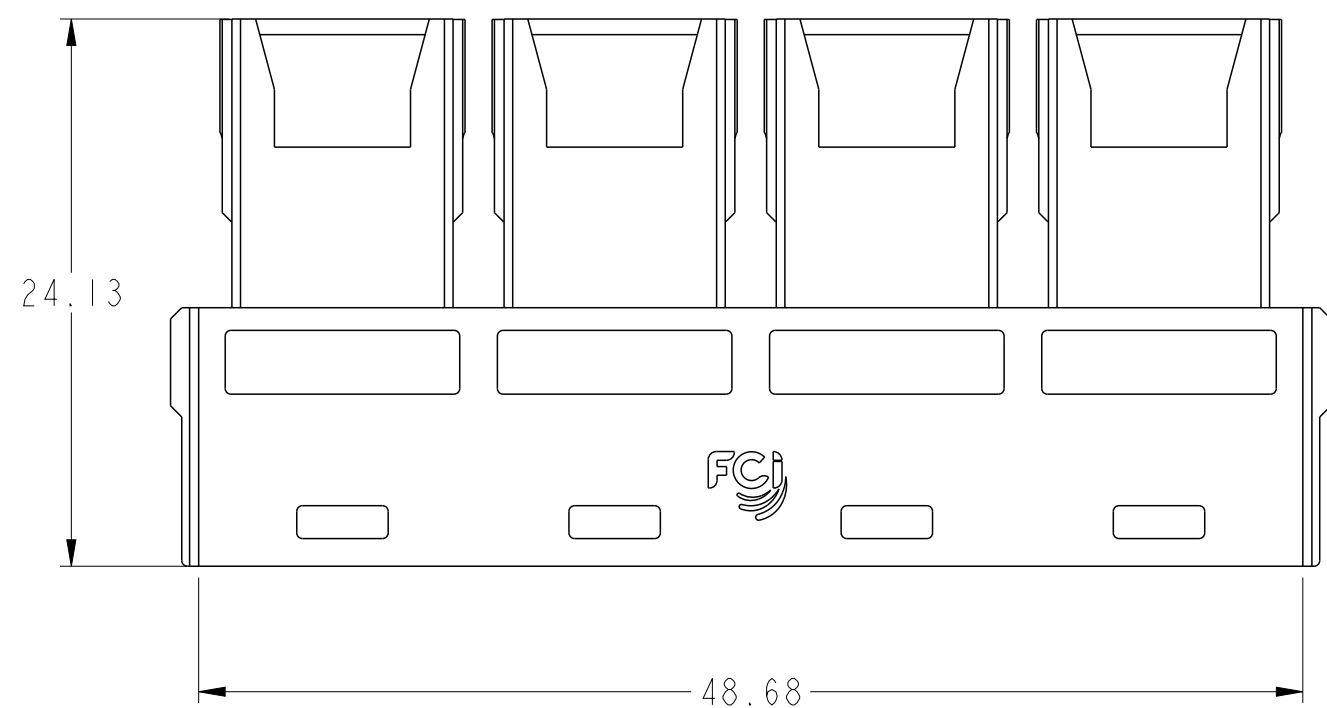
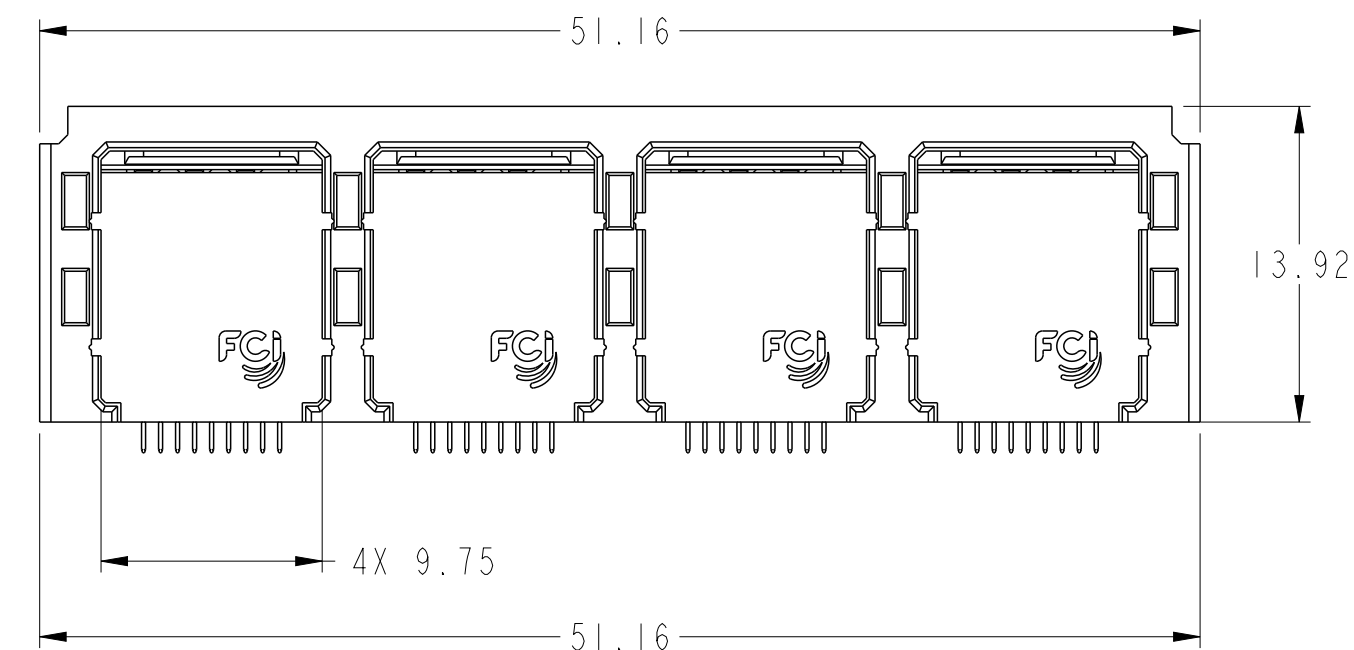
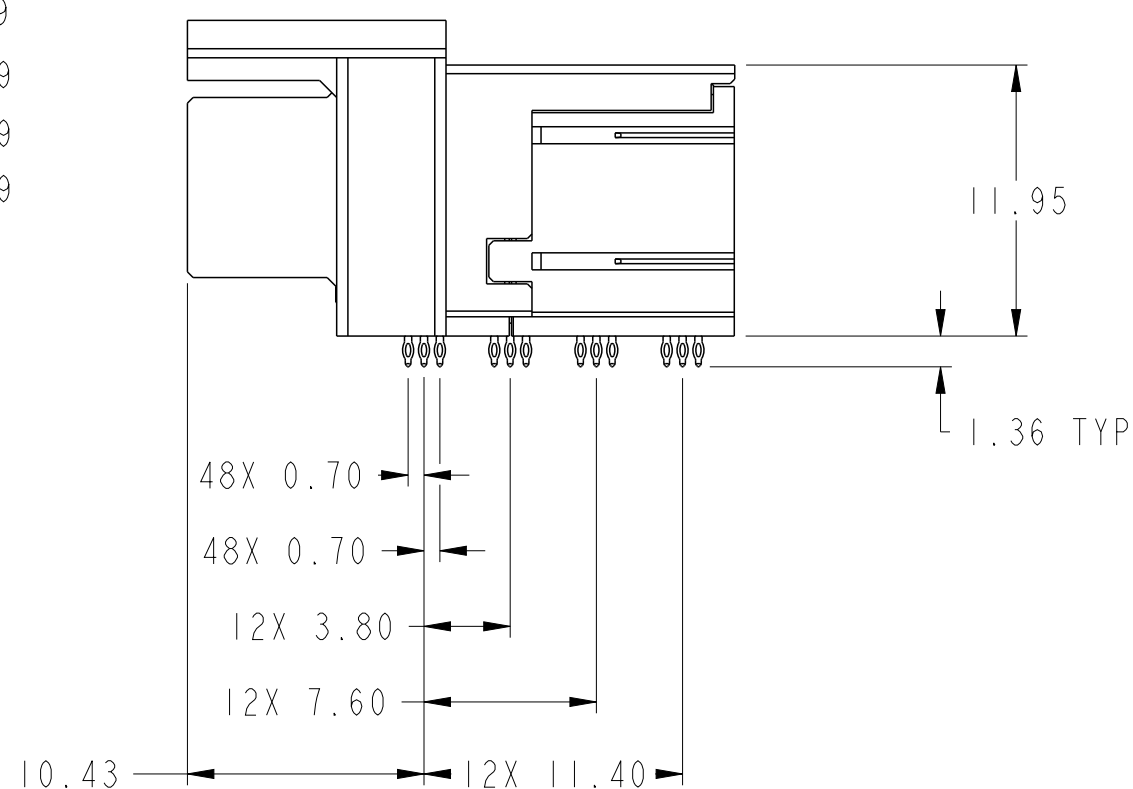
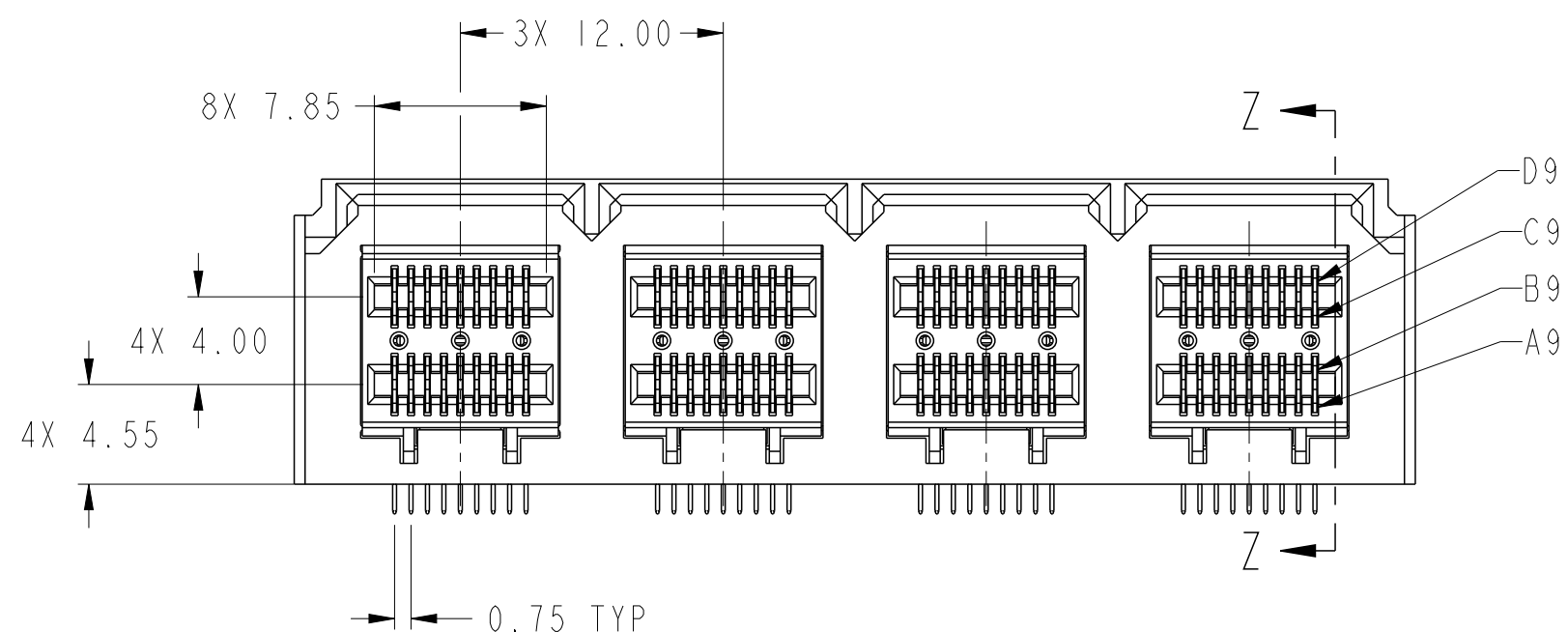
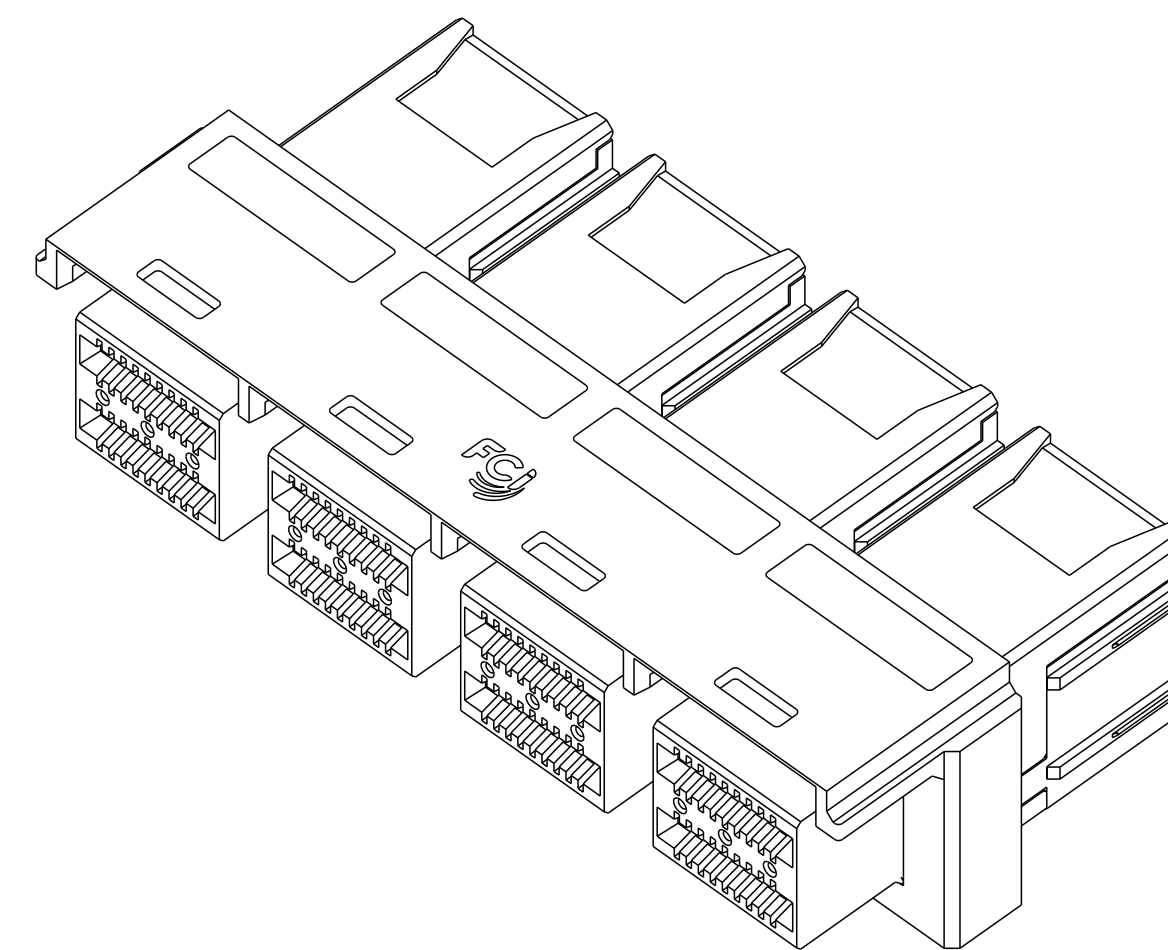

NOTES:

- MATERIALS:
CONNECTOR HOUSING: HIGH TEMPERATURE THERMOPLASTIC GLASS FILLED, UL 94V-0
TERMINALS: COPPER ALLOY
- FINISHES:
CONTACT AREA: 0.76µm GOLD OVER 2.54µm MIN NICKEL
TAIL AREA:
OPTION 1: 0.76µm - 1.52µm TIN/LEAD (90/10) OVER 2.54µm MIN NICKEL.
OPTION 2: 0.76µm - 1.52µm TIN (LEAD FREE) OVER 2.54µm MIN NICKEL.
- PRODUCT SPECIFICATION: GS-12-650.
APPLICATION SPECIFICATION: GS-20-0356
- MOUNTING HARDWARE: M2 X 0.4 SELF-THREADING SCREW
MOUNTING SCREW LENGTH: PCB THICKNESS + 2.5mm MAX.
- THIS CONNECTOR IS DESIGNED TO MEET THE REQUIREMENTS OF INDUSTRY SPECIFICATION SFF-8643.
- A SYMBOL WILL BE NEXT TO ANY DIMENSION, VIEW, OR NOTE THAT HAS BEEN MODIFIED WITH THE CURRENT DRAWING REVISION.

MATES WITH MINI-SAS HD ENDS IN:
10119217 SERIES (4i)
10119312 SERIES (4i)
10120086 SERIES (4i)
10120087 SERIES (4i)
10119576 SERIES (8i)
10119577 SERIES (8i)
10120088 SERIES (8i)
10120089 SERIES (8i)

spec ref	-	dr	Mark Gray	2010/08/04	projection	MM	size	A2	scale	3:1												
tolerance std	ASME Y14.5	eng	Andy Lu	2014/04/13			ecn no	ELX-DG-17441-1														
TOLERANCES UNLESS OTHERWISE SPECIFIED		chr	-	rel level				Released														
surface	<table border="1"> <tr> <td>linear</td> <td>0.X</td> <td>±0.25</td> </tr> <tr> <td></td> <td>0.XX</td> <td>±0.13</td> </tr> <tr> <td></td> <td>0.XXX</td> <td>±</td> </tr> <tr> <td>angular</td> <td>0°</td> <td>±1/2°</td> </tr> </table>	linear	0.X	±0.25		0.XX	±0.13		0.XXX	±	angular	0°	±1/2°	appr	Pei-Ming Zheng	2014/04/14	product family	MINI-SAS HD	cat. no.	10112634	rev	B
linear	0.X	±0.25																				
	0.XX	±0.13																				
	0.XXX	±																				
angular	0°	±1/2°																				
www.fci.com		Product - Customer Drw		sheet 1 of 4																		



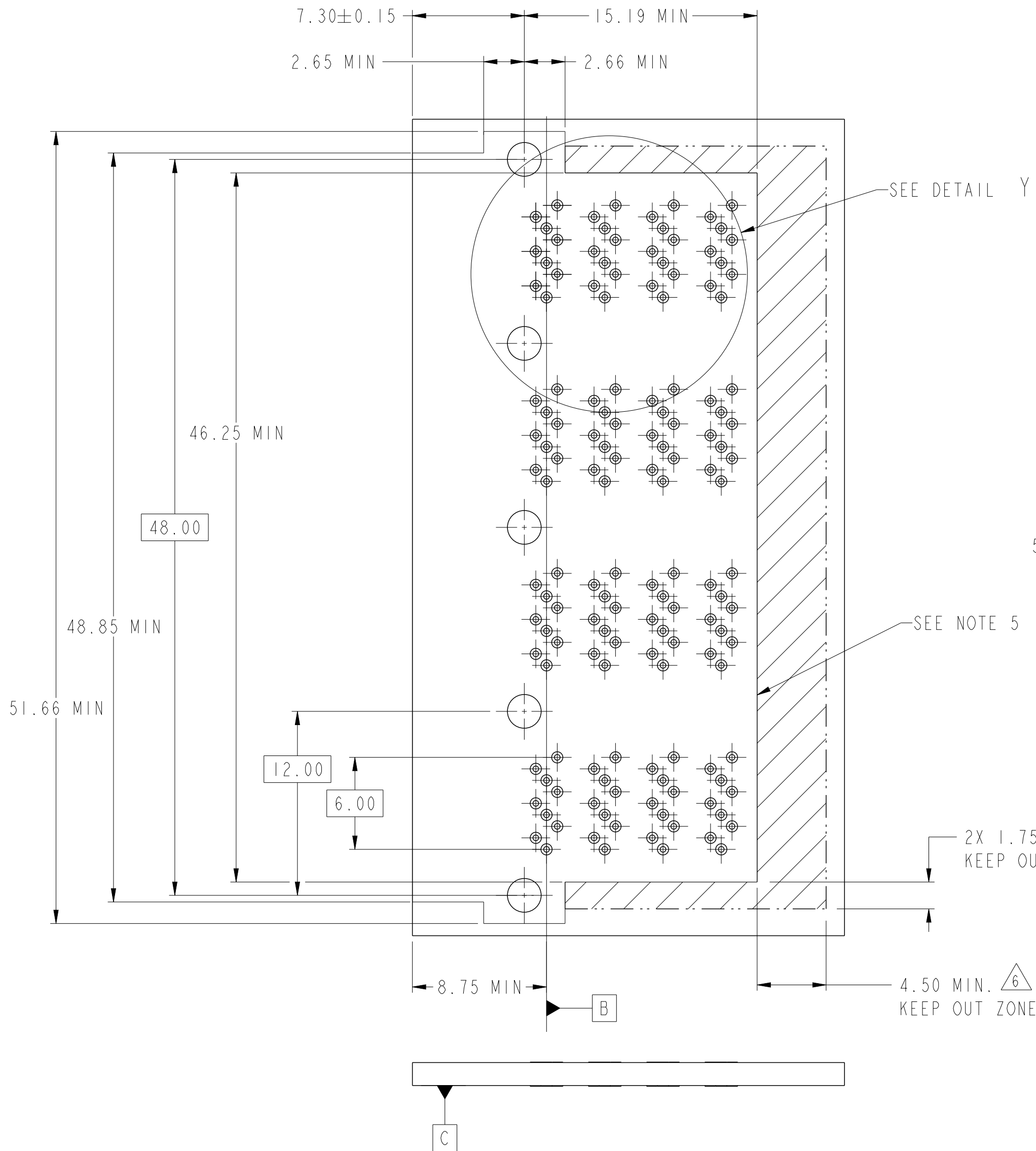

RECOMMENDED BOARD LAYOUT

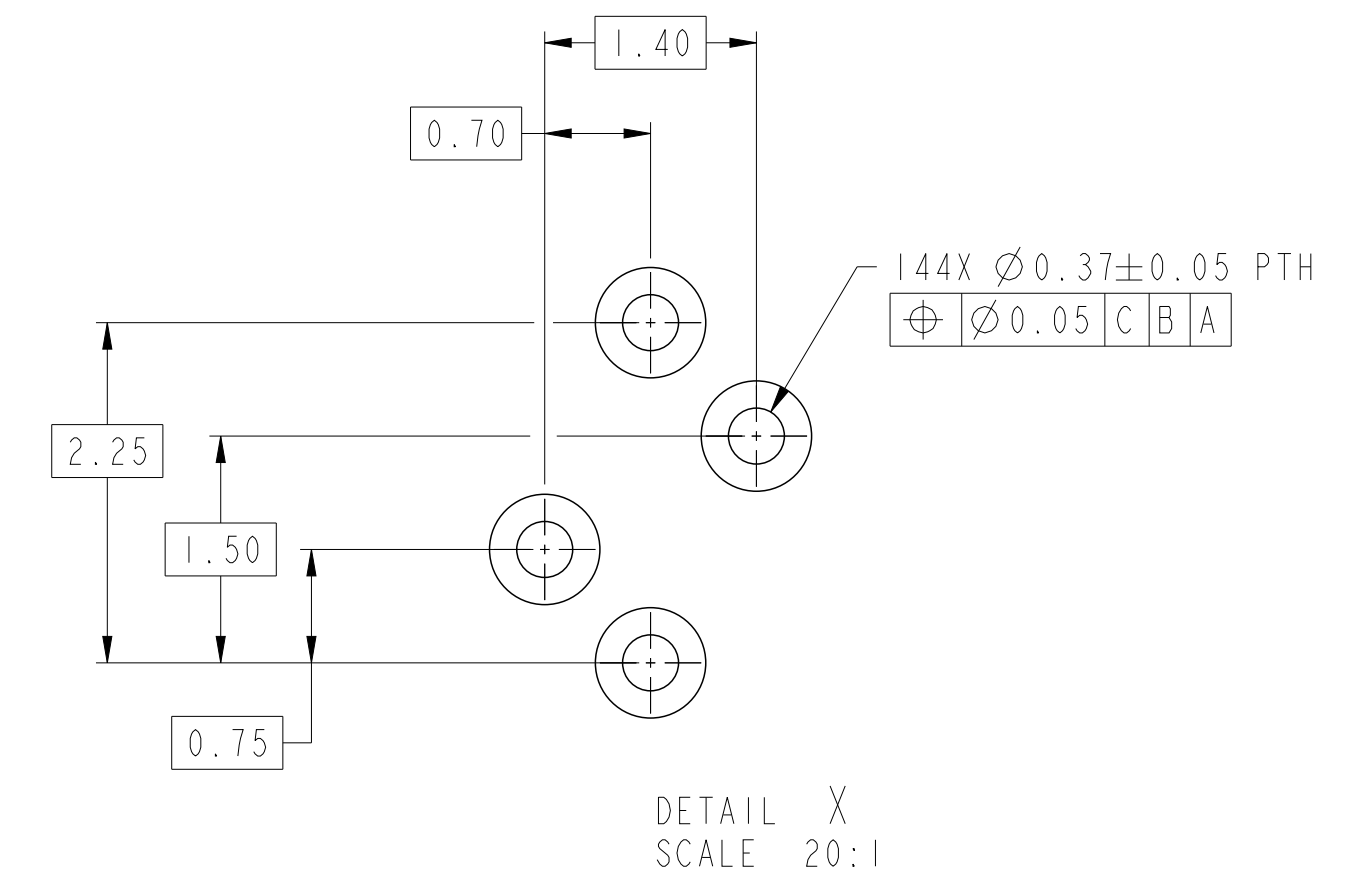
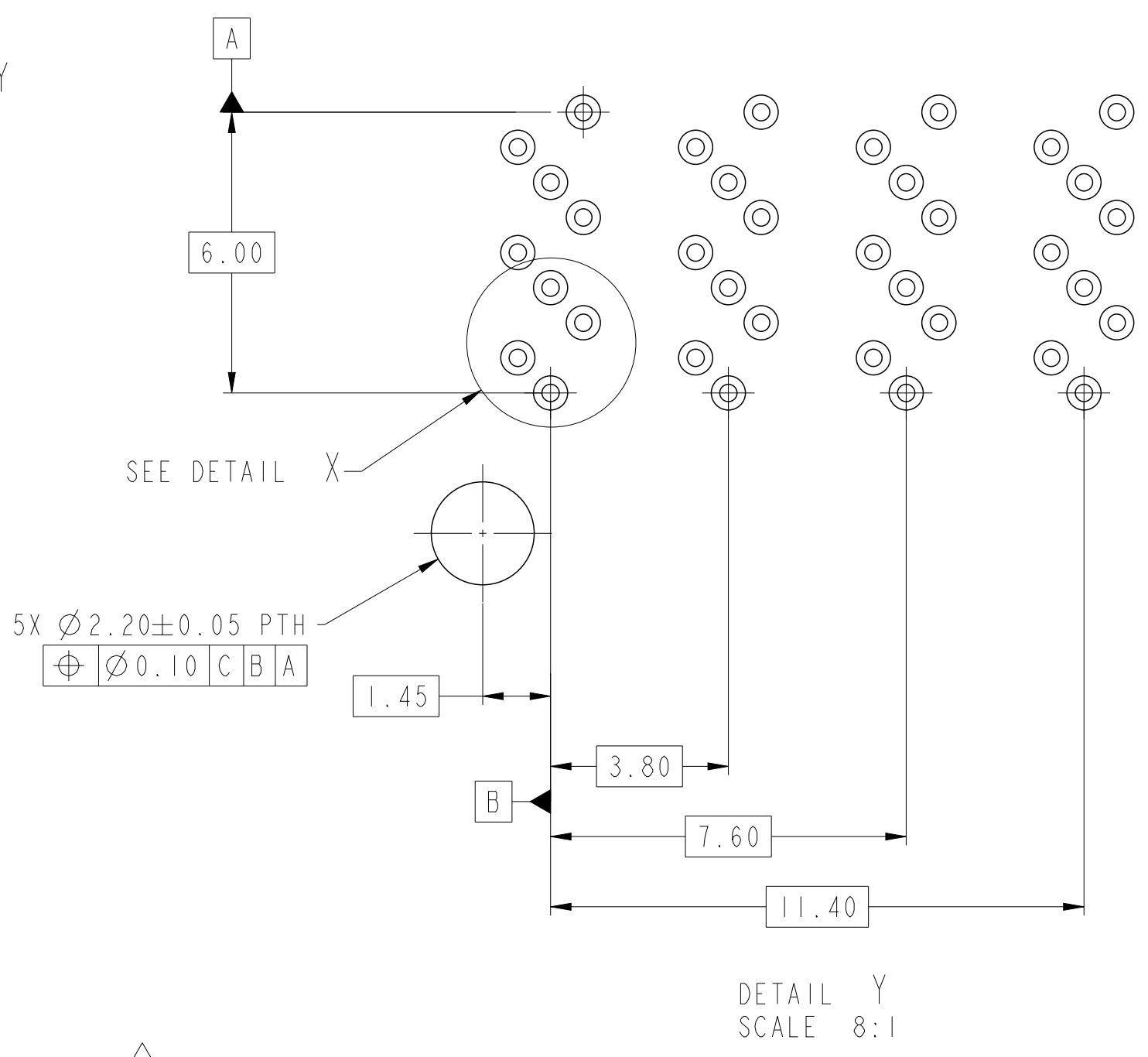

- NOTES:**
1. RECOMMENDED DRILL SIZE FOR A Ø0.37 FINISHED PTH IS Ø0.457 (#77 DRILL).
 2. RECOMMENDED ANNULAR RING AROUND Ø0.37 FINISHED PTH IS Ø0.73.
 3. MINIMUM RECOMMENDED SPACING : 14.00mm.
 4. MINIMUM PCB THICKNESS : 1.57mm.
 5. CONNECTOR KEEP OUT AREA.

spec ref	-	dr	Mark Gray	2010/08/04	projection	MM	size	A2	scale	2:1
tolerance std	ASME Y14.5	eng	Andy Lu	2014/04/13	chr	-	ecn no	ELX-DG-17441-1	rel level	Released
surface	✓	appr	Pei-Ming Zheng	2014/04/14	product family	MINI-SAS HD	cat. no.	10112634	rev	B
ASME Y14.5	linear	0.X	±0.25	FCI	www.fci.com	cat. no.	Product - Customer Drw	sheet 2 of 4		
	0.XX	±0.13								
	0.XXX	±								
	angular	0°	±1/2°							

Copyright FCI. FCI

PIN OUT DESIGNATIONS

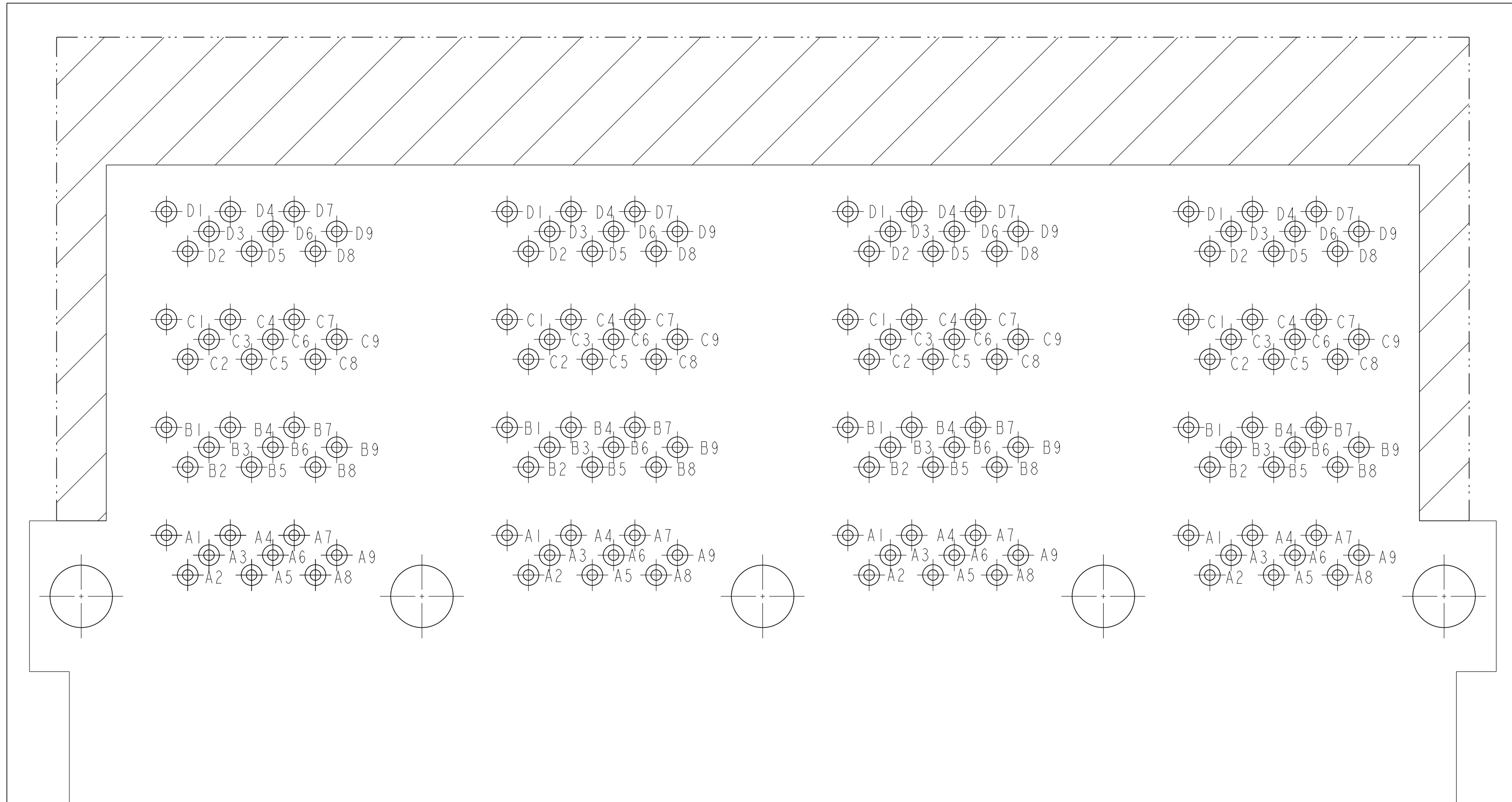

spec ref	-	dr	Mark Gray	2010/08/04	projection	MM	size	A2	scale	2:1	
tolerance std	ASME Y14.5	eng	Andy Lu	2014/04/13			ecn no	ELX-DG-17441-1			
TOLERANCES UNLESS OTHERWISE SPECIFIED		chr	-	rel level				Released			
surface	✓	appr	Pei-Ming Zheng	2014/04/14	product family	MINI-SAS HD	dwg no	10112634		rev	B
ASME Y14.5	angular	0°	±1/2°	www.fci.com	cat. no.	-	Product - Customer Drw	sheet 3 of 4			

PDS: Rev :B

STATUS:Released

Printed: Apr 14, 2014



Copyright FCI.

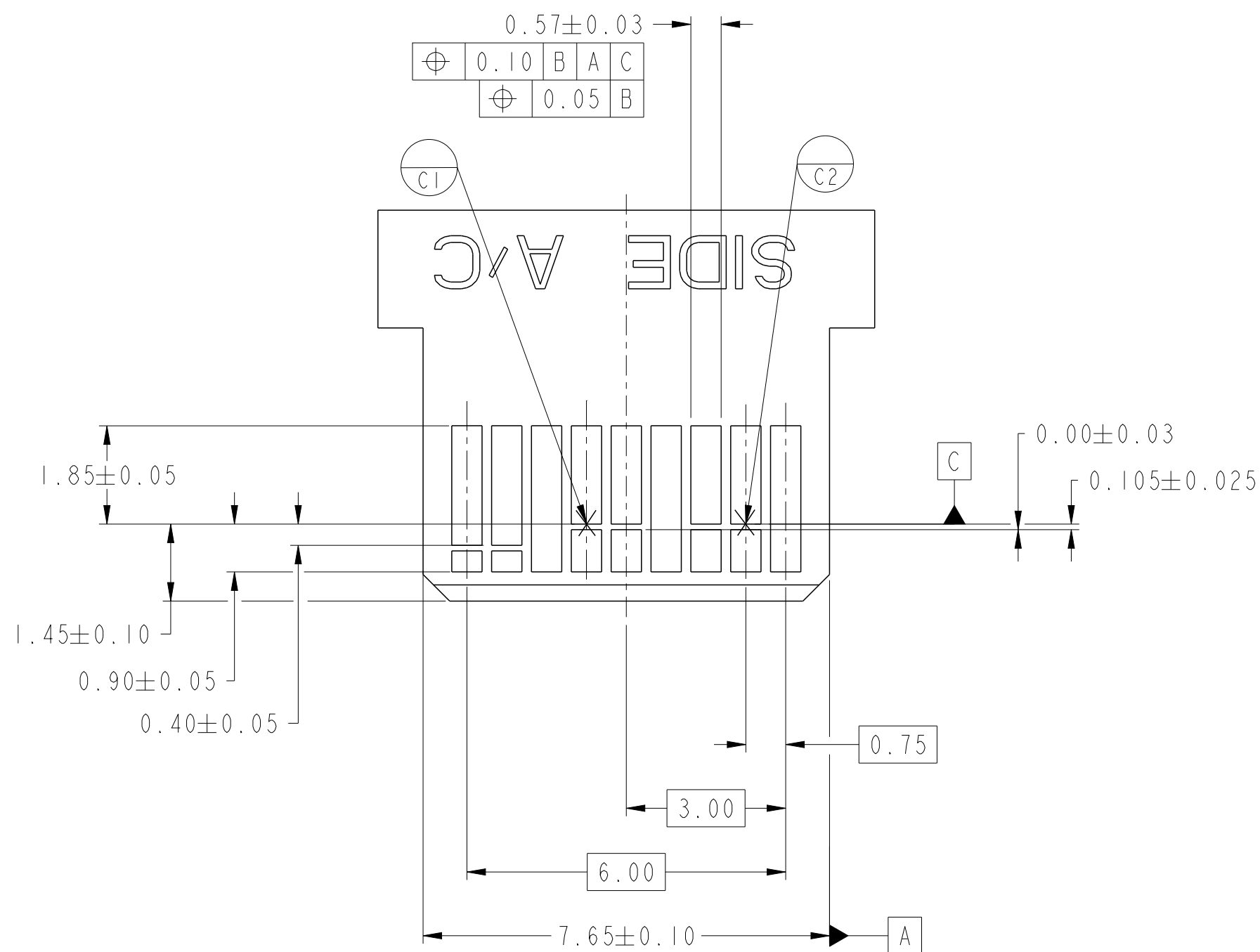
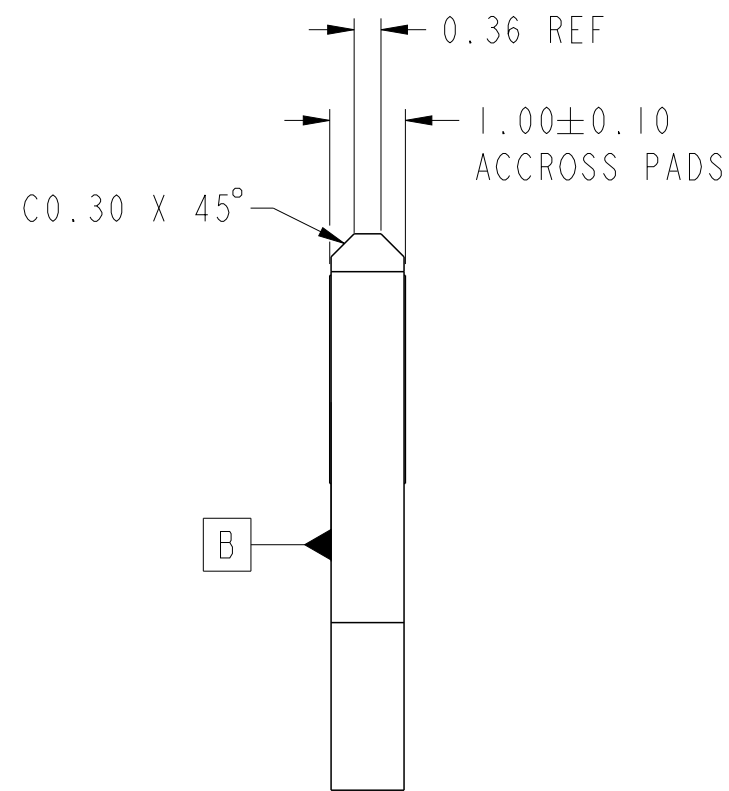
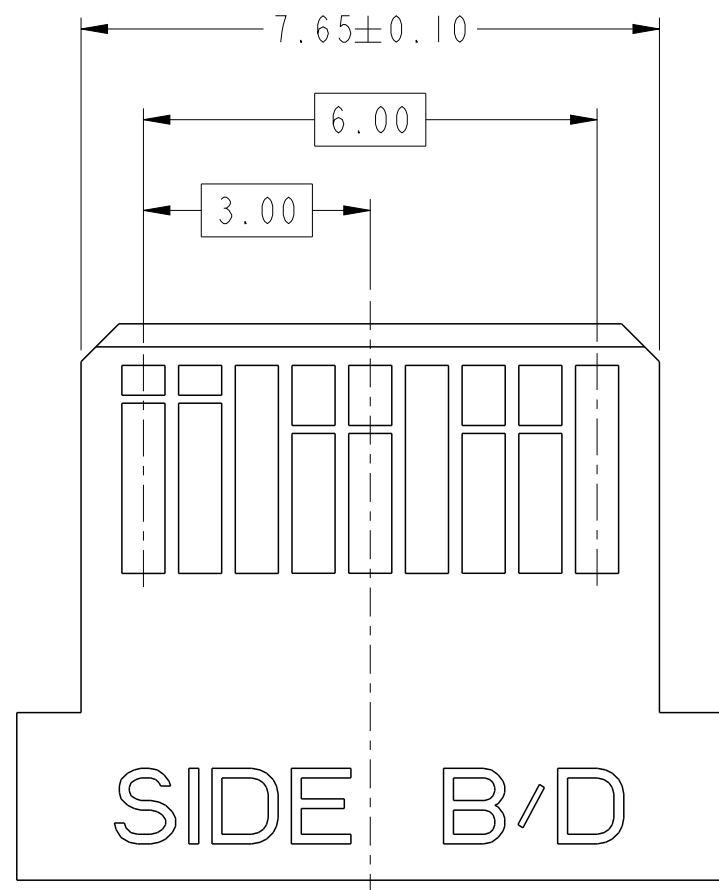

NOTES:

- 0.05 MINIMUM KEEP OUT SOLDER MASK AROUND ALL PADS.
- DATUM C TARGETS ARE DEFINED BY THE RESPECTIVE PAD CENTER LINES AND THE LEADING EDGE OF THE TARGET PADS.

spec ref	-	dr	Mark Gray	2010/08/04	projection	MM	size	A2	scale	2:1
tolerance std	ASME Y14.5	eng	Andy Lu	2014/04/13	chr	-	ecn no	ELX-DG-17441-1	rel level	Released
surface	✓	appr	Pei-Ming Zheng	2014/04/14	product family	MINI-SAS HD	cat. no.	10112634	rev	B
ASME Y14.5	angular	0°	±1/2°	www.fci.com	cat. no.	-	Product - Customer Drw	sheet 4 of 4		

