

PRODUCT NUMBER
SEE P/N TABLE

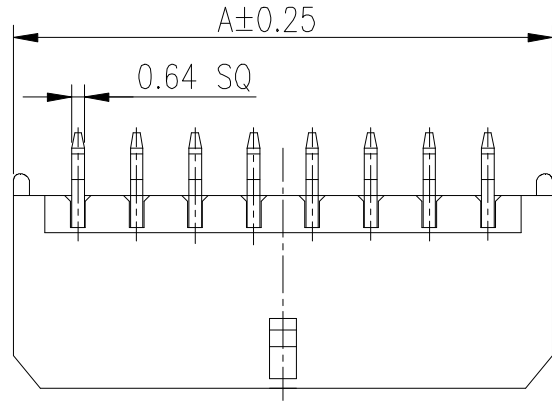

NOTE:

- MATERIAL:
HOUSING: HIGH TEMP. THERMOPLASTIC, UL94V-0, COLOR: BLACK
CONTACT: COPPER ALLOY.
- CONTACT FINISH: 50µ" MIN. NICKEL UNDERPLATED.
OPTIONAL PLATING ON CONTACT AREA.
- THIS PLUG MATES WITH FCI RECEPTACLE WIRE CONNECTOR 10127716.
- PRODUCT SPECIFICATION: GS-12-1177.
- PACKAGE SPECIFICATION: GS-14-2359.
- THE HOUSING WILL WITHSTAND EXPOSURE TO 260°C PEAK TEMPERATURE 10 SECONDS IN A REFLOW OVEN.
- PART NUMBER SCHEMATIC
10127721- XX X X LF

POS. CODE:
02: 2 POS
04: 4 POS
24: 24 POS

GLOW WIRE COMPATIBLE:
BLANK: NON-COMPATIBLE
G: COMPATIBLE

PLATING CODE:
1: 100µ" TIN
2: GOLD FLASH

5. P/N & DIMENSION TABLE:

P/N	POS	A	B
10127721-02XXLF	2	6.60	--
10127721-04XXLF	4	9.60	3.00
10127721-06XXLF	6	12.60	6.00
10127721-08XXLF	8	15.60	9.00
10127721-10XXLF	10	18.60	12.00
10127721-12XXLF	12	21.60	15.00
10127721-14XXLF	14	24.60	18.00
10127721-16XXLF	16	27.60	21.00
10127721-18XXLF	18	30.60	24.00
10127721-20XXLF	20	33.60	27.00
10127721-22XXLF	22	36.60	30.00
10127721-24XXLF	24	39.60	33.00

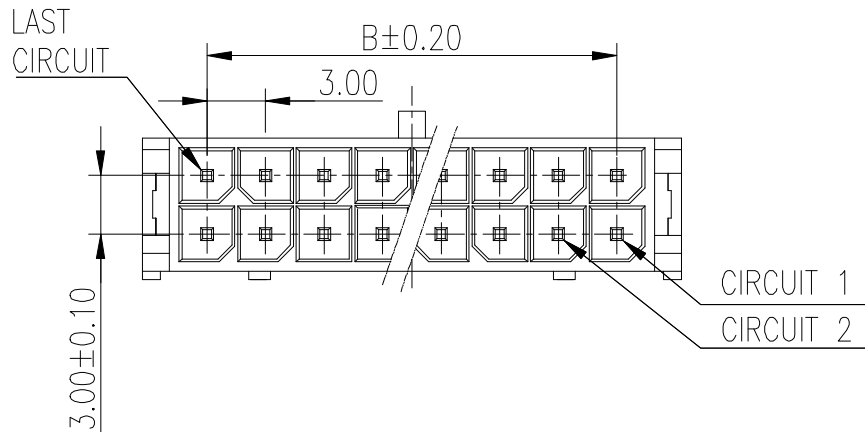
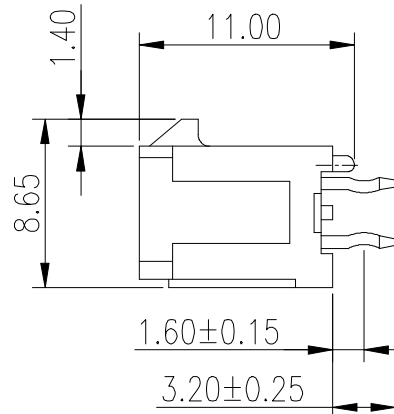

mat'l. code		surface		tolerance		projection		product family	
		✓				⊕		MINITEK PWR3.0	
ltr		ecn no		date		tolerances unless otherwise specified		title	
A		TAI	2013-10-21	angles		X.X ±0.3		WTB HEADER CONNECTOR, DUAL ROW, MINITEK PWR3.0, VERTICAL DIP TYPE	
B	ELX-T-17184	TAI	2014-03-12	fin		X.XX ±0.2			
C	ELX-T-19251	TAI	2014-10-31	X°±2°					
		dr		KENNY TAI		2013-10-21		dwg no	
		enr		KENNY TAI		2013-10-21		sheet 1 of 2	
		chr		KENNY TAI		2013-10-21		size	
		appd		PM ZHENG		2013-11-06		10127721	
sheet index		revision sheet		C 1		C 2		type	
								CUSTOMER Drawing	



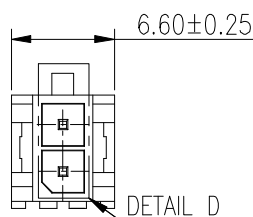

2 POS

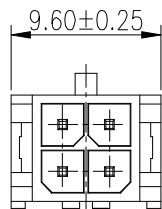

4 POS

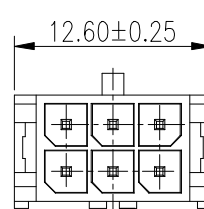

6 POS

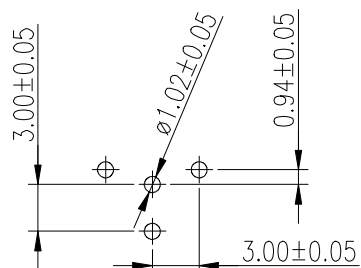

2 POS
RECOMMENDED PCB LAYOUT

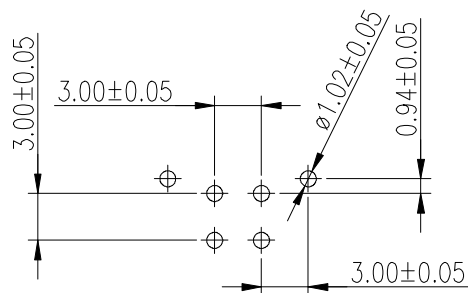

4 POS
RECOMMENDED PCB LAYOUT

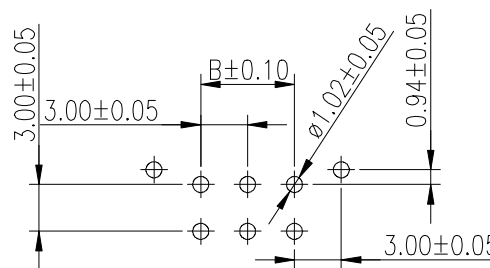

6 POS
RECOMMENDED PCB LAYOUT

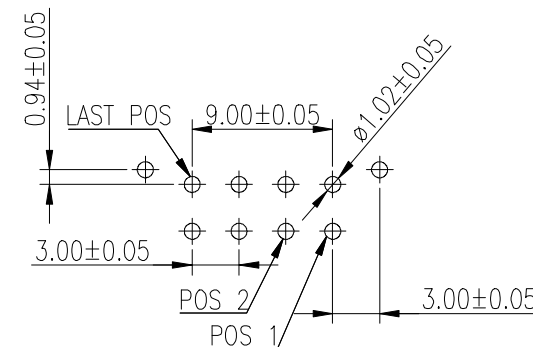

8~24 POS
RECOMMENDED PCB LAYOUT

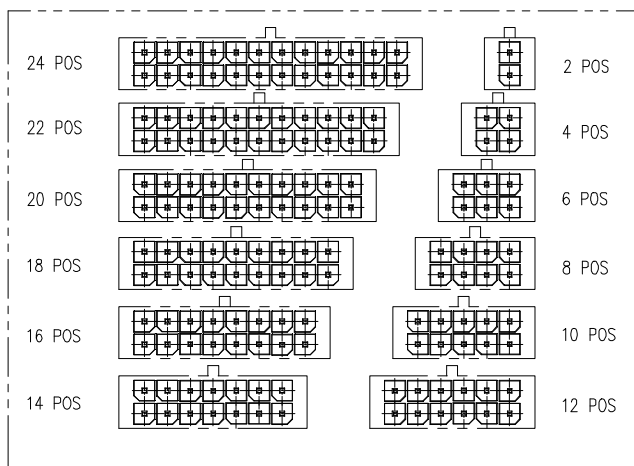

DETAIL D

mat'l. code		surface		tolerance	projection	product family	
ltr		ecn no	dr	date	<input checked="" type="checkbox"/> \varnothing	MINITEK PWR3.0	
		tolerances unless otherwise specified			<input type="checkbox"/> \varnothing	title	
		angles			MM	WTB HEADER CONNECTOR, DUAL ROW, MINITEK PWR3.0, VERTICAL DIP TYPE	
		X°±2°			scale	dwg no	
		dr				sheet 2 of 2	
		enr				size	
		chr				A4	
		appd				type	
sheet index		revision sheet	C	C	FCI		CUSTOMER Drawing
		1	2				