

THIS DRAWING IS UNPUBLISHED. RELEASED FOR PUBLICATION 20  
 © COPYRIGHT 20 BY - ALL RIGHTS RESERVED.

REVISIONS					
P	LTR	DESCRIPTION	DATE	DWN	APVD
C		REV; ECO-10-020682	12OCT2010	GG	RA
D		REV; ECO-15-006853	05MAY2015	GG	TE

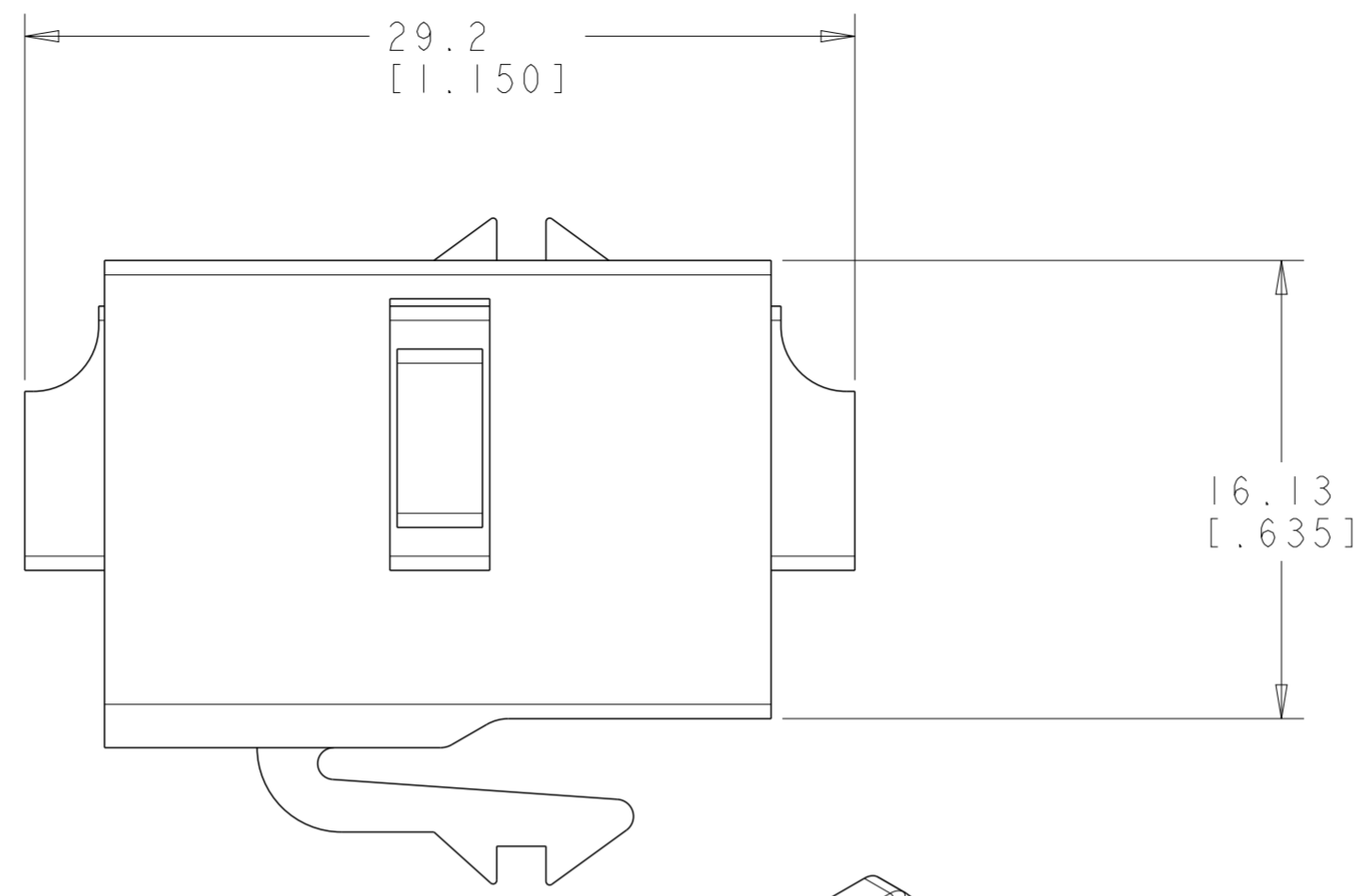
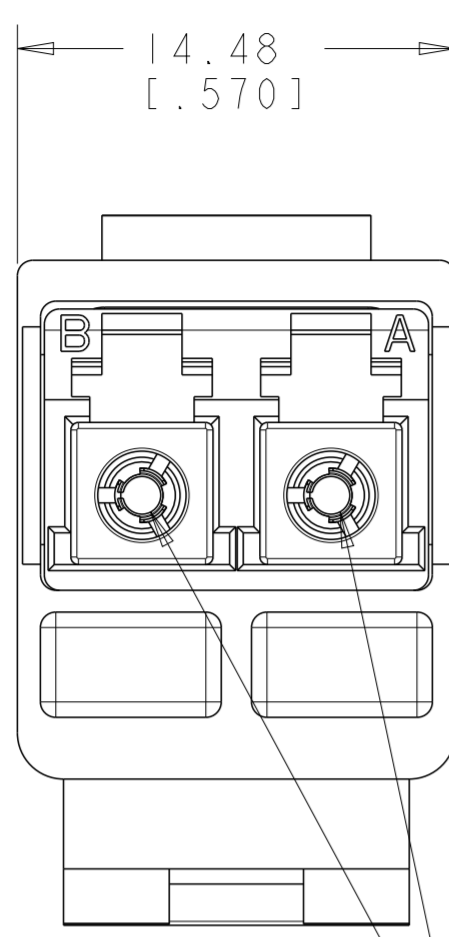

- 1 MATERIAL: JACK HOUSING - POLYPHENYLENE OXIDE, 94V-0 RATED.  
LC DUPLEX ADAPTER ASSEMBLY - ULTEM 1010R.
- 2 THESE TWO SUGGESTED CUTOUT OPENINGS ARE USED IN TANDEM WITH DUAL FRONT AND BACK CUTOUTS.
- 3 PACKAGED ONE ASSEMBLY PER POLYBAG.
- 4 DUST COVERS SHOWN NOT ASSEMBLED BUT SHIPPED ASSEMBLED TO DUPLEX LC ADAPTER.

ALIGNMENT SLEEVE, CERAMIC  
QUANTITY 2

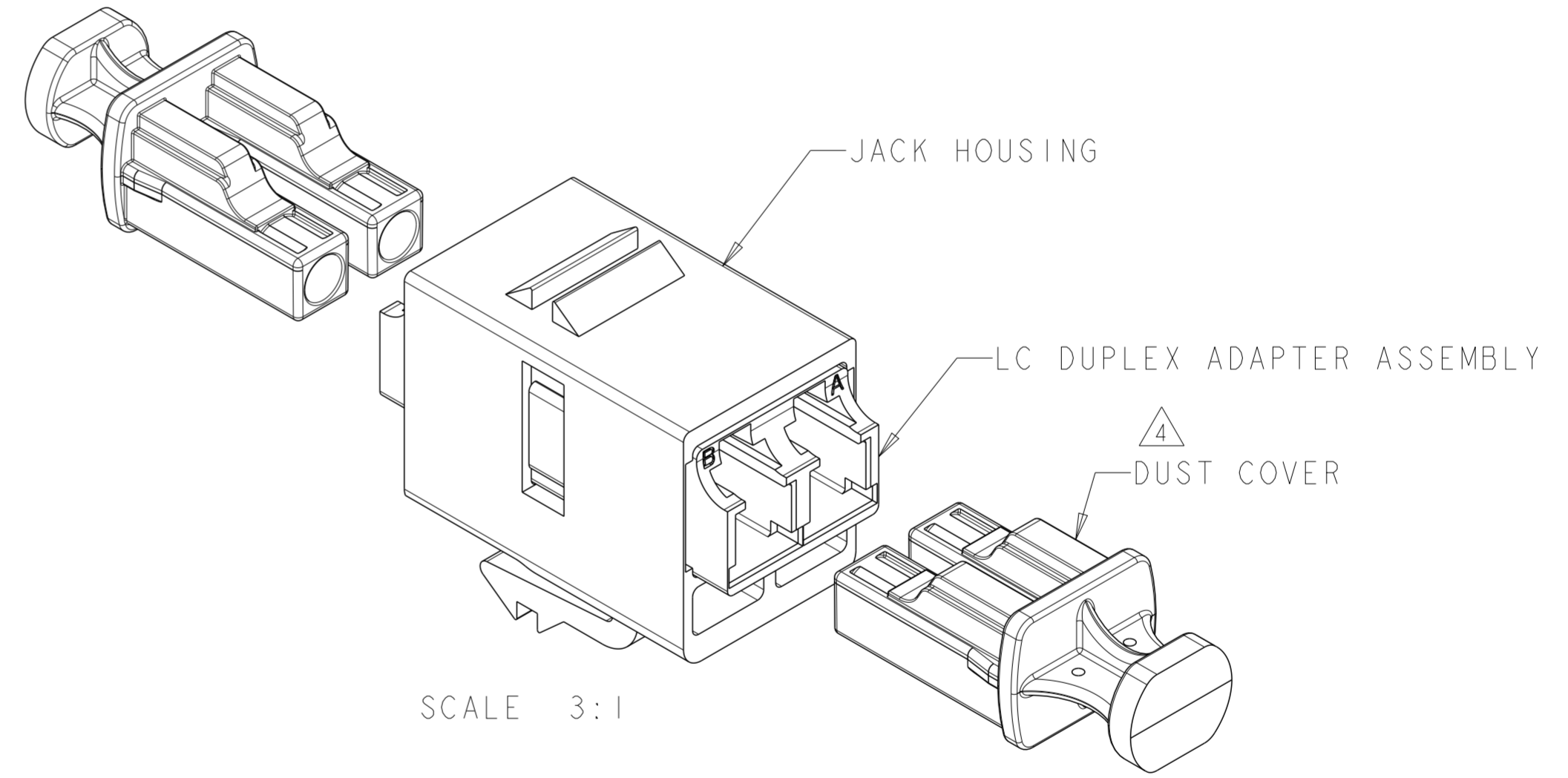

SCALE 3:1

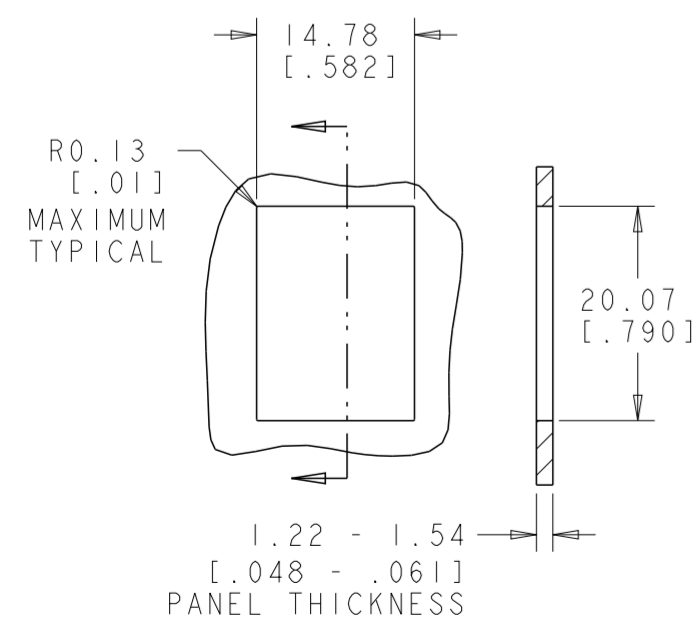

SINGLE PANEL CUTOUT

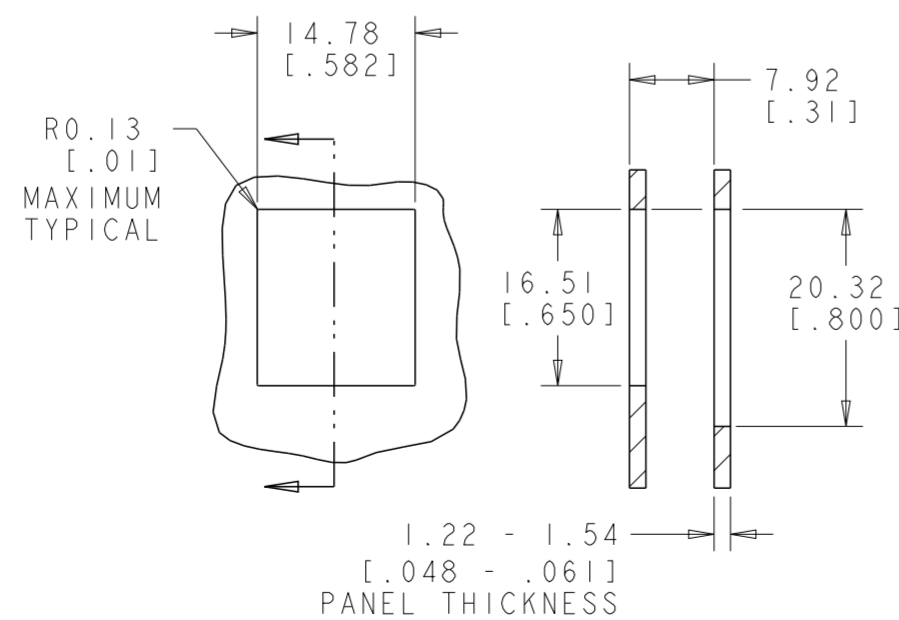

SUGGESTED FLUSH MOUNT  
PANEL APPLICATION CUTOUT 2

3	BEIGE	1-1933286-2
	BLACK	1-1933286-1
	AQUA	1933286-6
	BLUE	1933286-4
	GREEN	1933286-3
PACKAGE	COLOR	PART NUMBER

THIS DRAWING IS A CONTROLLED DOCUMENT.		DWN G. GARRETT 17APR2007	TE Connectivity			
DIMENSIONS: MM [INCHES]		CHK G. BOWMAN 17APR2007				
TOLERANCES UNLESS OTHERWISE SPECIFIED:		APVD G. BOWMAN 17APR2007				
0 PLC ± 1 PLC ± 2 PLC ± 3 PLC ± 4 PLC ± ANGLES ± FINISH -		NAME DUPLX, LC ADAPTER, SM-MM, SL HOUSING				
MATERIAL	1	PRODUCT SPEC	SIZE	CAGE CODE	DRAWING NO	RESTRICTED TO
		APPLIC. SPEC	A2	-	G-1933286	-
Customer Drawing		WEIGHT	SCALE	SHEET	OF	REV
			4:1	1	1	D