

| LOC | DIST | REVISIONS | | | | | |
|-----|------|-----------|-----|----------------------------|-----------|-----|------|
| GP | 00 | P | LTN | DESCRIPTION | DATE | DWN | APVD |
| | | D | | RELEASED PER ECO-12-014574 | 08AUG2012 | DZ | JY |
| | | E | | PER ECR-12-015568 | 03SEP2012 | DZ | JY |
| | | F | | RELEASED PER ECO-13-010325 | 19JUN2013 | RG | AC |
| | | F1 | | REVISED PER ECR-15-013279 | 05SEP2015 | RG | SH |

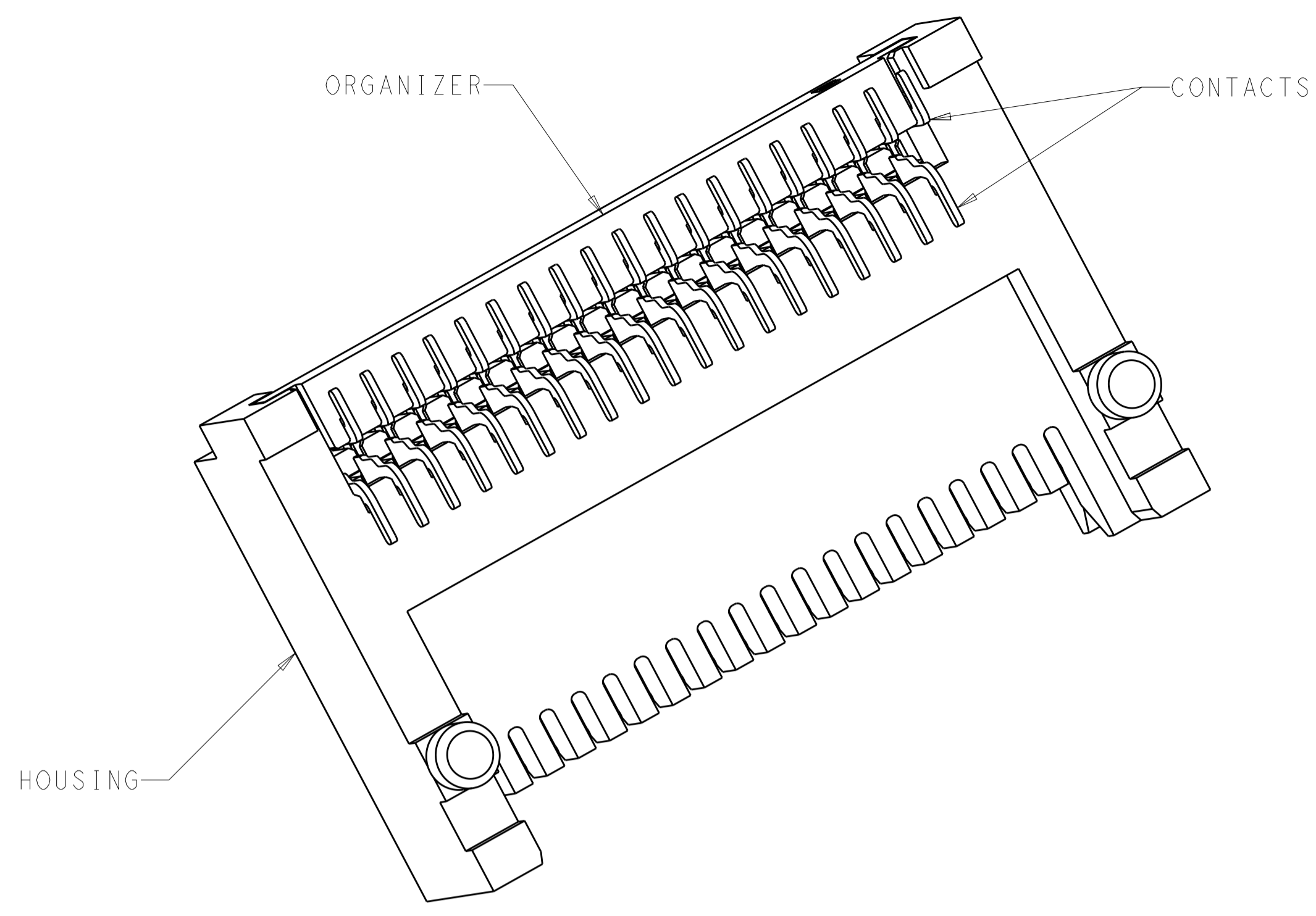

- ⚠ MATERIAL: HOUSING AND ORGANIZER: LCP, UL94V-0 RATED, BLACK.
CONTACTS: COPPER ALLOY, 0.15 THICK.
- ⚠ FINISH: CONTACTS: CONFORMS TO THE REQUIREMENTS OF TYCO ELECTRONICS PRODUCT SPECIFICATION 108-2425, BASED ON EIA/ECA-364-1000.01A, (CONTROLLED ENVIRONMENT APPLICATIONS) ON MATING INTERFACE.
TIN ON SOLDER TAILS
- 3. MATES WITH SFF-8436 COMPLIANT MODULES.
- ⚠ DATUM AND BASIC DIMENSION ESTABLISHED BY CUSTOMER.
- 5. DATUM R IS THE TOP SURFACE OF THE HOST PC BOARD.

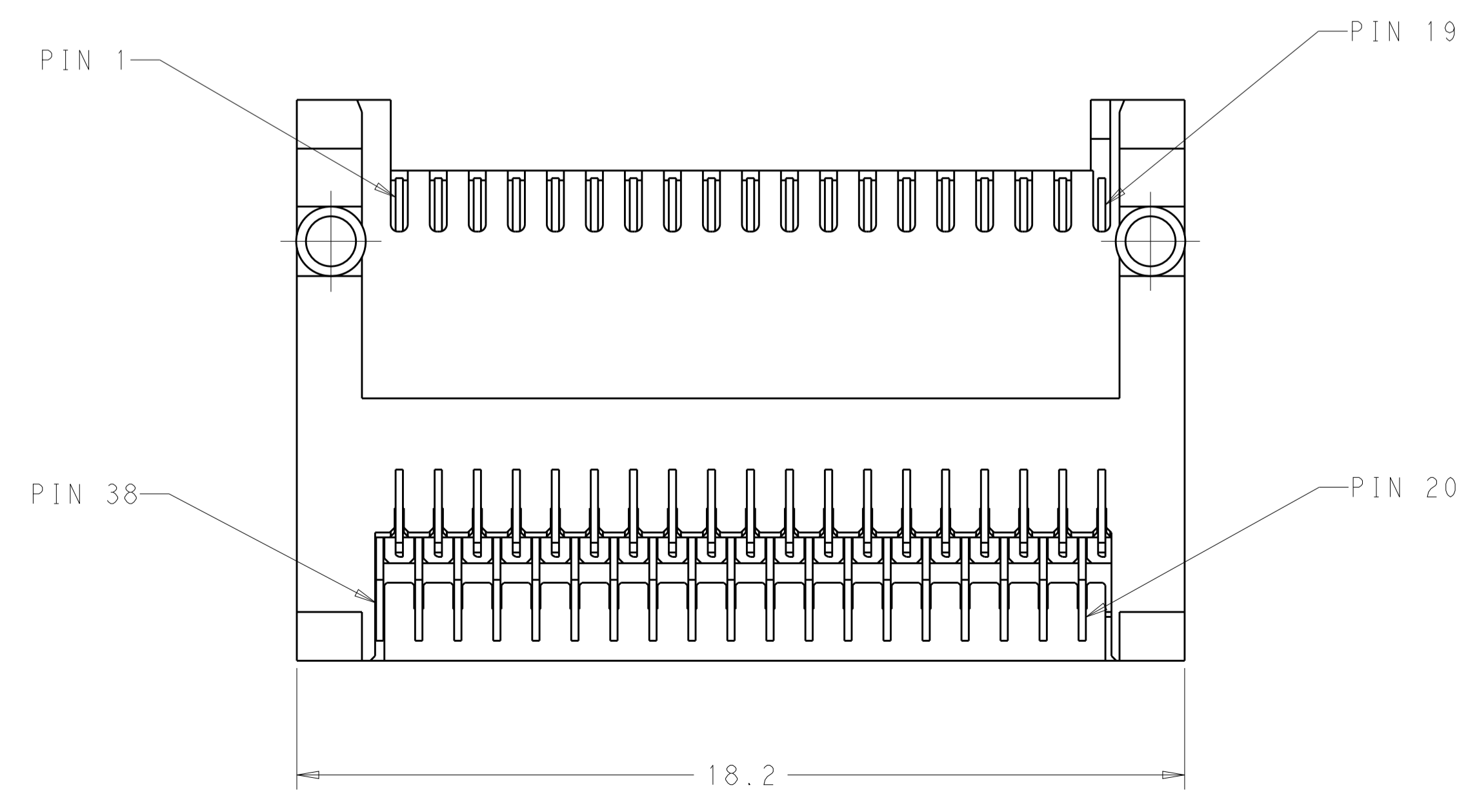
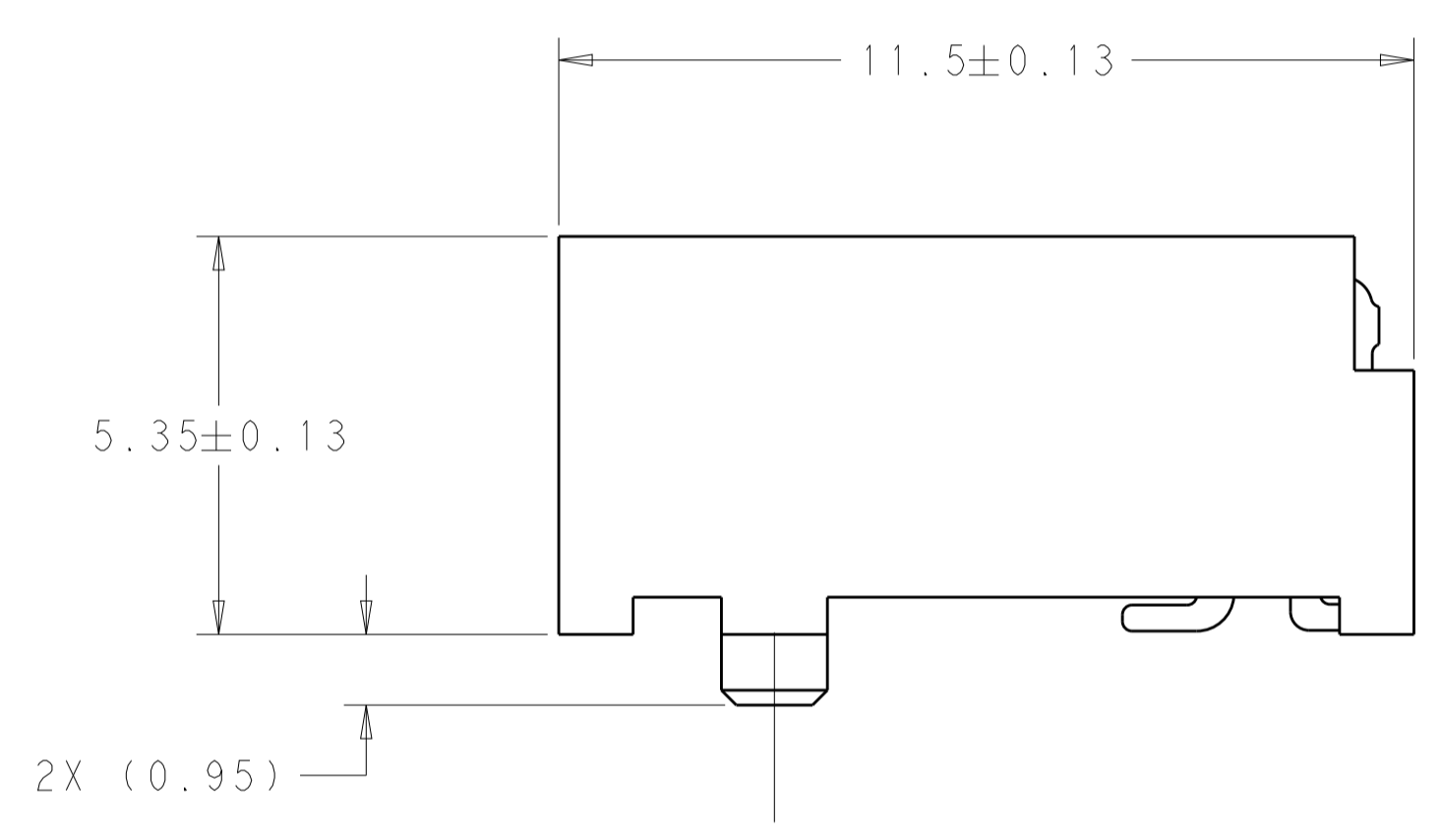
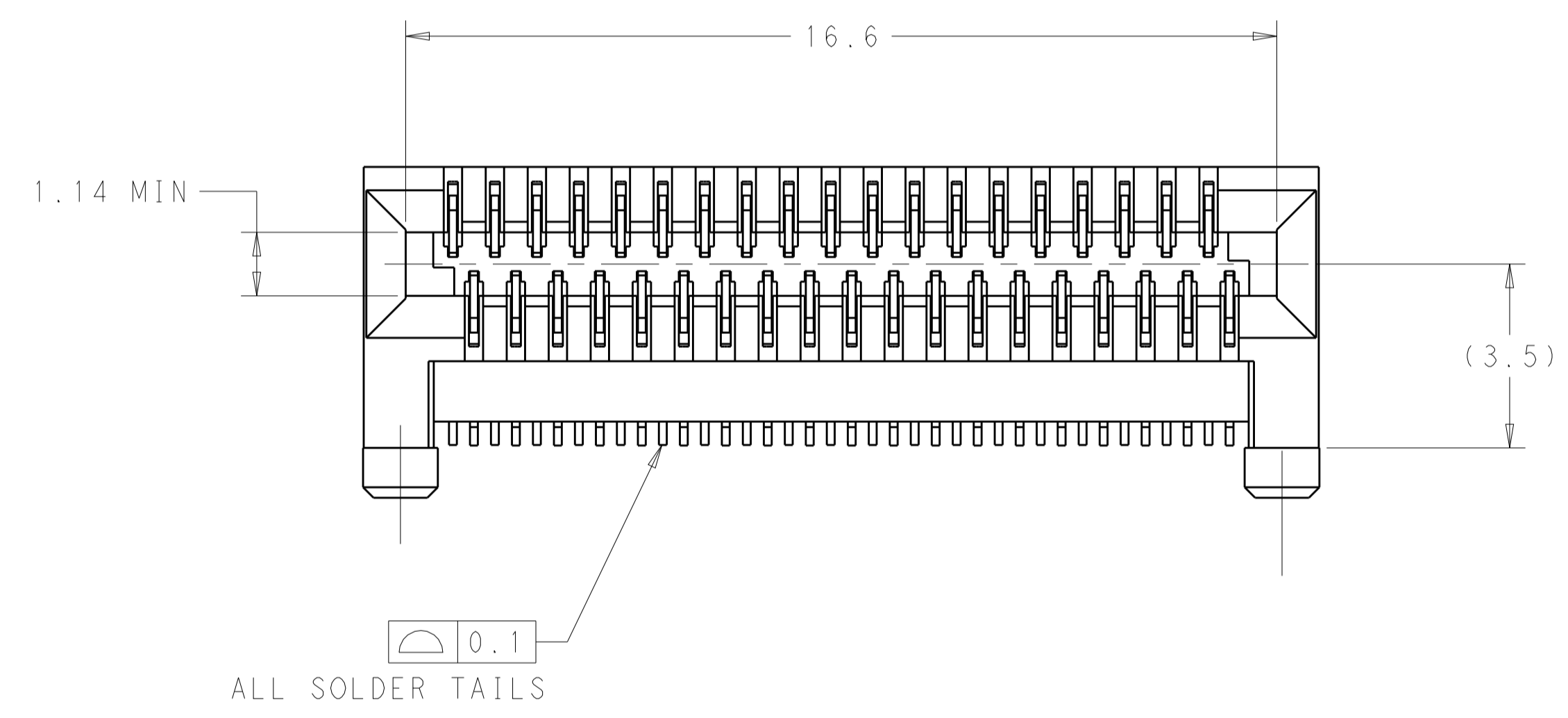

| | |
|--------|-------------|
| ⚠ | 2110819-1 |
| FINISH | PART NUMBER |

THIS DRAWING IS A CONTROLLED DOCUMENT.

| | | | |
|-------------|--|----------------------------|---|
| DIMENSIONS: | TOLERANCES UNLESS OTHERWISE SPECIFIED: | DWN C. VALENTINE 27OCT2009 | NAME |
| mm | 0 PLC ± | CHK J. PETERSON 27OCT2009 | OSFP+ ENHANCED EVERCLEAR, PT CONNECTOR, RIGHT ANGLE |
| | 1 PLC ±0.15 | APVD J. PETERSON 27OCT2009 | 108-2425 |
| | 2 PLC ±0.10 | PRODUCT SPEC | APPLICATION SPEC |
| | 3 PLC ± | APPLIC. SPEC | 114-13221 |
| | 4 PLC ± | WEIGHT | Customer Drawing |
| | ANGLES ± | SCALE | 10:1 |
| MATERIAL | FINISH | SIZE | CAGE CODE DRAWING NO |
| ⚠ | ⚠ | A100779 | 2110819 |
| | | RESTRICTED TO | REV F1 |

4805 (3/11)

| LOC | DIST | REVISIONS | | | | | |
|-----|------|-----------|-----|-------------|------|-----|------|
| | | P. | LTN | DESCRIPTION | DATE | DWN | APVD |
| GP | 00 | - | - | SEE SHEET 1 | - | - | - |
| | | | | | | | |
| | | | | | | | |

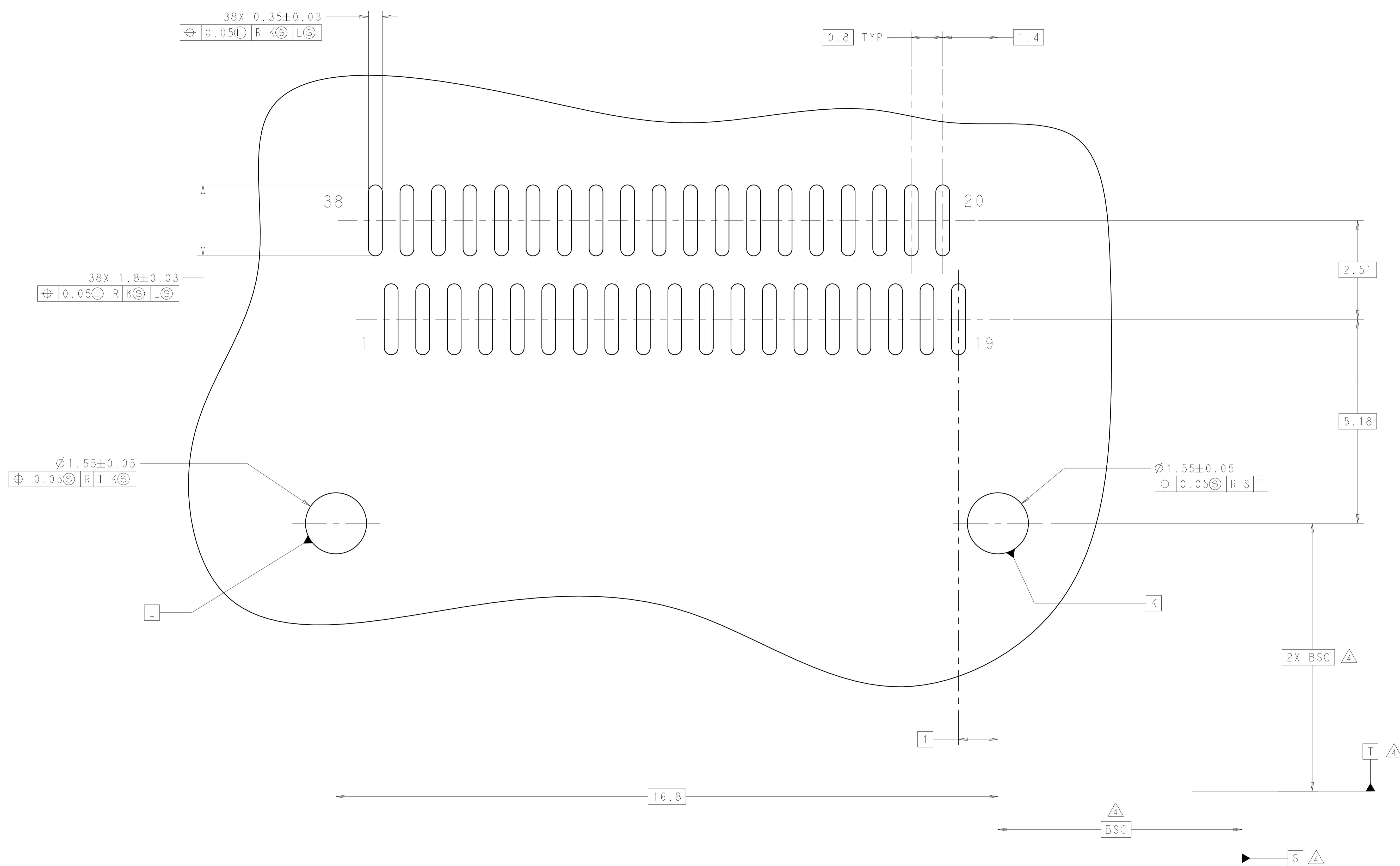

SCALE 20:1

| | | | | | | | | |
|--|------------|------------------|--------------|------------|--|-----------|------------|---------------|
| THIS DRAWING IS A CONTROLLED DOCUMENT. | | DWN | C. VALENTINI | 2/OCT/2009 | TE Connectivity | | | |
| DIMENSIONS: | | CHK | J. PETERSON | 2/OCT/2009 | | | | |
| mm | 0 PLC ±0.1 | APVD | J. PETERSON | 2/OCT/2009 | NAME QSPF+ ENHANCED EVERCLEAR, PT CONNECTOR, RIGHT ANGLE | | | |
| | 2 PLC ±0.1 | PRODUCT SPEC | | 108-2425 | | | | |
| | 3 PLC ±0.1 | APPLICATION SPEC | | 114-13221 | SIZE | CAGE CODE | DRAWING NO | RESTRICTED TO |
| | 4 PLC ±0.1 | FINISH | | | A1 | 00779 | C=2110819 | - |
| MATERIAL | | WEIGHT | | | Customer Drawing | | SCALE | 10:1 |
| | | | | | SHEET | 2 | OF | 2 |
| | | | | | REV | F1 | | |