

1-1418480-1 AS SHOWN
 1-1418480-1 wie gezeigt

REV.	DATE	BY	APPV
J1	15MAY2015	SK	Kraus

NOTES
 Bemerkungen

- 1 TE LOGO
TE Logo
- 2 ASSY PN, PRODUCTION DATE (CALENDAR DAY/YEAR); MARKING OPTIONAL AS LASER ENGRAVING OR LASER WITH COLOR CHANGE
Assy PN, Produktionsdatum (Kalendertag/Jahr); Beschriftung wahlweise als Lasergravur oder Laser mit Farbumschlag
- 3 BULK PACKAGING IN CORRUGATED BOX
Schuetztgut im Versandkarton
- 4 CAVITY NUMBERING
Kammer Bezeichnung
- 5 CAVITIES MATED WITH AMP MCP 2.8
SEE PRODUCT GROUP DRAWING
TE NO: 1355036
MAX. WIRE SIZE: 2.5mm² FLR (AWG 12 TXL)
Kontaktkammern passend fuer AMP MCP 2.8
siehe Produktgruppenzeichnung
TE Nr: 1355036
max. Drahtgroessenbereich: 2.5mm² FLR (AWG 12 TXL)
- 6 CAVITIES MATED WITH AMP MCP 1.5k
SEE PRODUCT GROUP DRAWING
TE NO: 1241436
MAX. WIRE SIZE: 1.5mm² FLR (AWG 16 TXL)
Kontaktkammern passend fuer AMP MCP 1.5k
siehe Produktgruppenzeichnung
TE Nr: 1241436
max. Drahtgroessenbereich: 1.5mm² FLR (AWG 16 TXL)
- 7 SUITABLE COVERS SEE DRAWING: 1670057, 1670364
Passende Kappen siehe Zeichnung: 1670057, 1670364
- 8 SLIDING DISTANCE OF SECONDARY LOCKING
Verschiebeweg der 2. Kontaktsicherung
- 9 FITS TO TE INTERFACE DRAWING 114-18740-1
Passend zur Ausfuhrungsvorschrift 114-18740-1
- 10 SUITABLE COUNTERPART SEE DRAWING: 1670214, 1703648
passendes Gegenstueck siehe Zeichnung: 1670214, 1703648
- 11 MALFUNCTION CAUSED BY LACQUER IS NOT COVERED BY TYCO ELECTRONICS WARRANTY.
Funktionsbeeintraechtigung durch Lackieren liegt nicht im Einfluss und Gewaehrleistungsumfang von Tyco Electronics.

SLIDE IN LOCKED POSITION
 Schieber in Verriegelungsposition

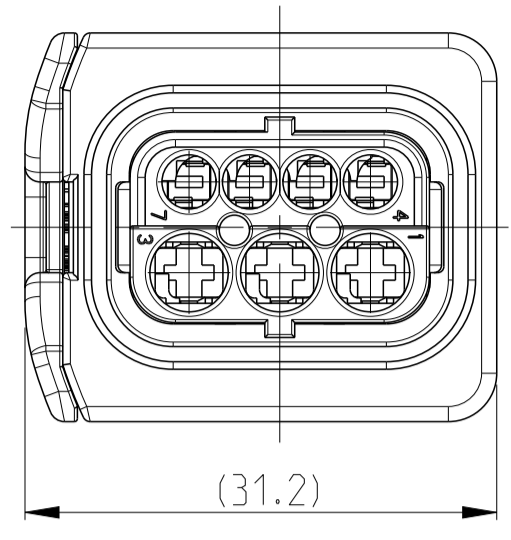

DELIVERY CONDITION:
 Lieferzustand:
 SECONDARY LOCKING AND SLIDE
 IN PRE-LOCKED POSITION
 2. Kontaktsicherung und Schieber
 in Vorraststellung

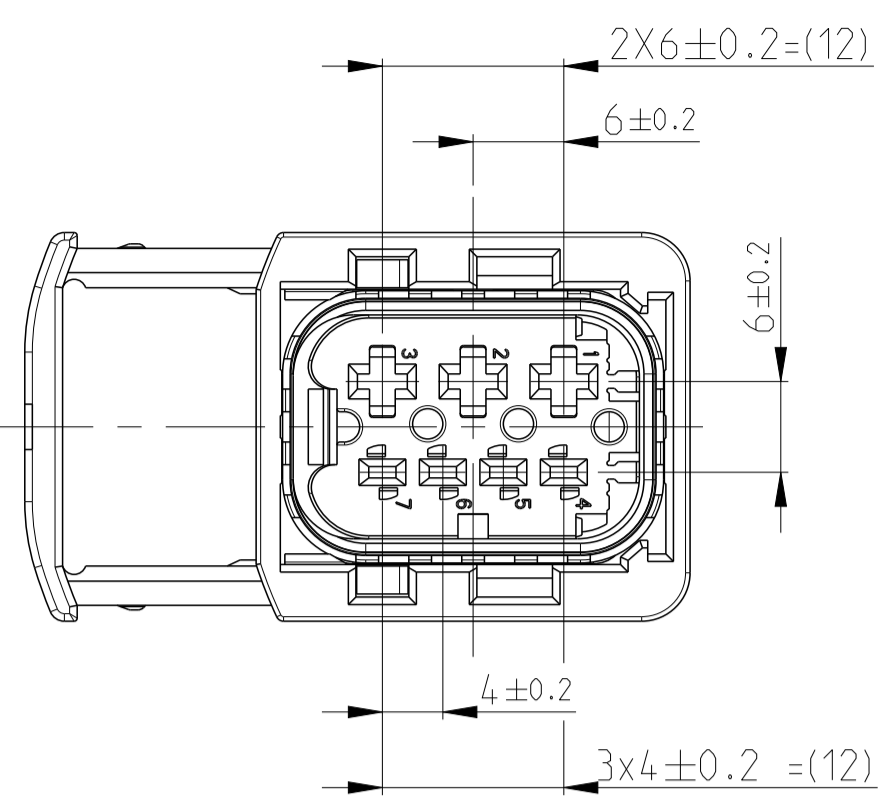

CODING A
 Kodierung

PN 1-1418480-1

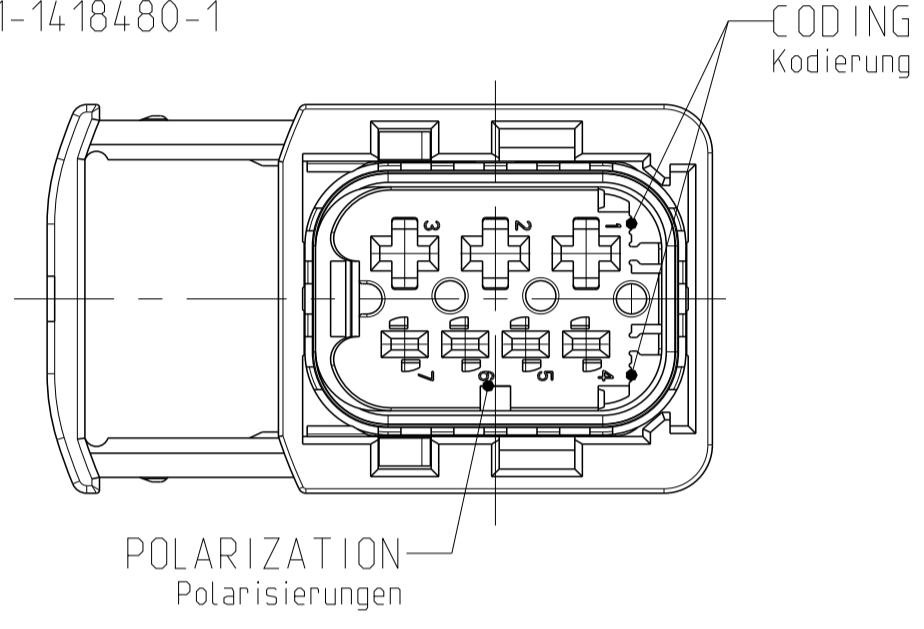

CODING B
 Kodierung

PN 2-1418480-1

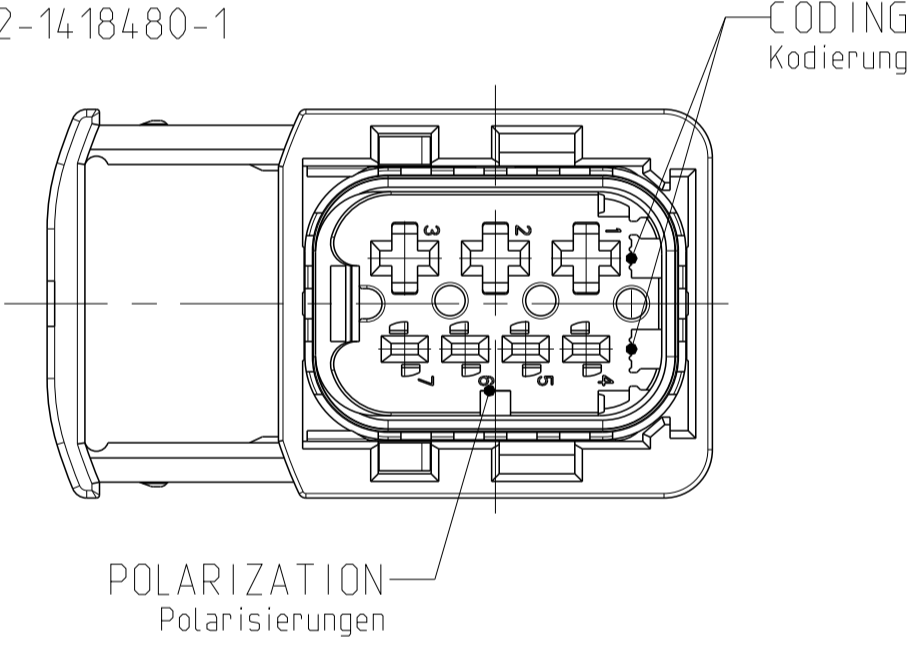

CODING C
 Kodierung

PN 3-1418480-1

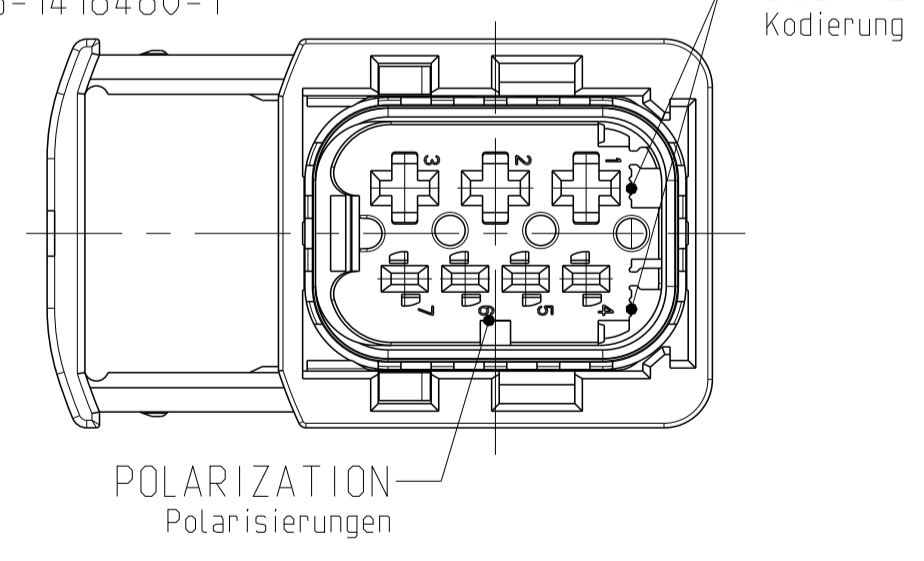

CODING D
 Kodierung

PN 4-1418480-1

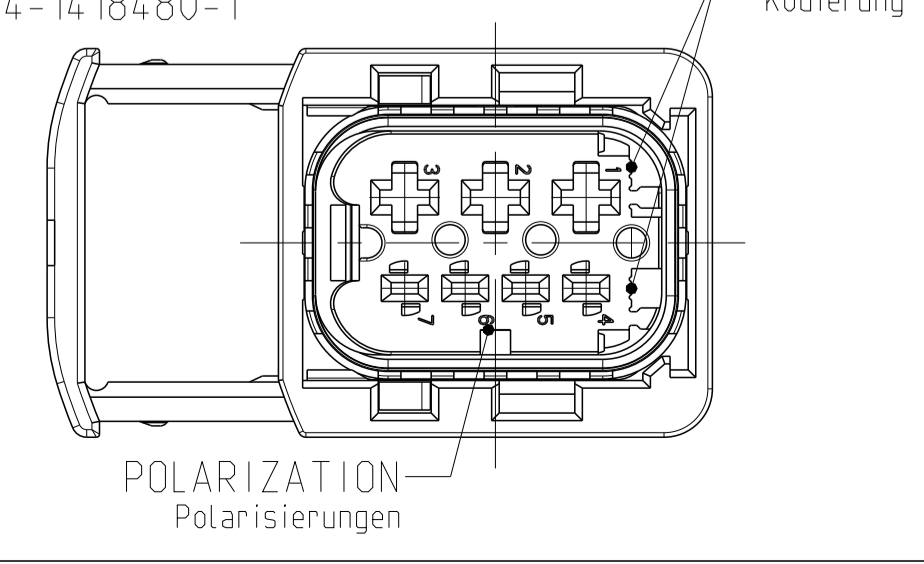

SECTION A-A
 Schnitt

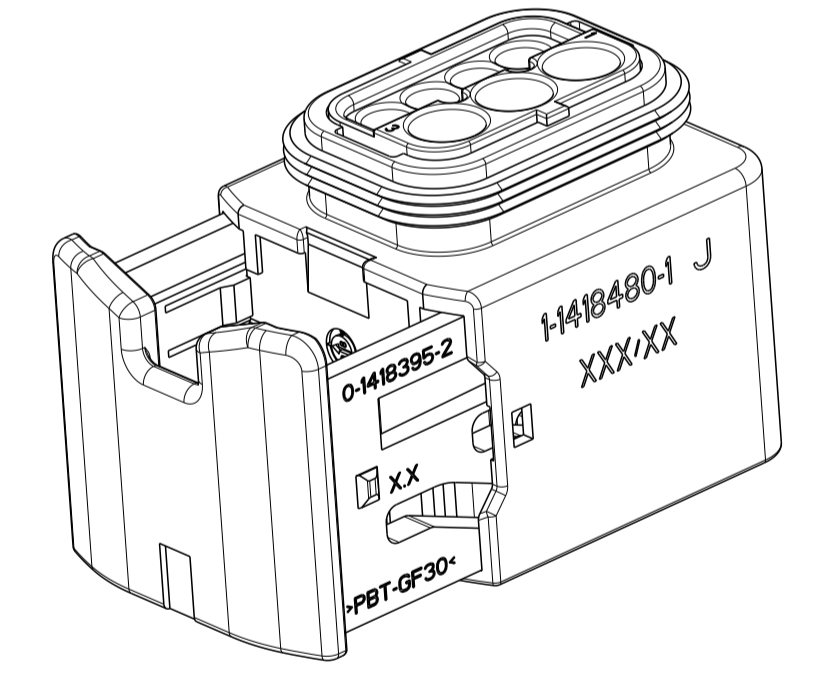
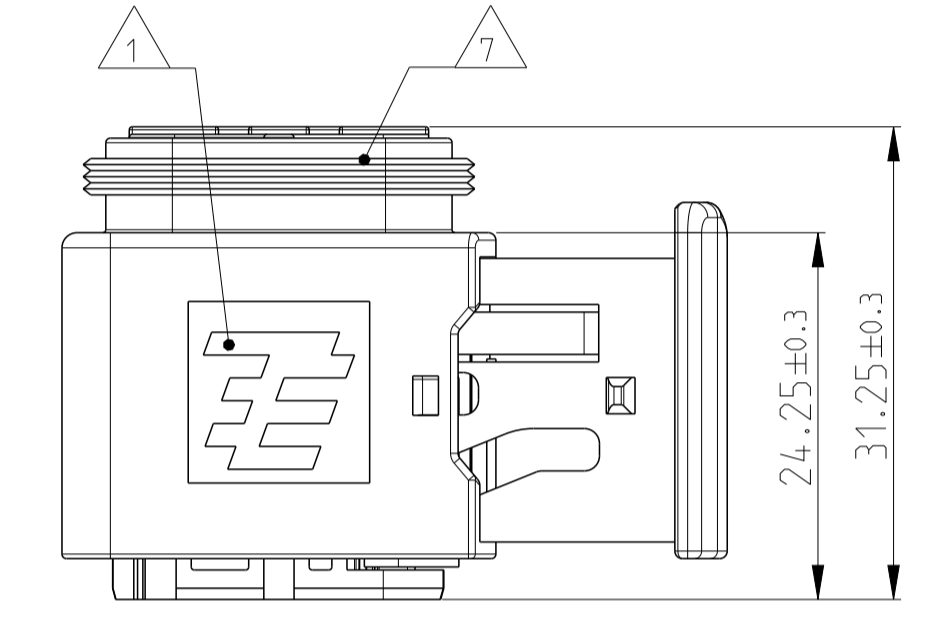
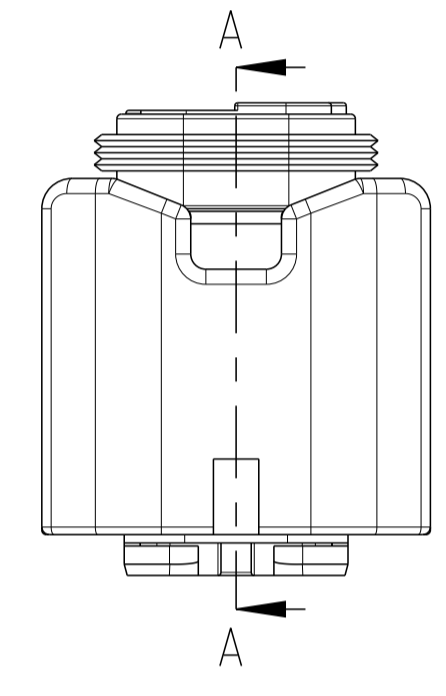
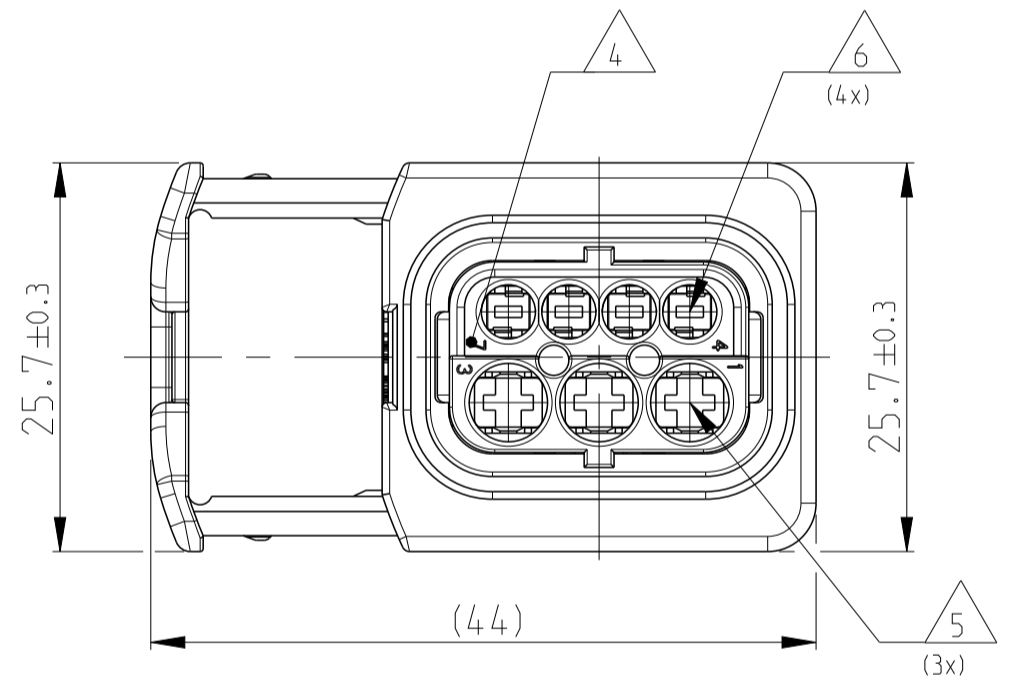
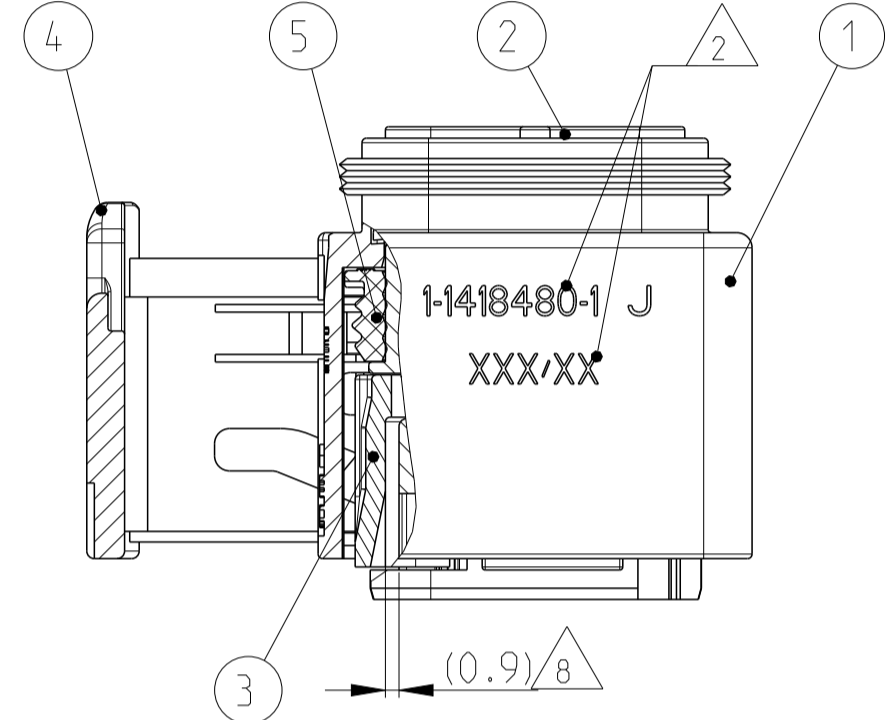

ITEM NO	DESCRIPTION	COLOUR	MATERIAL
1	RECEPTACLE HOUSING	BLACK	PBT-GF30 / V-0
2	7POS. CAVITY BLOCK, CODE, 'A'	BLACK	PBT-GF30 / V-0
2	7POS. CAVITY BLOCK, CODE, 'C'	BLACK	PBT-GF30 / V-0
2	7POS. CAVITY BLOCK, CODE, 'B'	GREEN	PBT-GF30 / V-0
2	7POS. CAVITY BLOCK, CODE, 'C'	GREEN	PBT-GF30 / V-0
2	7POS. CAVITY BLOCK, CODE, 'D'	BLUE	PBT-GF30 / V-0
3	7POS. CAVITY BLOCK, CODE, 'D'	BLUE	PBT-GF30 / V-0
4	U-SLIDE	YELLOW	PBT-GF30 / V-0
5	SEAL	WHITE	MVO

TE ORDER-NO.	REV.	NO.OF POS.	CODE	COLOR OF CAVITY BLOCK	QUANTITY	ITEM NO
TE Bestell-Nr.		Polzahl	Kodierung	Farbe des Kammerblocks	Stueck	ASSY
4-1418480-1	J	7	D	BLUE	1	4
3-1418480-1	J	7	C	GREEN	1	3
2-1418480-1	J	7	B	GREY	1	2
1-1418480-1	J	7	A	BLACK	1	1

THIS DRAWING IS A CONTROLLED DOCUMENT.
 DIMENSIONS: MILLIMETERS (MM) / TOLERANCES: UNLESS OTHERWISE SPECIFIED: ACC. TO DIN 9130

OWNER: D. Bischoff, 13APR2006
 CHK: J. Grandow, 25APR2006
 NAME: E. Eberwein, 28AUG2006

PRODUCT SPEC: 108-94.020
 APPLICATION SPEC: VERARBEITUNGSZUSATZ 114-18756

SIZE: A1 / CAGE CODE: 070779 / DRAWING NO: 1418480
 WEIGHT: 18.2g / FINISH: SOWANNE
 Customer Drawing / KUNDENZEICHNUNG / SCALE: MASSSTAB 2:1 / SHEET: 1 VON 1 / REV: J1

TE Connectivity