

THE INFORMATION CONTAINED IN THIS DRAWING IS THE SOLE PROPERTY OF L-COM, INC. ANY REPRODUCTION IN PART OR WHOLE WITHOUT THE WRITTEN PERMISSION OF L-COM, INC. IS PROHIBITED.

REVISIONS			
REV	DESCRIPTION	DATE	APPROVED
E	ECN 7409: UPDATED PER NEW SUPPLIER SPEC	5/19/14	D. CASTRO

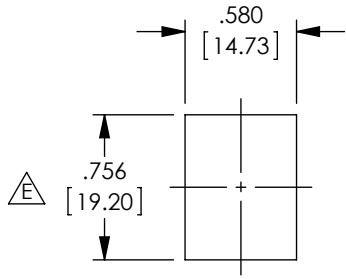

RECOMMENDED
PANEL OPENING

WIRING	
PIN 1	PIN 1
PIN 2	PIN 2
PIN 3	PIN 3
PIN 4	PIN 4
PIN 5	PIN 5
PIN 6	PIN 6
PIN 7	PIN 7
PIN 8	PIN 8
SHIELD	SHIELD

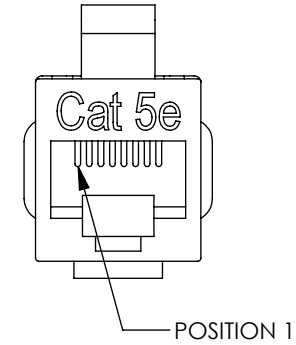
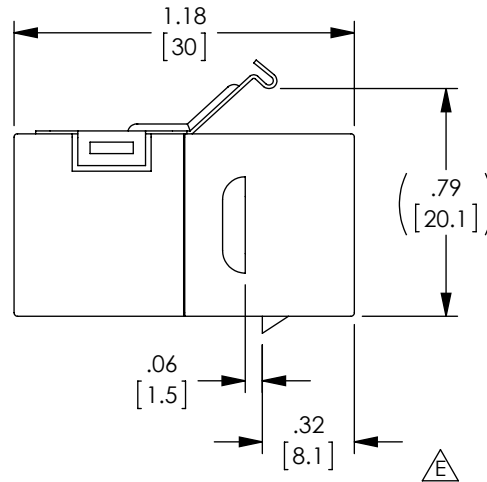
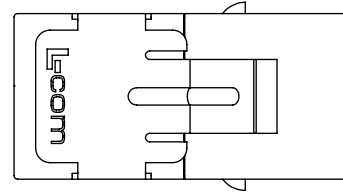
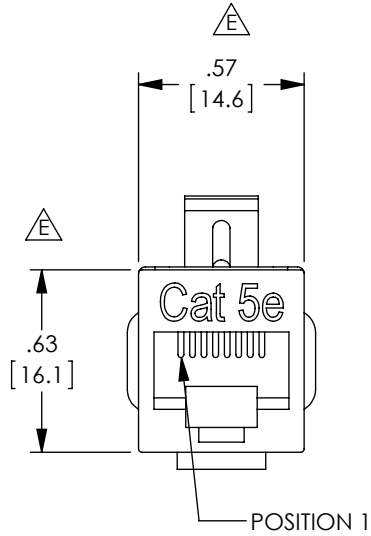

NOTES:

MATERIAL:
HOUSING: ABS, UL94V-0, COLOR: BLACK.
CONTACTS: PHOSPHOR BRONZE
CONTACT PLATING: GOLD, 50 μ INCHES OVER NICKEL PLATE.
SHIELD: BRASS WITH NICKEL PLATE.

ELECTRICAL:
DC CURRENT RATING: 1.5 AMP (MAX.)
VOLTAGE RATING: 150 VOLTS
INSULATION RESISTANCE: 500MΩ

MISCELLANEOUS:
RATING: CATEGORY 5E
OPERATING TEMPERATURE RANGE: -10°C TO +60°C.

COMPONENT SHALL BE INDIVIDUALLY PACKAGED IN ACCORDANCE WITH L-COM SPECIFICATION PS-0031.

ALL DIMENSIONS ARE FOR REFERENCE ONLY.

REGULATORY COMPLIANCE:
CE2011/65/EU (RoHS DIRECTIVE)



UNLESS OTHERWISE SPECIFIED, DIMENSIONS ARE IN INCHES [mm] OVERALL CABLE LENGTH TOLERANCE: ≤12 [305] = +1 [25] / -0 >12 [305] ≤60 [1524] = +2 [51] / -0 >60 [1524] ≤120 [3048] = +4 [102] / -0 >120 [3048] ≤300 [7620] = +6 [152] / -0 >300 [7620] = +5% / -0%	APPROVALS	DATE		45 BEECHWOOD DRIVE NORTH ANDOVER, MA 01845
	DRAWN BY D. PARHAM	4/8/2004		
ALL OTHER DIMENSIONAL TOLERANCES: .X = ± .2 [5.08] .XX = ± .02 [1.51] .XXX = ± .005 [1.3]	CHECKED BY T. CLARK	4/9/2004	CATEGORY	
	APPROVED BY C. McCORMICK	4/12/2004	TELECOM/MODULAR	
PROJECTION 	CONFIGURATION DETAILS OF UNDIMENSIONED FEATURES MAY VARY	COLOR VARIATIONS MAY OCCUR	PRODUCT DESCRIPTION	
			CAT 5E SHLD RJ45 KEYSTONE CPLR	
	SIZE A	FSCM NO. 43321	DWG. NO. TDG1026KS-C5E	REV. E
	SCALE: NONE		CAD FILE: TDG1026KS-C5E.SLDRW	SHEET 1 OF 1