

Inlet ring for Vpro-ECblue, Vpro full bell mouth

- Material: Sheet steel, galvanised

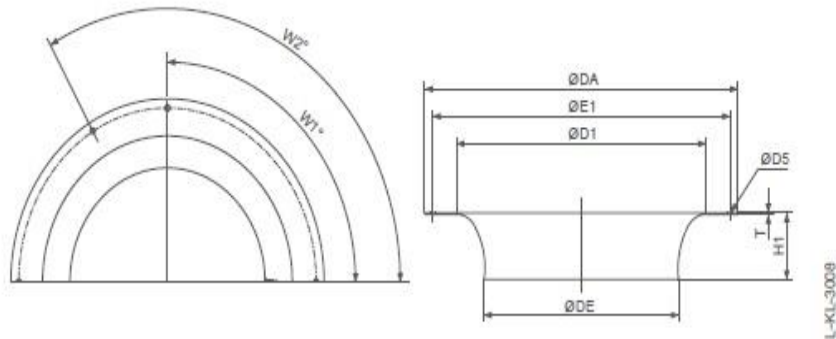

Size	Article no.	DA	DE	D1	D5	D6	E1	E2	H	T	ZxW1°	ZxW2°	⌀
		[mm]	[mm]	[mm]	[mm]	[mm]	[mm]	[mm]	[mm]	[mm]	(1)	(2)	
RH19V	00407897	170	125.5	145.5	4.5	-	158	-	14	1.0	4x90°	-	0.1
RH22V (220)	00407898	252	155.0	195.0	5.5	4.3	242	245	21	1.0	6x60°	4x90°	0.3
RH22V (225)	00407899	223	146.4	196.6	4.5	-	210	-	28	1.0	4x90°	-	0.2
RH25V	00407900	255	165.0	221.6	4.5	-	240	-	31	1.0	4x90°	-	0.3
RH28V	00275848	265	180	234.6	7.0	-	250	-	43	1.0	6x60°	-	0.4
RH31V	00335943	300	203	260.6	7.0	-	285	-	54	1.0	6x60°	-	0.5
RH35V	00275850	338	228	292.2	7.0	-	315	-	58	1.0	6x60°	-	0.6
RH40V	00275570	374	257	324.9	9.0	-	350	-	66	1.0	6x60°	-	0.8
RH45V	00275571	413	287	364.0	9.0	-	390	-	71	1.0	6x60°	-	0.9
RH50V	00275572	456	323	410.0	9.0	-	430	-	79	1.0	6x60°	-	1.1
RH56V	00278489	530	361	459.0	9.0	-	510	-	87	1.5	6x60°	-	2.2
RH63V	00279305	745	407	510.3	11.5	-	720	-	95	1.5	12x30°	-	4.6

(1) fastening inlet ring, (2) fastening guard grille