

COUNT		DESCRIPTION OF REVISIONS		BY	CHKD	DATE

Fig.1 : RECOMMENDED PATTERN Fig.2 : PLATING SPECIFICATION (40:1)

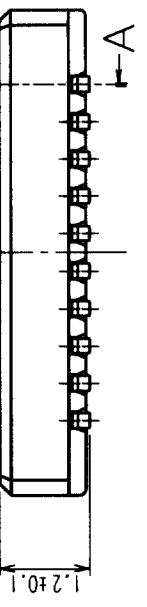
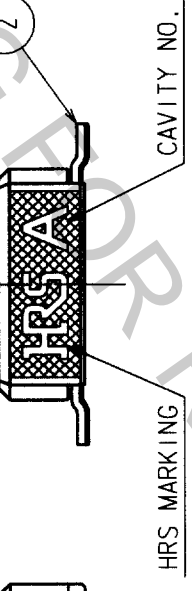
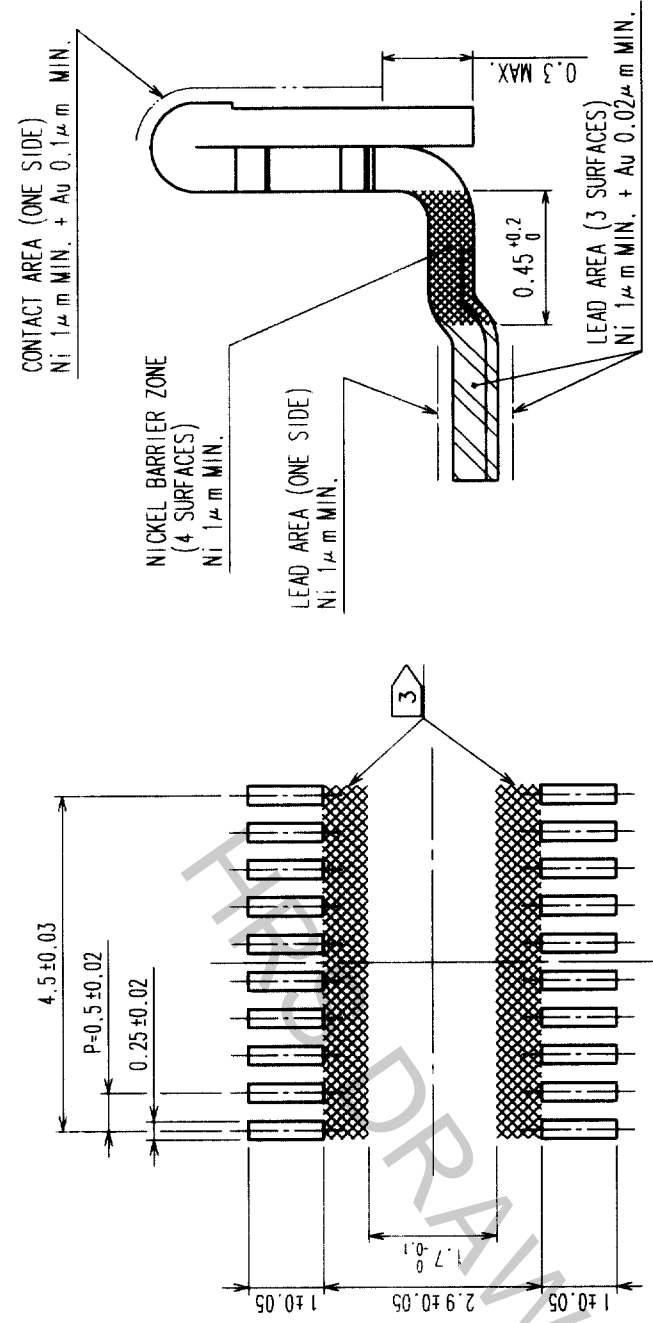
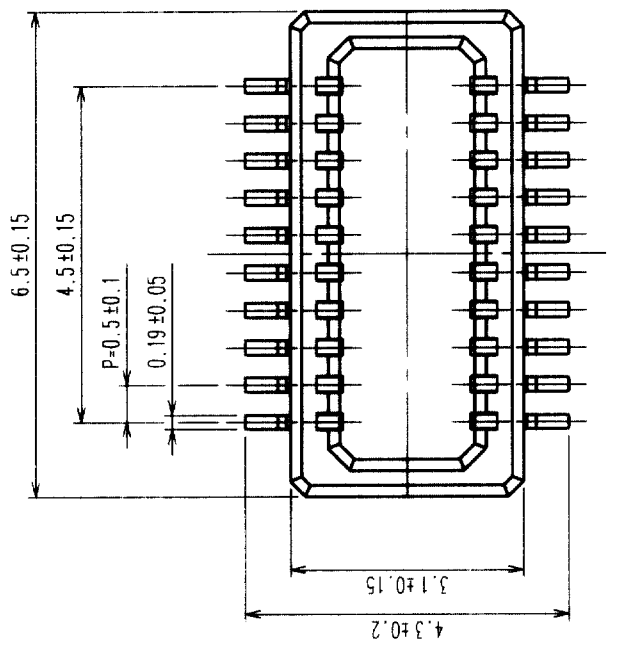

Fig.3 : A-A CROSS SECTION VIEW

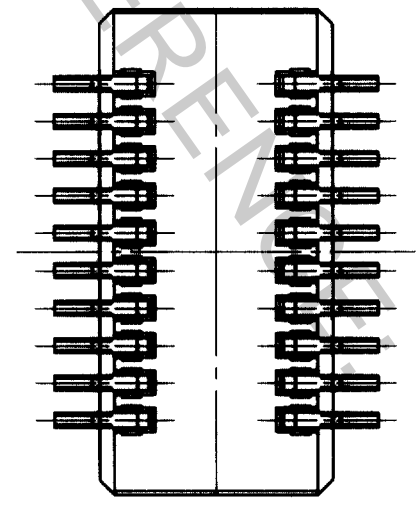
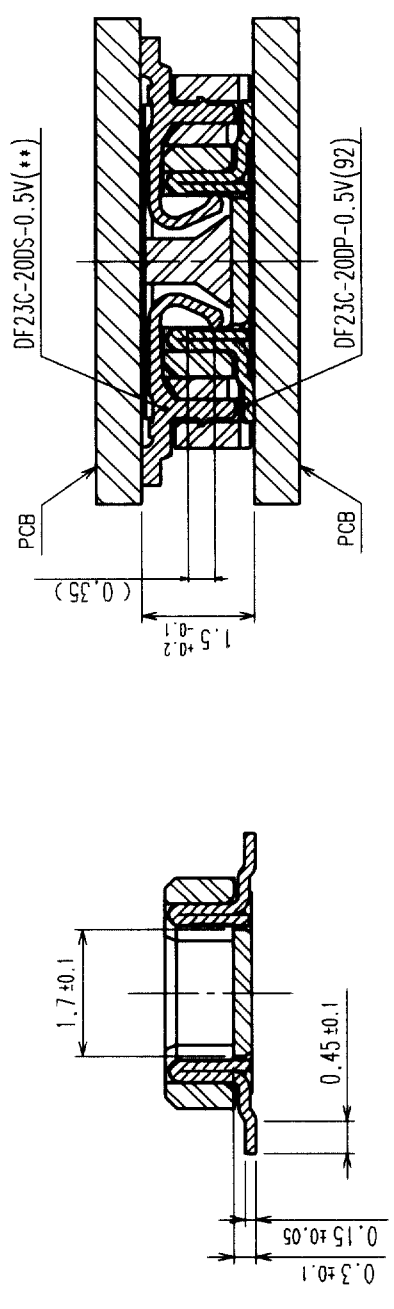

Fig.4 : MATING VIEW



NOTES 1 LEAD CO-PLANARITY SHALL BE 0.1mm MAX.
 2 BLACK, UL94V-0
 3 WHEN A PART MARKED WITH HAS A PATTERN BUT NO RESIST ON IT, TAKE CARE TO PREVENT THE CONNECTOR FROM TOUCHING IT.

NO.	MATERIAL	FINISH, REMARKS	NO.	MATERIAL	FINISH, REMARKS
2	PHOSPHOR BRONZE		4	POLYESTER	CLEAR
1	LCP		3	PS	CLEAR

CODE NO. (OLD)	DRAWN	DESIGNED	CHECKED	APPROVED	RELEASED
	F. Matsuki	T. Yamamoto	T. Saketa	T. Saketa	
	'03.12.11	'03.12.11	'03.12.11	'03.12.11	

DRAWING NO.	PART NO.
EDC3-164003-03	DF23C-20DP-0.5V(92)

SCALE	CODE NO.
10 : 1	CL688-0801-8-92

UNITS	
mm	



HIROSE ELECTRIC CO., LTD.



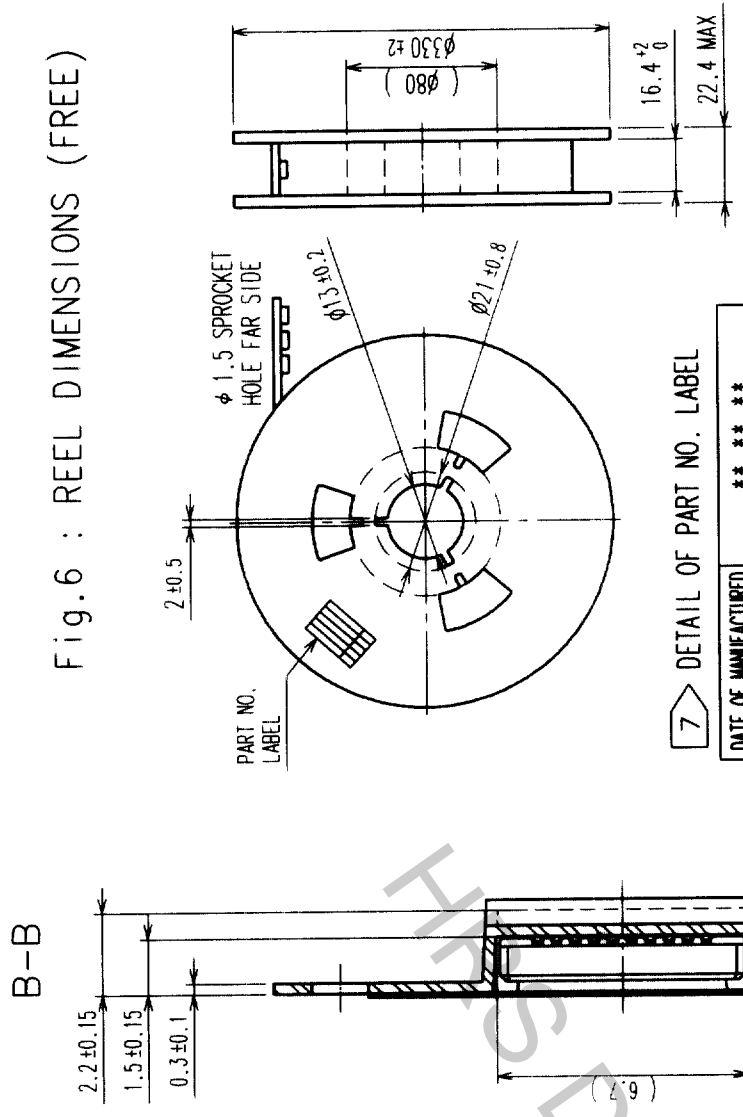
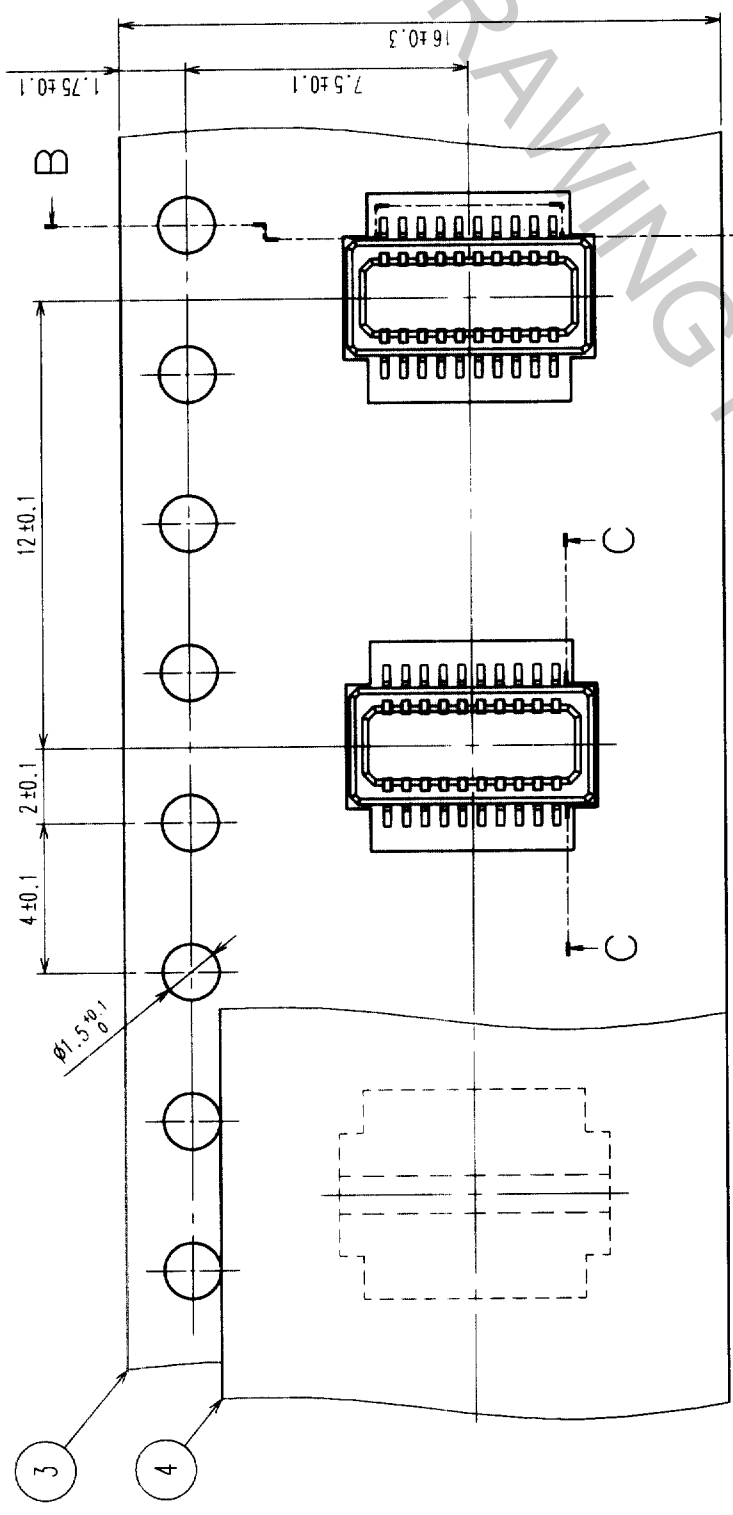

Fig. 6 : REEL DIMENSIONS (FREE)

7 **DETAIL OF PART NO. LABEL**

DATE OF MANUFACTURED	*** ** *
CODE NO.	CL688-0801-8-92
PART NO.	DF23C-20DP-0.5V(92)
QUANTITY	2000
SUPPLIER	HIROSE ELECTRIC CO., LTD.



6 Fig. 5 : TAPING (FREE)

DIRECTION OF UNREELING →

DETAIL OF LABEL

品名	688-0801-8-92	数量	1RL
PART NO.	DF23C-20DP-0.5V(92)	QTY	2000
PART NO.	NUMBER OF PRODUCTS PER REEL		
CODE NO.	NUMBER OF REELS PER BOX		

Fig. 7 : PACKAGING SPECIFICATION (FREE)

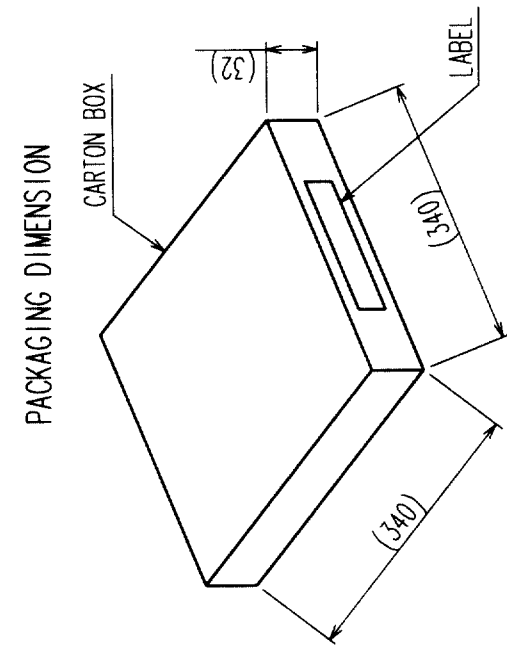

TRAILER

NOTES
 4 PER REEL 2000 CONNECTORS
 5 THE DIMENSIONS IN PARENTHESES ARE FOR REFERENCE.
 6 REFER TO JIS C 0806
 (PACKAGING OF COMPONENTS FOR AUTOMATIC HANDLING)
 7 DETAIL OF PART NO. LABEL IS WRITTEN IN JAPANESE.

LEADER

CODE NO. (OLD)	DRAWN	DESIGNED	CHECKED	APPROVED	RELEASED
	F. Matsuki	T. Yamamoto	T. Saito	T. Saito	
	'03.12.11	'03.12.11	'03.12.11	'03.12.11	
DRAWING NO.	PART NO.	DRAWING NO.			
EDC3-164003-03	DF23C-20DP-0.5V(92)	DF23C-20DP-0.5V(92)			
SCALE	UNITS	CODE NO.			
5 : 1	mm	CL688-0801-8-92			
		2			

TO

TO

TO

TO