

N = Number of poles  
 Dim A=Nx5.0  
 Dim B=(N-1)x5.0

	Dim A	Dim B
2-4p	±0.15	±0.10
5-7p	±0.20	±0.20

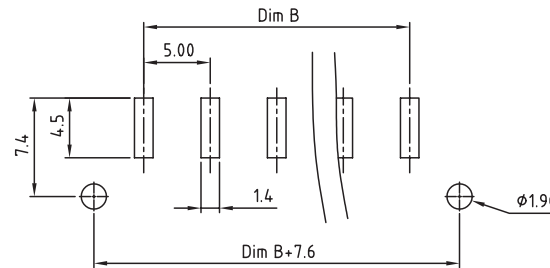
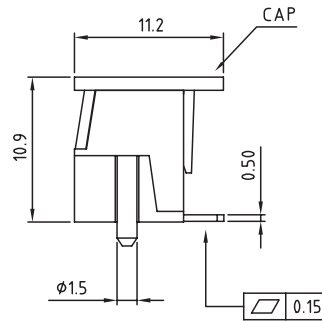
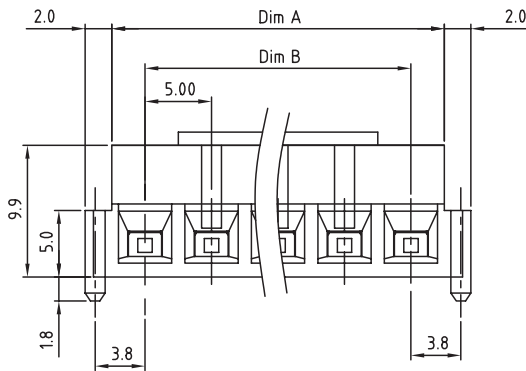

PCB LAYOUT - COMPONENT VIEW

TECHNICAL CHARACTERISTICS

MATERIAL

INSULATOR: HI TEMP PA46  
 FLAMABILITY RATING: UL94-V0  
 COLOR: BLACK  
 METAL HOUSING: BRASS (CuZn)  
 TERMINAL SCREW: STEEL ZINC PLATING "-" SLOT TYPE  
 WIRE GUARD: STAINLESS STEEL  
 SURFACE OF SOLDER TAIL PLATING: TIN

ENVIRONMENTAL

OPERATING TEMPERATURE: -40 UP TO 130°C  
 COMPLIANCE: LEAD FREE AND ROHS

ELECTRICAL

CURRENT RATING: 6A  
 WORKING VOLTAGE: 300VAC  
 WITHSTANDING VOLTAGE: 1.6KV  
 CONTACT RESISTANCE: 20 mOhm MAX

STANDARD

UL CERTIFIED E315414 / MODEL NUMBER 7097

MECHANICAL

SOLID WIRE: 30-14 AWG / 0.05-2.0MM<sup>2</sup>  
 STRANDED WIRE: 30-14 AWG / 0.05-2.0MM<sup>2</sup>  
 TORQUE: 3.5Lb.In / 0.4Nm

WIRE STRIPE LENGTH: 7-8mm  
 SCREW: M3  
 PITCH: 5.0mm

SOLDERING: REFLOW SOLDERING

PACKAGING: TAPE & REEL WITH CAP  
 SERIE 7097

RoHS Compliant

G			
F			
E			
D			
C			
B	17-AUG-10	DIMENSION	GG
A	21-JUN-10	PDF	JP
REV	DATE	FILE	BY

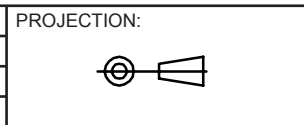

GENERAL TOLERANCE  
 .X = +/- 0.2  
 .XX = +/- 0.15



APPROVAL: RJ

UNIT: MM  
 SCALE:  
 SHEET: 1/1  
 DRAW: MARVIN

DESCRIPTION: SERIE 7097 -SMD 5.0MM HORIZONTAL ENTRY MODULAR WITH PRESSURE CLAMP - 2.0MM<sup>2</sup> WIRES WR-TBL  
 WERI PART NO: 691 709 710 3xx

SIZE  
**A4**