

REVISIONS			
REV	DESCRIPTION, ECN, EAR NO.	DATE	APP'D
C	ADJUSTED TOLERANCES	SEP05/13	S.M.
D	HOUSING HEIGHT	OCT31/13	S.M.
E	HOUSING MATERIAL CHANGE	NOV27/13	S.M.
F	CURRENT TO MATCH 18 PIN	MAR03/15	S.M.

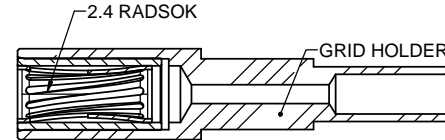

SOCKET CONTACT
ASSEMBLY. (SECTION VIEW)
SEE NOTE 4

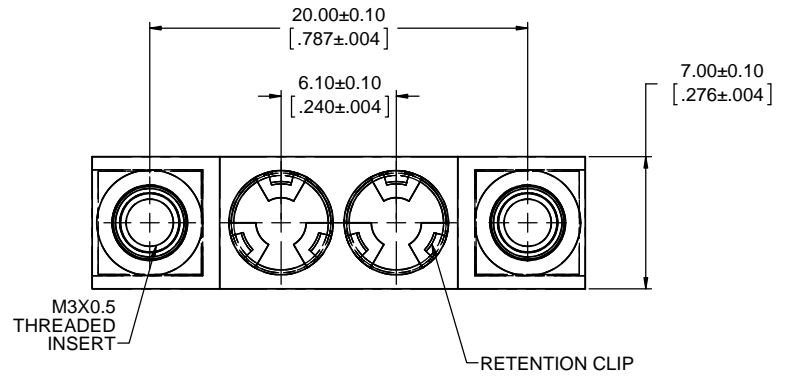
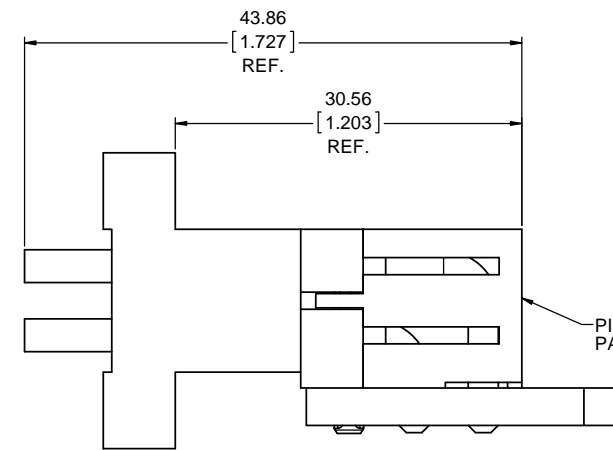
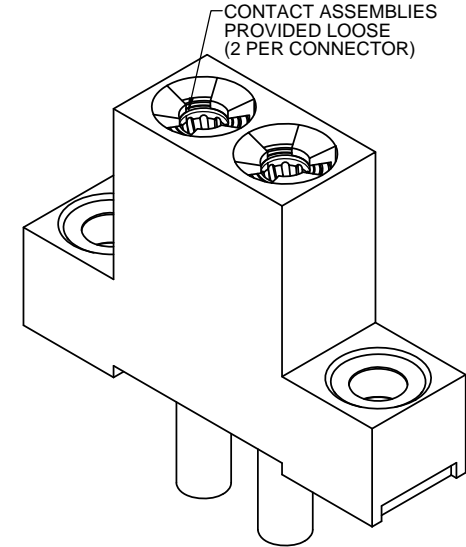

PIN AND SOCKET
CONNECTORS MATED

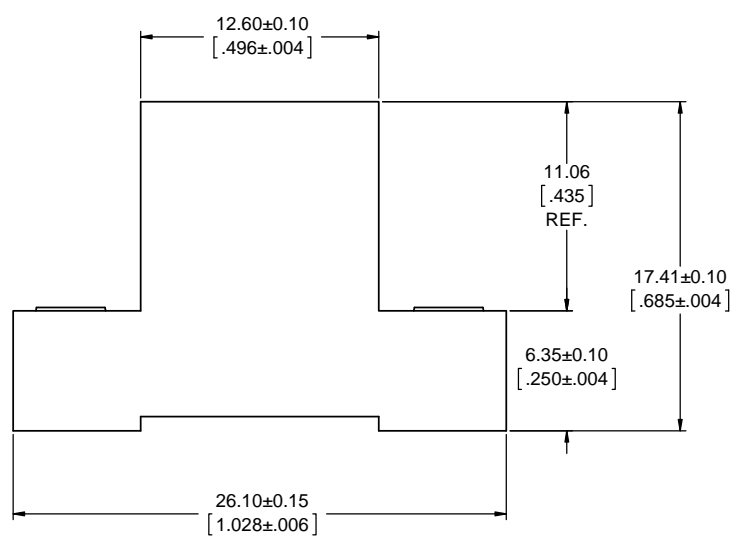

NOTES:

- MATERIALS: ALL MATERIALS ARE RoHS COMPLIANT PER EU DIRECTIVE 2011/65/EU
 - HOUSING: HIGH TEMPERATURE GLASS FILLED LCP, UL FLAMABILITY RATING 94V-0 COLOUR BLACK
 - RADSOK POWER CONTACTS: COPPER ALLOY PLATED WITH 5.08µm (200µ") SILVER OVER 1.27µm (50µ") MIN NICKEL
- ELECTRICAL CHARACTERISTICS
 - CURRENT RATING: 18A PER CONTACT
 - OPERATING TEMPERATURE: -55°C TO +105°C
 - DIELECTRIC WITHSTANDING VOLTAGE: 1500 VDC
 - INSULATION RESISTANCE: 5000 MEGAOHMS
- CRIMP #16 AWG WIRE TO CONTACTS BEFORE ASSEMBLY INTO HOUSING
- SOCKET CONTACT ASSEMBLIES SUPPLIED BULK PACKED



UNLESS SPECIFIED OTHERWISE	DRAWN	C.KWOK	SEP4/13
PRIMARY UNITS MILLIMETERS	CHECKED	S.MUGAN	SEP4/13
SECONDARY UNITS INCHES	M.E. APP'D		
REFERENCE IN PARENTHESES	Q.A. APP'D		
GENERAL TOLERANCES	DWG APPR.		
1 DECIMAL PLACE	ENG. REL. NO.		
2 DECIMAL PLACES ±0.20	REF.		
3 DECIMAL PLACES XXXXXX	THIRD ANGLE PROJECTION		
ANGULAR DEGREES ±5°	DO NOT SCALE DRAWING		

Amphenol Canada Corp.
www.amphenolcanada.com

DWR SERIES SLIM DRAWER, 2 POWER, SOCKET CONNECTOR, 16 AWG, CRIMP TERMINATION
RoHS COMPLIANT

DWG. NO. **P-DWR-P1S-C1200-1A5** REV **F**

CODE ID NO. 03554 DWG SIZE: X SCALE: 5:1 SHEET 1 OF 1