

This document is the property of Amphenol Corporation and is delivered on the express condition that is not to be disclosed, reproduced or used, in whole or in part, for manufacture or sale by anyone other than Amphenol Corporation without its prior consent, and that no right is granted to disclose or to use any information in this document.

The marking on this product doesn't contain environmental hazardous materials per Material Specification 55-00259 for Sony GP compliant or per directive 2011/65/EU for RoHS compliant.

FOR REFERENCE ONLY

REVISIONS				
SYM	ECN No.	DESCRIPTION	DATE	APPROVED
A	NE-14124	RELEASE FOR RoHS	06/24/2014	Arron Lin
BX1		ADD LCP NATURAL OPTION	01/08/2014	Arron Lin
BX2		ADDED BOARDLOCK OPTION	03/24/2015	Roger Tsai
BX3		ADDED TAIL OPTION	10/12/2015	Roger Tsai

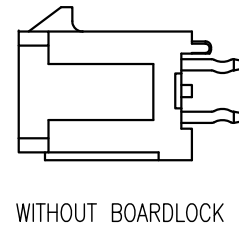
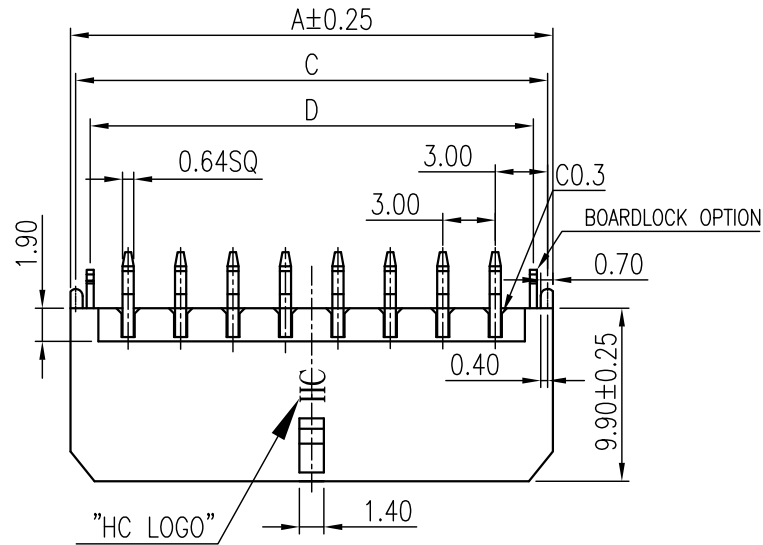

NOTE:

- 1.MATERIAL**
INSULATOR: HIGH TEMP. THERMOPLASTIC, LCP, UL 94V-0, COLOR BLACK
CONTACT MATERIAL: HIGH PERFORMANCE COPPER ALLOY.
BOARDLOCK: COPPER ALLOY.
- 2.FINISH:**
CONTACT: SELECTIVE PLATING. ;
SOLDERING AREA: MATTE TIN 100u" MIN. OR GOLD PLATING;
UNDER PLATING: NICKEL PLATING 50 u" THICKNESS MIN.OVERALL.
BOARDLOCK:
MATTE TIN 100u" MIN. PLATING;
UNDER PLATING: NICKEL PLATING 50 u" THICKNESS MIN.OVERALL.
- 4.THIS PRODUCT DOESN'T ENVIRONMENTAL HAZARDOUS**
MATERIALS PER DIRECTIVE 2011/65/EU FOR RoHS.
- 5.APPLICABLE P.C.BOARD THICKNESS: 1.60mm**
- 6.PRODUCT SPECIFICATION REFER TO : PS-7528**
- 7.PACKING MUST BE PER AMPHENOL PACKING SPECIFICATION**
- 8.TO ENSURE CURRENT RATING CAPABILITY, AMPHENOL HIGH CURRENT PART NUMBERS IN THE CHART ARE RECOMMENDED.**
(G88MPH CABLE HOUSING SERIES WITH G88MPC CABLE TERMINAL SERIES)

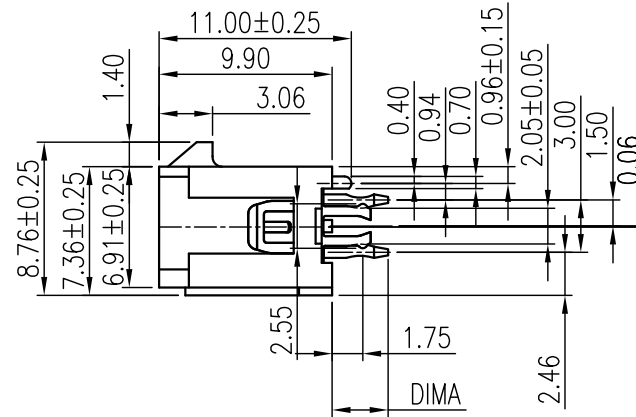
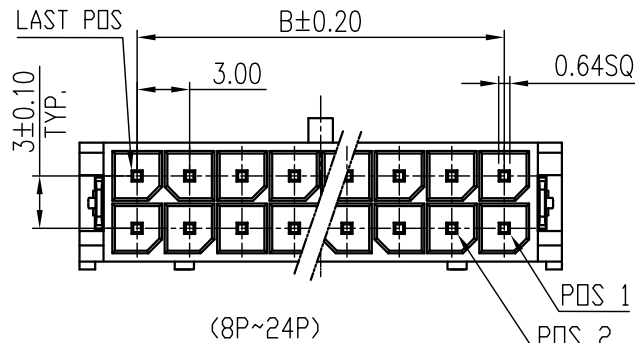

POS	A	B	C	D
02	6.60		6.00	4.3
04	9.60	3.00	9.00	7.3
06	12.60	6.00	12.00	10.3
08	15.60	9.00	15.00	13.3
10	18.60	12.00	18.00	16.3
12	21.60	15.00	21.00	19.3
14	24.60	18.00	24.00	22.3
16	27.60	21.00	27.00	25.3
18	30.60	24.00	30.00	28.3
20	33.60	27.00	33.00	31.3
22	36.60	30.00	36.00	34.3
24	39.60	33.00	39.00	37.3

PART NO. G88MPXX1XXXEU

No. OF CIRCUIT

CONTACT FINISH
0: MATTE TIN (OVERALL)
UNDER PLATING NICKEL
50 u" THICKNESS MIN
1: FLASH GOLD (OVERALL)
2: 15 u" GOLD
3: 30 u" GOLD

BOARDLOCK OPTION
K: WITH BOARDLOCK
M: WITHOUT BOARDLOCK

INSULATOR, TAIL DIMA
1: LCP(NATURAL), 3.20±0.25
2: LCP (BLACK), 3.20±0.25
5: LCP(NATURAL), 2.80^{+0.25}_{-0.00}
6: LCP (BLACK), 2.80^{+0.25}_{-0.00}

TOLERANCE	APPROVALS	DATE	TITLE	UNIT	SIZE	PART No.
X. X.X ±0.30 X.XX ±0.20 X.XXX ±0.10	DRAWN Aqua Chou	10/12/2015	G88MP SERIES MICRO POWER PLUS, WAFER 3.00 MM PITCH STRAIGHT DIP, W/KINK BLOCK (TRAY PACKING)	mm	A3	G88MPXX1XXXEU
	CHECKED Roger Tsai	10/12/2015				
	APPROVED Roger Tsai	10/12/2015				
ANGULAR ±1°	DWG TYPE CUST DWG	PROJECT CODE PHD		SCALE NA	SHEET 1 OF 4	DWG No. G88MPXX1XXXEU
UNLESS OTHERWISE SPECIFIED						REV. BX3

This document is the property of Amphenol Corporation and is delivered on the express condition that it is not to be disclosed, reproduced or used, in whole or in part, for manufacture or sale by anyone other than Amphenol Corporation without its prior consent, and that no right is granted to disclose or to use any information in this document.

The marking on this product doesn't contain environmental hazardous materials per Material Specification SS-00259 for Sony GP compliant or per directive 2011/65/EU for RoHS compliant.

FOR REFERENCE ONLY

REVISIONS				
SYM	ECN No.	DESCRIPTION	DATE	APPROVED
A	NE-14124	RELEASE FOR RoHS	06/24/2014	Arron Lin
BX1		ADD LCP NATURAL OPTION	01/08/2014	Arron Lin
BX2		ADDED BOARDLOCK OPTION	03/24/2015	Roger Tsai
BX3		ADDED TAIL OPTION	10/12/2015	Roger Tsai

6.60±0.25

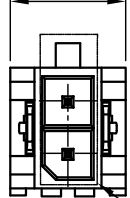

DETAIL D

(2X1PDS)

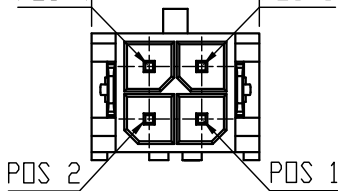
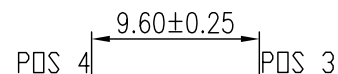

(2X2PDS)

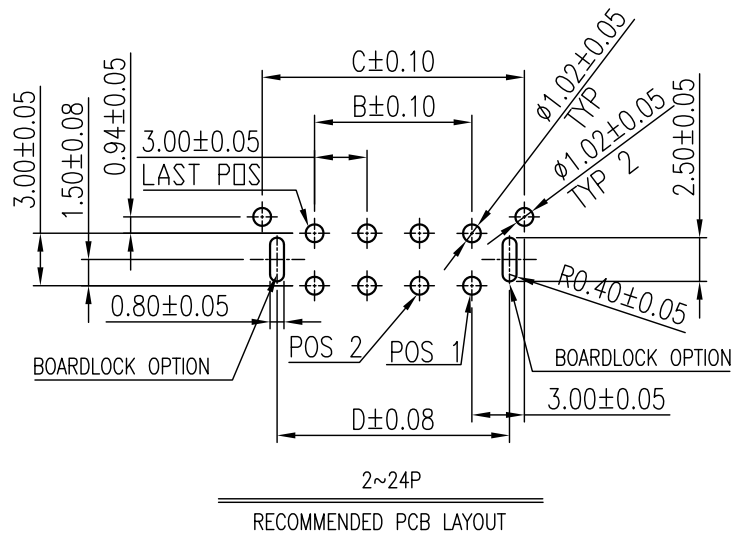
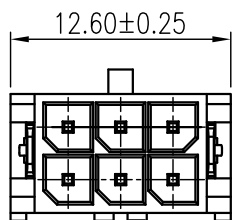

RECOMMENDED PCB LAYOUT

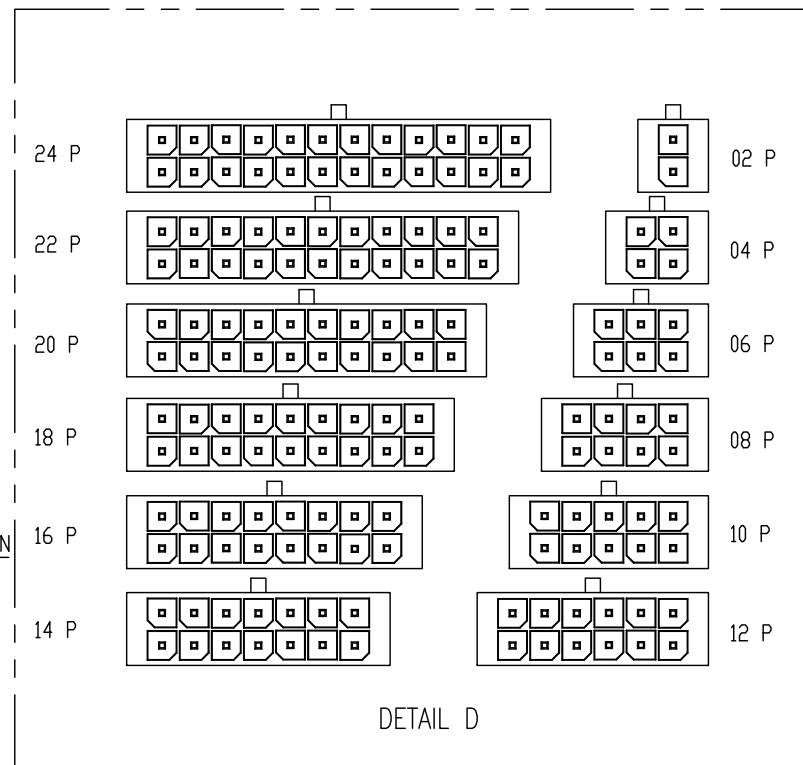

DETAIL D

TOLERANCE		APPROVALS		DATE	TITLE		Amphenol®							
X.		DRAWN	Aqua Chou	10/12/2015	G88MP SERIES MICRO POWER PLUS, WAFER 3.00 MM PITCH STRAIGHT DIP, W/KINK BLOCK (TRAY PACKING)		Amphenol Corporation Amphenol Taiwan Corporation							
X.X	±0.30	CHECKED	Roger Tsai	10/12/2015										
X.XX	±0.20	APPROVED	Roger Tsai	10/12/2015										
X.XXX	±0.10						UNIT	mm	SIZE	A3	PART No.	G88MPXX1XXXEU		
ANGULAR	±1°						SCALE	NA	SHEET	2 OF 4	DWG No.	G88MPXX1XXXEU	REV.	BX3
UNLESS OTHERWISE SPECIFIED		DWG TYPE		CUST DWG	PROJECT CODE		PHD							

This document is the property of Amphenol Corporation and is delivered on the express condition that is not to be disclosed, reproduced or used, in whole or in part, for manufacture or sale by anyone other than Amphenol Corporation without its prior consent, and that no right is granted to disclose or to use any information in this document.

The marking on this product doesn't contain environmental hazardous materials per Material Specification 55-00259 for Sony GP compliant or per directive 2011/65/EU for RoHS compliant.

FOR REFERENCE ONLY

REVISIONS				
SYM	ECN No.	DESCRIPTION	DATE	APPROVED
A	NE-14124	RELEASE FOR RoHS	06/24/2014	Arron Lin
BX1		ADD LCP NATURAL OPTION	01/08/2014	Arron Lin
BX2		ADDED BOARDLOCK OPTION	03/24/2015	Roger Tsai
BX3		ADDED TAIL OPTION	10/12/2015	Roger Tsai

POS.	BOARD-MOUNT P/N	CABLE HOUSING P/N	CABLE TERMINAL P/N	AWG NO.	PLATING OPTIONS
02	G88MP021XXXEU	G88MPH0222CEU	G88MPCX232CEU	AWG#16~18	0: TIN 100u" ; 1: FLASH GOLD
			G88MPCX332CEU	AWG#20~30	2: 15u" GOLD ; 3: 30u" GOLD
04	G88MP041XXXEU	G88MPH0422CEU	G88MPCX232CEU	AWG#16~18	0: TIN 100u" ; 1: FLASH GOLD
			G88MPCX332CEU	AWG#20~30	2: 15u" GOLD ; 3: 30u" GOLD
06	G88MP061XXXEU	G88MPH0622CEU	G88MPCX232CEU	AWG#16~18	0: TIN 100u" ; 1: FLASH GOLD
			G88MPCX332CEU	AWG#20~30	2: 15u" GOLD ; 3: 30u" GOLD
08	G88MP081XXXEU	G88MPH0822CEU	G88MPCX232CEU	AWG#16~18	0: TIN 100u" ; 1: FLASH GOLD
			G88MPCX332CEU	AWG#20~30	2: 15u" GOLD ; 3: 30u" GOLD
10	G88MP101XXXEU	G88MPH1022CEU	G88MPCX232CEU	AWG#16~18	0: TIN 100u" ; 1: FLASH GOLD
			G88MPCX332CEU	AWG#20~30	2: 15u" GOLD ; 3: 30u" GOLD
12	G88MP121XXXEU	G88MPH1222CEU	G88MPCX232CEU	AWG#16~18	0: TIN 100u" ; 1: FLASH GOLD
			G88MPCX332CEU	AWG#20~30	2: 15u" GOLD ; 3: 30u" GOLD
14	G88MP141XXXEU	G88MPH1422CEU	G88MPCX232CEU	AWG#16~18	0: TIN 100u" ; 1: FLASH GOLD
			G88MPCX332CEU	AWG#20~30	2: 15u" GOLD ; 3: 30u" GOLD
16	G88MP161XXXEU	G88MPH1622CEU	G88MPCX232CEU	AWG#16~18	0: TIN 100u" ; 1: FLASH GOLD
			G88MPCX332CEU	AWG#20~30	2: 15u" GOLD ; 3: 30u" GOLD
18	G88MP181XXXEU	G88MPH1822CEU	G88MPCX232CEU	AWG#16~18	0: TIN 100u" ; 1: FLASH GOLD
			G88MPCX332CEU	AWG#20~30	2: 15u" GOLD ; 3: 30u" GOLD
20	G88MP201XXXEU	G88MPH2022CEU	G88MPCX232CEU	AWG#16~18	0: TIN 100u" ; 1: FLASH GOLD
			G88MPCX332CEU	AWG#20~30	2: 15u" GOLD ; 3: 30u" GOLD
22	G88MP221XXXEU	G88MPH2222CEU	G88MPCX232CEU	AWG#16~18	0: TIN 100u" ; 1: FLASH GOLD
			G88MPCX332CEU	AWG#20~30	2: 15u" GOLD ; 3: 30u" GOLD
24	G88MP241XXXEU	G88MPH2422CEU	G88MPCX232CEU	AWG#16~18	0: TIN 100u" ; 1: FLASH GOLD
			G88MPCX332CEU	AWG#20~30	2: 15u" GOLD ; 3: 30u" GOLD

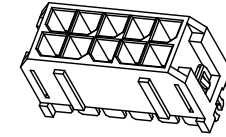

AMPHENOL BOARD-MOUNT

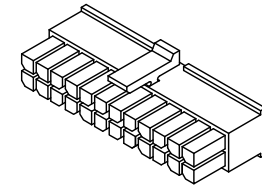

AMPHENOL CABLE HOUSING

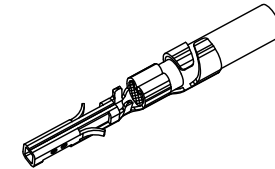

AMPHENOL CABLE TERMINAL

NOTE:
 TO ENSURE CURRENT RATING CAPABILITY,
 AMPHENOL HIGH CURRENT PART NUMBERS IN THE
 CHART ARE RECOMMENDED.
 (G88MPH CABLE HOUSING SERIES WITH G88MPC
 CABLE TERMINAL SERIES)

TOLERANCE		APPROVALS		DATE	TITLE	G88MP SERIES MICRO POWER PLUS, WAFER 3.00 MM PITCH STRAIGHT DIP, W/KINK BLOCK (TRAY PACKING)		Amphenol [®] Amphenol Corporation Amphenol Taiwan Corporation			
X.		DRAWN	Aqua Chou	10/12/2015		UNIT	mm	SIZE	A3	PART No.	G88MPXX1XXXEU
X.X	±0.30	CHECKED	Roger Tsai	10/12/2015		SCALE	NA	SHEET	3 OF 4	DWG No.	G88MPXX1XXXEU
X.XXX	±0.10	APPROVED	Roger Tsai	10/12/2015		REV.	BX3				
ANGULAR ±1°		DWG TYPE		PROJECT CODE							
UNLESS OTHERWISE SPECIFIED		CUST DWG		PHD							

This document is the property of Amphenol Corporation and is delivered on the express condition that is not to be disclosed, reproduced or used, in whole or in part, for manufacture or sale by anyone other than Amphenol Corporation without its prior consent, and that no right is granted to disclose or to use any information in this document.

The marking on this product doesn't contain environmental hazardous materials per Material Specification 55-00259 for Sony GP compliant or per directive 2011/65/EU for RoHS compliant.

FOR REFERENCE ONLY

REVISIONS				
SYM	ECN No.	DESCRIPTION	DATE	APPROVED
A	NE-14124	RELEASE FOR RoHS	06/24/2014	Arron Lin
BX1		ADD LCP NATURAL OPTION	01/08/2014	Arron Lin
BX2		ADDED BOARDLOCK OPTION	03/24/2015	Roger Tsai
BX3		ADDED TAIL OPTION	10/12/2015	Roger Tsai

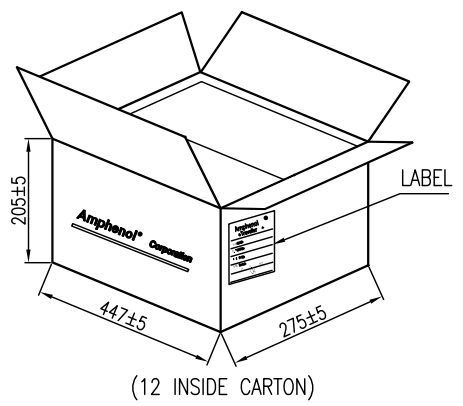
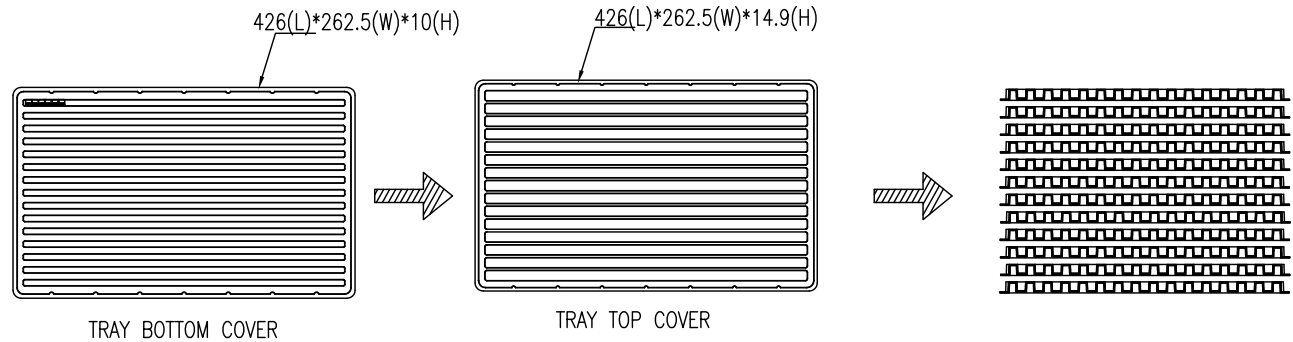

POS	PCS/TRAY	PCS/CARTON
02	900	10800
04	615	7380
06	465	5580
08	375	4500
10	315	3780
12	270	3240
14	240	2880
16	210	2520
18	180	2160
20	165	1980
22	150	1800
24	150	1800

- NOTE:
1. MATERIAL : BLACK CONDUCTIVE POLYSTYRENE ALLOY
 2. ALL DIMENSIONS MEET EIA-481-C REQUIREMENTS.
 3. THICKNESS : 0.80±0.05mm.

TOLERANCE		APPROVALS		DATE	TITLE		Amphenol [®]			
X.		DRAWN	Aqua Chou	10/12/2015	G88MP SERIES MICRO POWER PLUS, WAFER 3.00 MM PITCH STRAIGHT DIP, W/KINK BLOCK (TRAY PACKING)		Amphenol Corporation Amphenol Taiwan Corporation			
X.X	±0.30	CHECKED	Roger Tsai	10/12/2015						
X.XX	±0.20	APPROVED	Roger Tsai	10/12/2015						
X.XXX	±0.10						UNIT	mm	SIZE	A3
ANGULAR	±1°	DWG TYPE		PROJECT CODE			SCALE	NA	SHEET	4 OF 4
UNLESS OTHERWISE SPECIFIED		CUST DWG		PHD			PART No.		G88MPXX1XXXEU	
							DWG No.		G88MPXX1XXXEU	
							REV.		BX3	