

PANDUIT PART #	WIRE RANGE (ACCEPTS 2 WIRES)		COLOR (DIN)	WIRE STRIP LENGTH +1/32 -0 [+0,8 -0]	MAX. WIRE INSUL. DIA.	WIRE CLASS	DIMENSIONS in. [mm]						INSTALLATION TOOLS
	AWG 2X	[mm <sup>2</sup> ] 2X					L	P	ID	OD (REF.)	B (REF.)	T	
*FTD75-8	22-20	[0,5]	WHITE	7/16 [11,2]	.09 [2,4]	B, K, M	.59 [15,0]	.31 [8,0]	.06 [1,5]	.07 [1,8]	.18 [4,6]	.01 [0,3]	CT-1002 CT-1003 CT-1123
FTD76-8	18	[0,75]	GREY	7/16 [11,2]	.09 [2,4]	B, K, M	.59 [15,0]	.31 [8,0]	.07 [1,8]	.08 [2,0]	.20 [5,0]		
FTD76-10	18	[0,75]	GREY	9/16 [14,0]	.09 [2,4]	B, K, M	.67 [17,0]	.39 [10,0]	.07 [1,8]	.08 [2,0]	.20 [5,0]		
FTD77-8	18	[1,0]	RED	7/16 [11,2]	.11 [2,8]	B, K, M	.59 [15,0]	.31 [8,0]	.08 [2,0]	.09 [2,3]	.20 [5,0]		
FTD77-10	18	[1,0]	RED	9/16 [14,0]	.11 [2,8]	B, K, M	.67 [17,0]	.39 [10,0]	.08 [2,0]	.09 [2,3]	.20 [5,0]		
FTD78-8	16	[1,5]	BLACK	7/16 [11,2]	.12 [3,0]	B, K, M	.63 [16,0]	.31 [8,0]	.09 [2,3]	.10 [2,5]	.25 [6,4]		
FTD78-12	16	[1,5]	BLACK	21/32 [16,8]	.12 [3,0]	B, K, M	.79 [20,0]	.47 [12,0]	.09 [2,3]	.10 [2,5]	.25 [6,4]		
FTD80-10	14	[2,5]	BLUE	9/16 [14,0]	.15 [3,8]	K, M	.73 [18,5]	.39 [10,0]	.11 [2,8]	.13 [3,3]	.30 [7,6]		
FTD80-13	14	[2,5]	BLUE	23/32 [18,2]	.15 [3,8]	K, M	.85 [21,5]	.51 [13,0]	.11 [2,8]	.13 [3,3]	.30 [7,6]		
FTD81-12	12	[4,0]	GREY	21/32 [16,8]	.17 [4,3]	G, K, M	.91 [23,0]	.47 [12,0]	.15 [3,8]	.17 [4,3]	.34 [8,6]		
FTD82-14	10	[6,0]	YELLOW	3/4 [19,0]	.19 [4,8]	G, I, K, M	.98 [25,0]	.55 [14,0]	.18 [4,6]	.20 [5,0]	.38 [9,7]	CT-1002, +CT-1003, CT-1123	
FTD83-14	8	[10,0]	RED	3/4 [19,0]	.28 [7,1]	G, H, I, K, M	1.02 [26,0]	.55 [14,0]	.26 [6,6]	.27 [6,9]	.50 [12,7]	+CT-1003, CT-1004, CT-1104	
FTD84-16	6	[16,0]	BLUE	13/16 [21,0]	.35 [8,9]	G, H, I, K, M	1.22 [31,0]	.63 [16,0]	.33 [8,4]	.35 [8,9]	.65 [16,5]	CT-1005	

\* UL LISTED WITH 20 AWG ONLY, UL486F SCOPE IS 20 - 1/0 AWG. WHITE IS DIN COLOR FOR 20 AWG [0,5]  
+ TOOL/PART IS NOT A UL LISTED COMBINATION

**NOTES:**

- 1. USED FOR:
  - A. UL LISTED WITH STRANDED COPPER WIRE ONLY
  - B. 221°F [105°C] MAX. OPERATING TEMPERATURE
- 2. MATERIAL:
  - A. STAMPING: COPPER, TIN PLATED
  - B. HOUSING: POLYPROPYLENE, COLOR CODED
  - C. COLOR CODE CONFORMS TO DIN STANDARD
- 3. SEE [www.panduit.com](http://www.panduit.com) FOR PACKAGE QUANTITIES
- 4. DIMENSIONS IN BRACKETS ARE METRIC EQUIVALENT
- 5. DIMENSIONAL PART TOLERANCE +/-0.016 [0,4]

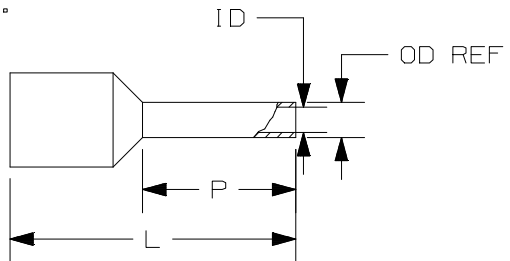
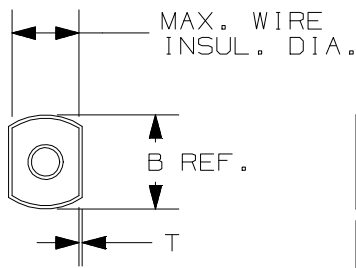

REV	DATE	BY	CHK	APR	DESCRIPTION	ECN
16	01.20.16	TMR	TMR	RGB	UPDATED WIRE STRIP LENGTH FOR FTD82, FTD83 & FTD84	A41669
15	06.05.15	TMR	TMR	RGB	ADDED WIRE CLASS, REVISED UL LISTED TOOLS	A41669
14	04.13.15	TMR	TMR	RGB	NOTE 5 TOLERANCE REFERRED TO DIN 46228 PART 4	A41669
13	03.09.15	JHNU	TMR	RGB	FTD76 WAS 20 AWG	A41669
12	12.05.14	JHNU	TMR	RGB	ADDED cULus LOGO REVISED NOTE 1A, ADDED NOTE 2C	A41669
11	02.19.13	JBN	BCT	VMB	REVISED NOTES; ADDED CSA LOGO UPDATED DRAWING TO CURRENT STANDARDS	A41669

TITLE			
<b>FERRULES WITH SLEEVES TWIN WIRE (DIN) FTD: 2 WIRES INSERTED INTO FERRULE</b> CUSTOMER DRAWING			
ITEM REVISION NAME	N41669BA/16		
DATASET FILE NAME	N41669BA_DC/16		
UNLESS OTHERWISE SPECIFIED, DIMENSIONAL TOLERANCES ARE: IN [mm]			MATERIAL:
.X ±                                    .XXX ± .XX ±                                    ANGLES ±			SEE NOTES
DRAWING NUMBER:		A41669	
DRAWN BY	DATE	CHK	SCALE
JKD	-	SKB	N.T.S.
SHEET 1 OF 1		SIZE A	