

A-A SECTION

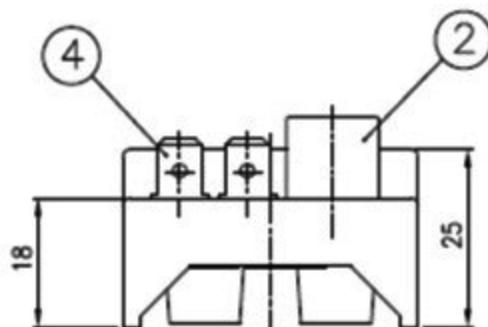
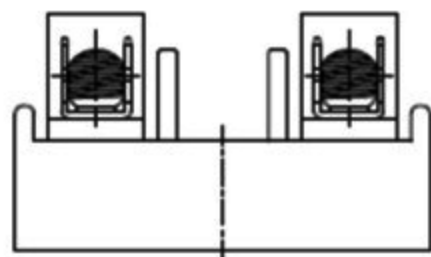
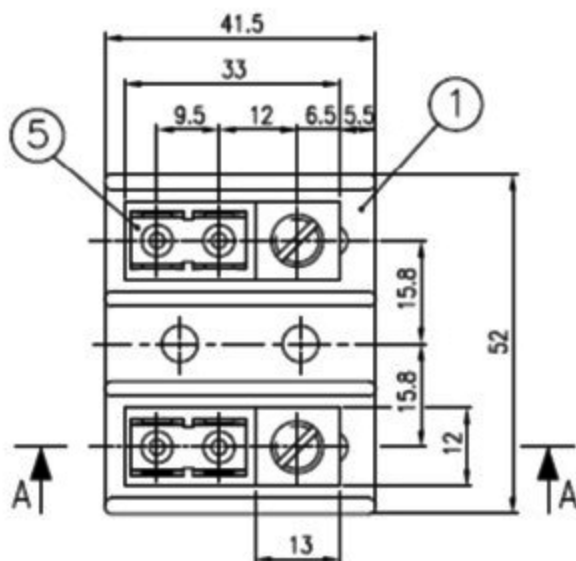

DIMENSIONAL TOLERANCE							
DIMENSION				ROUNDEDNESS AND CHAMFER			
MIN	MAX	MIN	MAX	MIN	MAX	MIN	MAX
3~6	6~30	30~120	200~1000	3~6	6~10	10~15	15~30
±0.2	±0.3	±0.5	±0.8	±1.2	±0.4	±1	±2

SPECIFICATIONS

VOLTAGE RATINGS: 300V  
 CURRENT RATINGS: 50A  
 CONDUCTORS: ALUMINUM  
 MATERIALS: BAKELITE UL94V-0  
 SUITABLE WIRE:  
 LINE: 2~14 AWG CU  
 LOAD: .25 QC Tab Terminals  
 WIRING TORQUE:  
 LINE:  
 2~3 AWG 50 LB-IN  
 4~6 AWG 45 LB-IN  
 8 AWG 40 LB-IN  
 10~14 AWG 35 LB-IN  
 LOAD:  
 .25 OC Tab Terminals  
 CERTIFICATION MARKING: UL CUL

5	Rivet	COPPER ; #3	4	NI PLATED	RI1	
4	Term.	BRASS (C2680R) ; t0.8 #250	2	NI PLATED	PR1-2	
3	SCREW	SS ; 5/16-24UNF	2	260-PLATED	SC311Y	
2	CONDUCTORS	ALUMINUM AL6061	2	Sn PLATED	AL-1	
1	BASE	BAKELITE (13794) UL94V-0	1		10011-1-2P	BLACK

No.	DATE	CONTENT	REVISOR	APPROVED	NO.	PART NAME	MATERIAL	SPECIFICATION	Q'TY	FINISH	PART No.	REMARK
△	'16.07.18	ADD UL CERTIFICATION	LF	LWS	3	SCREW	SS ; 5/16-24UNF		2	260-PLATED	SC311Y	
△	'15.05.21	MATERIAL CHANGE	H.Z.L.	H.L.C.	2	CONDUCTORS	ALUMINUM AL6061		2	Sn PLATED	AL-1	
△	'15.05.14	MATERIAL CHANGE	H.Z.L.	H.L.C.	1	BASE	BAKELITE (13794) UL94V-0		1		10011-1-2P	BLACK

SCALE	DIM.	mm	DRIVEN BY	CHECKED BY	APPROVED BY	TITLE
1/1			H.Z.L.	H.L.C.	H.L.C.	TERMINAL BLOCK
BlockMaster Electronics						DWG No. HP-AT101-1-2P (H3)