

BLADE TERMINALS DIN 46 244-A6,3-0,8 CuZn TIN PLATED  
 CUT EDGES WITHOUT TIN PLATING ALLOWED  
 DEGREE OF PROTECTION ACC. TO IEC529 = DIN 40 050 Teil 9

TERMINALS IP20  
 HOUSING IP54  
 IN CONNECTION WITH A CONNECTOR HOUSING  
 MOUNTING POSITION: TERMINALS SHALL POINT DOWNWARDS  
 FOR ALL OTHER POSITIONS PROTECTION GROUP IP 20 IS VALID

PART	MATERIAL	COLOUR
HOUSING	PA 66 GF 30± 10 [%]	BLACK
BASE PLATE	PA 66 GF 30± 10 [%]	NATURE

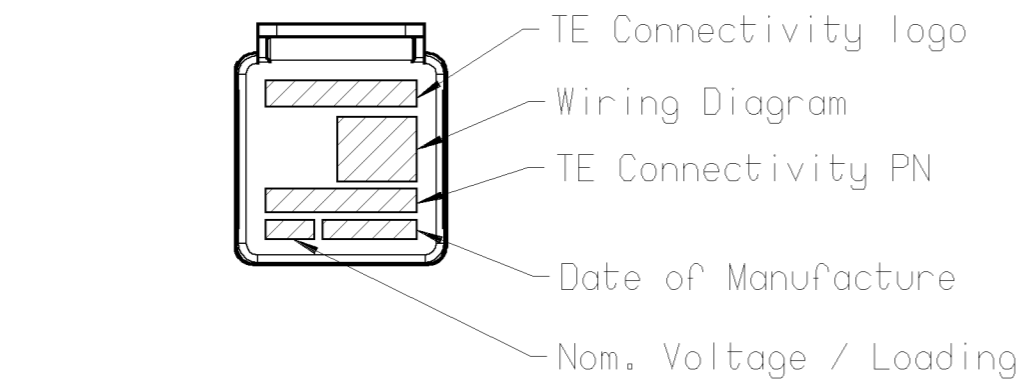

TERMINAL CONFIGURATION

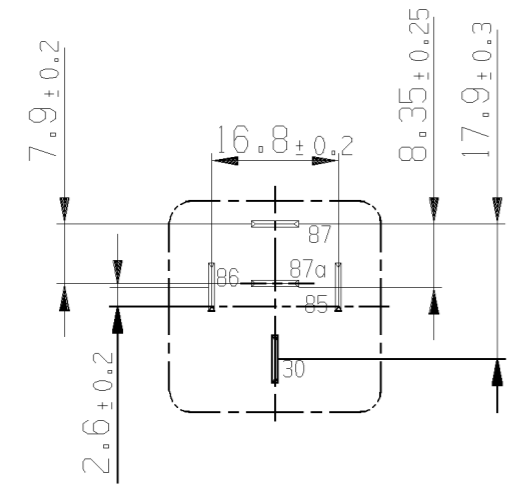

WIRING DIAGRAM

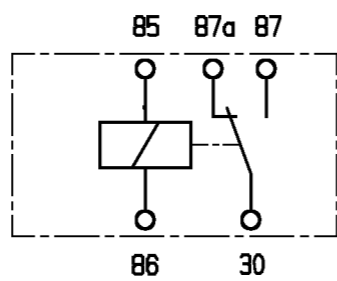

OBSOLETE BOSCH P/N	TE P/N	REV	PART NUMBER	CUSTOMER P/N	CODE NO
0 332 209 203	0-1904027-1		V23234-A1004-X050		
	1-1904027-1				
	2-1904027-1				
	3-1904027-1				
	4-1904027-1				
5-1904027-1					
PROPRIETARY THE REPRODUCTION, TRANSMISSION OR USE OF THIS DOCUMENT OR IT'S CONTENTS IS NOT PERMITTED WITHOUT EXPRESSED WRITTEN AUTHORITY. OFFENDERS WILL BE LIABLE FOR ALL DAMAGES. ALL RIGHTS, INCLUDING RIGHTS CREATED BY REGISTERED PATENT(S) GRANTED FOR A UTILITY MODEL OR DESIGN, ARE RESERVED.			CHANGES TO THIS DRAWING MUST BE DONE ONLY IN CAD		PAPER SIZE <b>A3</b>
APPLICABLE SPEC.:			FINISH DIMENSIONS APPLY PLATING SCALE <b>1:1</b> WEIGHT <b>Ca.34g</b>		
TOLERANCE UNLESS SPECIFIED OTHERWISE			DIMENSIONS IN MM		
DATE NAME DWN. 2006-06-06 P.Tomas			PART NAME <b>MINI RELAY B            CHANGEOVER 24V</b>		
B1 ECO-14-008934 12JUN2014 L.Sand APP.			PART NO. <b>V23234-A1004-X050</b>		
B ECO-12-015770 30AUG2012 A.P. REV.			SHT. <b>1</b>		
A3 INITIAL VERSION 2007-10-15 PTom LOCATION PE EVORA			CUSTOMER DRAWING		
A2 --- 2007-05-07 --			OF 2		
A1 --- 2007-07-31 --					
A --- 2006-11-02 --					
REV. CHANGE ORDER DATE APP.					



Nominal voltage (load and excitation circuit)	24 V
Permissible operating voltage	16...32 V
Permissible ambient temperature	-40...85 ° C
Response voltage (at 20 ° C)	≤ 16 V
Release voltage (at 20 ° C)	3.0...10.5 V
Response time	≤ 15 ms
Release time	≤ 15 ms
Contact material	Silver based
Equivalent coil resistance at terminal 85-86	255± 15Ω
Changeover contact:	
Voltage drop at blade terminals at a measuring current of 10± 0.5A	
Normally Open Contact, Terminal 30-87 in new condition	Typically ≤50mV, Max. 300mV
After life test	Typically ≤100mV, Max. 300mV
Normally Closed Contact, Terminal 30-87a in new condition	Typically ≤50mV, Max. 300mV
After life test	Typically ≤150mV, Max. 300mV

ELECTRICAL ENDURANCE	
Resistive Load 20A on NO	≥ 250.000 cycles
Resistive Load 10A on NC	≥ 250.000 cycles

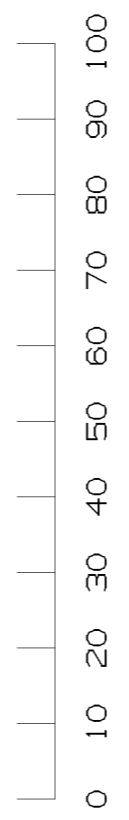

PROPRIETARY THE REPRODUCTION, TRANSMISSION OR USE OF THIS DOCUMENT OR IT'S CONTENTS IS NOT PERMITTED WITHOUT EXPRESSED WRITTEN AUTHORITY. OFFENDERS WILL BE LIABLE FOR ALL DAMAGES. ALL RIGHTS, INCLUDING RIGHTS CREATED BY REGISTERED PATENT(S) GRANTED FOR A UTILITY MODEL OR DESIGN, ARE RESERVED.				CHANGES TO THIS DRAWING MUST BE DONE ONLY IN CAD		PAPER SIZE <b>A3</b>	
APPLICABLE SPEC. #				FINISH			
				DIMENSIONS APPLY		PLATING	
				TOLERANCE UNLESS SPECIFIED OTHERWISE		SCALE	
				DIMENSIONS IN MM		WEIGHT <b>Ca. 34g</b>	
				DATE		NAME	
				DWN. 2006-06-06		P. Tomas	
				PART NAME <b>MINI RELAY B          CHANGEOVER 24V</b>			
				DATE		NAME	
B1 ECO-14-008934 12JUN2014 L.Sand APP.				B ECO-12-015770 30AUG2012 A.P. REV.		A3 INITIAL VERSION 2007-10-15 PTom LOCATION PE EVORA	
				A2 --- 2007-05-07 --		PART NO.	
				A1 --- 2007-01-31 --		<b>V23234-A1004-X050</b>	
				A --- 2006-11-02 --		SHT. <b>2</b>	
REV. CHANGE ORDER				DATE		APP.	
				CUSTOMER DRAWING			
						OF 2	

