

DO NOT
SCALE FROM
THIS PRINT

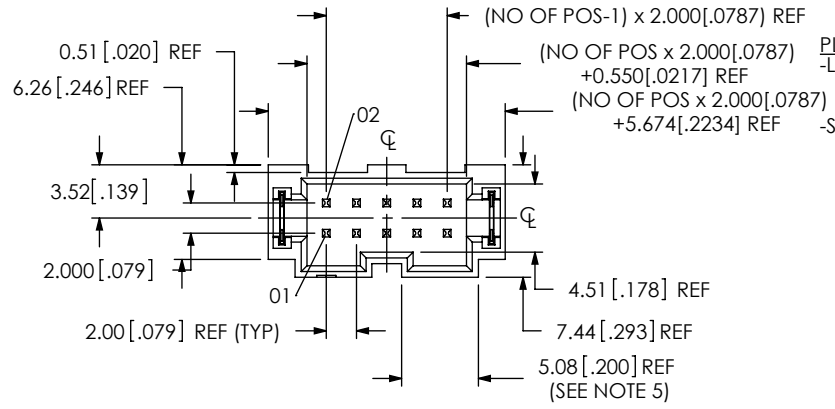

No OF POSITIONS
**-.02, **-.04, -.05, -.07, -.10, -.15,
-.20, -.25, & -.30 (PER ROW)
AVAILABLE AS STANDARD;
OTHER SIZES BETWEEN -.05
THRU -.50 AVAILABLE AS ASO

LEAD STYLE
-01

PLATING SPECIFICATION
-L: 10μ" SELECTIVE GOLD IN CONTACT
AREA, MATTE TIN ON TAIL
(USE T-1S13-XX-L-2)
-S: 30μ" SELECTIVE GOLD IN CONTACT
AREA, MATTE TIN ON TAIL
(USE T-1S13-XX-S-2)

ROW SPECIFICATION
-D: DOUBLE ROW

OPTION
-DS: DUAL SCREW DOWN (SEE FIG 6, SHT 3)
(FOR 1.57mm [.062] PCB)
(AVAILABLE 5-30 POSITIONS ONLY)
(NOT AVAILABLE WITH -RA, -WT OPTIONS)
(USE T-1S13-04-X-2 WITH TH OPTION
AND TI-M2-4-VFSM-T,
USE T-1S13-20-X-2 WITH SM OPTION
AND TI-M2-4-VFSM-T)
-K: POLYIMIDE FILM (-SM OPTION ONLY)
(USE K-DOT-.295-.406-.005, SEE FIG 4)
(NOT AVAILABLE IN -.02 OR -.04 POSITIONS)
-TR: TAPE & REEL (-SM OPTION ONLY)
(NOT AVAILABLE IN -.02 OR -.04 POSITIONS)
-WT: WELD TAB : (USE WT-25-07-T);
(-SM, SEE FIG 3, SHT 2)
(-TH, SEE FIG 5, SHT 2)
-RA: (USE WT-81-01-T)

OPTION
-TH: THROUGH HOLE (SEE FIG 1)
-RA: RIGHT ANGLE (SEE FIG 2)
-SM: SURFACE MOUNT (SEE FIG 3, SHT 2)

** = ONLY AVAILABLE WITH -SM-WT OR -RA-WT OPTIONS

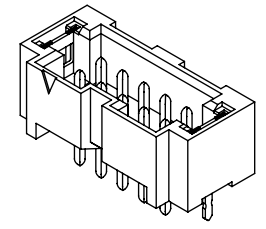
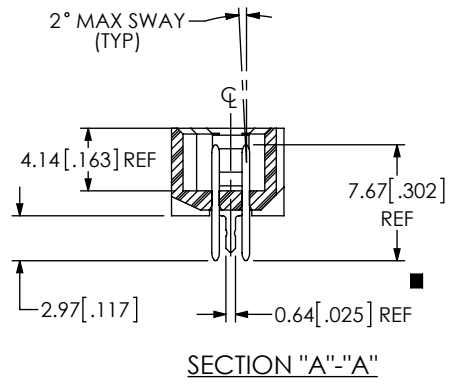
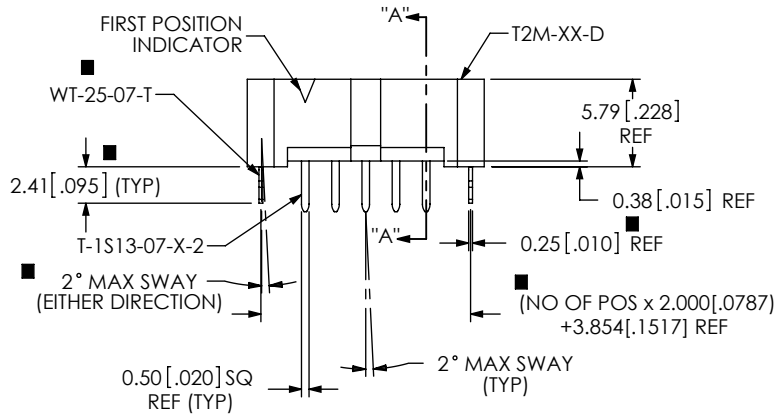

FIG 1
T2M-105-01-X-D-TH-XX
(■ = ONLY APPLICABLE WITH -WT OPTION)

NOTES:

- ⊗ REPRESENTS A CRITICAL DIMENSION.
- MINIMUM PUSHOUT FORCE: 4.44N [1.0 LB].
- POST HEIGHT VARIATION BETWEEN ANY TWO PINS: 0.13 [.005] MAXIMUM.
- MAXIMUM PIN ROTATION IN BODY TO BE 2°.
- DUAL POLARIZATION SLOT NOT AVAILABLE ON CONNECTOR WITH LESS THAN 5 POSITIONS.
- MINIMUM RETENTION FORCE FOR WELD TABS: 4.44N [1.0 LB].

UNLESS OTHERWISE SPECIFIED,
DIMENSIONS ARE IN MILLIMETERS.
TOLERANCES ARE:
DECIMALS ANGLES
X.X: ±0.3 [.01] 2°
X.XX: ±0.13 [.005]
X.XXX: ±0.051 [.0020]

PROPRIETARY NOTE
THIS DOCUMENT CONTAINS INFORMATION
CONFIDENTIAL AND PROPRIETARY TO
SAMTEC, INC. AND SHALL NOT BE REPRODUCED
OR TRANSFERRED TO OTHER DOCUMENTS OR
DISCLOSED TO OTHERS OR USED FOR ANY
PURPOSE OTHER THAN THAT WHICH IT WAS
OBTAINED WITHOUT THE EXPRESSED WRITTEN
CONSENT OF SAMTEC, INC.



520 PARK EAST BLVD, NEW ALBANY, IN 47150
PHONE: 812-944-6733 FAX: 812-948-5047
e-Mail info@SAMTEC.com code 55322

MATERIAL: DO NOT SCALE DRAWING SHEET SCALE: 2:1
INSULATOR: LCP, COLOR: BLACK
TERMINAL: PHOS BRONZE
WELD TAB: PHOS BRONZE
KAPTON: POLYIMIDE FILM

DESCRIPTION:
2mm SHROUDED TERMINAL STRIP

DWG. NO.
T2M-1XX-XX-X-D-XX-XX

BY: J. BORGELT 3/23/09 SHEET 1 OF 3

2° MAX SWAY (TYP)

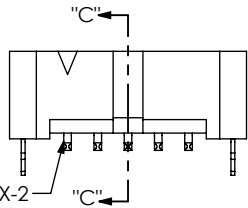
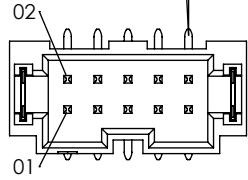
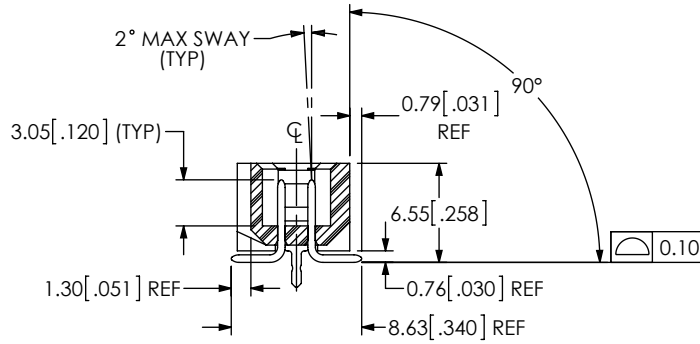
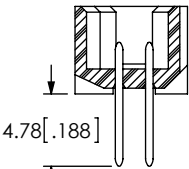

FIG 3
T2M-105-01-X-D-SM-WT SHOWN
(SAME AS FIG 1, EXCEPT AS SHOWN)



SECTION "C"-"C"



-SM IN PROCESS 1

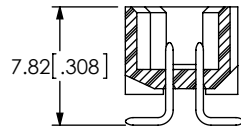

-SM IN PROCESS 2

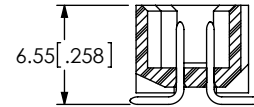

-SM IN PROCESS 3

FIG 2
T2M-105-01-X-D-RA-XX
(SAME AS FIG 1, EXCEPT AS SHOWN)

■ = ONLY APPLICABLE WITH -WT OPTION

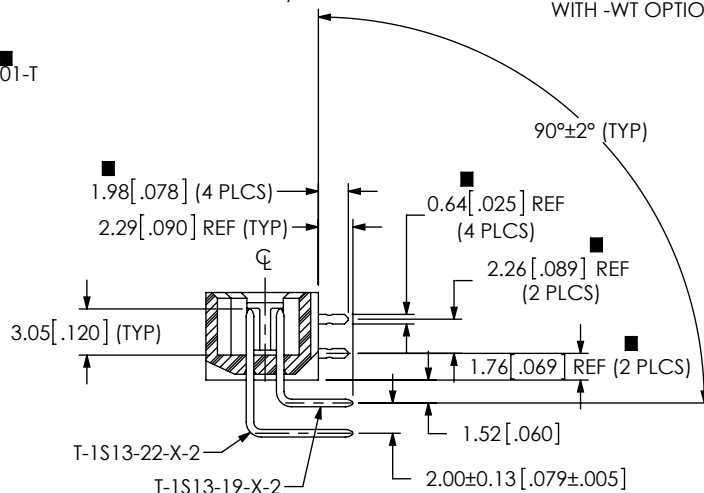
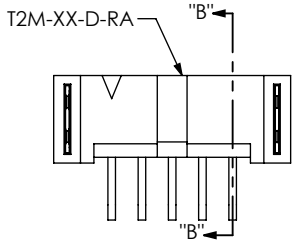
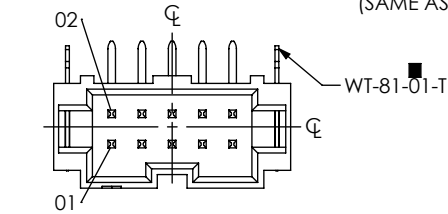

SECTION "B"-"B"

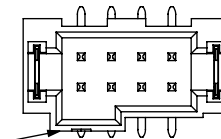

(SEE NOTE 5)

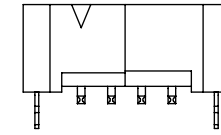
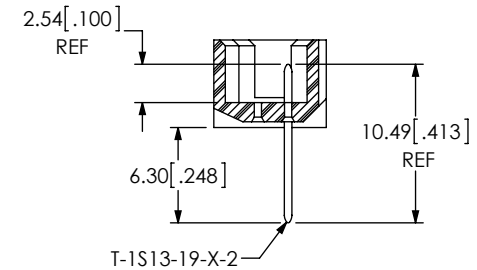
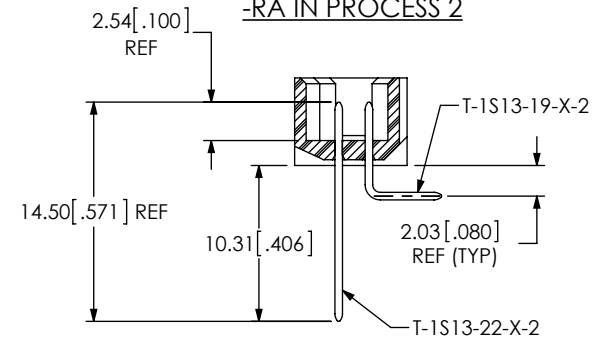

FIG 5
T2M-104-01-X-D-SM-WT
(SAME AS FIG 1, EXCEPT AS SHOWN)
(T2M-102-01-X-D-SM-WT SIMILAR)

-RA IN PROCESS 1



-RA IN PROCESS 2



PROPRIETARY NOTE
THIS DOCUMENT CONTAINS INFORMATION
CONFIDENTIAL AND PROPRIETARY TO
SAMTEC, INC. AND SHALL NOT BE REPRODUCED
OR TRANSFERRED TO OTHER DOCUMENTS OR
DISCLOSED TO OTHERS OR USED FOR ANY
PURPOSE OTHER THAN THAT WHICH IT WAS
OBTAINED WITHOUT THE EXPRESSED WRITTEN
CONSENT OF SAMTEC, INC.

DO NOT SCALE DRAWING

SHEET SCALE: 2:1

samtec

520 PARK EAST BLVD, NEW ALBANY, IN 47150
PHONE: 812-944-6733 FAX: 812-948-5047
e-Mail: info@SAMTEC.com code 55322

DESCRIPTION:
2mm SHROUDED TERMINAL STRIP

DWG. NO.
T2M-1XX-XX-X-D-XX-XX

BY: J. BORGELT 3/23/09 SHEET 2 OF 3

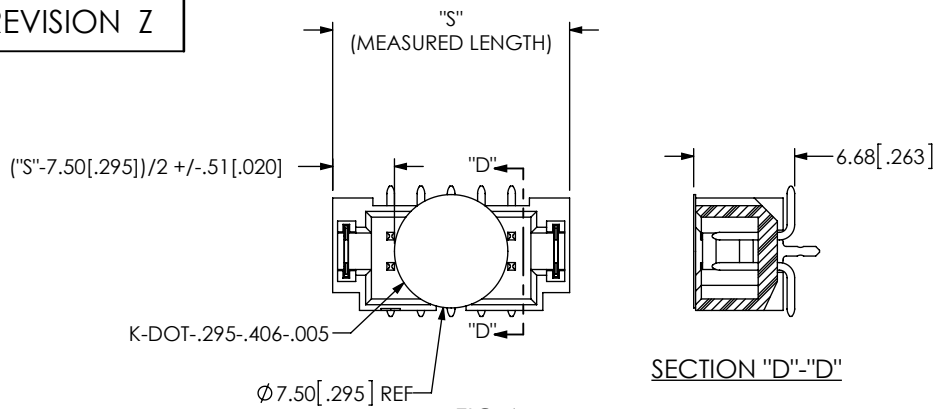

FIG 4
T2M-105-01-X-D-SM-K SHOWN
(FOR SURFACE MOUNT OPTION ONLY)

PACKAGING
ALL PARTS ARE LOADED WITH POSITIONS 1
TOWARDS ARROW

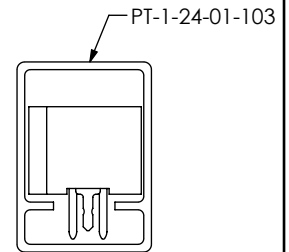
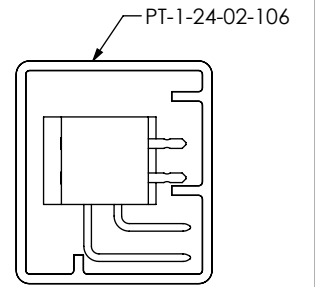
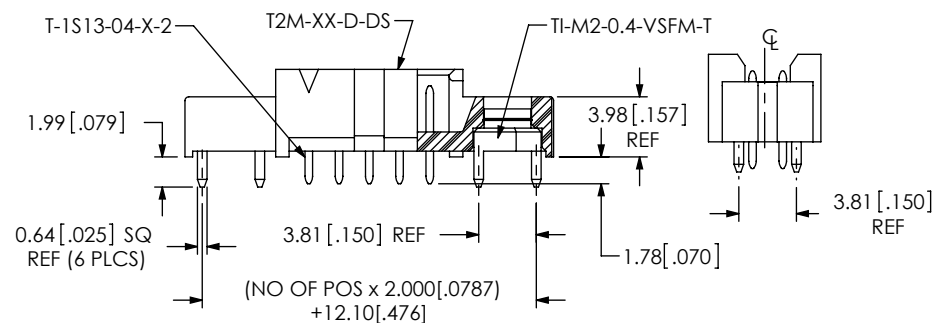
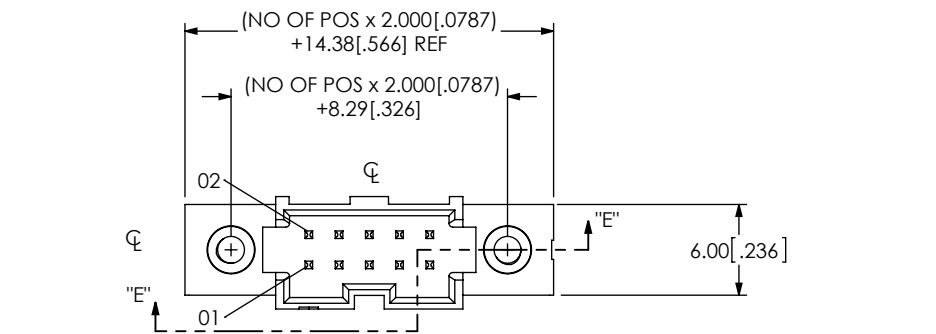
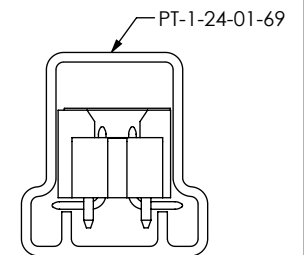
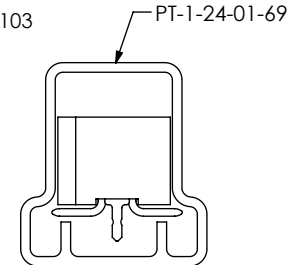
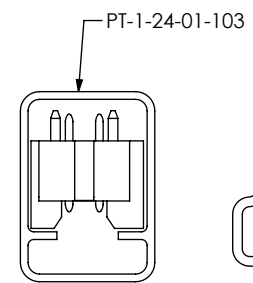

TABLE 1		
OPTIONS	PACKAGING TUBE	PLUG
-TH, -TH-WT	PT-1-24-01-103	TP-09
-SM, -SM-WT	PT-1-24-01-69	TP-09
-RA, -RA-WT	PT-1-24-02-106	TP-07
-TH-DS	PT-1-24-01-103	TP-09
-SM-DS	PT-1-24-01-69	TP-09



SECTION "E"-"E"

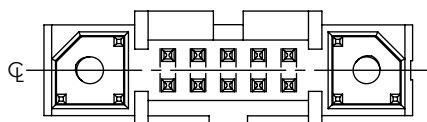
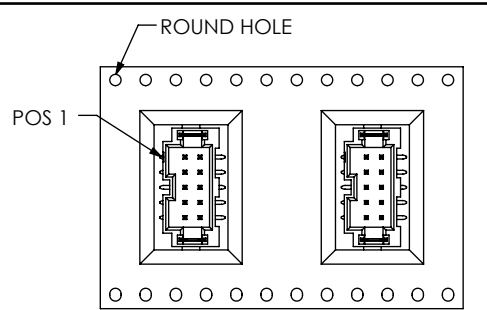

FIG 6
T2M-105-01-X-D-TH-DS SHOWN
(SAME AS FIG 1, EXCEPT AS SHOWN)
(ONLY AVAILABLE WITH -TH & -SM OPTION)



-TR PACKAGING VIEW
ALL PARTS ARE LOADED WITH POSITIONS 1
TOWARDS ROUND HOLE

<p>PROPRIETARY NOTE THIS DOCUMENT CONTAINS INFORMATION CONFIDENTIAL AND PROPRIETARY TO SAMTEC, INC. AND SHALL NOT BE REPRODUCED OR TRANSFERRED TO OTHER DOCUMENTS OR DISCLOSED TO OTHERS OR USED FOR ANY PURPOSE OTHER THAN THAT WHICH IT WAS OBTAINED WITHOUT THE EXPRESSED WRITTEN CONSENT OF SAMTEC, INC.</p> <p>DO NOT SCALE DRAWING</p> <p>SHEET SCALE: 2:1</p>	<p>520 PARK EAST BLVD, NEW ALBANY, IN 47150 PHONE: 812-944-6733 FAX: 812-948-5047 e-Mail info@SAMTEC.com code 55322</p>	
	<p>DESCRIPTION: 2mm SHROUDED TERMINAL STRIP</p> <p>DWG. NO. T2M-1XX-XX-X-D-XX-XX</p>	<p>BY: J. BORGELT</p>
		<p>SHEET 3 OF 3</p>