

Recommended PCB Layout

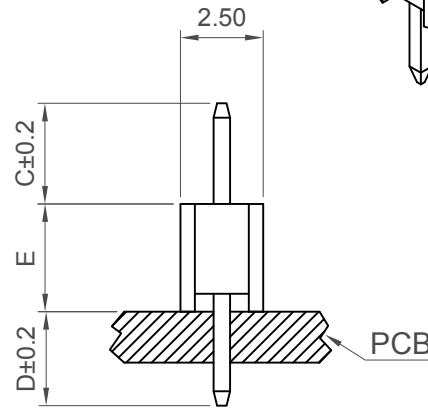
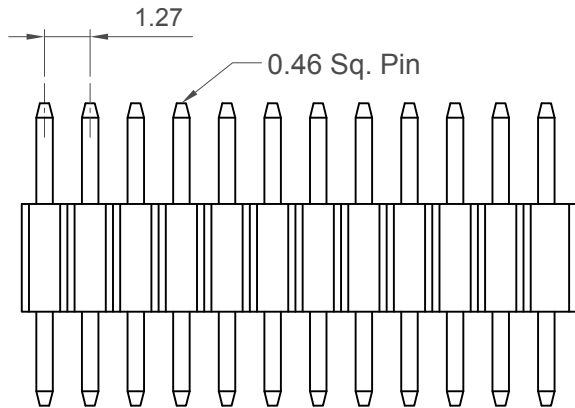
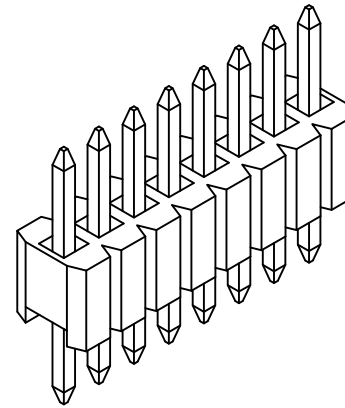

No. of Contacts	Dimensions		No. of Contacts	Dimensions	
	A	B		A	B
2	1.27	2.54	26	31.75	33.02
3	2.54	3.81	27	33.02	34.29
4	3.81	5.08	28	34.29	35.56
5	5.08	6.35	29	35.56	36.83
6	6.35	7.62	30	36.83	38.10
7	7.62	8.89	31	38.10	39.37
8	8.89	10.16	32	39.37	40.64
9	10.16	11.43	33	40.64	41.91
10	11.43	12.70	34	41.91	43.18
11	12.70	13.97	35	43.18	44.45
12	13.97	15.24	36	44.45	45.72
13	15.24	16.51	37	45.72	46.99
14	16.51	17.78	38	46.99	48.26
15	17.78	19.05	39	48.26	49.53
16	19.05	20.32	40	49.53	50.80
17	20.32	21.59	41	50.80	52.07
18	21.59	22.86	42	52.07	53.34
19	22.86	24.13	43	53.34	54.61
20	24.13	25.40	44	54.61	55.88
21	25.40	26.67	45	55.88	57.15
22	26.67	27.94	46	57.15	58.42
23	27.94	29.21	47	58.42	59.69
24	29.21	30.48	48	56.69	60.96
25	30.48	31.75	49	60.96	62.23
			50	62.23	63.50

Specifications 规格

Material 物料

Insulator 绝缘体: LCP, UL94V-0, Black  
Contact 接触端子: Copper Alloy

Plating 电镀

Underplating 底层电镀: Nickel all over  
Contact Area 接触部分: See Ordering Grid

Electrical 电气

Current Rating 电流额定值: 1 Amp Per Pin  
Contact Resistance 接触电阻值: 20 mΩ max.  
Insulating Resistance 绝缘电阻值: 1000 MΩ min.  
Dielectric Withstand Voltage 耐电压: 300V AC

Soldering Process 可焊性:

IR Reflow 回流焊: 260°C for 10 sec.  
Wave 波峰焊: 250°C for 5-10 sec  
Manual Solder 人工焊接: 350°C for 3-5 sec

Mechanical & Environmental 机械 & 环境

Operating Temperature 工作温度: -40°C to +105°C

Mates with 配套之母座 (Subject to pin length 在端子长度适合的条件下)

BD069 BD076

Ordering Grid

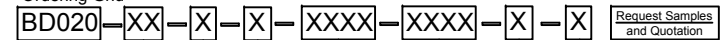

No. of Contacts  
02 to 50

Request Samples  
and Quotation

Packing Options  
G = Plastic Box (Standard)  
D = Tube  
E = Tube with Cap  
Insulator Material  
L = LCP

Contact Plating

A = Gold Flash All Over (Standard)  
B = Selective Gold Flash Contact Area/Tin On Tail  
C = Tin All Over  
G = 10µ" Gold Contact Area/Tin On Tail  
I = 30µ" Gold Contact Area/Tin On Tail

Dimension E (Insulator Height)

J = 1.40mm (Standard)  
G = 1.70mm  
E = 2.54mm  
F = 3.0mm

Dimension D (1/100mm) (Tail Length)  
0300 = 3.0mm (Standard)  
or specify Custom Tail Length  
eg 0250 = 2.50mm

Dimension C (1/100mm) (Post Height)  
0350 = 3.50mm (Standard)  
or specify Custom Post Height  
eg 0250 = 2.50mm

Part Number		Product Description	
BD020		1.27mm Pitch Pin Header	
Drawing Date		Single Row, Through-Hole, Vertical	
28th December 2007			
By	CC	Tolerances (Except as Noted)	Units:
Detail	BD020 F PCN	Length X. ± 0.30 X.X ± 0.20 X.XX ± 0.15 X.XXX ± 0.10	Metric (mm)
Revision	F3	Angle X.° ± 5° X.X° ± 2° X.XX° ± 1° X.XXX° ± 0.5°	3rd Angle Projection
Date	12/05/17		



This drawing is confidential and copyright of Global Connector Technology, Ltd (GCT). This drawing must not be copied or disclosed without written consent. E & OE



Not to Scale  
Drawn By AJO  
Sheet No. 1/1