

Type B1

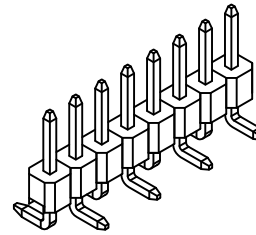

Type B2

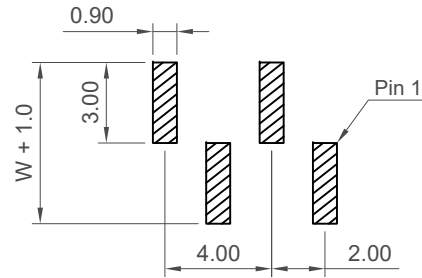
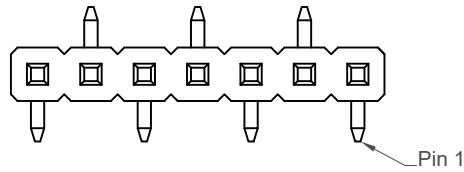
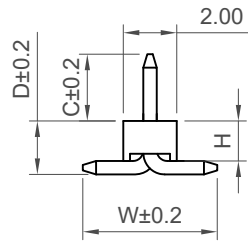
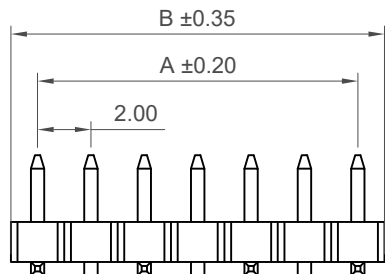
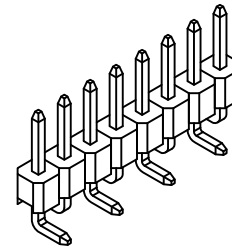
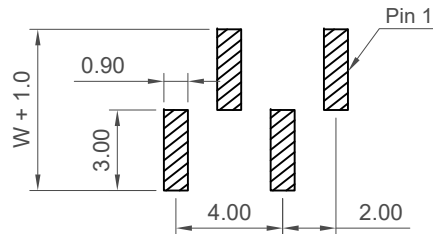
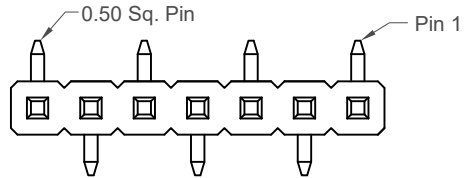

Specifications 规格

Material 物料

Contact 端子物料: Copper Alloy
 Insulator 绝缘体物料:
 Standard 标准物料: Polyamide, Nylon 6T, UL 94V-0
 Option 可选物料: Polyester, LCP, UL 94V-0

Electrical 电气

Current Rating 电流额定值: 2 Amp per pin
 Insulation Resistance 绝缘电阻值: 1000 MΩ min
 Contact Resistance 接触电阻值: 20 mΩ max.
 Dielectric Withstand Voltage 寒耐压: AC 500 V

Mechanical & Environmental 机械 & 环境

Operating Temperature 工作温度: -40°C to +105°C

Soldering Process 可焊性

Nylon 6T (Standard) -
 IR Reflow 回流焊: 260°C for 10 sec.
 Manual Solder 人工焊接: 350°C for 3-5 sec

LCP (Option) -

IR Reflow 回流焊: 260°C for 10 sec.
 Manual Solder 人工焊接: 350°C for 3-5 sec

Mates with 配套之母座 (Subject to pin length 在端子长度适合的条件下)

BF070 BF085 BF086 BF087 BF088 BF090

No. of Contacts	Dimensions	
	A	B
3	4.0	6.0
4	6.0	8.0
5	8.0	10.0
6	10.0	12.0
7	12.0	14.0
8	14.0	16.0
9	16.0	18.0
10	18.0	20.0
11	20.0	22.0
12	22.0	24.0
13	24.0	26.0
14	26.0	28.0
15	28.0	30.0
16	30.0	32.0
17	32.0	34.0
18	34.0	36.0
19	36.0	38.0
20	38.0	40.0
21	40.0	42.0

No. of Contacts	Dimensions	
	A	B
22	42.0	44.0
23	44.0	46.0
24	46.0	48.0
25	48.0	50.0
26	50.0	52.0
27	52.0	54.0
28	54.0	56.0
29	56.0	58.0
30	58.0	60.0
31	60.0	62.0
32	62.0	64.0
33	64.0	66.0
34	66.0	68.0
35	68.0	70.0
36	70.0	72.0
37	72.0	74.0
38	74.0	76.0
39	76.0	78.0
40	78.0	80.0

Ordering Grid

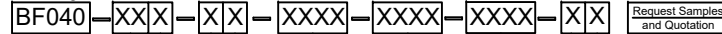

No. of Contacts
03 to 40

Contact Plating

A = Gold Flash All Over (Standard)
 B = Selective Gold Flash Contact Area/
 Tin On Tail
 C = Tin All Over
 G = 10µ" Gold Contact Area/Tin On Tail
 I = 30µ" Gold Contact Area/Tin On Tail

Insulator Height 'H'

B = 2.00mm (Standard)
 A = 1.50mm

Type
 1 = Type B1
 2 = Type B2

Insulator Material
 N = Nylon 6T (Standard)
 L = LCP

Dimension W (1/100mm) (Footprint Width)

0483 = 4.83mm (Standard)
 0500 = 5.00mm (Standard)
 Or specify Dimension W
 eg 0250 = 2.50mm

Dimension C (1/100mm) (Post Height)

0400 = 4.00mm (Standard)
 0600 = 6.00mm (Standard)
 Or specify Dimension C
 eg 0250 = 2.50mm

Dimension D (1/100mm) (PCB to Top of Insulator)

0260 = 2.60mm (Standard for 'H' = B)
 0210 = 2.10mm (Standard for 'H' = A)
 Or specify Dimension D
 eg 0250 = 2.50mm

Packing Options

B = Tape & Reel with Cap (Standard)
 D = Tube
 E = Tube with Cap

Part Number		Product Description	
BF040		2.00mm Pitch Pin Header	
Drawing Date		Single Row, Surface Mount	
31st October 2007			
By	AJO	Tolerances (Except as Noted)	
Detail	BF040 E PCN	Length	Angle
Revision	E1	X.X ± 0.38	X.X° ± 5°
Date	07/03/17	X.XX ± 0.25	X.XX° ± 2°
		X.XXX ± 0.13	X.XXX° ± 1°
			X.XXX° ± 0.5°
		Units:	Metric (mm)
		3rd Angle Projection	



This drawing is confidential and copyright of Global Connector Technology, Ltd (GCT). This drawing must not be copied or disclosed without written consent. E & OE

GCT

Global Connector Technology
www.gct.co

Not to Scale Drawn By LYH Sheet No. 1/1