

## Recommended PCB Layout

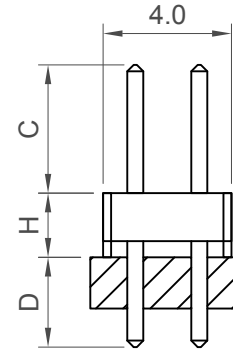
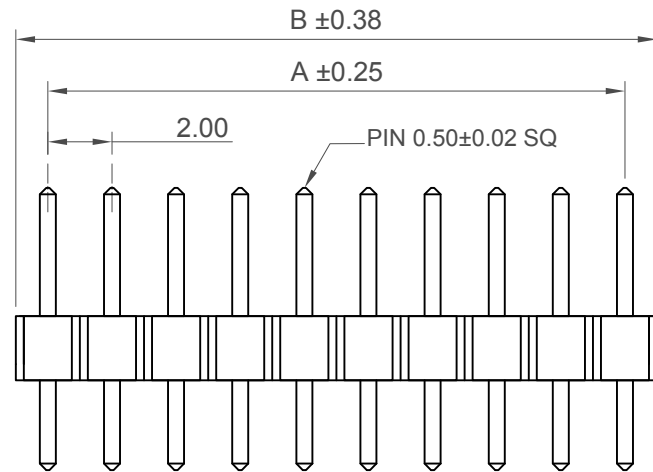

## Specifications

### Material

Contact : Copper Alloy

Insulator :

Standard : Polyamide , Nylon 6T, UL 94-V0

Options : Polymer , LCP, UL 94-V0

Options : Polyester , PBT, UL 94-V0

### Plating

See Ordering Grid

### Electrical

Current Rating: 2 Amp Per Pin

Insulation Resistance: 1000 MΩ min

Contact Resistance: 20 mΩ max.

Dielectric Withstand Voltage: AC 500 V

### Mechanical & Environmental

Operating Temperature: -40°C to +105°C

### Soldering Process:

Nylon 6T (Standard) -

IR Reflow: 260°C for 10 sec.

Wave: 230°C for 5-10 sec

Manual Solder: 350°C for 3-5 sec

LCP (Option) -

IR Reflow: 260°C for 10 sec.

Wave: 250°C for 5-10 sec

Manual Solder: 350°C for 3-5 sec

PBT(Option) -

Manual Solder: 330°C for 3-5 sec

(Not Suitable for High Temperature Process)

### Mates with (Subject to pin length)

BF065 BF075 BF080 BF095

BF100 BF105 BF110 BF112

BF115 BF120 BF185

No. of Contacts	Dimensions	
	A	B
4	2.0	4.0
6	4.0	6.0
8	6.0	8.0
10	8.0	10.0
12	10.0	12.0
14	12.0	14.0
16	14.0	16.0
18	16.0	18.0
20	18.0	20.0
22	20.0	22.0
24	22.0	24.0
26	24.0	26.0
28	26.0	28.0
30	28.0	30.0
32	30.0	32.0
34	32.0	34.0
36	34.0	36.0
38	36.0	38.0
40	38.0	40.0
42	40.0	42.0
44	42.0	44.0
46	44.0	46.0
48	46.0	48.0
50	48.0	50.0
52	50.0	52.0
54	52.0	54.0
56	54.0	56.0
58	56.0	58.0
60	58.0	60.0
62	60.0	62.0
64	62.0	64.0
66	64.0	66.0
68	66.0	68.0
70	68.0	70.0
72	70.0	72.0
74	72.0	74.0
76	74.0	76.0
78	76.0	78.0
80	78.0	80.0

## Ordering Grid

BF050-XX-X-X-XXXX-XXXX-X-X

No. of Contacts  
04 to 80

Request Samples  
and Quotation

## Packing Options

G = Plastic Box (Standard)

B = Tape and Reel with Cap

D = Tube

E = Tube with Cap

## Insulator Material

N = Nylon 6T (Standard)

L = LCP

P = PBT

## Dimension D (1/100mm) (Tail Length)

0300 = 3.00mm (Standard)

Or specify Custom Tail Length

eg 0250 = 2.50mm

## Dimension C (1/100mm) (Post Length)

0400 = 4.00mm (Standard)

0600 = 6.00mm (Standard)

Or specify Custom Post Length

eg 0250 = 2.50mm

## Contact Plating

A = Gold Flash All Over (Standard)

B = Selective Gold Flash Contact Area/

Tin On Tail

C = Tin All Over

G = 10µ" Gold Contact Area/Tin On Tail

I = 30µ" Gold Contact Area/Tin On Tail

## Dimension H (1/100mm) (Insulator Height)

B = 2.00mm (Standard)

A = 1.5mm

Part Number		Product Description	
BF050		2.00mm Pitch Pin Header, Dual Row, Through Hole, Vertical	
Drawing Date		31st October 2007	
By	CC	Tolerances (Except as Noted)	Units:
Detail	BF050 F PCN	Length X. ± 0.30 X.X ± 0.20 X.XX ± 0.15 X.XXX ± 0.10	Metric (mm)
Revision	F2	Angle X.X° ± 5° X.XX° ± 2° X.XXX° ± 1° X.XXX° ± 0.5°	3rd Angle Projection
Date	19/09/17		



This drawing is confidential and copyright of Global Connector Technology, Ltd (GCT). This drawing must not be copied or disclosed without written consent. E & OE

**GCT**  
www.gct.co

Not to Scale  
Drawn By LYH  
Sheet No. 1/1