

H
G
F
E
D
C
B
A

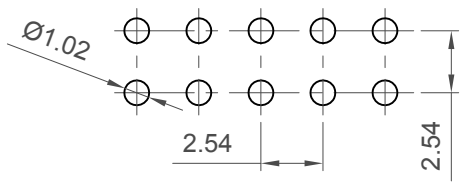
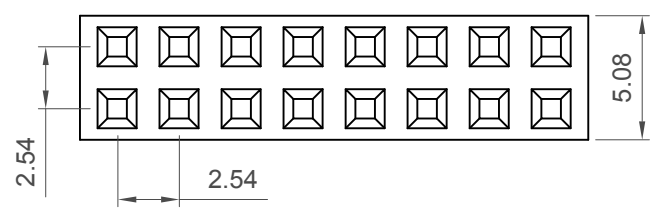

Recommended PCB Layout
Tolerance: ±0.05mm

Insulator Height = 5.0mm: Pin Size = 0.70mm x 0.25mm
Insulator Height = 7.1mm: Pin Size = 0.60mm x 0.25mm

Insulator Height = 5.0mm: Min. Insertion Depth = 1.49mm
Insulator Height = 7.1mm: Min. Insertion Depth = 2.03mm

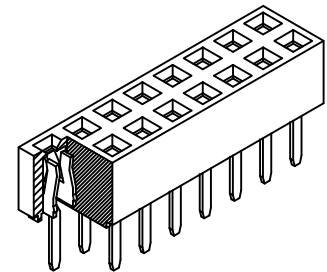
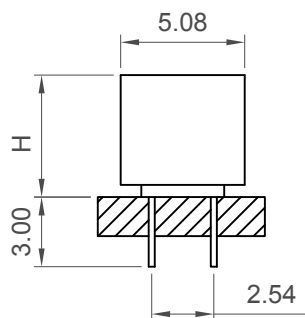
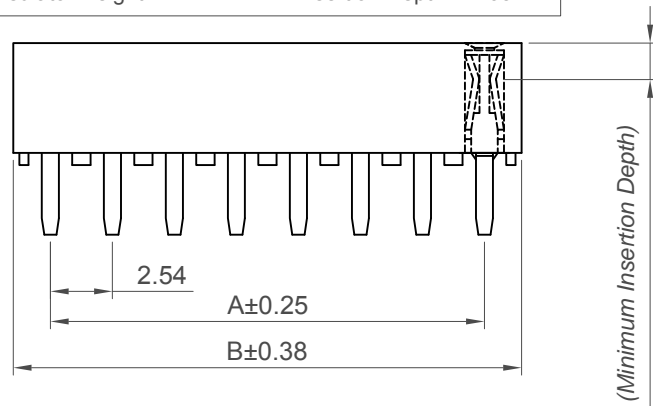

Specifications 规格

Material 物料
Contact 端子: Copper Alloy
Insulator 绝缘体物料:
Standard 标准物料: Polyamide, Nylon 6T, UL 94V-0
Options 可选物料: Polymer, LCP, UL 94V-0
Polyester, PBT, UL 94V-0

Plating 电镀
See ordering grid.

Electrical 电气
Current Rating 电流额定值: 3 Amp (per contact)
Contact Resistance 接触电阻值: 20 mΩ max.
Insulation Resistance 绝缘电阻值: 1000 MΩ min.
Dielectric Withstand Voltage 耐电压: 600 V AC

Mechanical & Environmental 机械 & 环境
Operating Temperature 工作温度: -40°C to +105°C

Soldering Process 可焊性:
Nylon 6T (Standard):
IR Reflow 回流焊: 260°C for 10 sec.
Wave 波峰焊: 230°C for 5-10 sec.
Manual Solder 人工焊接: 350°C for 3-5 sec
PBT (Option)
Manual solder 人工焊接: 330°C for 3-5 sec.
(Not suitable for hi-temp process)
LCP (Option):
IR Reflow 回流焊: 260°C for 10 sec.
Wave 波峰焊: 250°C for 5-10 sec.
Manual Solder 人工焊接: 350°C for 3-5 sec

Mates with 配套之公头
(Subject to pin length 在端子长度适合的条件下)
BG025 BG040 BG041 BG045 BG050
BG065 BG066 BG070 BG085

| Number of Contacts | Dimensions | |
|--------------------|------------|--------|
| | A | B |
| 4 | 2.54 | 5.58 |
| 6 | 5.08 | 8.12 |
| 8 | 7.62 | 10.66 |
| 10 | 10.16 | 13.20 |
| 12 | 12.70 | 15.74 |
| 14 | 15.24 | 18.28 |
| 16 | 17.78 | 20.82 |
| 18 | 20.32 | 23.36 |
| 20 | 22.86 | 25.90 |
| 22 | 25.40 | 28.44 |
| 24 | 27.94 | 30.98 |
| 26 | 30.48 | 33.52 |
| 28 | 33.02 | 36.06 |
| 30 | 35.56 | 38.60 |
| 32 | 38.10 | 41.14 |
| 34 | 40.64 | 43.68 |
| 36 | 43.18 | 46.22 |
| 38 | 45.72 | 48.76 |
| 40 | 48.26 | 51.30 |
| 42 | 50.80 | 53.84 |
| 44 | 53.34 | 56.38 |
| 46 | 55.88 | 58.92 |
| 48 | 58.42 | 61.46 |
| 50 | 60.96 | 64.00 |
| 52 | 63.50 | 66.54 |
| 54 | 66.04 | 69.08 |
| 56 | 68.58 | 71.62 |
| 58 | 71.12 | 74.16 |
| 60 | 73.66 | 76.70 |
| 62 | 76.20 | 79.24 |
| 64 | 78.74 | 81.78 |
| 66 | 81.28 | 84.32 |
| 68 | 83.82 | 86.86 |
| 70 | 86.36 | 89.40 |
| 72 | 88.90 | 91.94 |
| 74 | 91.44 | 94.48 |
| 76 | 93.98 | 97.02 |
| 78 | 96.52 | 99.56 |
| 80 | 99.06 | 102.10 |

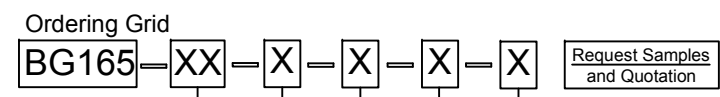

Contact Plating
A = Gold Flash All Over (Standard)
B = Selective Gold Flash Contact Area/Tin On Tail
C = Tin All Over
G = 10μ" Gold Contact Area/Tin On Tail
I = 30μ" Gold Contact Area/Tin On Tail

Height H
A = 5.0mm (Standard)
B = 7.1mm

Packing Options
D = Tube (Standard)
E = Tube with Cap
F = Tube with Film
G = Plastic Box
H = Tray (4 contacts only)

Insulator Material
N = Nylon 6T (Standard)
P = PBT
L = LCP

| | | | |
|-------------------|----------------|--|----------------------|
| Part Number | | Product Description | |
| BG165 | | 2.54mm Pitch Socket | |
| Drawing Date | | Dual Row, Through-Hole, Vertical | |
| 30th October 2006 | | | |
| By | CC | Tolerances (Except as Noted) | Units: |
| Detail | BG165 G PCN | Length X. ± 0.30 X.X ± 0.20 X.XX ± 0.15 X.XXX ± 0.10 | Metric (mm) |
| Revision | G1 | Angle X° ± 5° X.X° ± 2° X.XX° ± 1° X.XXX° ± 0.5° | 3rd Angle Projection |
| Date | 27/06/17 | | |



This drawing is confidential and copyright of Global Connector Technology, Ltd (GCT). This drawing must not be copied or disclosed without written consent. E & OE



| | | |
|--------------|--------------|---------------|
| Not to Scale | Drawn By LYH | Sheet No. 1/1 |
|--------------|--------------|---------------|