

F
E
D
C
B
A

F
E
D
C
B
A

- NOTES:
- MATERIAL: PHOSPHOR BRONZE
 - PLATING:
 - 124 = SELECT BRIGHT TIN: 3.75 MICROMETERS MIN OVER NICKEL
 - 207 = SELECT HARD GOLD: 0.38 MICROMETERS MIN.
SELECT TIN: 2.0 MICROMETERS MIN BOTH OVER NICKEL
 - 206 = SELECT HARD GOLD: 0.75 MICROMETERS MIN.
SELECT TIN: 2.0 MICROMETERS MIN BOTH OVER NICKEL
 - 216 = SELECT HARD GOLD: 1.27 MICROMETERS MIN.
SELECT TIN: 2.54 MICROMETERS MIN BOTH OVER NICKEL
 - P124 = PREPLATED OVERALL BRIGHT TIN: 3.75 MICROMETERS MIN OVER NICKEL
(MAY HAVE UNPLATED EDGES)
 - PRODUCT SPECIFICATION: TERMINALS CONFORM TO PS-70058 AND PS-70400 WHEN CRIMPED WITH MOLEX CRIMP TOOLS.
 - COSMETIC SPECIFICATION: PS-45499-002 CLASS B
 - TERMINAL FOR USE WITH HOUSING SERIES 70066 AND 70450
 - WIRE SPECIFICATION: TERMINALS STAMPED WITH THE LETTER:
 - A = ACCEPTS 24-30 AWG STRANDED WIRE WITH A 1.52 MAX INSULATION DIA
 - B = ACCEPTS 32-36 AWG STRANDED WIRE WITH A 0.64 MAX INSULATION DIA.
 - C = ACCEPTS 22-24 AWG STRANDED WIRE WITH A 1.63 MAX INSULATION DIA

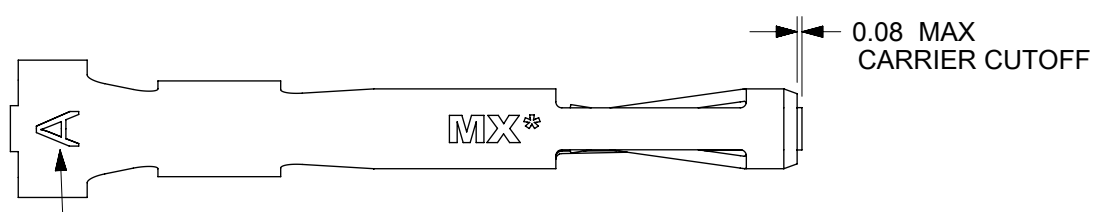
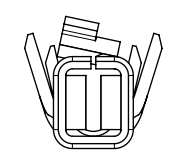
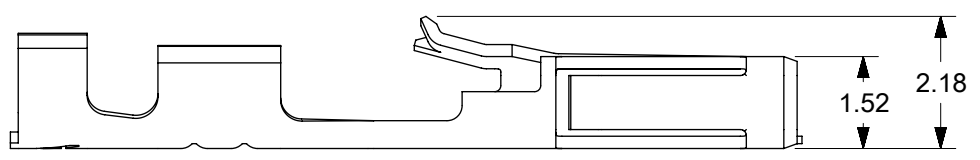
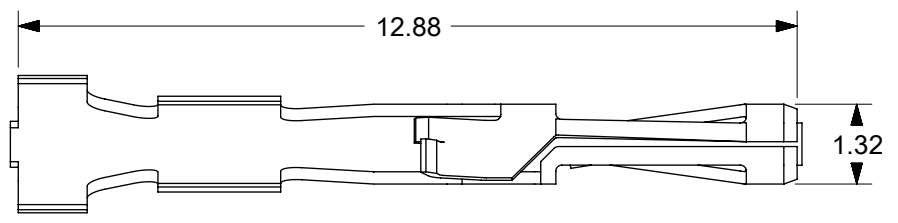

TERMINALS STAMPED WITH THE LETTER "A"
ACCEPT 24-30 AWG WIRE WITH A 1.52 MAX INSULATION DIA.

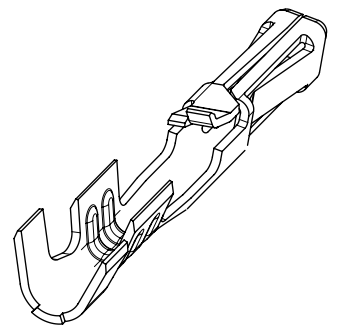

TERMINALS ON THIS SHEET ARE FOR USE
WITH 24-30 AWG WIRE.
SEE SHEETS 2 AND 3 FOR OTHER WIRE SIZES

CURRENT PART NUMBER	REPLACEMENT PART NUMBER	PACKAGING	PLATING SEE NOTE 2	WIRE SIZE	MAX INSULATION DIA
16-02-0069	70058-1069	REEL	124 SELECT TIN	24-30 AWG	1.52 DIA MAX
16-02-0096	70058-1096	LOOSE			
70058-4069	70058-0069	REEL	P124 OVERALL TIN		
70058-4096	70058-0096	LOOSE			
16-02-0082	70058-0082	REEL	207 0.38 GOLD		
16-02-0097	70058-0097	LOOSE			
16-02-0083	70058-0083	REEL	206 0.75 GOLD		
16-02-0098	70058-0098	LOOSE			
16-02-0139	70058-0139	REEL	216 1.27 GOLD		
16-02-0140	70058-0140	LOOSE			

SYMBOLS DIMENSION UNITS: mm SCALE: 8:1 GENERAL TOLERANCES (UNLESS SPECIFIED) ANGULAR TOL: ± ° 4 PLACES: ± 3 PLACES: ± 2 PLACES: ± 0.25 1 PLACE: ± 0.15 0 PLACES: ± 0.0 DRAFT WHERE APPLICABLE MUST REMAIN WITHIN DIMENSIONS	THIS DRAWING CONTAINS INFORMATION THAT IS PROPRIETARY TO MOLEX ELECTRONIC TECHNOLOGIES, LLC AND SHOULD NOT BE USED WITHOUT WRITTEN PERMISSION		CURRENT REV DESC: CLARIFY PLT		
	EC NO: 123338		2018/04/02		
	DRWN: KSAMIEC		2018/04/02		
	CHK'D: FSMITH		2018/04/02		
APPR: FSMITH		2018/04/02		SL CRIMP TERMINAL (24-30 AWG WIRE)	
INITIAL REVISION:		2017/05/03		PRODUCT CUSTOMER DRAWING	
DRWN: KSAMIEC		2017/06/16		DOCUMENT NUMBER: 700580000-SD	
APPR: FSMITH		2017/06/16		DOC TYPE: PSD	
THIRD ANGLE PROJECTION		DRAWING: B-SIZE		DOC PART: 000	
SERIES: 70058		MATERIAL NUMBER: SEE CHART		REVISION: A2	
CUSTOMER: GENERAL MARKET		SHEET NUMBER: 1 OF 4			

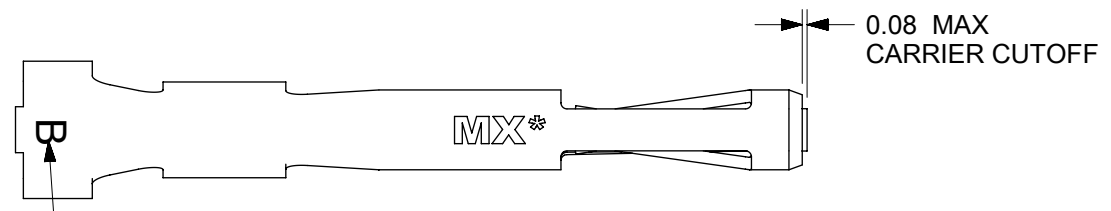
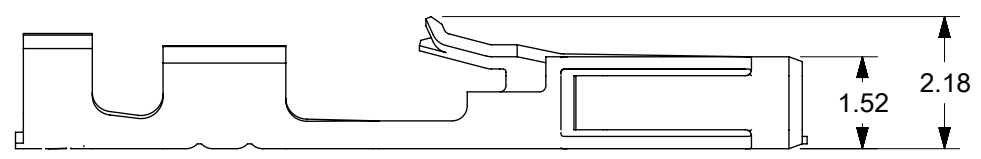
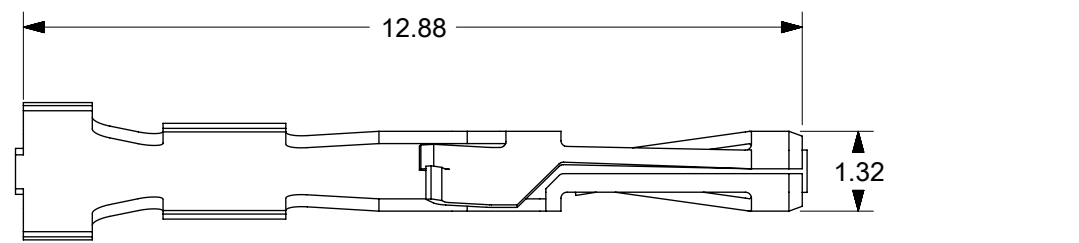

TERMINALS STAMPED WITH THE LETTER "B"
ACCEPT 32-36 AWG WIRE WITH A 0.64 MAX INSULATION DIA

NOTES:

- MATERIAL: PHOSPHOR BRONZE
- PLATING:
 - 124 = SELECT BRIGHT TIN: 3.75 MICROMETERS MIN OVER NICKEL
 - 207 = SELECT HARD GOLD: 0.38 MICROMETERS MIN.
SELECT TIN: 2.0 MICROMETERS MIN BOTH OVER NICKEL
 - 206 = SELECT HARD GOLD: 0.75 MICROMETERS MIN.
SELECT TIN: 2.0 MICROMETERS MIN BOTH OVER NICKEL
 - 216 = SELECT HARD GOLD: 1.27 MICROMETERS MIN.
SELECT TIN: 2.54 MICROMETERS MIN BOTH OVER NICKEL
 - P124 = PREPLATED OVERALL BRIGHT TIN: 3.75 MICROMETERS MIN OVER NICKEL
(MAY HAVE UNPLATED EDGES)
- PRODUCT SPECIFICATION: TERMINALS CONFORM TO PS-70058 AND PS-70400 WHEN CRIMPED WITH MOLEX CRIMP TOOLS.
- COSMETIC SPECIFICATION: PS-45499-002 CLASS B
- TERMINAL FOR USE WITH HOUSING SERIES 70066 AND 70450
- WIRE SPECIFICATION: TERMINALS STAMPED WITH THE LETTER:
 - A = ACCEPTS 24-30 AWG STRANDED WIRE WITH A 1.52 MAX INSULATION DIA
 - B = ACCEPTS 32-36 AWG STRANDED WIRE WITH A 0.64 MAX INSULATION DIA.
 - C = ACCEPTS 22-24 AWG STRANDED WIRE WITH A 1.63 MAX INSULATION DIA

CURRENT PART NUMBER	REPLACEMENT PART NUMBER	PACKAGING	PLATING SEE NOTE 2	WIRE SIZE	MAX INSULATION DIA
16-02-0084	70058-1084	REEL	124 SELECT TIN	32 - 36 AWG	0.64 DIA MAX
16-02-0099	70058-1099	LOOSE			
70058-4084	70058-0084	REEL	P124 OVERALL TIN		
70058-4099	70058-0099	LOOSE			
16-02-0074	70058-0074	REEL	207 0.38 GOLD		
16-02-0100	70058-0100	LOOSE			
16-02-0085	70058-0085	REEL	206 0.75 GOLD		
16-02-0101	70058-0101	LOOSE			
16-02-0143	70058-0143	REEL	216 1.27 GOLD		
16-02-0144	70058-0144	LOOSE			

TERMINALS ON THIS SHEET ARE FOR USE
WITH 32-36 AWG WIRE.
SEE SHEETS 1 AND 3 FOR OTHER WIRE SIZES

SYMBOLS DIMENSION UNITS: mm SCALE: 8:1 GENERAL TOLERANCES (UNLESS SPECIFIED) ANGULAR TOL: ± ° 4 PLACES: ± 3 PLACES: ± 2 PLACES: ± 0.25 1 PLACE: ± 0.15 0 PLACES: ± 0.0 DRAFT WHERE APPLICABLE MUST REMAIN WITHIN DIMENSIONS	THIS DRAWING CONTAINS INFORMATION THAT IS PROPRIETARY TO MOLEX ELECTRONIC TECHNOLOGIES, LLC AND SHOULD NOT BE USED WITHOUT WRITTEN PERMISSION		CURRENT REV DESC: CLARIFY PLT					
	EC NO: 123338		2018/04/02			SL CRIMP TERMINAL (32-36 AWG WIRE)		
	DRWN: KSAMIEC		2018/04/02					
	CHK'D: FSMITH		2018/04/02			PRODUCT CUSTOMER DRAWING		
APPR: FSMITH		2018/04/02		INITIAL REVISION:	DOCUMENT NUMBER	DOC TYPE	DOC PART	REVISION
DRWN: KSAMIEC		2017/05/03		DRWN: KSAMIEC	700580000-SD	PSD	000	A2
APPR: FSMITH		2017/06/16		APPR: FSMITH	MATERIAL NUMBER	CUSTOMER	SHEET NUMBER	
DRAFT WHERE APPLICABLE MUST REMAIN WITHIN DIMENSIONS		THIRD ANGLE PROJECTION	DRAWING	SERIES	SEE CHART	GENERAL MARKET	2 OF 4	

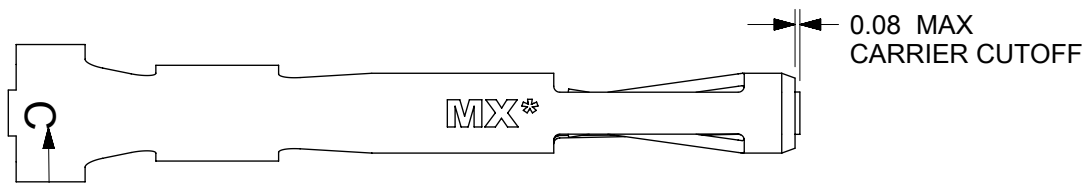
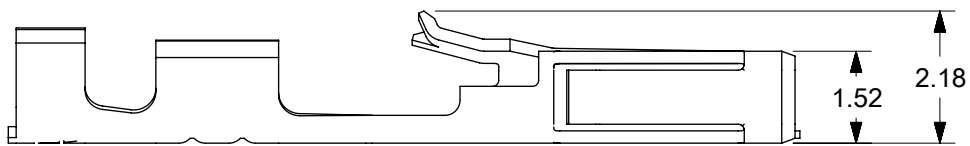
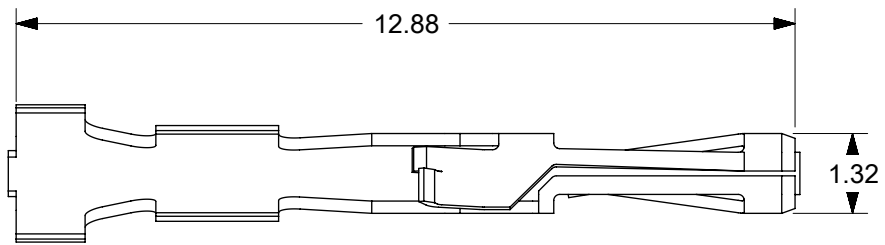

TERMINALS STAMPED WITH THE LETTER "C"
ACCEPT 22-24 AWG WIRE WITH A 1.63 MAX INSULATION DIA

NOTES:

- MATERIAL: PHOSPHOR BRONZE
- PLATING:
 - 124 = SELECT BRIGHT TIN: 3.75 MICROMETERS MIN OVER NICKEL
 - 207 = SELECT HARD GOLD: 0.38 MICROMETERS MIN.
SELECT TIN: 2.0 MICROMETERS MIN BOTH OVER NICKEL
 - 206 = SELECT HARD GOLD: 0.75 MICROMETERS MIN.
SELECT TIN: 2.0 MICROMETERS MIN BOTH OVER NICKEL
 - 216 = SELECT HARD GOLD: 1.27 MICROMETERS MIN.
SELECT TIN: 2.54 MICROMETERS MIN BOTH OVER NICKEL
 - P124 = PREPLATED OVERALL BRIGHT TIN: 3.75 MICROMETERS MIN OVER NICKEL
(MAY HAVE UNPLATED EDGES)
- PRODUCT SPECIFICATION: TERMINALS CONFORM TO PS-70058 AND PS-70400 WHEN CRIMPED WITH MOLEX CRIMP TOOLS.
- COSMETIC SPECIFICATION: PS-45499-002 CLASS B
- TERMINAL FOR USE WITH HOUSING SERIES 70066 AND 70450
- WIRE SPECIFICATION: TERMINALS STAMPED WITH THE LETTER:
 - A = ACCEPTS 24-30 AWG STRANDED WIRE WITH A 1.52 MAX INSULATION DIA
 - B = ACCEPTS 32-36 AWG STRANDED WIRE WITH A 0.64 MAX INSULATION DIA.
 - C = ACCEPTS 22-24 AWG STRANDED WIRE WITH A 1.63 MAX INSULATION DIA

CURRENT PART NUMBER	REPLACEMENT PART NUMBER	PACKAGING	PLATING SEE NOTE 2	WIRE SIZE	MAX INSULATION DIA
16-02-0086	70058-1086	REEL	124 SELECT TIN	22-24 AWG	1.63 DIA MAX
16-02-0102	70058-1102	LOOSE			
70058-4086	70058-0086	REEL	P124 OVERALL TIN		
70058-4102	70058-0102	LOOSE			
16-02-0087	70058-0087	REEL	207 0.38 GOLD		
16-02-0103	70058-0103	LOOSE			
16-02-0088	70058-0088	REEL	206 0.75 GOLD		
16-02-0104	70058-0104	LOOSE			
16-02-0131	70058-0131	REEL	216 1.27 GOLD		
16-02-0147	70058-0147	LOOSE			

TERMINALS ON THIS SHEET ARE FOR USE
WITH 22-24 AWG WIRE.
SEE SHEETS 1 AND 2 FOR OTHER WIRE SIZES

SYMBOLS	THIS DRAWING CONTAINS INFORMATION THAT IS PROPRIETARY TO MOLEX ELECTRONIC TECHNOLOGIES, LLC AND SHOULD NOT BE USED WITHOUT WRITTEN PERMISSION				
	DIMENSION UNITS	SCALE			
▽ = 0	mm	8:1	EC NO: 123338		
▽ = 0	GENERAL TOLERANCES (UNLESS SPECIFIED)		DRWN: KSAMIEC 2018/04/02		
▽ = 0	ANGULAR TOL ± °		CHK'D: FSMITH 2018/04/02		
▽ = 0	4 PLACES ±		APPR: FSMITH 2018/04/02		
▽ = 0	3 PLACES ±		INITIAL REVISION:		
▽ = 0	2 PLACES ± 0.25		DRWN: KSAMIEC 2017/05/03		
▽ = 0	1 PLACE ± 0.15		APPR: FSMITH 2017/06/16		
▽ = 0	0 PLACES ± 0.0		DOCUMENT NUMBER		
■ = 0	DRAFT WHERE APPLICABLE MUST REMAIN WITHIN DIMENSIONS		700580000-SD		
▽ = 0	THIRD ANGLE PROJECTION		DOC TYPE DOC PART REVISION		
DRAWING		SERIES		PSD 000 A2	
B-SIZE		70058		MATERIAL NUMBER CUSTOMER SHEET NUMBER	
SEE CHART		GENERAL MARKET		3 OF 4	

REEL PACKED

LOOSE PACKED

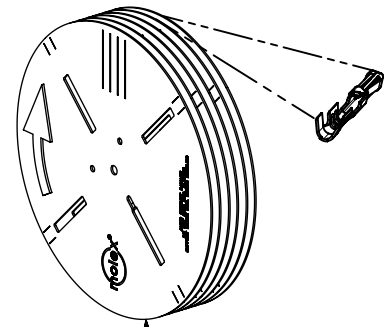

UNWINDING DIRECT
TO CRIMP MACHINE

PARTS PER REEL: 20,000
REELS PER BOX: 3
PARTS PER BOX: 60,000

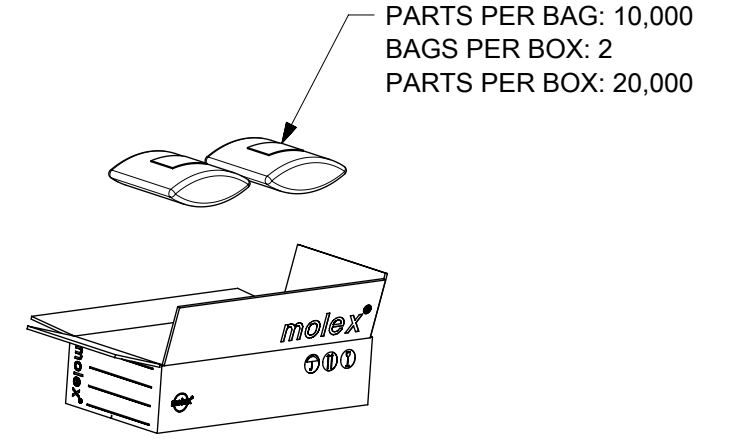

PARTS PER BAG: 10,000
BAGS PER BOX: 2
PARTS PER BOX: 20,000

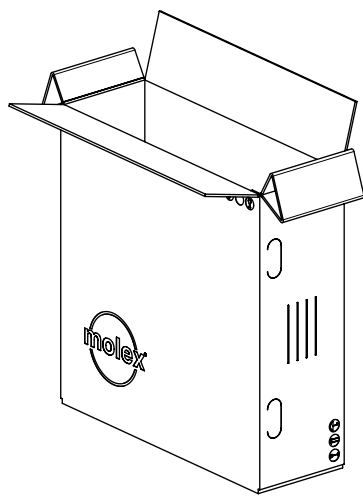

SYMBOLS	THIS DRAWING CONTAINS INFORMATION THAT IS PROPRIETARY TO MOLEX ELECTRONIC TECHNOLOGIES, LLC AND SHOULD NOT BE USED WITHOUT WRITTEN PERMISSION										
	DIMENSION UNITS		SCALE		CURRENT REV DESC: CLARIFY PLT				molex		
	mm		1:15		EC NO: 123338						
	GENERAL TOLERANCES (UNLESS SPECIFIED)		DRWN: KSAMIEC 2018/04/02				SL CRIMP TERMINAL				
	ANGULAR TOL ± °		CHK'D: FSMITH 2018/04/02								
	4 PLACES ±		APPR: FSMITH 2018/04/02				PRODUCT CUSTOMER DRAWING				
	3 PLACES ±		INITIAL REVISION:				DOCUMENT NUMBER		DOC TYPE	DOC PART	REVISION
	2 PLACES ± 0.25		DRWN: KSAMIEC 2017/05/03				700580000-SD		PSD	000	A2
	1 PLACE ± 0.15		APPR: FSMITH 2017/06/16				MATERIAL NUMBER		CUSTOMER		SHEET NUMBER
	0 PLACES ± 0.0		DRAFT WHERE APPLICABLE MUST REMAIN WITHIN DIMENSIONS		THIRD ANGLE PROJECTION	DRAWING	SERIES	SEE CHART	GENERAL MARKET	4 OF 4	