

- NOTES:
1. Material: High conductivity seamless copper tube.
 2. Plating: Parts are annealed and tin plated.
 3. Wire Type: Class 2r/5f & 6f Stranded Copper per DIN VDE 0295, IEC 60228 and HD 383.
 4. UL Listed Wire Connector: Yes, for applications up to 35kv.
Consult cable manufacturer for voltage stress relief instructions with applications greater than 2000 volts.
 5. UL Temperature Rating: 90° C
 6. C.S.A. Certified Wire Connector: Yes
 7. Parts are CE and tested per EN 61238-1:2003/IEC 61238-1:2003 Class B, with Class 2r wire 10mm² - 630mm².

Part Number	Class 2r Wire Size	Class 5f & 6f Wire Size	Stud Size	Wire Strip Length	Panduit Die Index No. For Class 2r Wire Circumferential Dies	Panduit Die Index No. For Class 5f & 6f Wire Circumferential Dies	Panduit Die Index No. For Class 5f & 6f Wire Nest/Indentor Dies	ALL DIMENSIONS IN mm									
								l±2.76	o±.50	i±.50	a±2.25	m (ref)	c±.50	n±2.25	d±.50	b±2.25	t ± .70
LCMD10-8-Q	10mm	*10mm	M8	12.5	P21	---	---	75.3	6.80	4.50	11.5	8.5	44.50	8.0	9.00	13.5	1.5
LCMD16-8-Q	16mm	10mm	M8	16.0	P21	P21	P29/1	79.0	7.60	5.50	14.5	10.3	44.50	6.5	9.00	13.5	1.6
**LCMD16-12-Q	16mm	10mm	M8	16.0	P21	P21	P29/1	92.0	8.40	5.60	13.0	16	44.50	13.5	14.00	19.0	2.7
LCMD25-8-Q	25mm	16mm	M8	16.5	P29	P21	P29/1	81.5	8.80	6.90	15.0	10.0	44.50	8.0	9.00	16.0	1.5
LCMD25-10-Q	25mm	16mm	M10	16.5	P29	P21	P29/1	81.5	8.80	6.90	15.0	10.0	44.50	8.0	11.00	16.0	1.5
LCMD25-12-Q	25mm	16mm	M12	16.5	P29	P21	P29/1	89.5	10.40	7.14	15.0	14.5	44.50	11.5	14.00	20.5	2.2
**LCMD35-8-Q	35mm	25mm	M8	19.0	P29	P29	P42/2	86.5	10.40	8.20	17.5	12.3	44.50	8.5	9.00	16.0	2.0
LCMD35-10-Q	35mm	25mm	M10	19.0	P29	P29	P42/2	86.5	10.40	8.20	17.5	12.3	44.50	8.5	11.00	16.0	2.0
LCMD35-12-Q	35mm	25mm	M12	19.0	P29	P29	P42/2	95.5	11.00	8.20	17.5	14.5	44.50	11.5	14.00	22.0	1.9
LCMD50-10-X	50mm	35mm	M10	21.8	P37	P33	P50/2	92.0	12.30	9.80	20.3	12.5	44.50	10.0	11.00	18.5	2.3
LCMD50-12-X	50mm	35mm	M12	21.8	P37	P33	P50/2	94.5	13.00	9.80	20.3	14.0	44.50	11.0	14.00	23.5	2.4
LCMD70-10-X	70mm	50mm	M10	24.8	P45	P37	P50/2	98.0	14.20	11.50	23.3	14.5	44.50	11.5	11.00	21.3	2.6
LCMD70-12-X	70mm	50mm	M12	24.8	P45	P37	P50/2	98.0	14.20	11.50	23.3	14.5	44.50	11.5	14.00	21.3	2.6
**LCMD95-10-X	95mm	70mm	M10	26.0	P54	P45	P62/4	105.0	16.50	13.50	24.5	15.0	44.50	13.5	11.00	25.0	2.8
LCMD95-12-X	95mm	70mm	M12	26.0	P54	P45	P62/4	105.0	16.50	13.50	24.5	15.0	44.50	13.5	14.00	25.0	2.8
LCMD95-14-X	95mm	70mm	M14	26.0	P54	P50	P62/4	105.0	16.50	13.50	24.5	15.0	44.50	13.5	16.00	25.0	2.8
LCMD120-12-X	120mm	95mm	M12	26.0	P62	P50	P76/4	109.5	18.60	15.20	24.5	15.5	44.50	14.5	14.00	28.0	3.2
LCMD120-14-X	120mm	95mm	M14	26.0	P62	---	P76/4	109.5	18.60	15.20	24.5	15.5	44.50	14.5	16.00	28.0	3.2
LCMD150-12-X	150mm	120mm	M12	29.0	P66	---	P76/4	115.0	21.00	16.50	27.5	18.0	44.50	16.5	14.00	31.0	4.3
LCMD150-14-X	150mm	120mm	M14	29.0	P66	---	P76/4	118.5	21.00	16.50	27.5	22.0	44.50	16.5	16.00	31.0	4.3
LCMD185-12-X	185mm	150mm	M12	29.7	P76	---	P76/4	117.0	23.00	18.60	28.2	16.5	44.50	17.5	14.00	34.0	4.2
LCMD185-14-X	185mm	150mm	M14	29.7	P76	---	P76/4	121.5	23.00	18.60	28.2	21.0	44.50	17.5	16.00	34.0	4.2
LCMD240-12-5	240mm	185mm	M12	36.5	P87	---	P87/4	131.0	26.00	20.80	35.0	21.0	44.50	19.5	14.00	38.0	5.0
LCMD240-14-5	240mm	185mm	M14	36.5	P87	---	P87/4	131.0	26.00	20.80	35.0	21.0	44.50	19.5	16.00	38.0	5.0
LCMD300-12-5	300mm	240mm	M12	41.8	P94	---	P106/6	140.0	29.00	23.50	40.3	23.0	44.50	20.0	14.00	43.0	5.3
LCMD300-14-5	300mm	240mm	M14	41.8	P94	---	P106/6	139.0	29.00	23.50	40.3	22.0	44.50	20.0	16.00	43.0	5.3
LCMDX300-12-5	---	300mm	M12	46.3	---	---	P32/6	151.5	33.00	26.20	44.8	26.5	44.50	23.5	14.00	48.5	6.5
LCMDX300-14-5	---	5f Only	M14	46.3	---	---	P32/6	151.5	33.00	26.20	44.8	26.5	44.50	23.5	16.00	48.5	6.5
LCMD400-12-5	400mm	---	M12	46.3	P106	---	---	151.5	34.50	27.00	44.8	26.5	44.50	23.5	14.00	50.0	7.2
LCMD400-14-5	400mm	---	M14	46.3	P106	---	---	151.5	34.50	27.00	44.8	26.5	44.50	23.5	16.00	50.0	7.2
LCMD400-16-5	400mm	---	M16	46.3	P106	---	---	151.5	34.50	27.00	44.8	26.5	44.50	23.5	18.00	50.0	7.2
LCMD500-12-1	500mm	---	M12	48.0	P125	---	---	164.5	40.00	31.00	46.5	28.5	44.50	25.5	14.00	58.0	8.6
LCMD500-14-1	500mm	---	M14	48.0	P125	---	---	164.5	40.00	31.00	46.5	28.5	44.50	25.5	16.00	58.0	8.6
LCMD500-16-1	500mm	---	M16	48.0	P125	---	---	164.5	40.00	31.00	46.5	28.5	44.50	25.5	18.00	58.0	8.6
LCMD630-12-1	630mm	---	M12	57.7	P125	---	---	175.5	44.00	34.50	56.2	28.5	44.50	27.5	14.00	63.5	9.2
LCMD630-14-1	630mm	---	M14	57.7	P125	---	---	175.5	44.00	34.50	56.2	28.5	44.50	27.5	16.00	63.5	9.2
LCMD630-16-1	630mm	---	M16	57.7	P125	---	---	175.5	44.00	34.50	56.2	28.5	44.50	27.5	18.00	63.5	9.2

* Class 5f only
**cULus LISTED WIRE CONNECTOR



LISTED Wire Connector



LISTED Wire Connector



CERTIFIED

REV	DATE	BY	CHK	APR	DESCRIPTION	ECN
06	1/17	JHNU	JHNU	RGB	REVISED TONGUE WIDTH AND TONGUE THICKNESS DIMENSIONS	13J059BB-JC
05	11/16	JHNU	JHNU	RGB	ADDED LCMD16-12-Q	13J059BB-JC
04	7/15	JHNU	TLCO	RGB	ADDED LCMD35-8-Q, LCMD95-10-X	13J059BB-JC
03	7/14	JHNU	TLCO	RGB	ADDED 5f ONLY TO WIRE SIZE FOR X300 PARTS	13J059BB-JC
02	6/14	JHNU	TLCO	RGB	REVISED NOTE 7: 630 WAS 240	13J059BB-JC
01	6/14	JHNU	TLCO	RGB	REVISED l DIM: LCMD50-10 WAS 91.0, LCMD300-12 WAS 139.0 REVISED o DIM: LCMD10-8 WAS 6.20 REVISED m DIM: LCMD50-10 WAS 11.5, LCMD300-12 WAS 22.0 REVISED t DIM: LCMD10-8 WAS 1.05, LCMD16-8 WAS 1.20 LCMD25-12 WAS 1.60, LCMD35-12 WAS 1.50, LCMD50-12 WAS 1.80	13J059BB-JC
00	4/14	JHNU	TLCO	RGB	DRAWING RELEASED	

TITLE
METRIC LUGS - LCMD TWO HOLE SERIES 10-630mm STANDARD BARREL CUSTOMER DRAWING

ITEM REVISION NAME
13J059BB/06
DATASET FILE NAME
13J059BB-JC/06.SLDDRW

UNLESS OTHERWISE SPECIFIED, DIMENSIONAL TOLERANCES ARE: IN [mm]
.X ± .XXX ±
.XX ± ANGLES ±

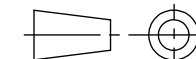

THIRD ANGLE PROJECTION



SEE NOTES

DRAWING NUMBER
13J059BB-JC

DRAWN BY
JHNU
DATE
12/13
CHK
TLCO
SCALE
NONE

SHEET 1 OF 1
SIZE
B