

3M™ 25G SFP28 Direct Attach Copper Cable Assemblies, 1422/1423 Series  
Visit 3M.com/interconnect

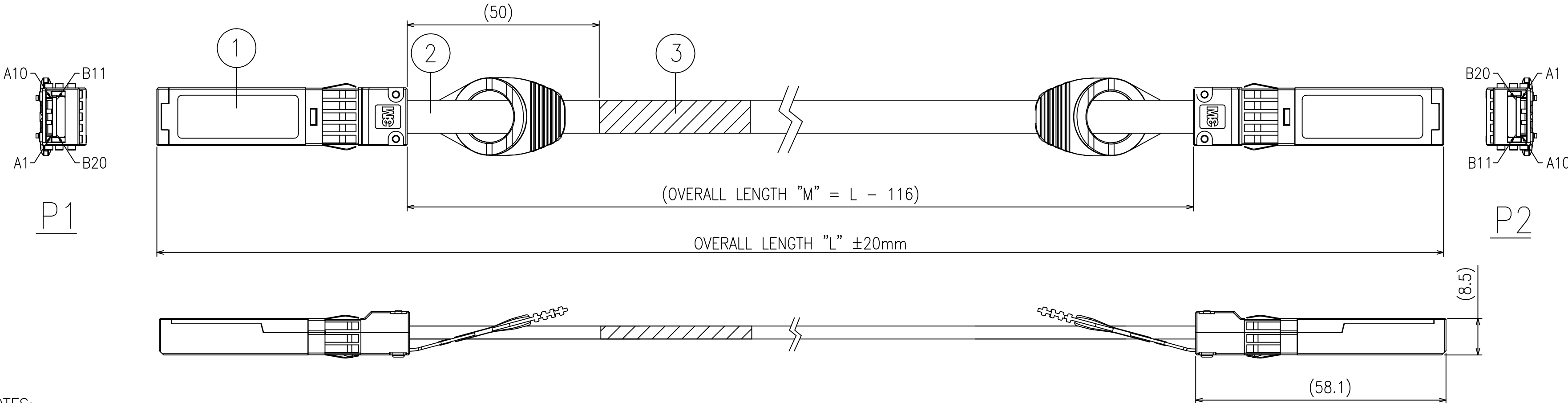

- NOTES:
1. ORDERING INFORMATION:
- 14XX-P XX-07-X.XX
- 22-UNIVERSAL PULLTAB (BOTTOM)
- 23-UNIVERSAL PULLTAB (TOP)
- PASSIVE UNEQUALIZED
- LENGTH OPTIONS "L" (in meters)
- CODE CABLE CONFIGURATION
- 24 30AWG UTJ PVC JACKET COLOR BLACK WITH COPPER FOIL (UPTO 2METERS)
- 34 26AWG UTJ PVC JACKET COLOR BLACK WITH COPPER FOIL (2METERS to 4METERS)
2. MATERIALS:
- ① - SFP+ SHELL KIT, 2 PCS
- ② - HEAT SHRINKABLE TUBE BLACK (OPTIONAL), 2 PCS
- ③ - LILONG LABEL=CLEAR/WHITE BACKGROUND WITH BLACK TEXT, TEXT H=2.00MM, ARIAL, L\*W=40\*30MM, "YYWW" IS DATE CODE, e.g YEAR=2007, WEEK=26, YYWW=0726
3. CABLE JACKET DETAIL: PVC, COLOR BLACK
4. THIS CABLE ASSEMBLY IS RoHS COMPLIANT
5. BULK CABLE IMPEDANCE: 100±5 OHMS (DIFFERENTIAL)
6. DESIGN TO SFP STANDARD SFF-8431
7. UNLESS OTHERWISE NOTED, REFERENCES TO INDUSTRY SPECIFICATIONS ARE INTENDED TO INDICATE SUBSTANTIAL COMPLIANCE TO THE MATERIAL ELEMENTS OF THE SPECIFICATION. SUCH REFERENCES SHOULD NOT BE CONSTRUED AS A GUARANTEE OF COMPLIANCE TO ALL REQUIREMENTS IN A GIVEN SPECIFICATION.
8. CABLE RETURN LOSS PERFORMANCE IS VALID FOR CABLE ASSEMBLIES OF A MINIMUM OF 1.00 METER IN LENGTH. CABLE ASSEMBLIES LESS THAN 1.00 METER IN LENGTH MAY NOT ACHIEVE THE RETURN LOSS PERFORMANCE IN IEEE802.3bj. CABLE RETURN LOSS PERFORMANCE IS SUBJECT TO CHANGE WITH DIFFERENT CABLE ASSEMBLY LENGTHS. END USER WILL NEED TO DETERMINE WHETHER THIS PRODUCT IS SUITABLE FOR THEIR INTENDED APPLICATION.

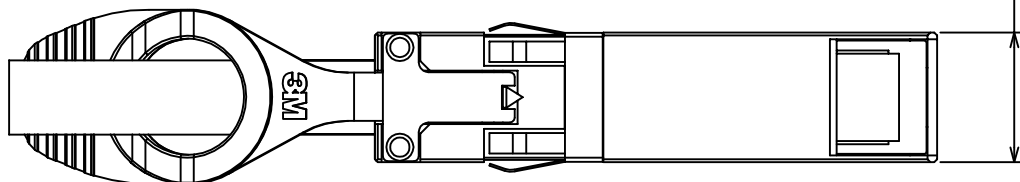

P1/P2	
PIN NO.	SYMBOL
1	VeeT
2	Tx_Fault
3	Tx_Disable
4	SDA
5	SCL
6	Mod_ABS
7	RS0
8	Rx_LOS
9	RS1
10	VeeR

ASSEMBLY PINOUT

P1		P2	
B11	GND	B20	GND
B12	Rx-	B19	Tx-
B13	Rx+	B18	Tx+
B14	GND	B17	GND
B15	-	B16	-
B16	-	B15	-
B17	GND	B14	GND
B18	Tx+	B13	Rx+
B19	Tx-	B12	Rx-
B20	GND	B11	GND

DESIGN REFERENCE		NEXT ASSEMBLY	
DISTRIBUTION CODES			
DIVISION EMSD		DIVISION CODE	
DO NOT SCALE DRAWING	SCALE NTS	TOLERANCES EXCEPT AS NOTED	
THIRD ANGLE PROJECTION		INCHES	
INTERPRET PER ASME Y14.5 - 1994		MILLIMETERS	
MAX SURFACE ROUGHNESS		ANGLES ±1°	
125 ✓			
□ ALL SURFACES			
☒ MARKED ONLY			
B 0076958		DEC 12,2017	
A 0074719		JUL 12,2017	
REV ECO		ISSUE DATE AND DESCRIPTION	
DRFT YUNLONG		MFG EDDIE	
CHKD YUNLONG		APPVL SAUJIT BANDHU	
DATE JUL 12,2017		DATE JUL 12,2017	
3M		3M Center St. Paul, MN 55144	
TITLE		3M™ 25G SFP28 Direct Attach Copper Cable Assemblies, 1422/1423 Series	
CAGE NUMBER		DRAWING NO.	
C		78-5100-2664-0	
MODEL		REV. B	
		DET. SHT 1 OF 2	

1

## D



A

3



## D

78-5100-2664-0	B
DRAWING NUMBER	REVISION

B

A

1