

REVISIONS					
REV	ECO	DESCRIPTION	DATE	BY	APPR
A1	-	RELEASE NEW DRAWING	11MAY18	ROOKIE	TOMMY

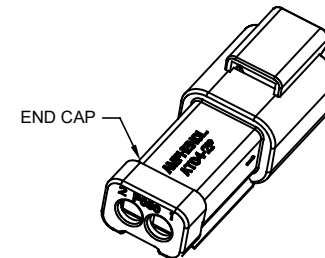
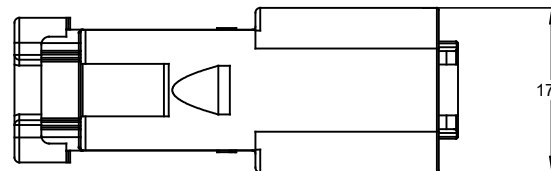
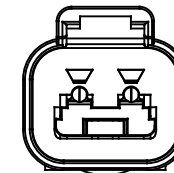
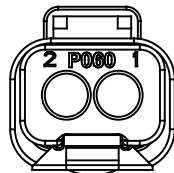
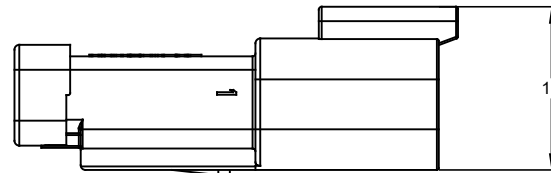
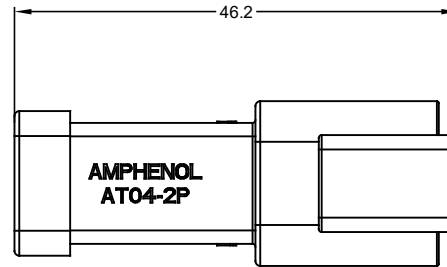

NOTES: UNLESS OTHERWISE SPECIFIED

1. MATERIAL:
HOUSING: THERMOPLASTIC, BLACK
SEAL: SILICONE RUBBER
CONTACT: COPPER ALLOY
2. MODIFICATIONS: BLACK, 2 PIN BUSBAR WITH NICKEL PLATED
3. SPECIFICATIONS:
 - 3.1 CURRENT RATING: 13 AMPS MAXIMUM FOR THE 2 PIN BUSBAR
 - 3.2 OPERATING TEMPERATURE: -55°C TO +125°C.
 - 3.3 DIELECTRIC WITHSTANDING VOLTAGE: LESS THAN 2 MILLIAMPS CURRENT LEAKAGE @ 1500 VOLTS AC.
 - 3.4 INSULATION RESISTANCE: 1000 MEGOHM MIN @ 25°C.
 - 3.5 MOISTURE RESISTANCE: IP67 (MATED CONDITION).
 - 3.6 MATING CYCLE DURABILITY: 100 CYCLES
 - 3.7 RoHS COMPLIANT
4. MATING PART: AT06-2S* PLUG
(* = AVAILABLE MODIFICATIONS)
6. ALL DIMENSIONS ARE FOR REFERENCE USE ONLY.

AT04-2P-P060		DESCRIPTION		ITEM
QUANTITY	PART NUMBER	MATERIALS LIST		
UNLESS OTHERWISE SPECIFIED: 1) All dimensions are in metric (mm). 2) Tolerances are as follows: 1 PL DEC ±0.30 2 PL DEC ±0.15 3 PL DEC ±0.08 Fractions ±1/64 Angles ±1° 3) Note reference =		SIGNATURES		DATE
MATERIAL SPECIFICATIONS:		DRAWN: ROOKIE		11MAY18
PROCESS SPECIFICATIONS:		CHECKED: ORION		11MAY18
NEXT ASSY:		APPROVAL: TOMMY		11MAY18
		CUSTOMER:		
		THIS DRAWING IS SUPPLIED FOR INFORMATION ONLY. DESIGN FEATURES, SPECIFICATIONS AND PERFORMANCE DATA SHOWN HEREON ARE THE PROPERTY OF THE AMPHENOL CORPORATION. NO RIGHTS OF REPRODUCTION ARE IMPLIED. ALL DIMENSIONS ARE SUBJECT TO NORMAL MANUFACTURING VARIATIONS.		
		SINE Systems Corporation		
		A Subsidiary of Amphenol Corporation 44724 Morley Drive Clinton Township, MI 48036		
		AT 2WAY RECEPTACLE 2 PIN BUSBAR-NICKEL PLATED, BLACK		
		SIZE: B	FCM NO:	DWG NO: AT04-2P-P060
		SCALE: NONE		REVISION: A1
		SHEET 1 OF 1		

TITLE: AT2WAY RECEPTACLE 2 PIN BUSBAR-NICKEL PLATED, BLACK DWG NO: AT04-2P-P060 REV: A1 SH: 1 OF: 1