

Oct.1.2018 Copyright 2018 HIROSE ELECTRIC CO., LTD. All Rights Reserved.  
 In case that the application demands a high level of reliability, such as automotive,  
 please contact a company representative for further information.

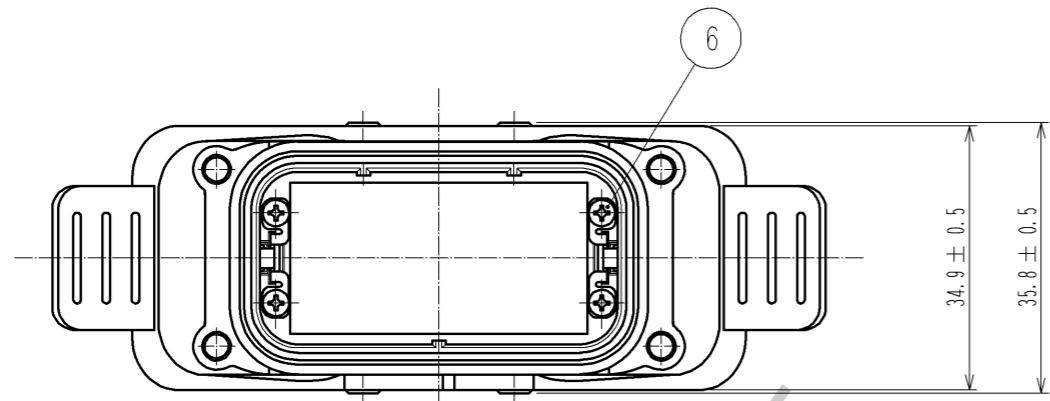

2 RECOMMENDED PANEL SIZE

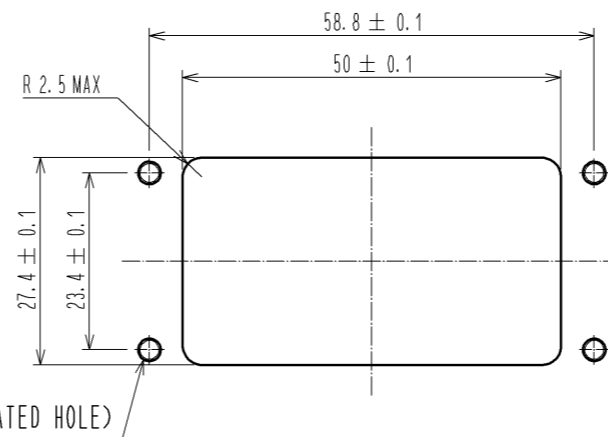

3 ELECTRODES TOUCH AREA FOR RACK PLATING(FREE)

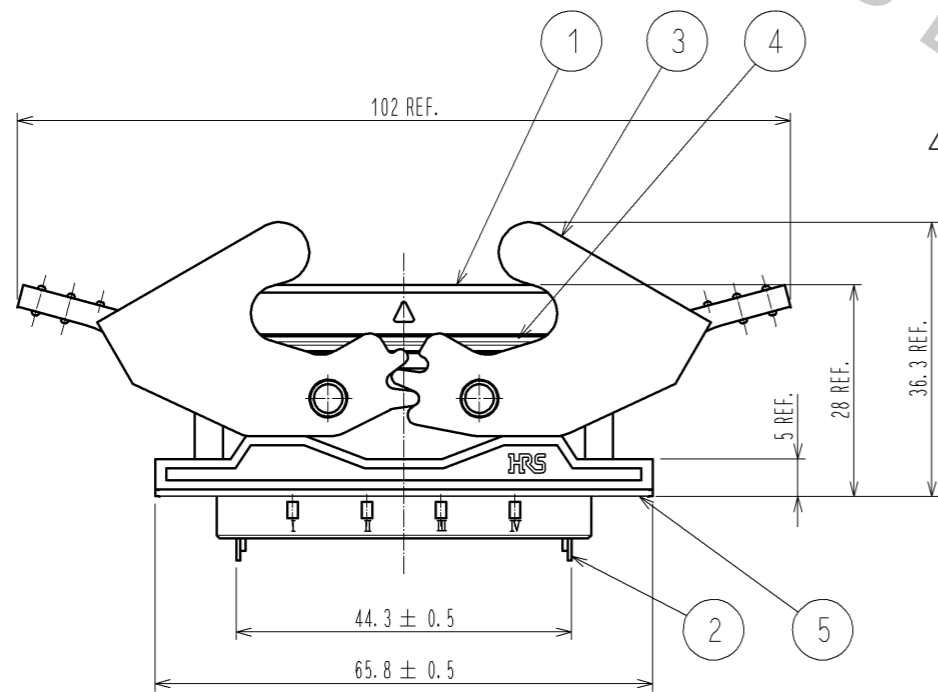
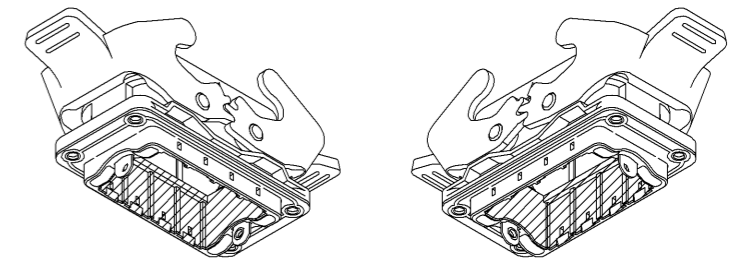

1 REVISED CONFIGURATION

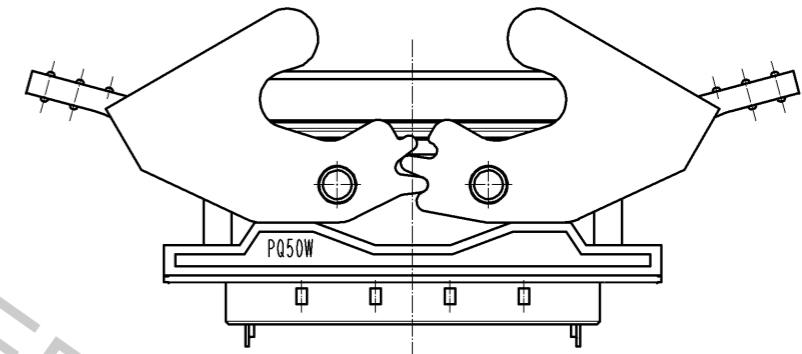
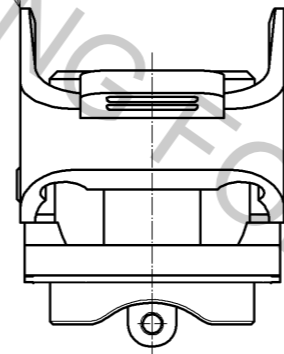

- NOTES
- REFER TO ETAD-E3022 FOR THE CONFORMITY CONNECTORS AND CONTACTS USED IN COMBINATION WITH THIS PRODUCT.
  - USE THIS PRODUCT IN THE CONDITION WHERE IT ATTACHED TO THE PANEL.  
 USING M3 SCREW FOR ATTACHMENT TO THE PANEL, SCREW FASTENING TORQUE IS 0.6 [N].  
 PERFORM WATERPROOFING PROCESSING THE SCREW PART OF ATTACHMENT.
  - THERE COULD BE DIFFERENCE COLOR OR NO-PLATING IN THE DESIGNATED AREA OF REFERENCE No.1 DUE TO TOUCH THE ELECTRODES IN THE RACK PLATING PROCESS. BUT IT DOESN'T AFFECT THE PERFORMANCE.

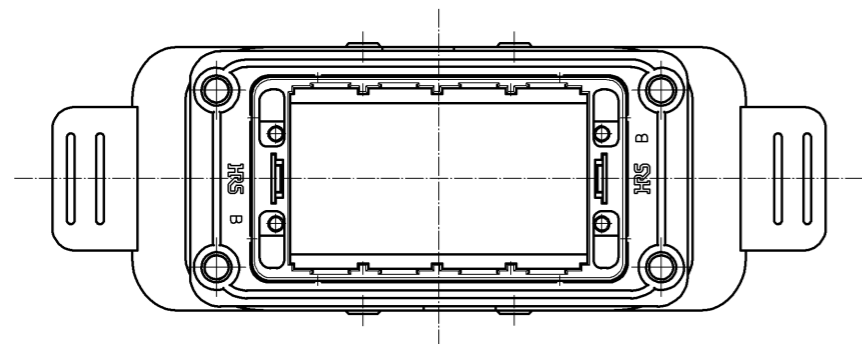

3	PA	BLACK. UL94V-0	6	STEEL	NICKEL PLATING
2	STAINLESS STEEL	NICKEL PLATING	5	NBR	BLACK
1	PPS	BLACK. NICKEL PLATING. UL94V-0	4	NBR	BLACK
NO.	MATERIAL	FINISH . REMARKS	NO.	MATERIAL	FINISH . REMARKS
UNITS mm		SCALE 1 : 1	COUNT 1	DESCRIPTION OF REVISIONS	
				DESIGNED TS. SAKAIZAWA	CHECKED NM. NISHIMATSU
				DATE 14. 11. 18	
<b>HRS</b> HIROSE ELECTRIC CO., LTD.		APPROVED : RI. TAKAYASU	13. 02. 05	DRAWING NO. EDC3-127528-00	
		CHECKED : NM. NISHIMATSU	13. 02. 05	PART NO. PQ50W-50-FL	
		DESIGNED : TS. SAKAIZAWA	13. 02. 04	CODE NO. CL236-2020-5-00	
		DRAWN : TS. SAKAIZAWA	13. 02. 04		