

THIS DRAWING IS UNPUBLISHED. RELEASED FOR PUBLICATION
 © COPYRIGHT - By TE CONNECTIVITY ALL RIGHTS RESERVED.

REVISIONS				
P	LTR	DESCRIPTION	DATE	APVD
C3		RELEASED 63585-2	21NOV16	SV PKS

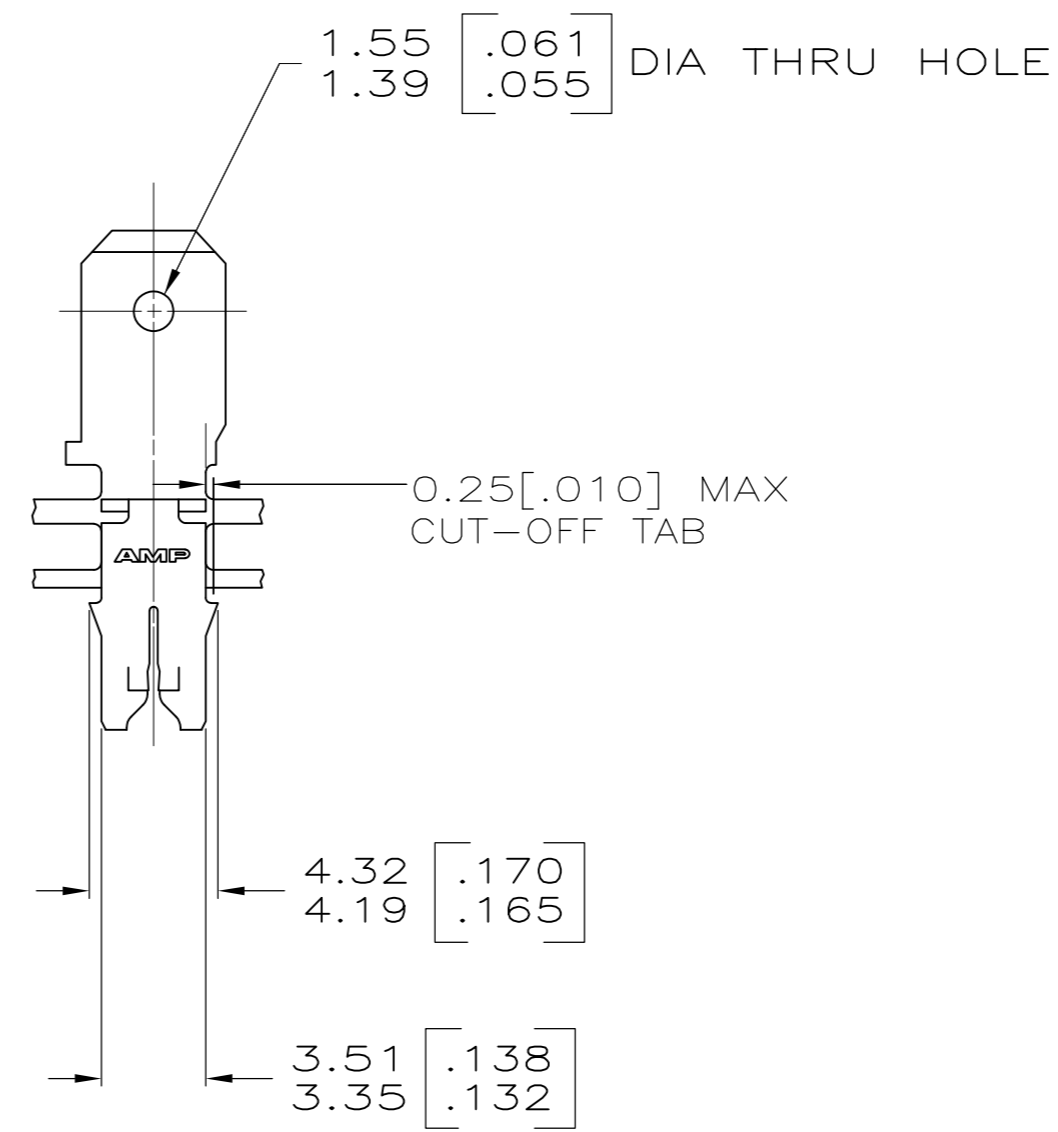

- 1 CONTINUOUS STRIP ON REELS WITH TERMINALS LOCATED ON 5.59±0.08 [.220±.003] CENTERS.
- 2 AFTER INSERTION INTO PLASTIC HOLDER TAB PORTION MUST BE BENT 45° TO 90° OR POTTED-IN TO PREVENT PULL-OUT WHEN MATING RECEPTACLE IS DISCONNECTED.
- 3 SLOT TERMINATES EITHER SINGLE OR DOUBLE MAGNET WIRE OF THE SAME SIZE AND TYPE.
COPPER RANGE: 0.36-0.57mm [#27-#23] AWG.
- 4 TIN PLATE.
- 5 THIS PART IS REELED WITH INTERLAYER PAPER.

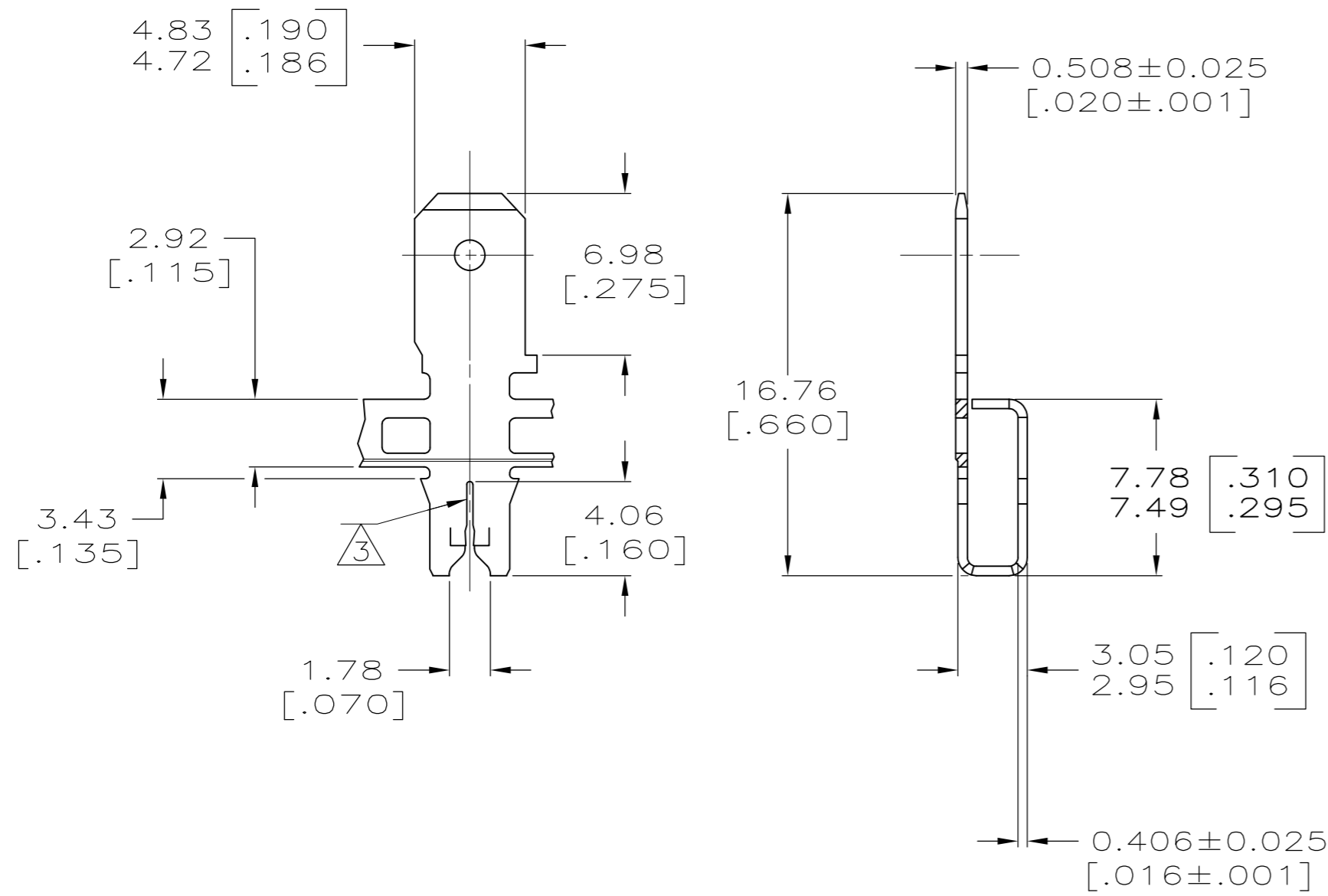

4	63585-2	5
4	63585-1	
FINISH	PART NUMBER	

THIS DRAWING IS A CONTROLLED DOCUMENT.		DWN 7FEB2005 MICHAEL S. FEHER	TE Connectivity	
DIMENSIONS: INCHES		CHK 7FEB2005 KURT A. RANDOLPH	NAME	
TOLERANCES UNLESS OTHERWISE SPECIFIED:		APVD 7FEB2005 KURT A. RANDOLPH	TAB, 4.75 [.187] FASTON, 300 SERIES MAG-MATE	
0 PLC ± -		PRODUCT SPEC	SIZE	CAGE CODE
1 PLC ± -		108-2012	A2	00779
2 PLC ± -		APPLICATION SPEC	DRAWING NO	RESTRICTED TO
3 PLC ± 0.25 [.010]		114-2046	C=63585	-
4 PLC ± -		WEIGHT	SCALE	SHEET
ANGLES ± -		0	4:1	1 OF 1
FINISH		CUSTOMER DRAWING	REV	C3
SEE TABLE				