

CONTACT ORIENTATION ON ROLL

NOTES : (UNLESS OTHERWISE SPECIFIED)

- MATERIAL :
  - CONTACT BODY : COPPER ALLOY.
  - OUTER SPRING : STAINLESS STEEL.
- SPECIFICATIONS :
  - CURRENT RATING : 5A MAX.
  - TERMINATION TYPE : CRIMPING.
  - WIRE RANGE : 26~24AWG.
  - WIRE INSULATION DIA(MAX) :  $\varnothing$ 2.6mm.
- ROHS COMPLIANT.
- ALL DIMENSIONS ARE FOR REFERENCE USE ONLY.
- AVAILABLE TOOLS :
  - HAND CRIMPER : MFX-3954.
  - CRIMP APPLICATOR : MFX-3957.
  - EXTRACTION TOOL : QXRT20.

P/N	CONTACT PLATING(MATING AREA)
SS24W2T	TIN PLATING OVER NICKEL.
SS24W2F	GOLD FLASH PLATING OVER NICKEL.
SS24W2G10	10 $\mu$ "GOLD PLATING OVER NICKEL.
SS24W2G15	15 $\mu$ "GOLD PLATING OVER NICKEL.
SS24W2G30	30 $\mu$ "GOLD PLATING OVER NICKEL.

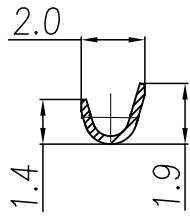
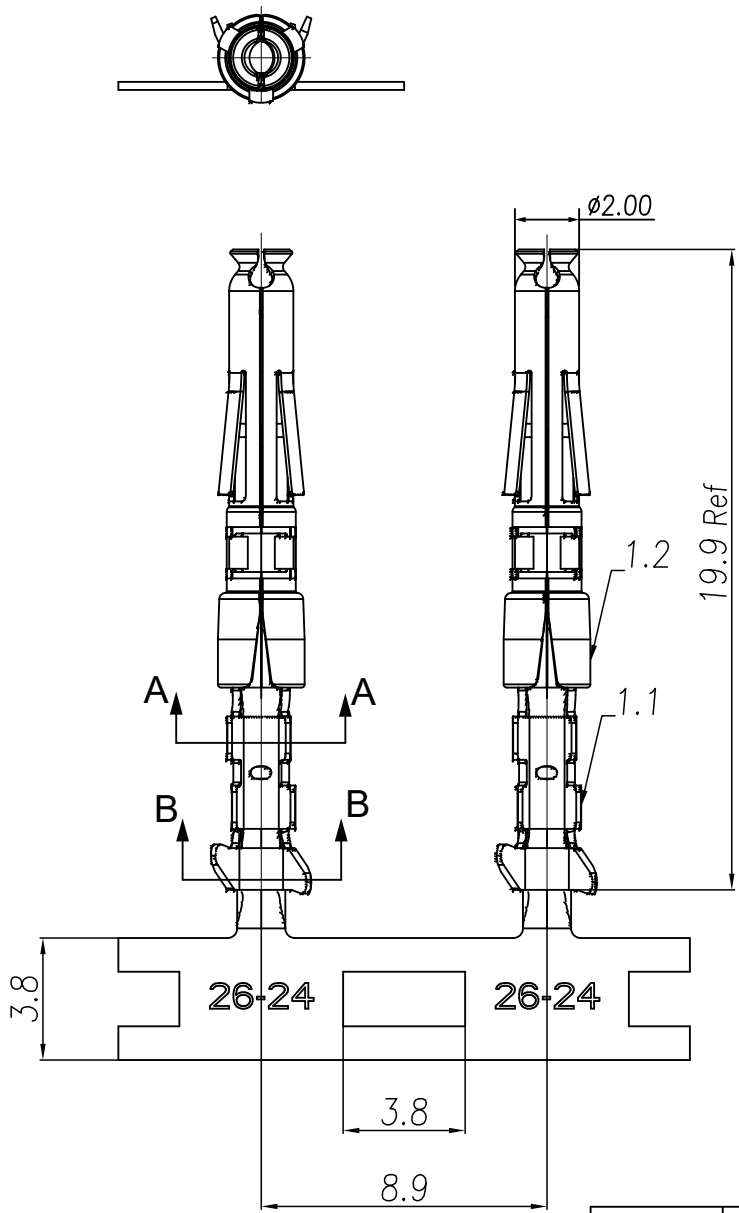

SECTION A-A

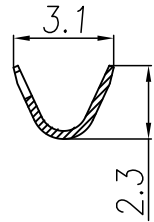

SECTION B-B

QUANTITY	PART NUMBER	DESCRIPTION	ITEM
MATERIALS LIST			
UNLESS OTHERWISE SPECIFIED		SIGNATURES	DATE
1) All dimensions are in metric(mm).		DRAWN:	ROOKIE
2) Tolerances are as follows:		CHECKED:	ORION
1 PL DEC $\pm 0.30$		ENGINEER:	
2 PL DEC $\pm 0.15$		APPROVAL:	TOMMY
3 PL DEC $\pm 0.08$		CUSTOMER:	NOV-9-17
3) Note reference = $\triangle$		THIS DRAWING IS SUPPLIED FOR INFORMATION ONLY. DESIGN FEATURES, SPECIFICATIONS AND PERFORMANCE DATA SHOWN HEREON ARE THE PROPERTY OF THE AMPHENOL CORPORATION. NO RIGHTS OF REPRODUCTION ARE IMPLIED. ALL DIMENSIONS ARE SUBJECT TO NORMAL MANUFACTURING VARIATIONS.	
MATERIAL SPECIFICATIONS:		ECO-MATE, SOCKET CONTACT, STAMPED, 24-26AWG, SIZE 20	
PROCESS SPECIFICATIONS:		SIZE	TYPE
NEXT ASSY:		B	C-
		SCALE:	NONE
		DWG NO:	SS24W2XX
		REVISION	A1
		SHEET	1 OF 1

REVISIONS					
REV	ECO	DESCRIPTION	DATE	BY	APPR
A1	-	RELEASED DRAWING	NOV-9-17	ROOKEI	TOMMY

TITLE: ECO-MATE, SOCKET CONTACT, STAMPED, 24-26AWG, SIZE 20

DWG NO:

SS24W2XX

REV: A1

SH: 1

OF: 1