

THE INFORMATION CONTAINED IN THIS DRAWING IS THE SOLE PROPERTY OF L-COM, INC. ANY REPRODUCTION IN PART OR WHOLE WITHOUT THE WRITTEN PERMISSION OF L-COM, INC. IS PROHIBITED.

REVISIONS			
REV	DESCRIPTION	DATE	APPROVED
A	REV A DRAWING RELEASED	10/26/2018	JYOU

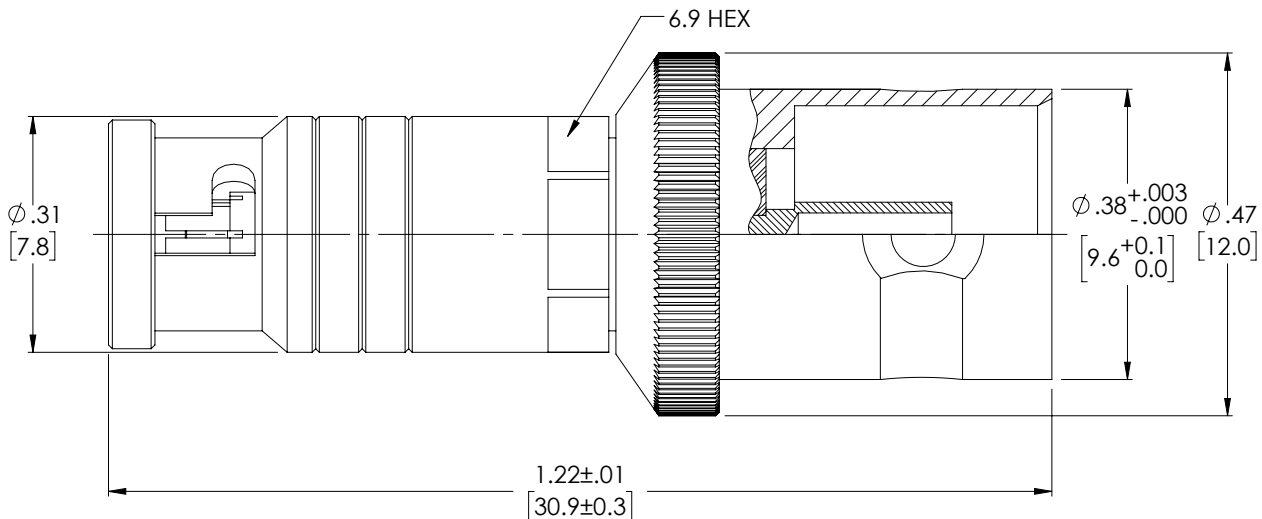

**Notes:**

Electrical:  
 Impedance: 75Ω  
 Frequency Range: 0~12 GHz.  
 Voltage Rating: 500 V rms.  
 Insulator Resistance: ≥5 GΩ  
 Dielectric Withstanding Voltage: 1000 V rms.  
 Contact Resistance: Center Contact ≤3 mΩ  
 Outer Contact ≤2.5 mΩ  
 Reflection Factor(VSMR) 1.25 MAX. DC-6.0 GHz  
 1.30 MAX. 6.0-12 GHz

Environment:  
 Temperature Range: -65a to 165a  
 Corrosion (Salt Spray): **MIL-STD-202**, Method 101, Cond. C  
 Thermal Shock: **MIL-STD-202**, Method 107, Cond. B  
 Mechanical: **MIL-STD-202**, Method 213, Cond. I  
 Vibration: **MIL-STD-202**, Method 204, Cond. D

PACKAGING:  
 CONNECTOR SHALL BE INDIVIDUALLY PACKAGED IN ACCORDANCE WITH L-COM SPECIFICATION PS-0031.

**REGULATORY COMPLIANCE:**  
 CE2011/65/EU(RoHS DIRECTIVE)

ITEM	Description	Material	Finish
5	BNC Inner Contact	P.Bronze	NICKEL/GOLD PLATE
4	Ultra Tiny BNC Inner Contact	BeCu	NICKEL/GOLD PLATE
3	Insulator	PTFE	None
2	Body	Brass	NICKEL PLATE
1	Shell	Brass	NICKEL PLATE

UNLESS OTHERWISE SPECIFIED, DIMENSIONS ARE IN INCHES [mm] OVERALL CABLE LENGTH TOLERANCE: ≤12 [305] = +1 [25] / -0 >12 [305] ≤60 [1524] = +2 [51] / -0 >60 [1524] ≤120 [3048] = +4 [102] / -0 >120 [3048] ≤300 [7620] = +6 [152] / -0 >300 [7620] = +5% / -0% ALL OTHER DIMENSIONAL TOLERANCES: .X = ± .2 [5.08] .XX = ± .02 [5.1] .XXX = ± .005 [1.3]	APPROVALS	DATE
	DRAWN BY JYOU	09/12/2018
	CHECKED BY BZHANG	09/12/2018
	APPROVED BY SPAN	09/12/2018
PROJECTION 	CONFIGURATION DETAILS OF UNDIMENSIONED FEATURES MAY VARY	COLOR VARIATIONS MAY OCCUR

		50 HIGH STREET NORTH ANDOVER, MA 01845	
CATEGORY		Coaxial	
PRODUCT DESCRIPTION			
BNC Jack to Ultra Tiny BNC Plug Adapter			
SIZE <b>A</b>	FSCM NO. <b>43321</b>	DWG. NO. V7C00020	REV. <b>A</b>
SCALE: NONE		CAD FILE: V7C00020.SLDDRW	
SHEET 1 OF 1			