

Applicable cable

Items	Applicable condition
Conductor size	AWG 24
Insulation O.D.	Ø1.1 to 1.25 mm
Braid Shield	Tin plating
Sheath O.D.	Ø6.3mm - Ø7.2mm

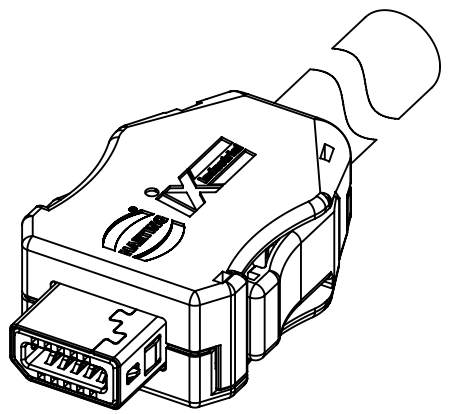
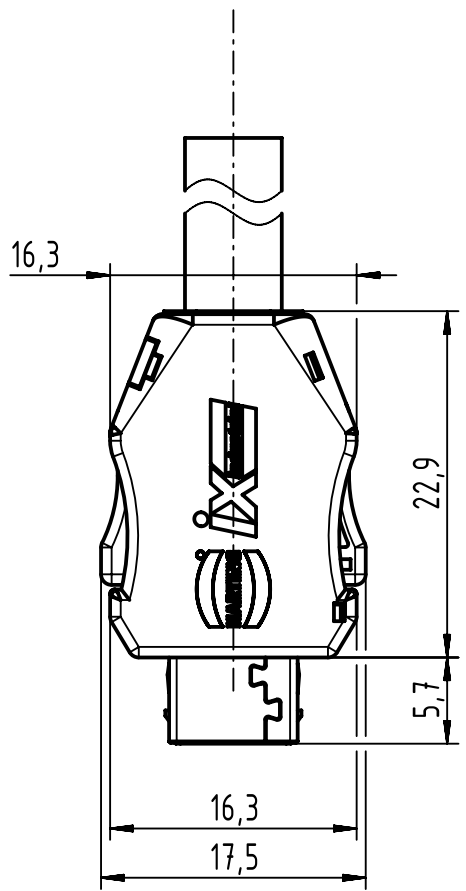

Contact material: copper alloy
 Contact area: Gold 0.2µm min.
 Wiring area: Gold 0.03µm min.
 Under plating: Nickel 2µm min.

Pin	10/100 Mbit/s	1/10 Gbit/s
1	TX+	BI_DA+
2	TX-	BI_DA-
3	N.C.	N.C.
4	N.C.	BI_DC+
5	N.C.	BI_DC-
6	RX+	BI_DB+
7	RX-	BI_DB-
8	N.C.	N.C.
9	N.C.	BI_DD+
10	N.C.	BI_DD-

	All Dimensions in mm Original Size DIN A4	Scale 2:1	Free size tol.		Ref. Sub.	
	All rights reserved Department EL PD	Created by TAMAS	Inspected by PRIESTER	Standardisation HOFFMANN	Date 2018-06-13	State Final Release
HARTING Electronics GmbH D-32339 Espelkamp		Title IDC type Plug A key, Cable guide Ø1.3 (HARTING Logo)			Doc-Key / ECM-Nr. 100791017/UGD/000/A 500000136323	
		Type TB	Number 09451812562		Rev. A	Page 1/2

Shield Shell delivery form

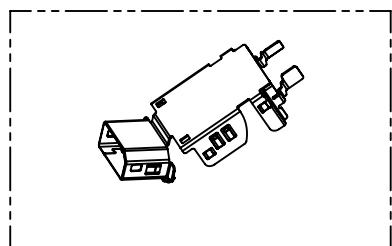

Product Structure

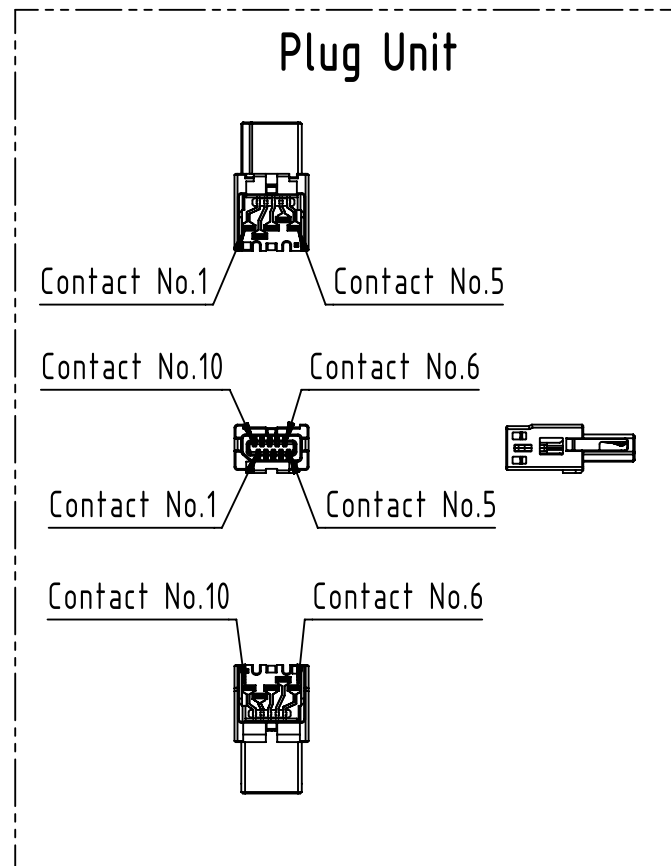
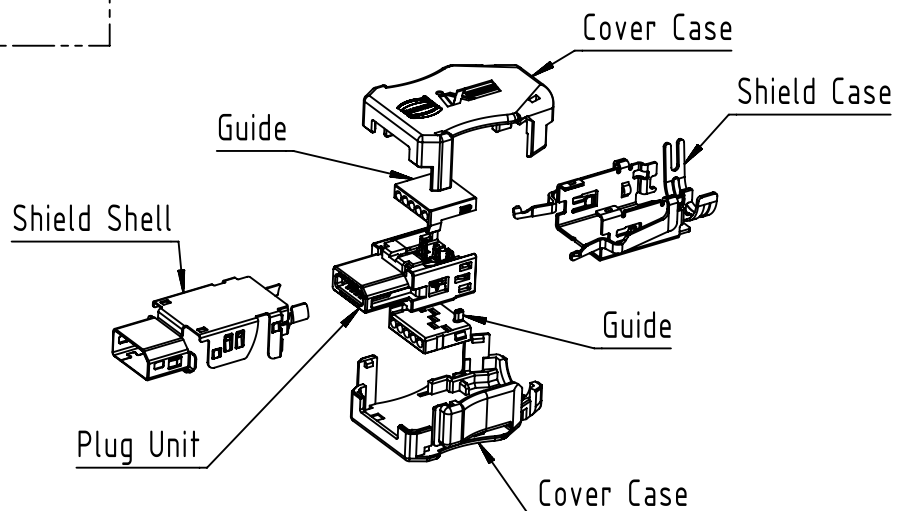

Mating condition (2:1)

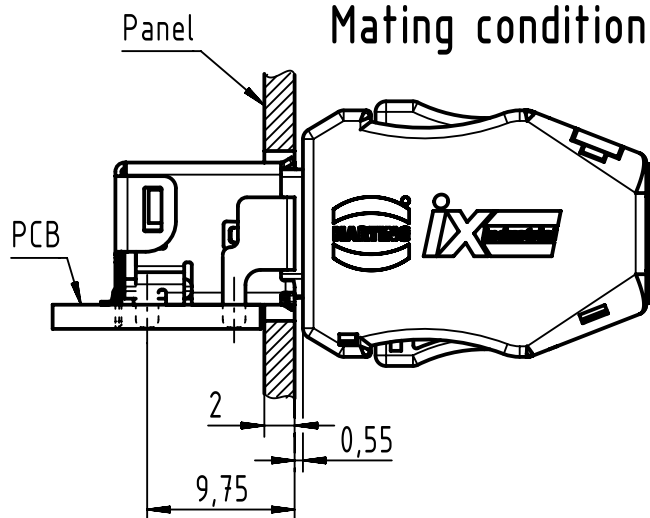

	All rights reserved Department EL PD	All Dimensions in mm Original Size DIN A4		Scale 1:1	Free size tol.	Ref. Sub.	
		Created by TAMAS	Inspected by PRIESTER	Standardisation HOFFMANN	Date 2018-06-13	State Final Release	
HARTING Electronics GmbH D-32339 Espelkamp		Title IDC type Plug A key, Cable guide Ø1.3 (HARTING Logo)				Doc-Key / ECM-Nr. 100791017/UGD/000/A 500000136323	
		Type TB	Number 09451812562			Rev. A	Page 2/2