

MATING PROFILE

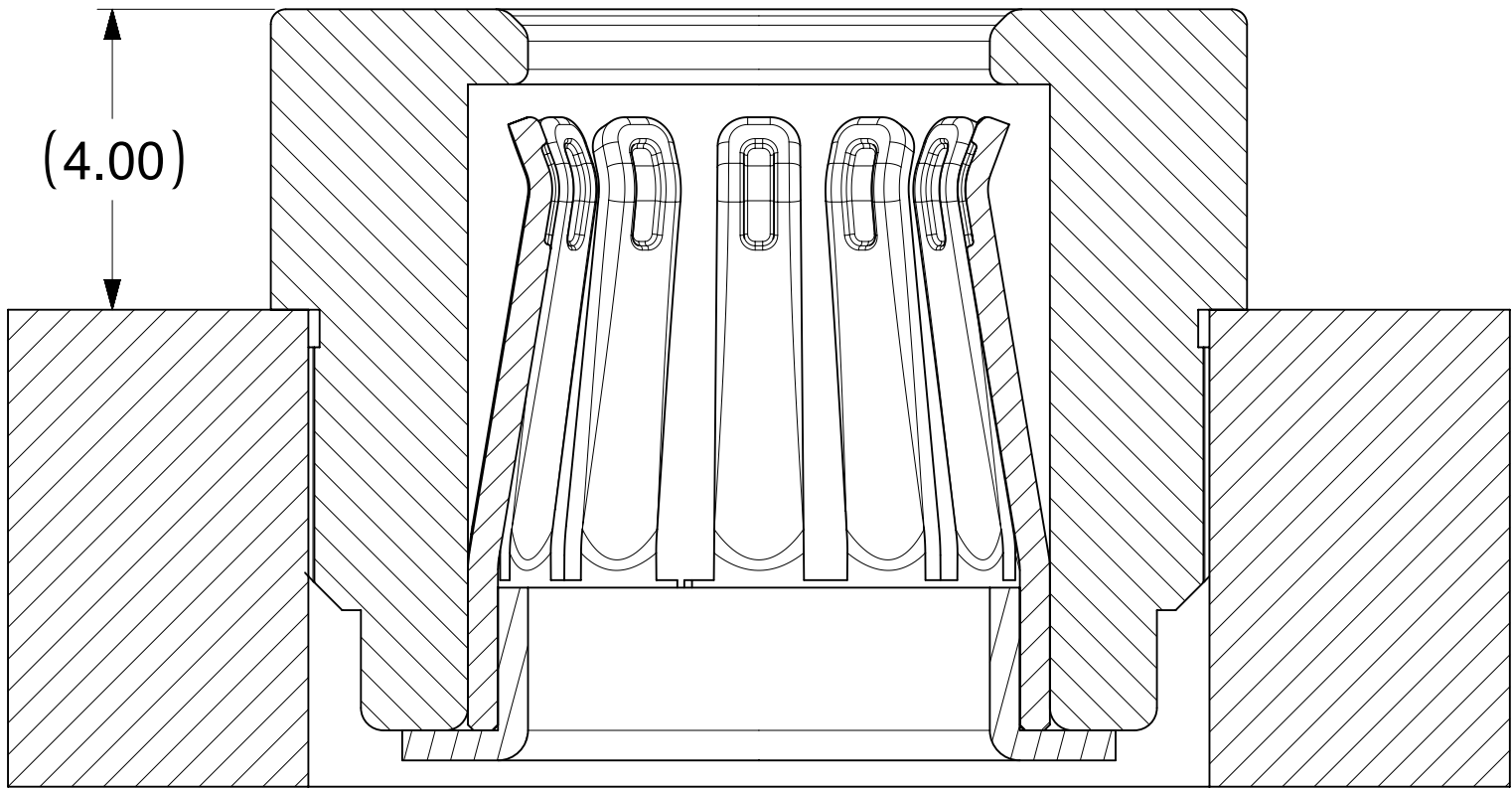
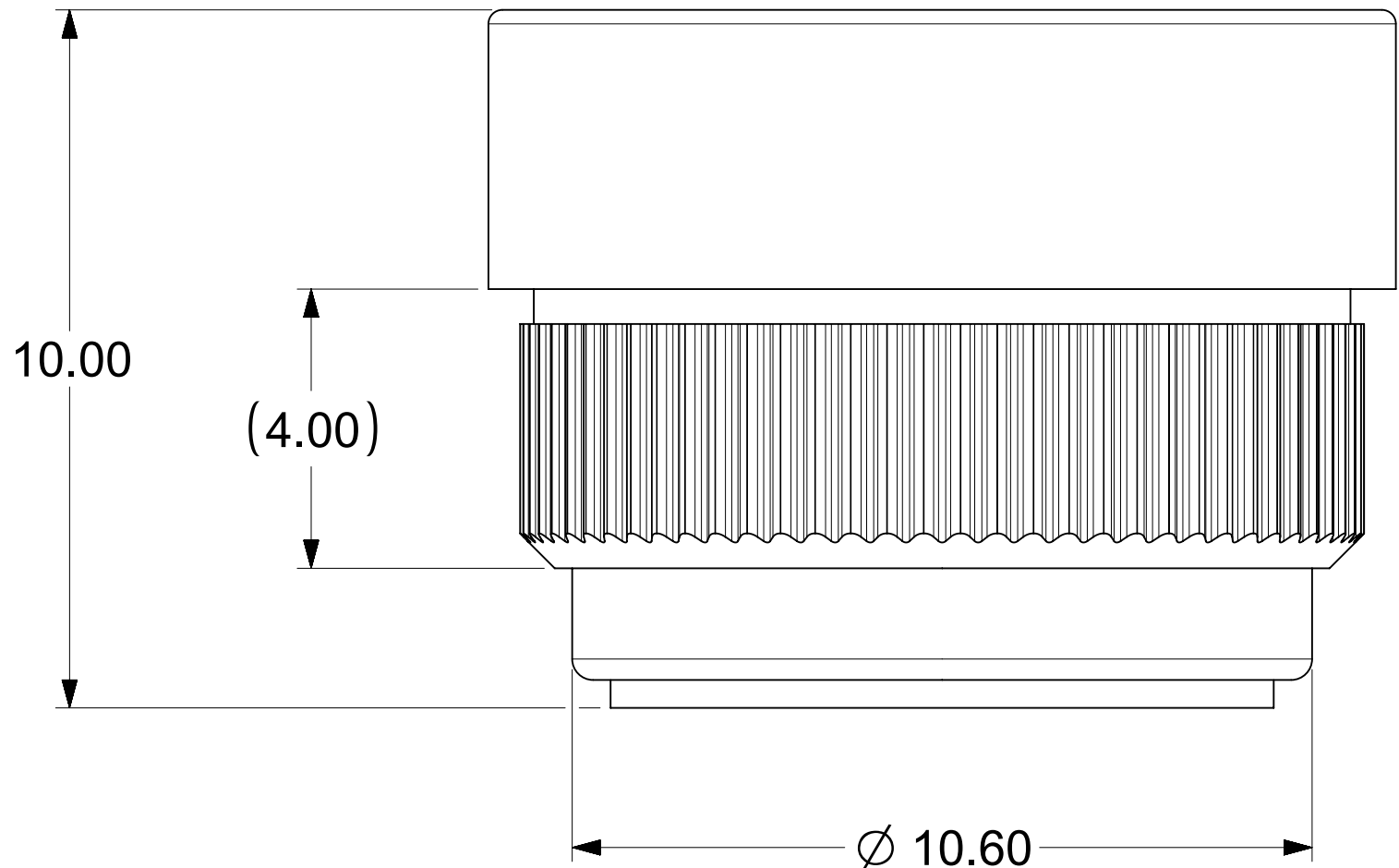

SECTION A-A

- NOTES:
1. MATERIALS: COPPER ALLOY
 2. PLATING:
 - i. CONTACT AREA: GOLD
 - ii. REST: SILVER WITH TARNISH INHIBITOR
 3. MATES WITH THE STANDARD PIN DRAWINGS:
 - i. 6.0MM SMT DRAWING 2032630136-SD, MIN. MATING DISTANCE 6.75MM
 - ii. 6.0MM PRESS FIT DRAWING 2032630006-SD, MIN MATING DISTANCE 6.5MM
 - iii. 6.0MM SCREW MOUNT DRAWING 2032636185-SD, MIN MATING DISTANCE 9.5MM
 4. PRODUCT SPECIFICATION: 2043130006-PS
 5. APPLICATION SPECIFICATION: 2043130006-AS
 6. PACKAGING SPECIFICATION: 2043180006-PK.
 7. SILVER COMPONENTS WILL BE SUPPLIED TARNISH FREE
BUT MAY TARNISH OVER TIME.

THIS DRAWING CONTAINS INFORMATION THAT IS PROPRIETARY TO MOLEX ELECTRONIC TECHNOLOGIES, LLC AND SHOULD NOT BE USED WITHOUT WRITTEN PERMISSION																
DIMENSION UNITS		SCALE		CURRENT REV DESC:					<div>molex</div> <div>6MM CST STANDARD SOCKET PRESSFIT</div>							
mm		5:1														
GENERAL TOLERANCES (UNLESS SPECIFIED)				EC NO: 618748 DRWN: RLOW 2019/06/06 CHK'D: JJONIAK 2019/06/10 APPR: JJONIAK 2019/06/10 INITIAL REVISION: DRWN: RLOW 2019/02/19 APPR: BPISZCZOR 2019/05/30					PRODUCT CUSTOMER DRAWING							
ANGULAR TOL		±	°													
4 PLACES		±							DOCUMENT NUMBER		DOC TYPE		DOC PART		REVISION	
3 PLACES		±														
2 PLACES		±	0.25						2043160006-SD		PSD		000		A1	
1 PLACE		±	0.15													
0 PLACES		±														
DRAFT WHERE APPLICABLE MUST REMAIN WITHIN DIMENSIONS				THIRD ANGLE PROJECTION		DRAWING		SERIES		MATERIAL NUMBER			CUSTOMER			
						D-SIZE		204316		2043160006		GENERAL MARKET		1 OF 1		