

POSITRONIC INDUSTRIES BELIEVES THE DATA ON THIS DRAWING TO BE RELIABLE SINCE THE TECHNICAL INFORMATION IS GIVEN FREE OF CHARGE. THE USER EMPLOYS SUCH INFORMATION AT HIS OWN DISCRETION AND POSITRONIC INDUSTRIES ASSUMES NO LIABILITY OR RESPONSIBILITY FOR RESULTS OBTAINED OR DAMAGES INCURRED FROM USE OF SUCH INFORMATION IN WHOLE OR IN PART.

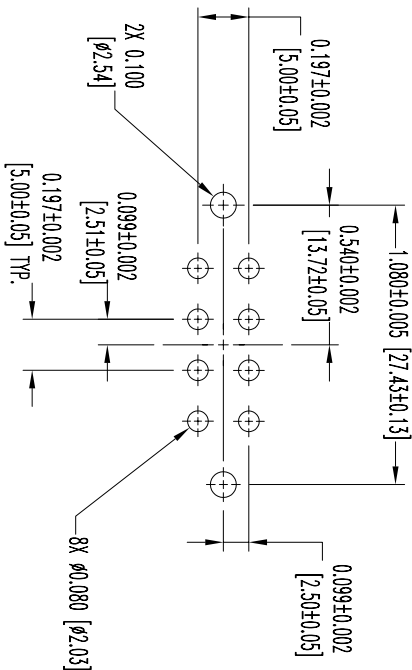
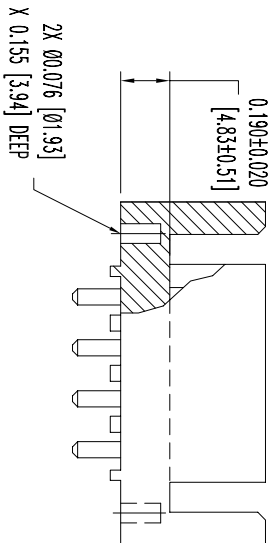
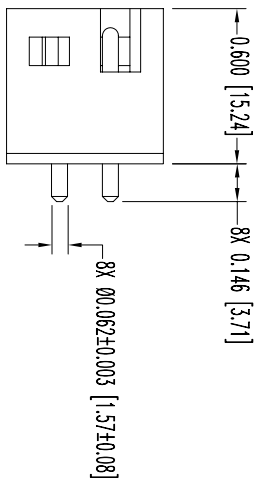
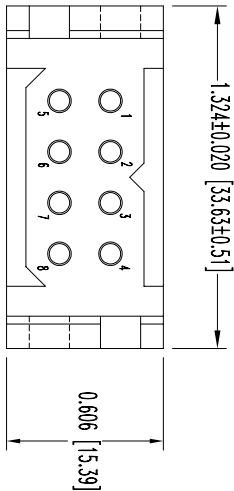

CONTACT HOLE PATTERN

- NOTES:
1. MATERIALS AND FINISHES:  
INSULATOR: GLASS FILLED POLYESTER, UL 94V-0, COLOR BLUE.  
CONTACTS: PRECISION MACHINED COPPER ALLOY, GOLD FLASH OVER NICKEL FINISH.
  2. ELECTRICAL CHARACTERISTICS:  
CONTACT CURRENT RATING: 27 AMPS PER UL 1977.  
INITIAL CONTACT RESISTANCE: 0.0016 OHMS MAX. PER IEC 512-2, TEST 2b.  
INSULATION RESISTANCE: 5 G OHMS PER IEC 512-2, TEST 3a, METHOD A.  
WORKING VOLTAGE: 600 VAC.  
WORKING TEMPERATURE: -55°C TO +125°C.
  3. WORKING TEMPERATURE: -55°C TO +125°C.
  4. CONNECTORS ARE ROHS COMPLIANT PER ROHS DIRECTIVE 2002/95/EC OF 27 JAN 2003.
  5. DIMENSIONS ARE IN INCHES [MILLIMETERS].

DATE	REV	REVISION RECORD	APP	DR	CK
9-5-07	NC	ECO 28397	RCW	YK	TK

SK8906



POSITRONIC  
INDUSTRIES INC.  
www.connectpositronic.com

FSCM 28198

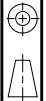

DECIMAL TOL.  
± 0.015 [0.38]

PCS SERIES

SCALE  
N.T.S.

DRAWN BY  
YK

APPROVED BY  
RCW

TITLE

PLB08M300A1/AA

ANGULAR TOL.  
± 5°

DATE  
9-5-07

DRAWING NUMBER  
SK8906

REV.  
NC