

PCB LAYOUT FOR SINGLE SIDE MOUNT

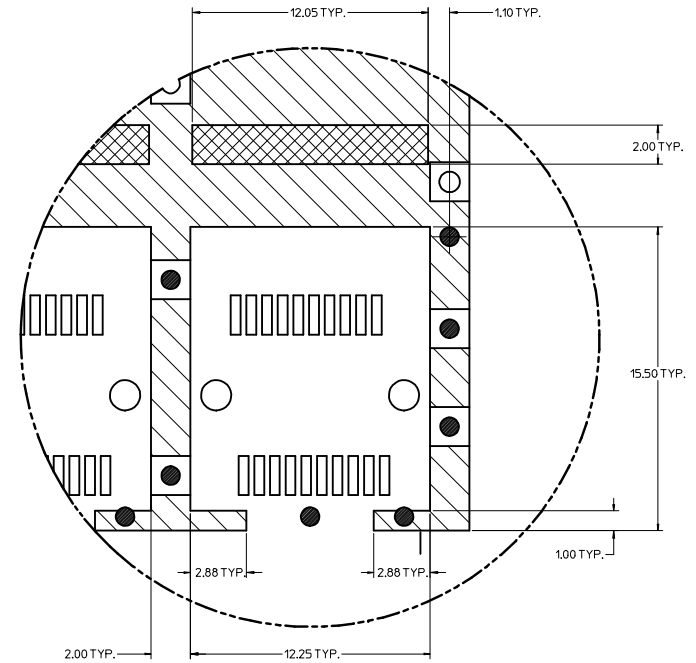
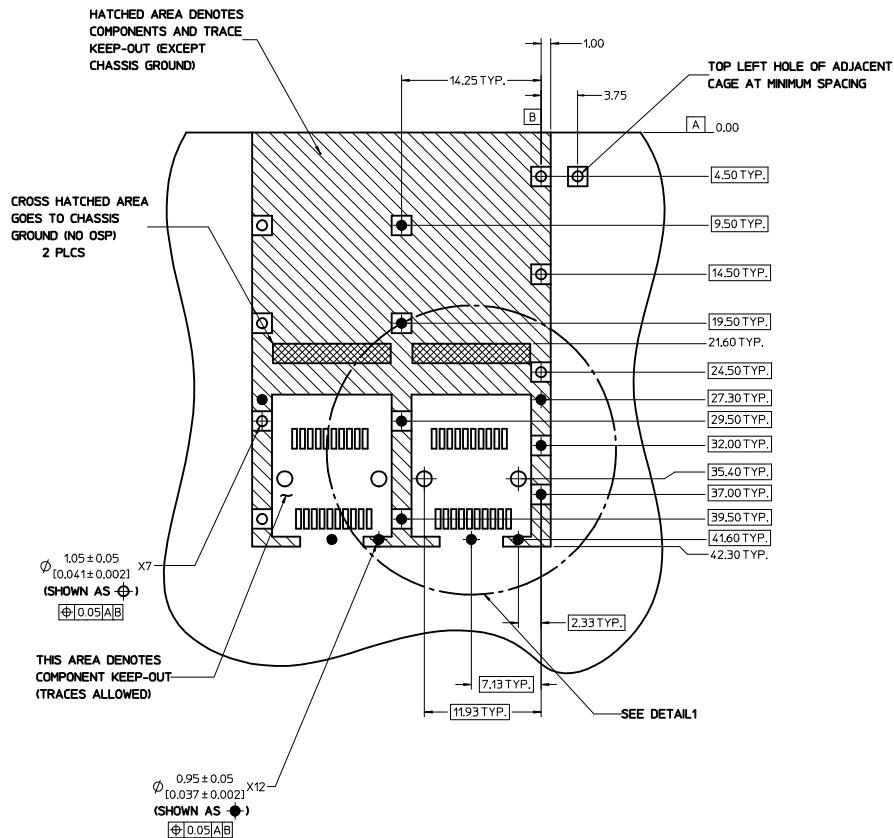

DETAIL1
SCALE 8:1
HOST CONNECTOR DETAIL

NOTES:

1. PADS AND VIAS CONNECT TO CHASSIS GROUND (RECOMMEND PADS TO BE 2.00mm SQUARE)
2. RECOMMENDED THRU HOLE PLATING INCLUDES HASL, OSP, OR IMMERSION (GOLD, SILVER, OR TIN).
3. CONNECTOR PAD LAYOUT PER SFP+ MSA WILL ACCOMMODATE MOLEX CONNECTOR SERIES 74441 OR EQUIVALENT.
4. HOLE PATTERN REPEATS FOR EACH PORT. SPACING BETWEEN PORTS IS 14.25mm.

RELEASED IEC NO: USY2009-0291 DRAWN: JERWIN 2009/01/28 CHECKED: KJANOTA 2009/01/28 APPR: KJANOTA 2009/01/28	QUALITY SYMBOLS ▽=0 ▽=0	GENERAL TOLERANCES (UNLESS SPECIFIED)		DIMENSION STYLE MM ONLY	SCALE 1:1	DESIGN UNITS METRIC	THIRD ANGLE PROJECTION
		4 PLACES ± --- ± --- 3 PLACES ± --- ± --- 2 PLACES ± 0.15 ± --- 1 PLACE ± 0.25 ± ---	mm INCH	DRAWN BY JRESENDE	DATE 08/06/16	TITLE SFP+ 1X2 CAGE ASSY W/ CUSTOM ELASTOMERIC GASKET FRAME	
		ANGULAR ±1/2°		CHECKED BY JRESENDE	DATE 08/06/16	APPROVED BY KJANOTA	
		DRAFT WHERE APPLICABLE MUST REMAIN WITHIN DIMENSIONS		MATERIAL NO. 747540215	DATE 08/06/16	DOCUMENT NO. SD-74754-0215	SHEET NO. 2 OF 4

THIS DRAWING CONTAINS INFORMATION THAT IS PROPRIETARY TO MOLEX INCORPORATED AND SHOULD NOT BE USED WITHOUT WRITTEN PERMISSION

PCB LAYOUT FOR BELLY TO BELLY MOUNTING

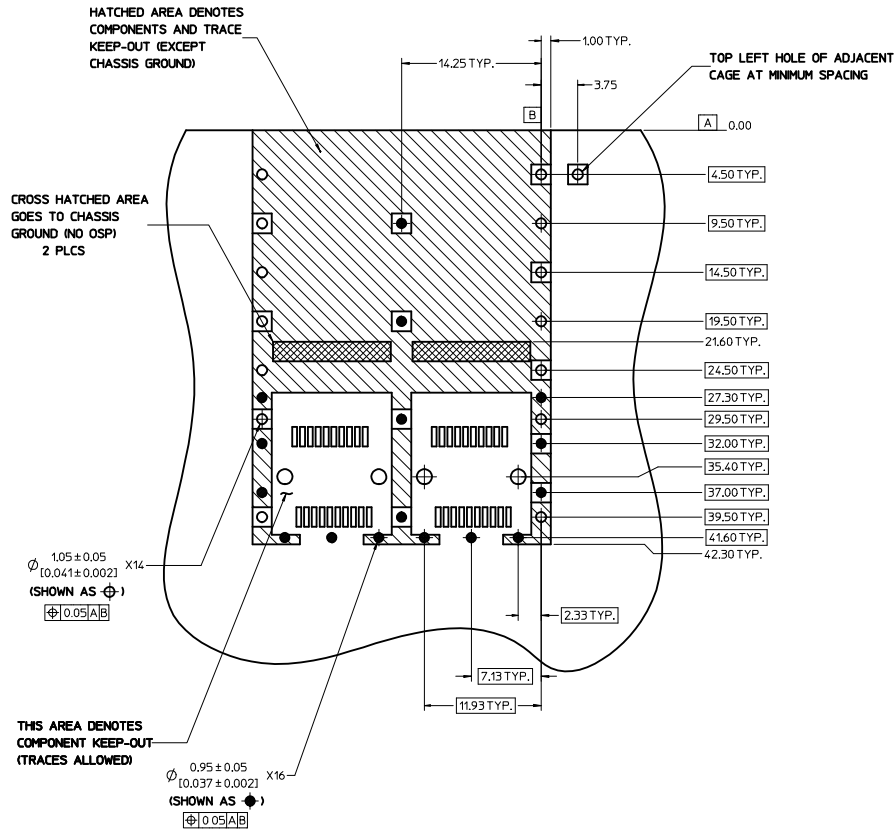

NOTE:
SEE SHEET 2 FOR
HOST CONNECTOR DETAIL

NOTES:

- PADS AND VIAS CONNECT TO CHASSIS GROUND (RECOMMEND PADS TO BE 2.00mm SQUARE)
- RECOMMENDED THRU HOLE PLATING INCLUDES HASL, OSP, OR IMMERSION (GOLD, SILVER, OR TIN).
- CONNECTOR PAD LAYOUT PER SFP+ MSA WILL ACCOMMODATE MOLEX CONNECTOR SERIES 74441 OR EQUIVALENT.
- HOLE PATTERN REPEATS FOR EACH PORT. SPACING BETWEEN PORTS IS 14.25mm.

RELEASED IEC NO: USY2009-0291 DRAWN: ERWIN CHECKED: JANOTA APPR: K. JANOTA DATE: 2009/01/28 DATE: 2009/01/28	QUALITY SYMBOLS $\nabla=0$ $\nabla=0$	GENERAL TOLERANCES (UNLESS SPECIFIED)		DIMENSION STYLE MM ONLY	SCALE 1:1	DESIGN UNITS METRIC	THIRD ANGLE PROJECTION
		4 PLACES	± ---	± ---	DATE	DATE	DATE
		3 PLACES	± ---	± ---	JRESENDE	08/06/16	JRESENDE
		2 PLACES	± 0.15	± ---	CHECKED BY	DATE	DATE
DRAFT WHERE APPLICABLE MUST REMAIN WITHIN DIMENSIONS	SIZE D	1 PLACE	± 0.25	± ---	APPROVED BY	DATE	DATE
		ANGULAR ± 1/2°		KJANOTA	08/06/16	MOLEX	MOLEX INCORPORATED
		MATERIAL NO.		DOCUMENT NO.		SHEET NO.	
		747540215		SD-74754-0215		3 OF 4	

BEZEL AND BOARD POSITION DIMENSIONS FOR SINGLE SIDE MOUNTING (GASKET)

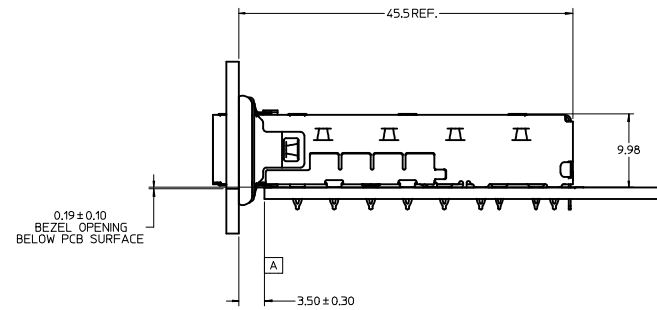
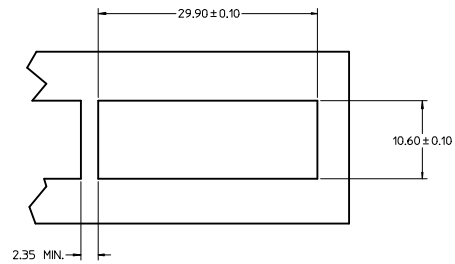

BEZEL AND BOARD POSITION DIMENSIONS FOR BELLY TO BELLY MOUNTING (GASKET)

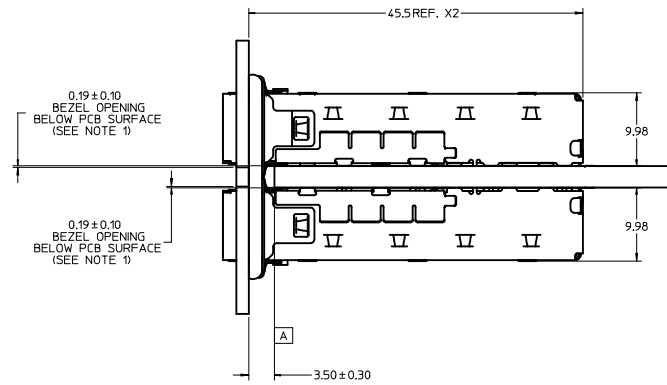
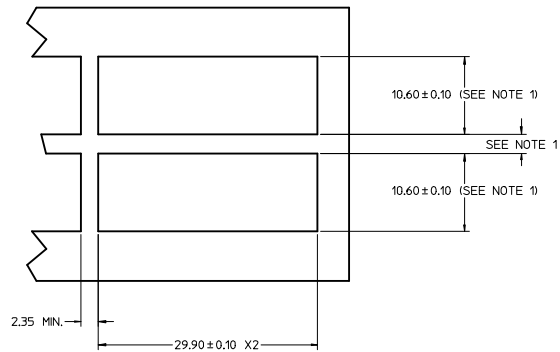

NOTE:

1. PCB THICKNESS VARIATION MUST BE CONSIDERED WHEN DETERMINING BEZEL OPENING, SIZE, AND LOCATION.

QUALITY SYMBOLS		GENERAL TOLERANCES (UNLESS SPECIFIED)		DIMENSION STYLE		SCALE		DESIGN UNITS		THIRD ANGLE PROJECTION	
				MM ONLY		1:1		METRIC			
=0		mm		INCH		DATE		TITLE			
=0		4 PLACES ±		±		JRESENDE		08/06/16		SFP+ 1X2 CAGE ASSY	
		3 PLACES ±		±		CHECKED BY		DATE		W/ CUSTOM ELASTOMERIC	
		2 PLACES ±		0.15		JRESENDE		08/06/16		GASKET FRAME	
		1 PLACE ±		0.25		APPROVED BY		DATE		MOLEX INCORPORATED	
		ANGULAR ±		1/2°		KJANOTA		08/06/16			
		DRAFT WHERE APPLICABLE		MUST REMAIN WITHIN DIMENSIONS		MATERIAL NO.		DOCUMENT NO.		SHEET NO.	
						747540215		SD-74754-0215		4 OF 4	
						THIS DRAWING CONTAINS INFORMATION THAT IS PROPRIETARY TO MOLEX INCORPORATED AND SHOULD NOT BE USED WITHOUT WRITTEN PERMISSION					