

| ISS. | AMEND | DATE |
|------|----------------|----------|
| 1 | 1st DRAWN | 04/09/15 |
| 2 | ADD M3 VARIANT | 29/05/18 |

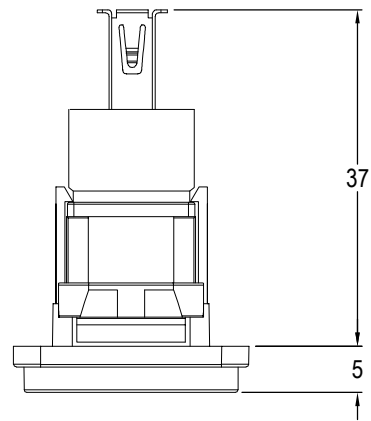
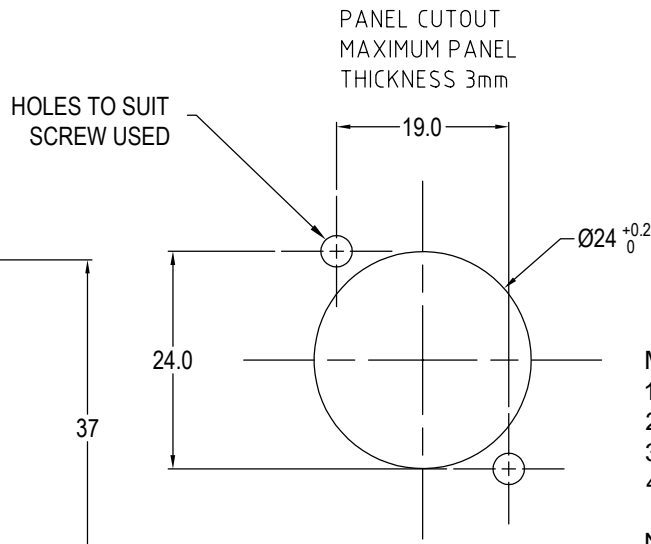
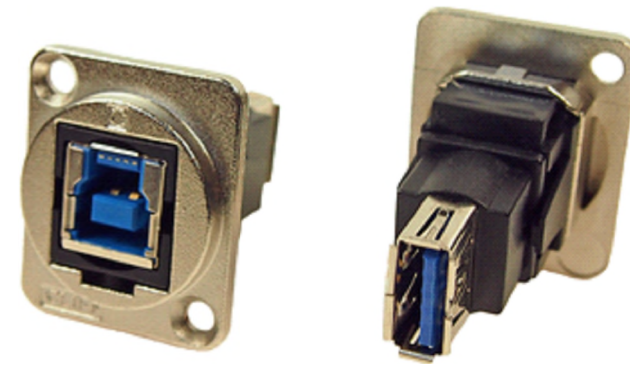

- Material:**
1. Insert: ABS
 2. Frame: Nickel plated zinc diecast
 3. Shell: Nickel plated steel
 4. Contacts: Gold Plated

- Notes:**
1. Voltage rating: 30V ac
 2. Current rating: 1.8 A max
 3. Contact resistance: 50mΩ max
 4. Insulation resistance: 20MΩ min
 5. Dielectric withstanding voltage: 500V AC
 6. Operating Temperature: -20°C to 50°C

| VARIANTS | |
|------------|------------------------------|
| PART No. | HOLE DETAILS |
| CP30206NM | HOLE Ø3.50 x CSK 82° x Ø5.85 |
| CP30206NM3 | M3 HOLES |

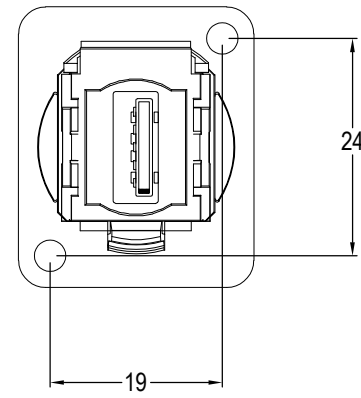
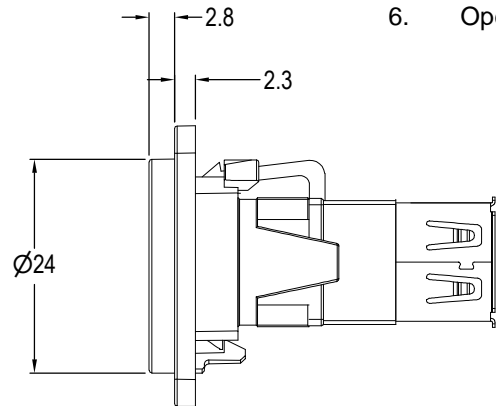
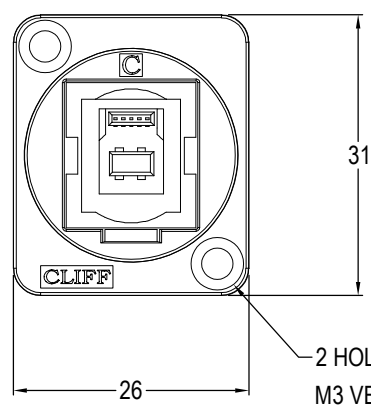

RoHS
COMPLIANT

TOLERANCE
 NO DEC. PLACE ±
 1 DEC. PLACE ±
 2 DEC. PLACE ±
 HOLE Ø ±
 ANGLES ±
 UNLESS OTHERWISE STATED

Cliff Electronic Components Ltd.
 76 Holmethorpe Avenue, Holmethorpe Industrial Estate,
 Redhill, Surrey, RH1 2PF, England, UK
 Tel: 01737-771375 Fax: 01737-766012 Website: www.cliffuk.co.uk

THE CONTENTS OF THIS DOCUMENT MUST NOT BE COPIED OR DISCLOSED TO A 3rd PARTY WITHOUT WRITTEN PERMISSION OF CLIFF UK. © 2015

DIMENSIONS IN MILLIMETERS UNLESS OTHERWISE STATED. WORK TO DIMENSIONS. REMOVE ALL BURRS. IF IN DOUBT ASK.

MATERIAL: See Notes

FINISH: See Notes

DRAWN: D.P.J. APPROVED: D.P.J.

3rd ANGLE PROJECTION:

TITLE: FT METAL USB 3.0 B to USB 3.0 A

DRWG. No. **CP30206NM** FORM: A4DRWGf

DO NOT SCALE