

PRODUCT NUMBER  
SEE TABLE

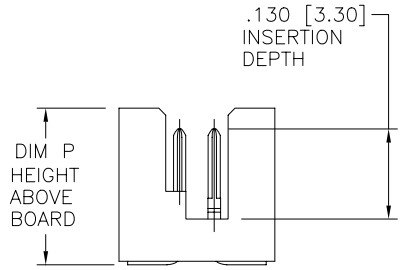
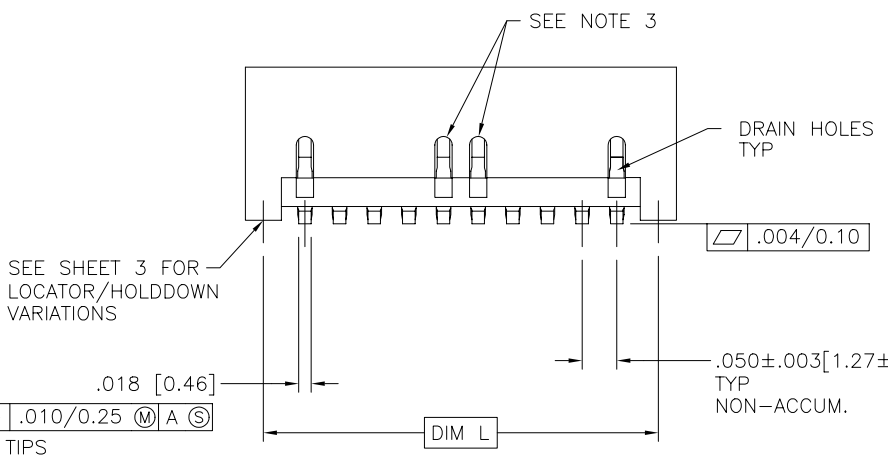
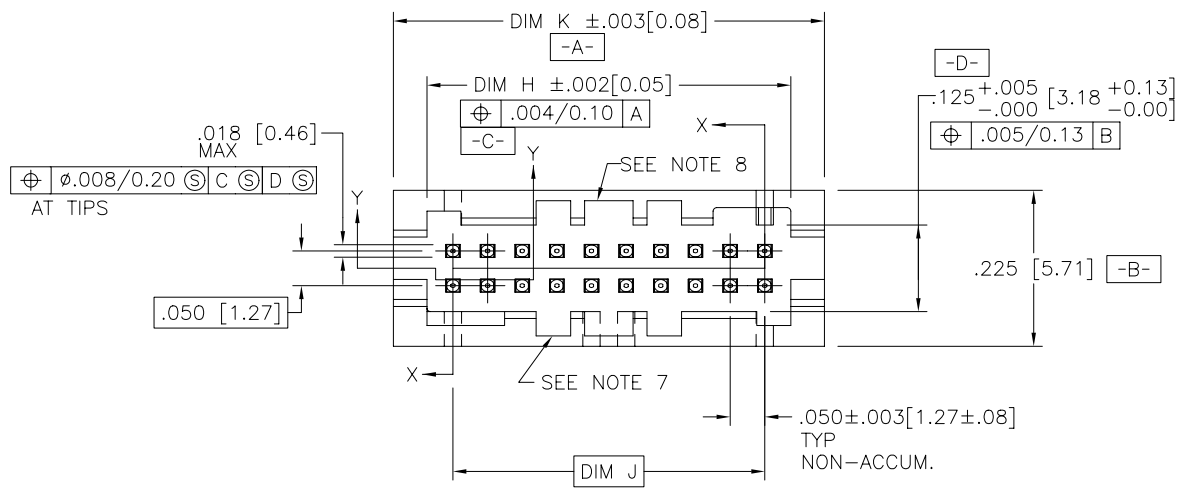

Copyright FCI

|             |          |  |         |                 |            |                                       |           |                               |  |
|-------------|----------|--|---------|-----------------|------------|---------------------------------------|-----------|-------------------------------|--|
| mat'l. code |          | surface                                      |         | tolerance       |            | projection                            |           | product family                |  |
| SEE NOTES   |          | ISO 1302 <input checked="" type="checkbox"/> |         | ISO 406         |            |                                       |           | RIB CAGE                      |  |
|             |          |  |         | ISO 1101        |            |                                       |           |                               |  |
| ltr         |          | ecn no                                       |         | date            |            | tolerances unless otherwise specified |           | title                         |  |
| S           | v02340   | DAI  | 9/20/00 | angles          | linear     | xx $\pm .01/.3$                       | INCH/MM   | RIB CAGE III SMT              |  |
| T           | v10994   | CRG  | 3/15/01 |                 |            | xxx $\pm .005/.13$                    |           | VERT. HEADER ASS'Y            |  |
| U           | v11295   | CRG  | 4/25/01 | $\sigma \pm 2'$ |            | xxxx $\pm .0020/.050$                 | scale 1:1 |                               |  |
| V           | j10329   | CRG  | 6/06/01 | dr              | M. CORNMAN | 6/07/95                               |           | dwg no                        |  |
| W           | v04-0004 | DAI  | 1/21/04 | enfr            | D. WHITING | 6/07/95                               |           | sheet 1 of 6 size             |  |
| X           | M05-084  | MHT  | 5/05/05 | chr             | D. WHITING | 6/07/95                               |           | 95781 A3                      |  |
| Y           | M06-0284 | AEA  | 7/27/06 | appd            | D. WHITING | 6/07/95                               |           | type Product Customer Drawing |  |
| sheet index | revision | Y  | Y       | Y               | Y          | Y                                     | Y         |                               |  |
|             | sheet    | 1  | 2       | 3               | 4          | 5                                     | 6         |                               |  |

form: A3

PRODUCT NUMBER  
SEE TABLE

| SIZE | DIM H       | DIM J       | DIM K       | DIM L       |
|------|-------------|-------------|-------------|-------------|
| 2X5  | .275/6.99   | .200/5.08   | .372/9.45   | .320/8.13   |
| 2X10 | .525/13.34  | .450/11.43  | .622/15.80  | .570/14.48  |
| 2X15 | .775/19.68  | .700/17.78  | .872/22.15  | .820/20.83  |
| 2X20 | 1.025/26.03 | .950/24.13  | 1.122/28.50 | 1.070/27.18 |
| 2X25 | 1.275/32.38 | 1.200/30.48 | 1.372/34.85 | 1.320/33.53 |
| 2X30 | 1.525/38.74 | 1.450/36.83 | 1.622/41.20 | 1.570/39.88 |
| 2X35 | 1.775/45.08 | 1.700/43.18 | 1.872/47.55 | 1.820/46.23 |
| 2X40 | 2.025/51.43 | 1.950/49.53 | 2.122/53.90 | 2.070/52.58 |
| 2X45 | 2.275/57.78 | 2.200/55.88 | 2.372/60.25 | 2.320/58.93 |
| 2X50 | 2.525/64.14 | 2.450/62.23 | 2.622/66.60 | 2.570/65.28 |

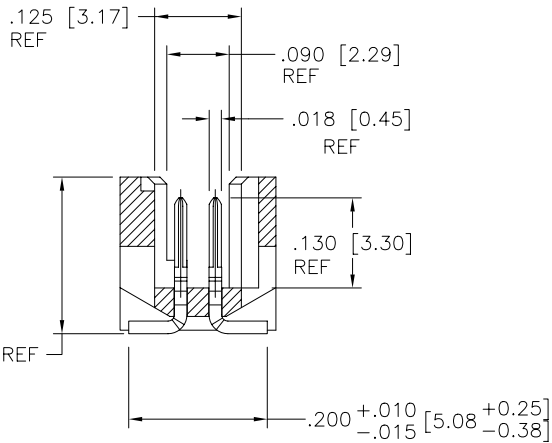

⊕ .010/.25 ⊗ B

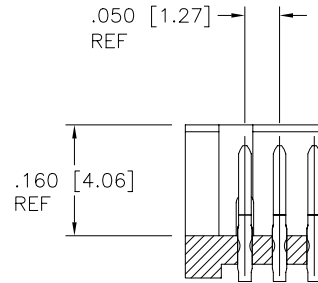

|                          |                |                       |      |                                       |            |                 |                   |                            |                          |
|--------------------------|----------------|-----------------------|------|---------------------------------------|------------|-----------------|-------------------|----------------------------|--------------------------|
| mat'l. code<br>SEE NOTES |                | surface<br>ISO 1302 ✓ |      | tolerance<br>ISO 406<br>ISO 1101      |            | projection<br>⊕ |                   | product family<br>RIB CAGE |                          |
| ltr                      | ecn no         | dr                    | date | tolerances unless otherwise specified |            |                 |                   | title                      |                          |
| Y                        |                |                       |      | angles                                | linear     | xx ±.01/.3      | INCH/MM           |                            | RIB CAGE III SMT         |
|                          |                |                       |      | σ±2'                                  |            | xxx ±.005/.13   | scale 1:1         |                            | VERT. HEADER ASS'Y       |
|                          |                |                       |      | dr                                    | M. CORNMAN | 6/07/95         | FCJ               |                            | dwg no                   |
|                          |                |                       |      | enfr                                  | D. WHITING | 6/07/95         | sheet 2 of 6 size |                            | 95781 A3                 |
|                          |                |                       |      | chr                                   | D. WHITING | 6/07/95         | type              |                            | Product Customer Drawing |
|                          |                |                       |      | appd                                  | D. WHITING | 6/07/95         |                   |                            |                          |
| sheet index              | revision sheet |                       |      |                                       |            |                 |                   |                            |                          |

FCJ  
FCIconnect.com  
Copyright FCI

PRODUCT NUMBER  
SEE TABLE

# LOCATOR/HOLDDOWN VARIATIONS

STYLE  
1

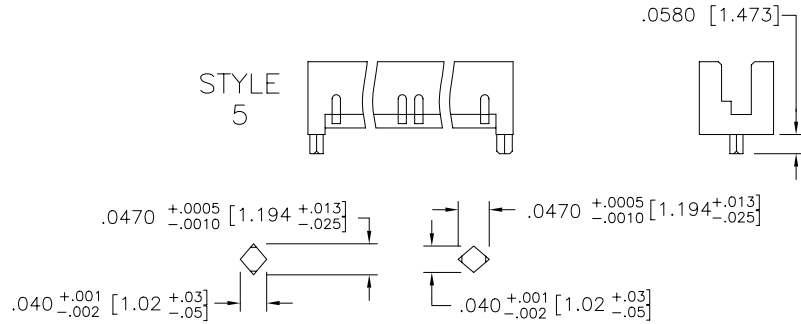

STYLE  
2

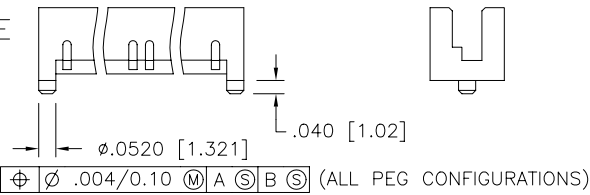

STYLE  
6  
SEE NOTE 9

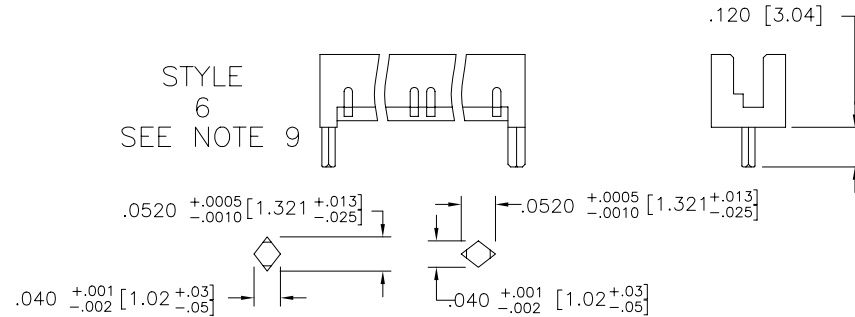

STYLE  
3

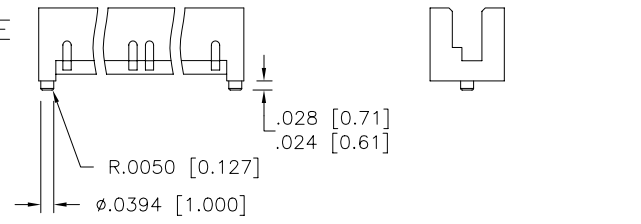

STYLE  
7

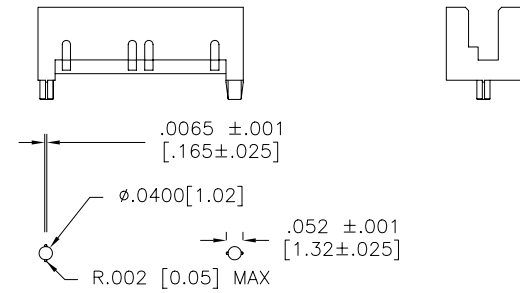

STYLE  
4

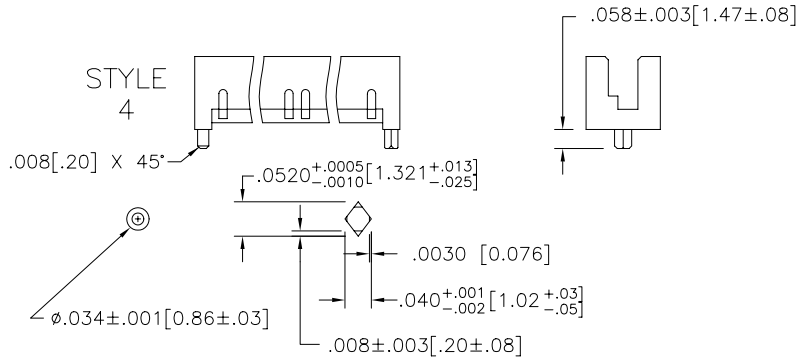

|                          |                |  |                                  |   |  |
|--------------------------|----------------|--|----------------------------------|---|--|
| mat'l. code<br>SEE NOTES |                | surface<br>ISO 1302 ✓<br>ISO 406<br>ISO 1101 | tolerance<br>ISO 406<br>ISO 1101 | projection<br>INCH/MM                           | product family<br>RIB CAGE             |
| ltr                      | ecn            | no   | dr                               | date  | title                                  |
| Y                        |                |  |                                  |   | RIB CAGE III SMT<br>VERT. HEADER ASS'Y |
|                          |                | angles                                       | linear                           | xx ±.01/.3<br>xxx ±.005/.13<br>xxxx ±.0020/.050 | scale 1:1                              |
|                          |                | dr   | M. CORNMAN                       | 6/07/95   | dwg no                                 |
|                          |                | enr  | D. WHITING                       | 6/07/95   | sheet 3 of 6 size                      |
|                          |                | chr  | D. WHITING                       | 6/07/95   | 95781 A3                               |
|                          |                | appd   | D. WHITING                       | 6/07/95   | type Product Customer Drawing          |
| sheet index              | revision sheet |  |                                  |   |  |

PRODUCT NUMBER  
SEE TABLE

# RECOMMENDED PCB MOUNTING PAD PATTERN

STYLE  
1

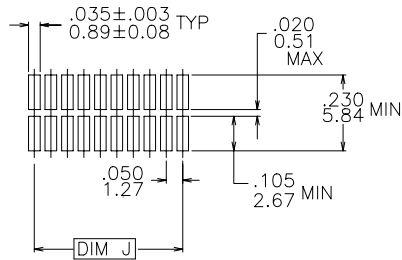

STYLE  
5

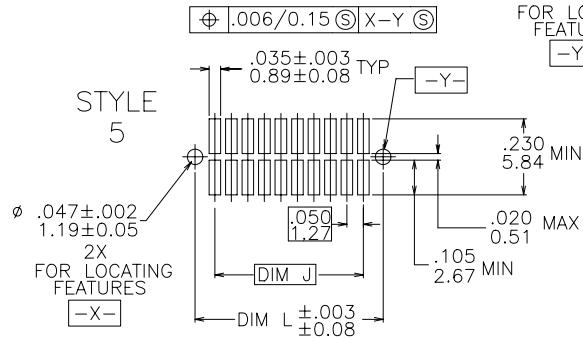

STYLE  
4

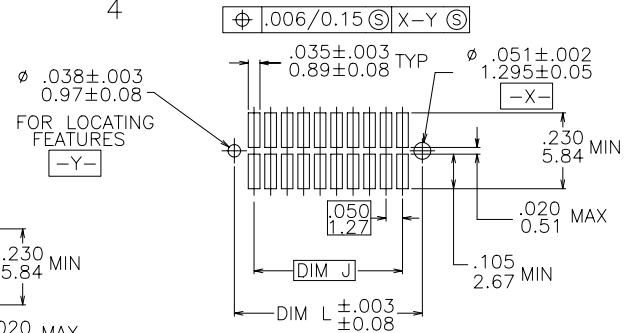

STYLE  
6

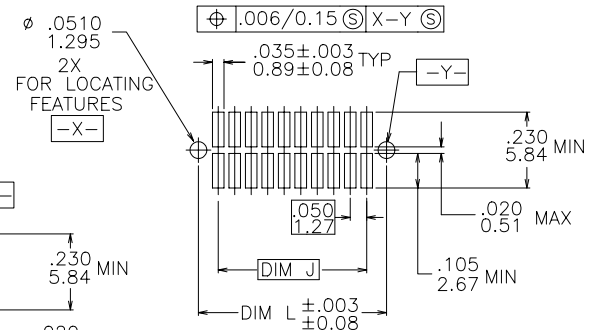

STYLE  
2

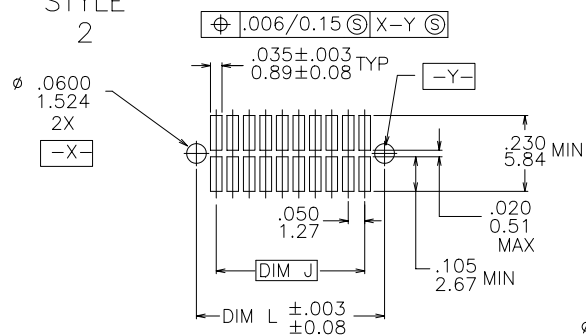

STYLE  
7

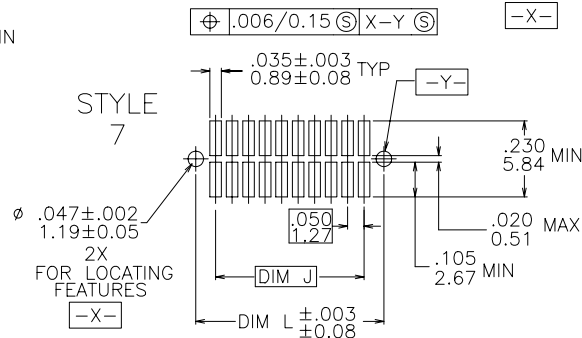

STYLE  
3

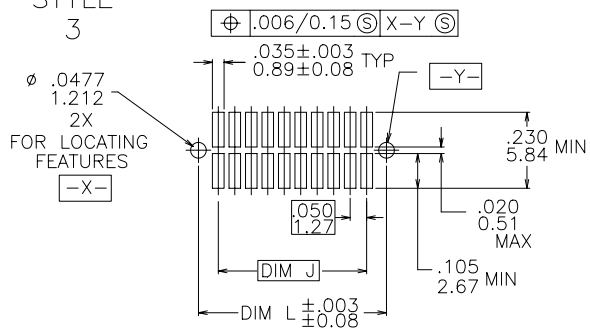

|                                       |     |                       |                                  |                  |                            |
|---------------------------------------|-----|-----------------------|----------------------------------|------------------|----------------------------|
| mat'l. code<br>SEE NOTES              |     | surface<br>ISO 1302 ✓ | tolerance<br>ISO 406<br>ISO 1101 | projection<br>⊕  | product family<br>RIB CAGE |
| ltr                                   | ecn | no                    | dr                               | date             | title                      |
| tolerances unless otherwise specified |     |                       |                                  |                  | INCH/MM                    |
| Y                                     |     |                       |                                  |                  |                            |
|                                       |     | angles                | linear                           | xx ±.01/.3       | RIB CAGE III SMT           |
|                                       |     |                       |                                  | xxx ±.005/.13    | VERT. HEADER ASS'Y         |
|                                       |     | σ±2'                  |                                  | xxxx ±.0020/.050 | scale 1:1                  |
|                                       |     | dr                    | M. CORNMAN                       | 6/07/95          | dwg no                     |
|                                       |     | enrg                  | D. WHITING                       | 6/07/95          | sheet 4 of 6               |
|                                       |     | chr                   | D. WHITING                       | 6/07/95          | size                       |
|                                       |     | appd                  | D. WHITING                       | 6/07/95          | A3                         |
| sheet index                           |     | revision              |                                  |                  | type                       |
|                                       |     | sheet                 |                                  |                  | Product Customer Drawing   |



Copyright FCI

| PRODUCT NUMBER<br>NOTE 1,4A & 4B | DIM P<br>HEIGHT ABOVE<br>BOARD (REF.) | HOLDDOWN<br>STYLE |
|----------------------------------|---------------------------------------|-------------------|
| 72428-1XX                        | .244/6.20                             | 1                 |
| 73546-1XX                        | .364/9.25                             | 1                 |
| 73547-1XX                        | .364/9.25                             | 2                 |
| 73548-1XX                        | .364/9.25                             | 4                 |
| 84700-1XX                        | .226/5.74                             | 7                 |
| 84701-1XX                        | .298/7.57                             | 7                 |
| 84734-1XX                        | .364/9.25                             | 7                 |
| 87401-1XX                        | .226/5.74                             | 6                 |
| 87409-1XX                        | .226/5.74                             | 2                 |
| 87849-1XX                        | .226/5.74                             | 1                 |
| 88566-1XX                        | .260/6.60                             | 2                 |
| 90098-1XX                        | .298/7.57                             | 2                 |
| 90863-1XX                        | .226/5.74                             | 1                 |
| 91036-1XX                        | .364/9.25                             | 5                 |
| 91423-1XX                        | .226/5.74                             | 2                 |
| 91855-1XX                        | .226/5.74                             | 5                 |
| 92099-1XX                        | .226/5.74                             | 4                 |
| 92412-1XX                        | .298/7.57                             | 4                 |
| 93206-1XX                        | .226/5.74                             | 3                 |
| 93221-1XX                        | .298/7.57                             | 1                 |
| 93289-1XX                        | .298/7.57                             | 5                 |

TABLE A

\* CUSTOMER SPECIAL

SEE NOTE 10

\*

NOTES:

- ① XXXX-XXXLF  
  - └─ LEAD FREE OPTION (NOTE 11& 13)
  - └─ NUMBER OF POSITIONS (NOTE 2)
- ② NUMBER OF POSITIONS = 05 THRU 50 IN 5 POS INCREMENTS.  
(EXAMPLE : 105=10 POS., 110=20 POS. ETC.)
- ③ REQUIRED ON -X40,-X45 & -X50 POSITION PARTS ONLY.
4. PACKAGING :  
 A. ANTISTATIC TUBES. SEE TABLE A  
 B. ADD "CT" TO END OF DASH NUMBER FOR CONNECTOR WITH VACUUM CAP IN ANTISTATIC TUBES.  
 EX. : XXXXX-1XXCT  
 C. PRESSURE SEALED TAPE AND REEL. SEE TABLE C FOR AVAILABLE PART NUMBERS.
- ⑤ HOUSING MATERIAL :  
GLASS FILLED THERMOPLASTIC FLAME RETARDANT PER UL 94V-0.  
COLOR : BLACK
- ⑥ TERMINAL PLATING :  
 30u"/.76u HARD Au OVER 50u"/1.27u NI ON CONTACT ZONES.  
 100u"/2.54u TIN LEAD OVER 50u"/1.27u Ni IN SOLDERING ZONES.  
LEAD FREE OPTION:  
 30u"/.76u HARD Au OVER 50u"/1.27u NI ON CONTACT ZONES.  
 100u"/2.54u PURE TIN OVER 50u"/1.27u Ni IN SOLDERING ZONES.
- ⑦ MOLDING FLOW RESTRICTOR QUANTITY AND LOCATION IS MANUFACTURING OPTION.
- ⑧ VACUUM CAP SLOT REQUIRED ON ALL SIZES, SLOT MAY BE LOCATED ON OPPOSITE SIDE FOR 2 X 5.
- ⑨ STYLE 6 IS NOT AVAILABLE IN TAPE AND REEL.
- ⑩ 90863-1XX IS PACKAGED ONLY IN TAPE AND REEL.
- ⑪ ADD LF SUFFIX AT THE END OF PART NUMBER FOR LEAD FREE OPTION.
12. THE HOUSING WILL WITHSTAND EXPOSURE TO 260°C PEAK TEMPERATURE FOR 20 SECONDS IN A CONVECTION, INFRA-RED OR VAPOR PHASE REFLOW OVEN. SEE APPLICATION NOTE/PROCEDURES IF THEY ARE AVAILABLE.
- ⑬ THIS PRODUCT MEETS EUROPEAN UNION DIRECTIVES AND OTHER COUNTRY REGULATION AS DESCRIBED IN GS-22-008.



FCIconnect.com

Copyright FCI

|                          |                |                       |  |                 |  |
|--------------------------|----------------|-----------------------|--|-----------------|--|
| mat'l. code<br>SEE NOTES |                | surface<br>ISO 1302 ✓ | tolerance<br>ISO 406<br>ISO 1101                                 | projection<br>⊕ | product family<br>RIB CAGE             |
| ltr                      | ecn no/dr      | date                  | tolerances unless otherwise specified                            | INCH/MM         | title                                  |
| Y                        |                |                       | angles linear<br>xx ±.01/.3<br>xxx ±.005/.13<br>xxxx ±.0020/.050 | scale 1:1       | RIB CAGE III SMT<br>VERT. HEADER ASS'Y |
|                          |                | dr                    | M. CORNMAN   | 6/07/95         | dwg no                                 |
|                          |                | enr                   | D. WHITING   | 6/07/95         | 95781                                  |
|                          |                | chr                   | D. WHITING   | 6/07/95         | sheet 5 of 6 size<br>A3                |
|                          |                | appd                  | D. WHITING   | 6/07/95         | type Product Customer Drawing          |
| sheet index              | revision sheet |                       |  |                 |  |

| PRODUCT NUMBER | QTY. REEL | TAPE WIDTH PITCH MM | CONNECTOR ORIENTATION IN TAPE POCKET |
|----------------|-----------|---------------------|--------------------------------------|
| NOTE 11,4C     |           |                     |                                      |
| 72428-120TR    | 500       | 44/12               | VIEW 1                               |
| 73547-110TR    | ↑         | 24/12               | ↑                                    |
| 84700-105TR    |           | 24/12               |                                      |
| 84700-135TR    |           | 56/12               |                                      |
| 87409-115TR    |           | 44/12               |                                      |
| 87409-120TR    |           | 44/12               |                                      |
| 87409-125TR    |           | 56/12               |                                      |
| 87409-130TR    |           | 56/12               |                                      |
| 87409-140TR    |           | 72/12               |                                      |
| 87849-110TR    |           | 24/12               |                                      |
| 87849-115TR    |           | 44/12               |                                      |
| 87849-120TR    |           | 44/12               |                                      |
| 87849-125TR    |           | 56/12               |                                      |
| 87849-130TR    | 500       | 56/12               |                                      |
| 88566-110TR    | 750       | 24/12               |                                      |
| 88566-115TR    | 500       | 44/12               |                                      |
| 88566-130TR    | 500       | 56/12               |                                      |
| 90863-110      | ↑         | 24/12               | ↓                                    |
| 90863-115      |           | 44/12               | VIEW 1                               |
| 90863-115REV   |           | 44/12               | VIEW 2 *                             |
| 90863-120      |           | 44/12               | VIEW 1                               |
| 90863-125      |           | 56/12               | ↑                                    |
| 90863-130      |           | 56/12               |                                      |
| 91036-110P     |           | 24/16               |                                      |
| 93206-115TR    |           | 44/12               |                                      |
| 93221-105TR    |           | 24/12               |                                      |
| 93221-110TR    |           | 32/12               |                                      |
| 93221-125TR    | 500       | 56/12               | VIEW 1                               |

TABLE C

\* CUSTOMER SPECIAL  
NO VACUUM CAP

REFERENCE ONLY :

TAPE WIDTH 32mm AND ABOVE HAS BOTH FEED TRACKS,  
BELOW 32mm HAS TOP FEED TRACK ONLY.

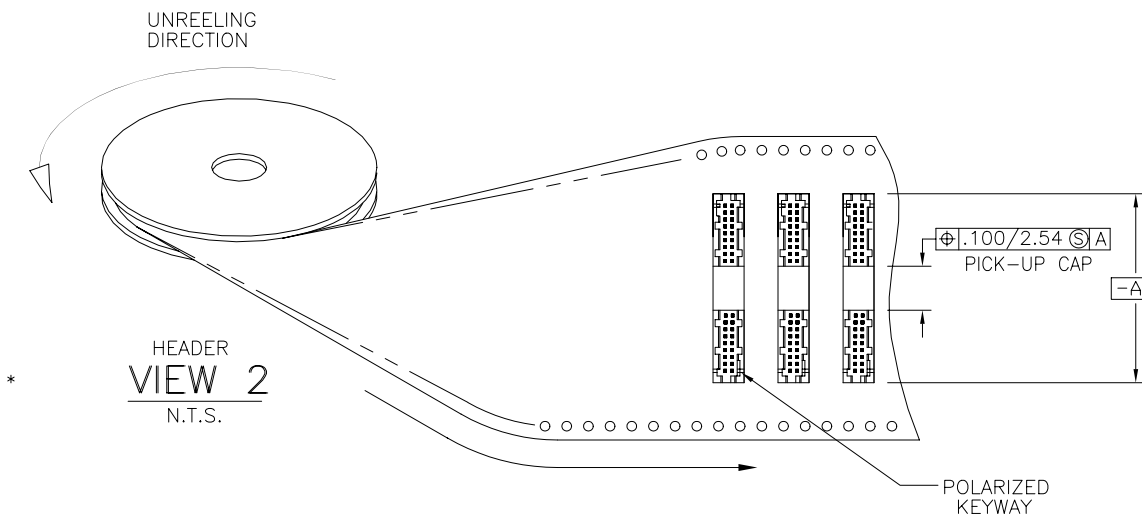
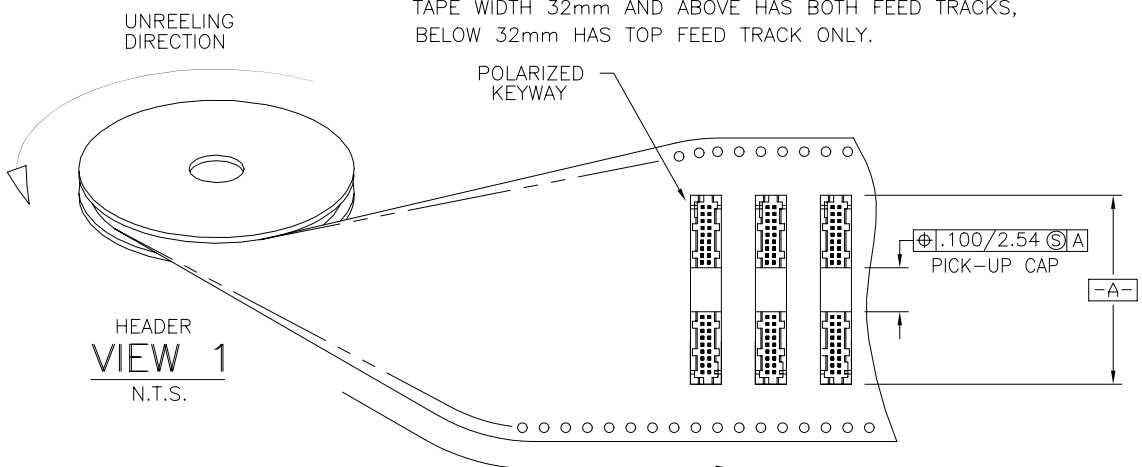

|                          |                |                       |                                  |                 |  |
|--------------------------|----------------|-----------------------|----------------------------------|-----------------|--|
| mat'l. code<br>SEE NOTES |                | surface<br>ISO 1302 ✓ | tolerance<br>ISO 406<br>ISO 1101 | projection<br>⊕ | product family<br>RIB CAGE             |
| ltr                      | ecn            | no                    | dr                               | date            | title                                  |
| Y                        |                |                       |                                  |                 | RIB CAGE III SMT<br>VERT. HEADER ASS'Y |
| angles                   |                | linear                | xx ±.01/.3                       | INCH/MM         | dwg no                                 |
| σ±2'                     |                | xxxx ±.005/.13        | xxxx ±.0020/.050                 | scale 1:1       | sheet 6 of 6 size                      |
| dr                       | M. CORNMAN     | 6/07/95               |                                  | <b>FCJ</b>      | A3                                     |
| enr                      | D. WHITING     | 6/07/95               |                                  |                 | 95781                                  |
| chr                      | D. WHITING     | 6/07/95               |                                  |                 |  |
| appd                     | D. WHITING     | 6/07/95               |                                  |                 |  |
| sheet index              | revision sheet |                       |                                  |                 | type Product Customer Drawing          |