

SK6177

THIS DRAWING CONTAINS INFORMATION PROPRIETARY TO POSITRONIC AND ITS SUBSIDIARIES. POSITRONIC BELIEVES THE DATA ON THIS DRAWING TO BE RELIABLE. SINCE THE TECHNICAL INFORMATION IS GIVEN FREE OF CHARGE, THE USER EMPLOYS SUCH INFORMATION AT HIS OWN DISCRETION AND RISK. POSITRONIC ASSUMES NO RESPONSIBILITY FOR RESULTS OBTAINED OR DAMAGES INCURRED FROM USE OF SUCH INFORMATION IN WHOLE OR IN PART.

DATE	REV	REVISION RECORD	APP	DR	CK
4-20-05	NC	ECO 23980		ME	

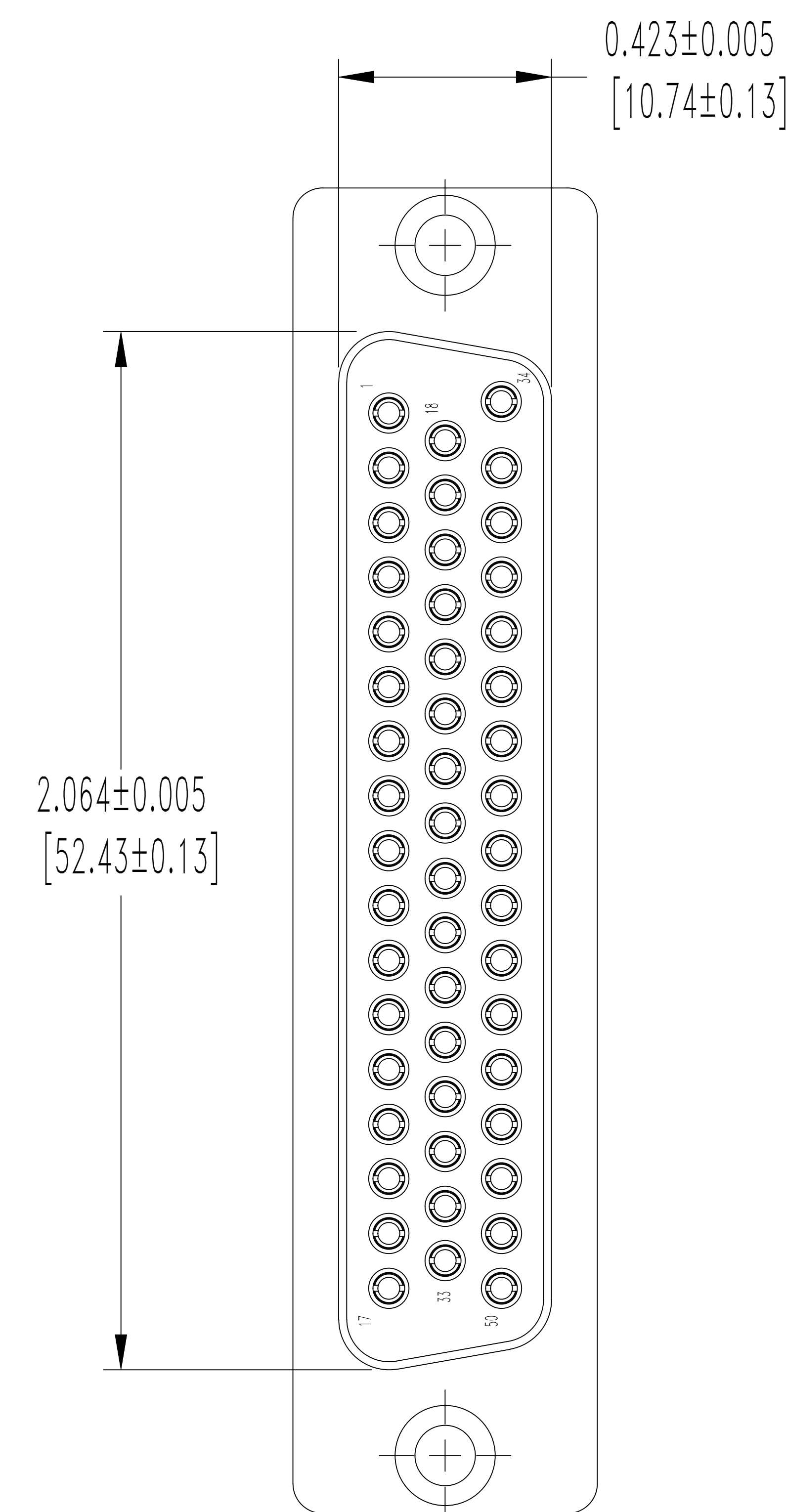
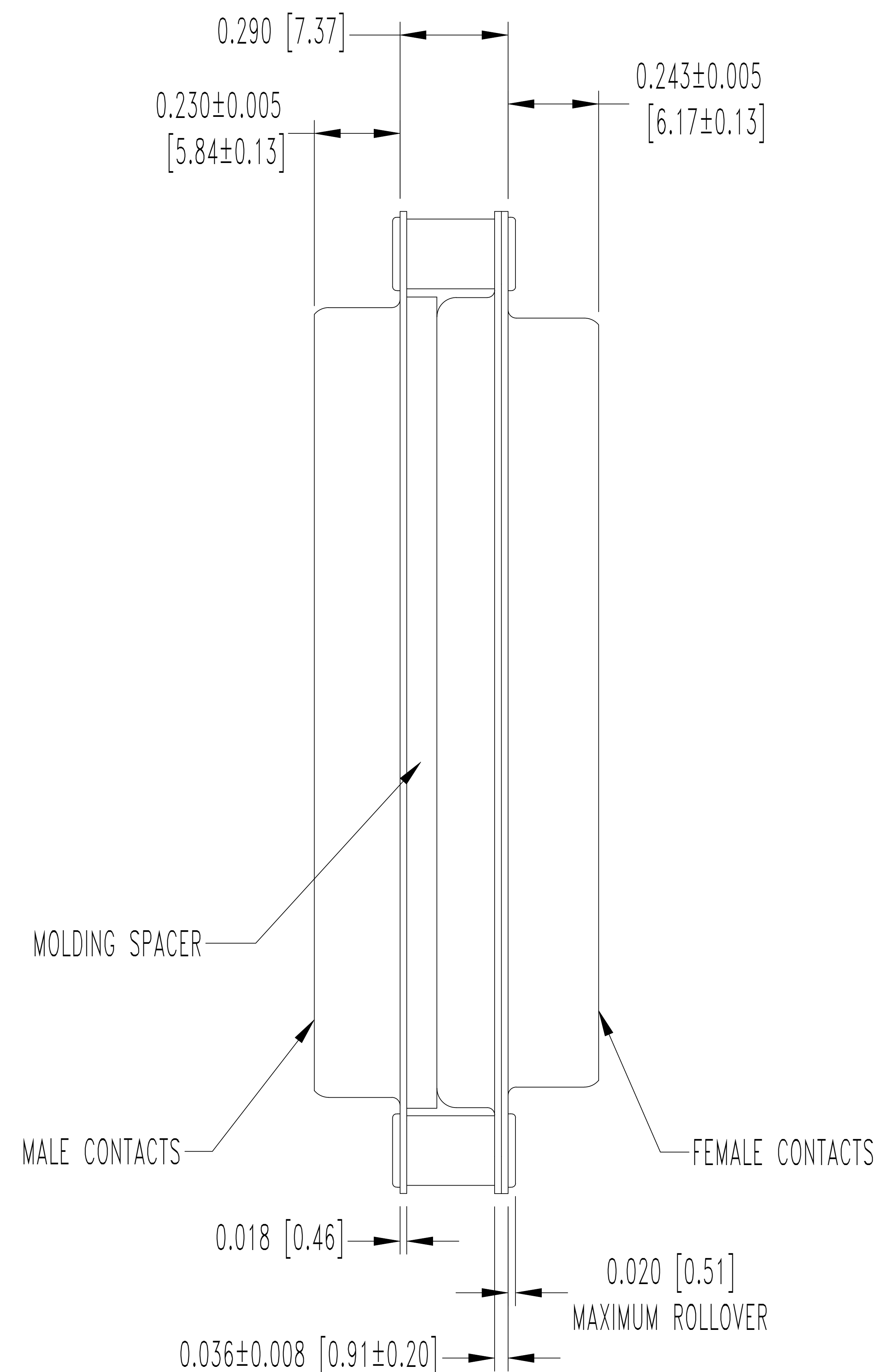
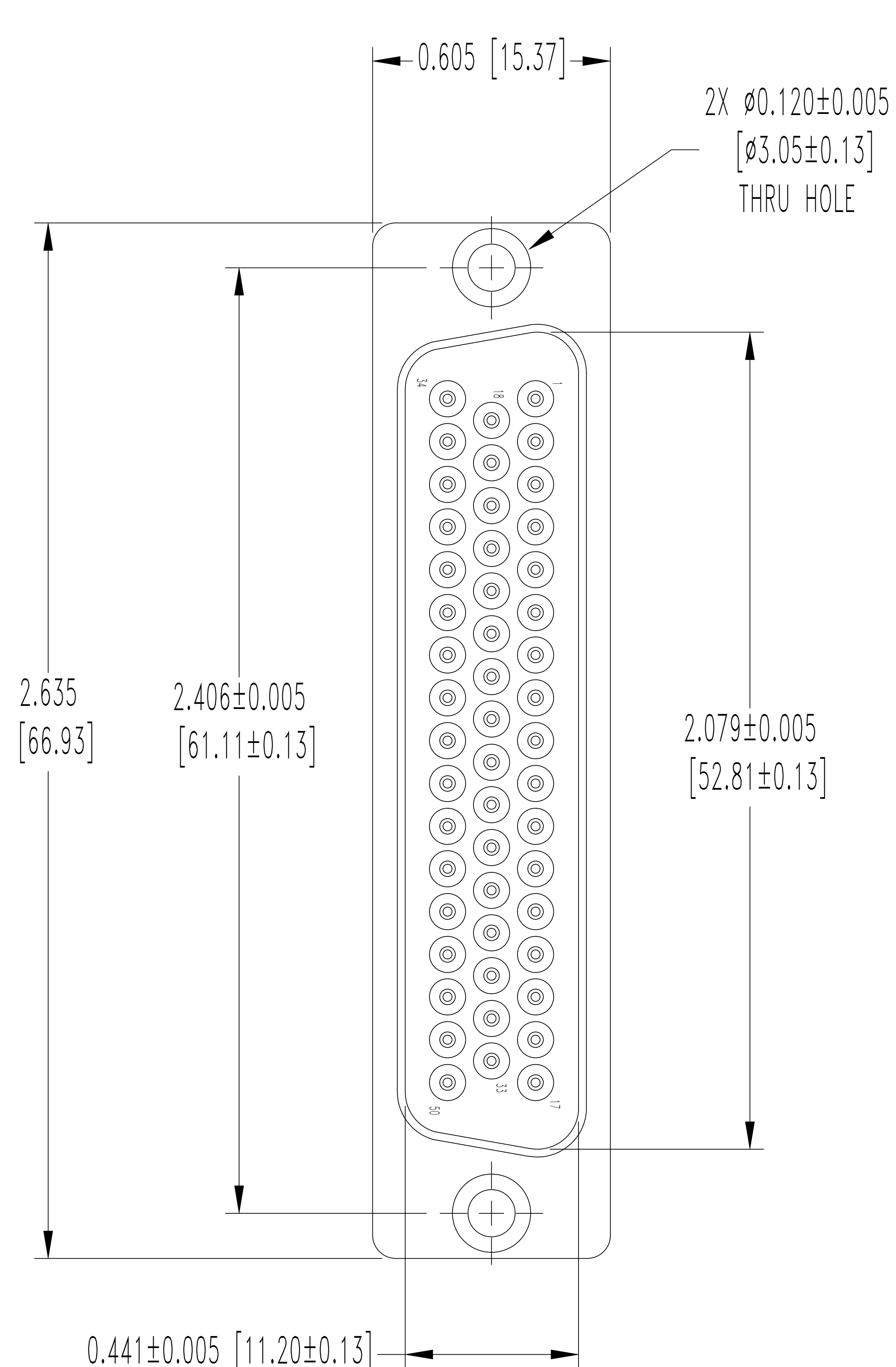

## NOTES:

## 1. MATERIALS AND FINISHES:

INSULATOR: DAP PER ASTM-D-5948, UL 94V-0, ASTM E-595, NASA-RP-1124.

CONTACTS: PRECISION MACHINED HIGH TENSILE COPPER ALLOY WITH BRASS SHROUDS, 0.000050 [1.25μ] GOLD OVER COPPER PLATE.

SHELLS: BRASS WITH 0.000050 [1.25μ] GOLD OVER COPPER PLATE.

MOLDING SPACER: GLASS FILLED POLYESTER, COLOR BLUE.

## 2. ELECTRICAL CHARACTERISTICS:

CONTACT CURRENT RATING: 7.5 AMPERES, NOMINAL.

INITIAL CONTACT RESISTANCE: 0.008 OHMS, MAXIMUM.

INSULATOR RESISTANCE: 5 G ohms.

WORKING VOLTAGE: 300 V r.m.s.

## 3. WORKING TEMPERATURE: -55°C TO +125°C.

## 4. DIMENSIONS ARE IN INCHES [MILLIMETERS].

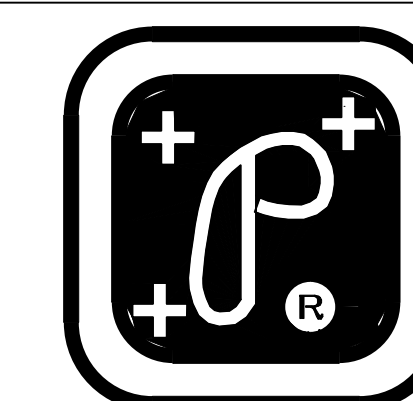

POSITRONIC  
INDUSTRIES INC.

SPRINGFIELD, MISSOURI 65801

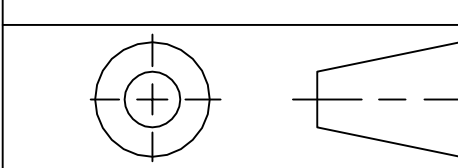
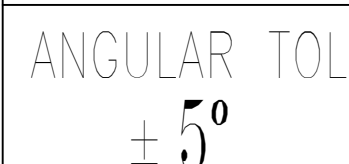
DECIMAL TOL.  
± 0.015 [0.38]ANGULAR TOL.  
± 5°

SAD SERIES

SCALE  
N.T.S.DRAWN BY  
M. ENEA

APPROVED BY

TITLE

SAD50M/F

DATE  
4-20-05DRAWING NUMBER  
SK6177REV.  
NC