

45 DEGREE CABLE EXIT

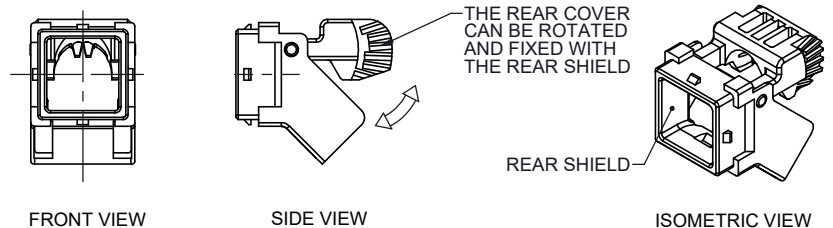
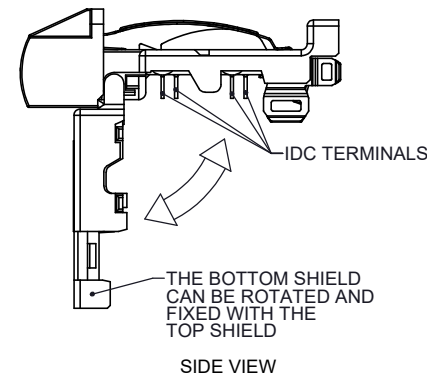
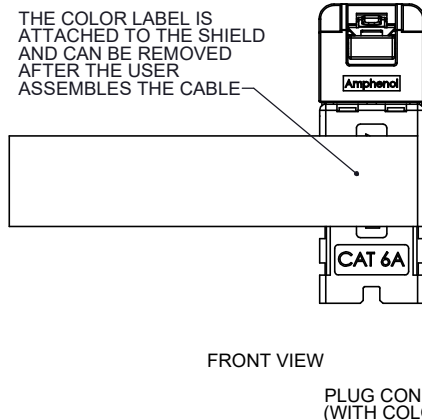
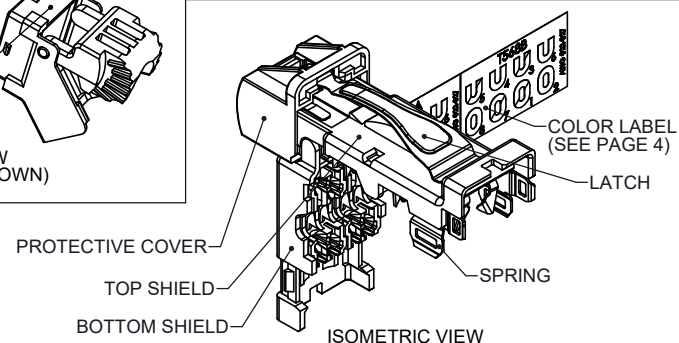
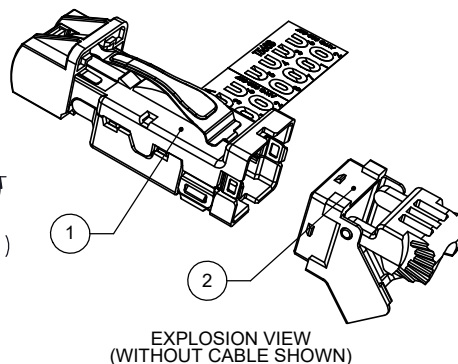
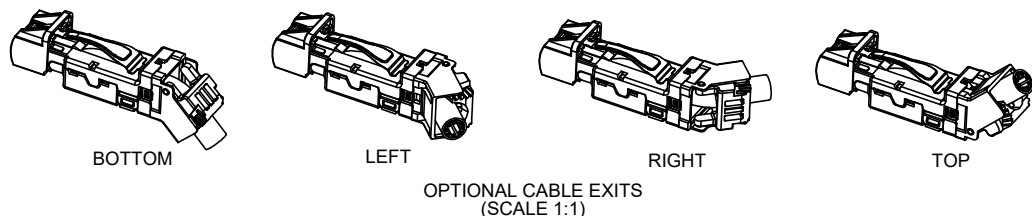
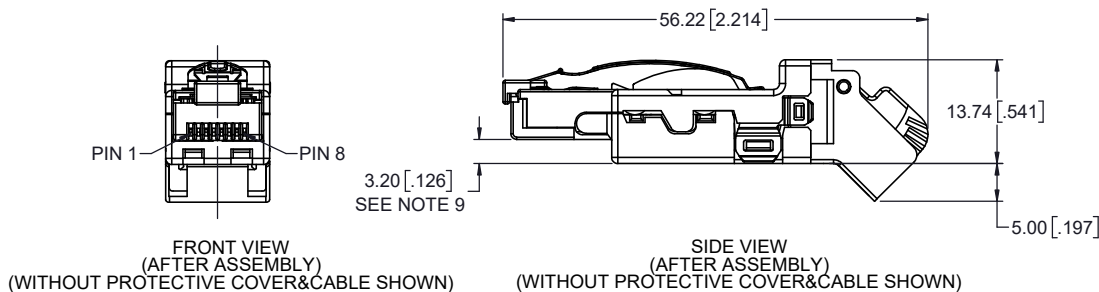
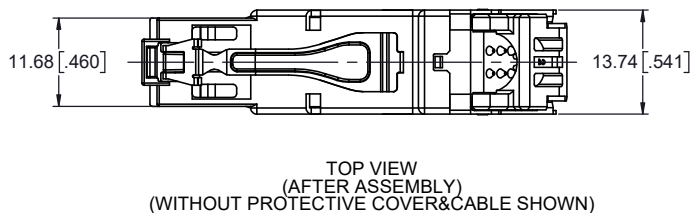
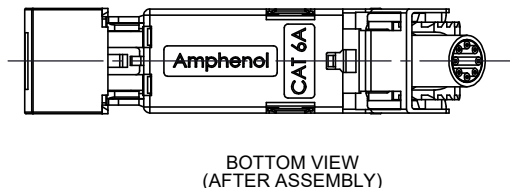
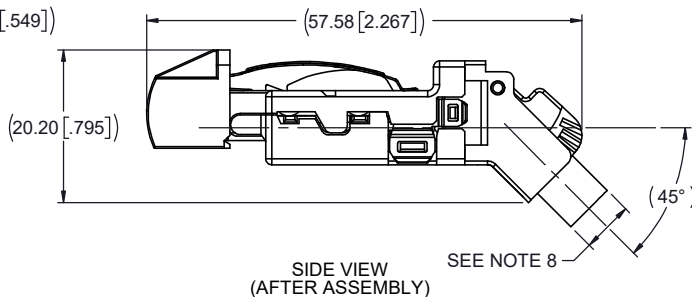
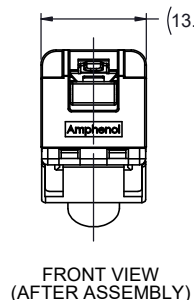

REAR SHIELD SUB ASSEMBLY

UNLESS SPECIFIED OTHERWISE	DRAWN	RONNIE.C	JUN17/20
PRIMARY UNITS MILLIMETERS	CHECKED	KELVIN.T	JUN17/20
SECONDARY UNITS INCHES	M.E. APP'D		
REFERENCE IN PARENTHESES	O.A. APP'D		
GENERAL TOLERANCES	DWG APPR.	A.GREEN	JUN22/20
1 DECIMAL PLACE	ENG. REL. NO.		
2 DECIMAL PLACES	REF.		
3 DECIMAL PLACES	THIRD ANGLE PROJECTION		
ANGULAR DEGREES	DO NOT SCALE DRAWING		

Amphenol Canada Corp.			
Commercial Products			
INDUSTRIAL CATEGORY 6A RJ45 FIELD TERMINABLE PLUG, ZINC ALLOY SHELL, PLASTIC HOUSING, PROTECTIVE COVER, WIRE SIZE, CABLE EXIT AND GOLD PLATING OPTIONS -RoHS COMPLIANT			
DWG. NO.	P-DRP10-188-XXXXXX		
CODE ID NO.	03554	DWG SIZE: X	SCALE: 2:1
SHEET	1	OF 5	REV E

THIS DOCUMENT CONTAINS PROPRIETARY INFORMATION AND SUCH INFORMATION MAY NOT BE DISCLOSED TO OTHERS FOR ANY PURPOSE OR USED FOR MANUFACTURING PURPOSES WITHOUT WRITTEN PERMISSION FROM AMPHENOL CANADA CORP.

90 DEGREE CABLE EXIT

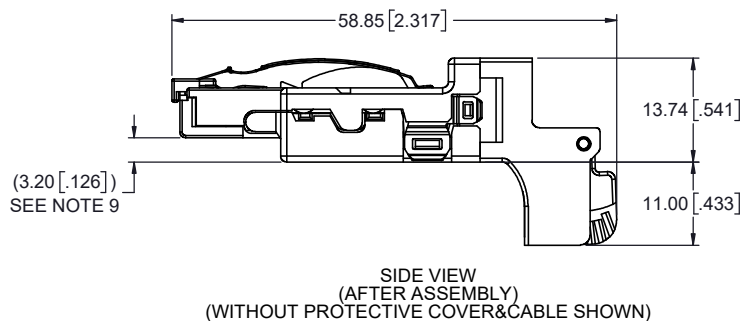
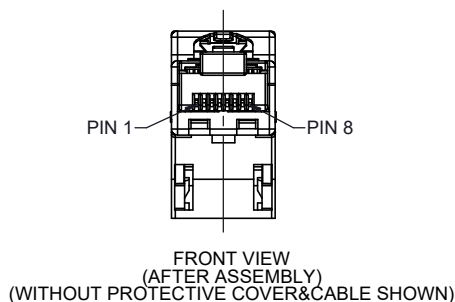
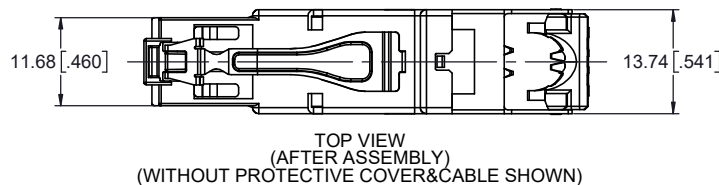
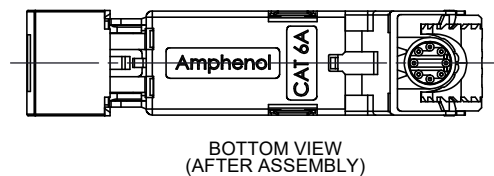
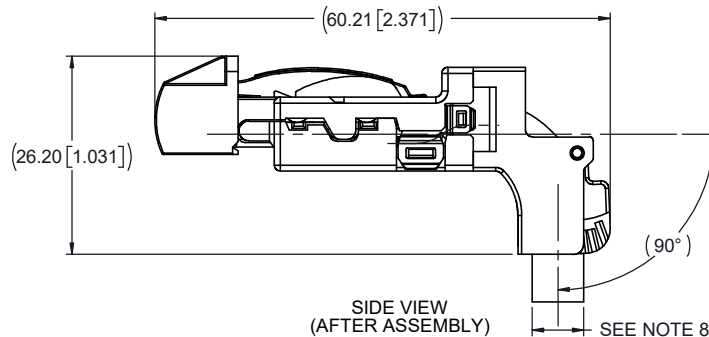
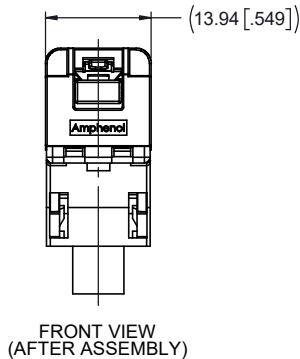

REVISIONS			
REV	DESCRIPTION, ECN, EAR NO.	DATE	APP'D
A	PROPOSAL DRAWING	JUN17/20	L.CHAN
B	REDUCE THE OUTSIDE SIZE	AUG07/20	L.CHAN
C	REDESIGN FOR A SHORTER VERSION AND ADD PACKAGE INFORMATION	OCT19/20	L.CHAN
D	UPDATE THE DRAWING	AUG20/21	L.CHAN
E	UPDATE THE COLOR LABEL	MAY12/22	KELVIN

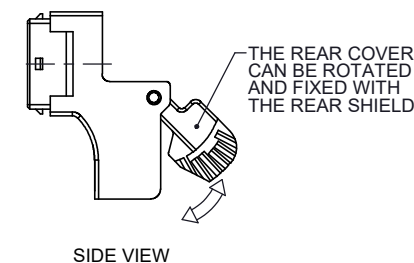
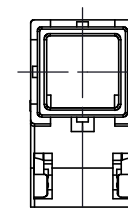
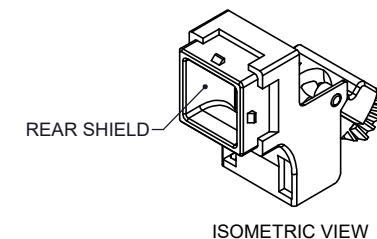
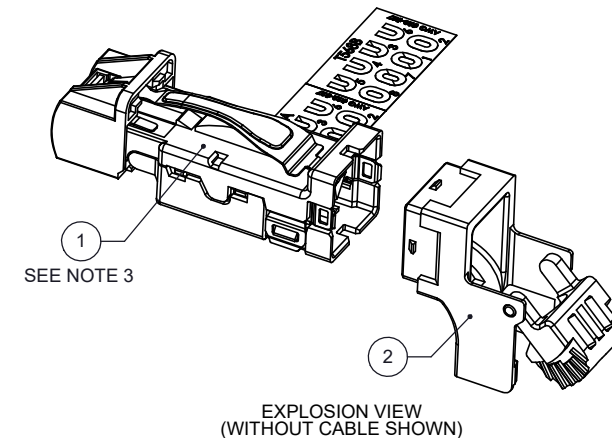

REAR SHIELD SUB ASSEMBLY

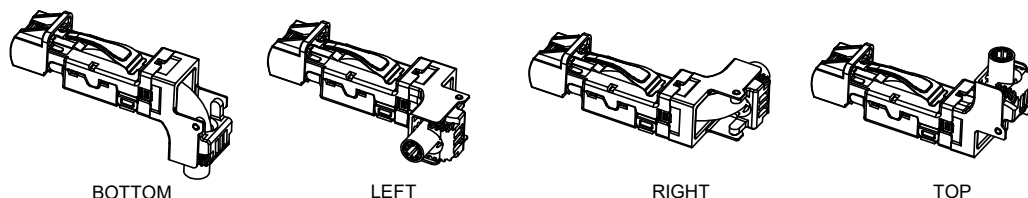

UNLESS SPECIFIED OTHERWISE		DRAWN	RONNIE.C	JUN17/20
PRIMARY UNITS MILLIMETERS		CHECKED	KELVIN.T	JUN17/20
SECONDARY UNITS INCHES		M.E. APP'D		
REFERENCE IN PARENTHESES		Q.A. APP'D		
GENERAL TOLERANCES		DWG APPR.	A.GREEN	JUN22/20
1 DECIMAL PLACE	±0.50	ENG. REL. NO.		
2 DECIMAL PLACES	±0.38	REF.		
3 DECIMAL PLACES	±0.25	THIRD ANGLE PROJECTION		
ANGULAR DEGREES	±1.5°	DO NOT SCALE DRAWING		

Amphenol Canada Corp.				
Commercial Products				
INDUSTRIAL CATEGORY 6A RJ45 FIELD TERMINABLE PLUG, ZINC ALLOY SHELL, PLASTIC HOUSING, PROTECTIVE COVER, WIRE SIZE, CABLE EXIT AND GOLD PLATING OPTIONS -RoHS COMPLIANT				
DWG. NO.		P-DRP10-188-XXXXXX		REV
CODE ID NO.	03554	DWG SIZE:	X	SCALE: 2:1
SHEET		2 OF 5		

STRAIGHT CABLE EXIT

REVISIONS			
REV	DESCRIPTION, ECN, EAR NO.	DATE	APP'D
A	PROPOSAL DRAWING	JUN17/20	L.CHAN
B	REDUCE THE OUTSIDE SIZE	AUG07/20	L.CHAN
C	REDESIGN FOR A SHORTER VERSION AND ADD PACKAGE INFORMATION	OCT19/20	L.CHAN
D	UPDATE THE DRAWING	AUG20/21	L.CHAN
E	UPDATE THE COLOR LABEL	MAY12/22	KELVIN

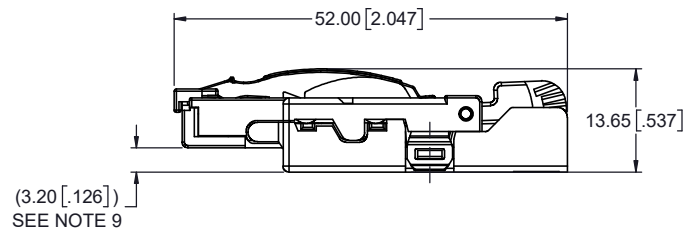
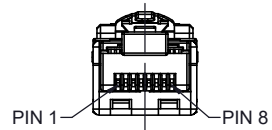
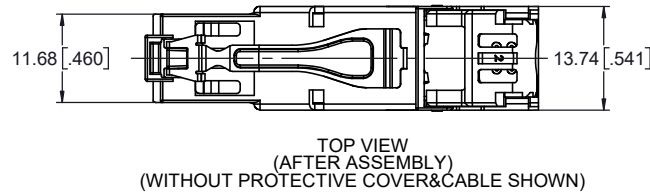
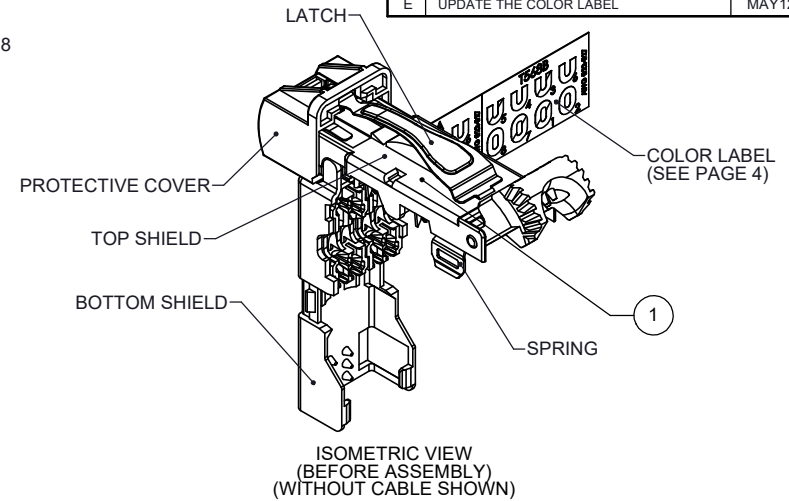
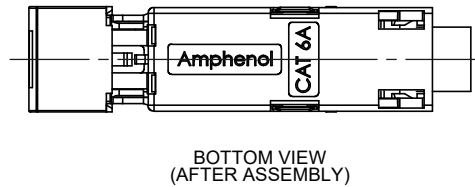
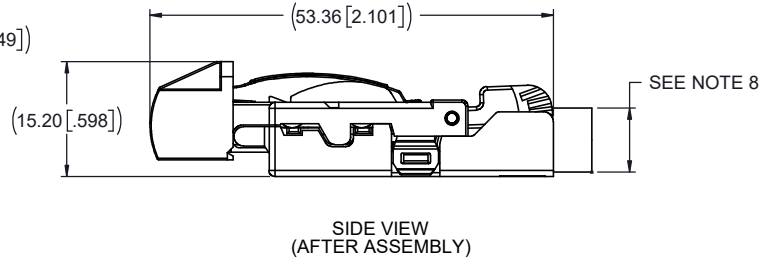
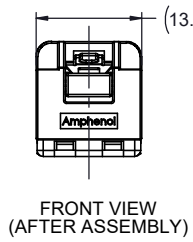

THE COLOR LABEL IS ATTACHED TO THE SHIELD AND CAN BE REMOVED AFTER THE USER ASSEMBLES THE CABLE

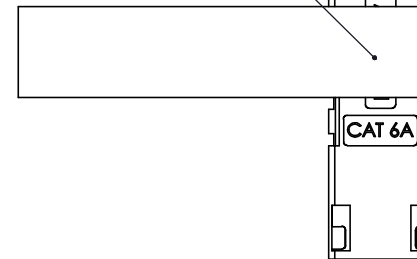

FRONT VIEW

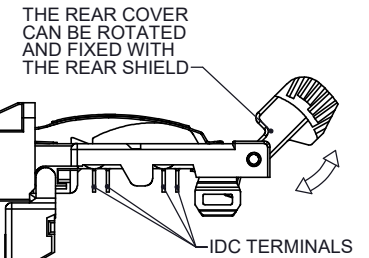

SIDE VIEW

PLUG CONNECTOR ELEMENT
(WITH COLOR LABEL SHOWN)

UNLESS SPECIFIED OTHERWISE	DRAWN	RONNIE.C	JUN17/20
PRIMARY UNITS MILLIMETERS	CHECKED	KELVIN.T	JUN17/20
SECONDARY UNITS INCHES	M.E. APP'D		
REFERENCE IN PARENTHESES	Q.A. APP'D		
GENERAL TOLERANCES	DWG APPR.	A.GREEN	JUN22/20
1 DECIMAL PLACE ±0.50	ENG. REL. NO.		
2 DECIMAL PLACES ±0.38	REF.		
3 DECIMAL PLACES ±0.25	THIRD ANGLE PROJECTION		
ANGULAR DEGREES ±1.5°	DO NOT SCALE DRAWING		

Amphenol Canada Corp. Commercial Products			
INDUSTRIAL CATEGORY 6A RJ45 FIELD TERMINABLE PLUG, ZINC ALLOY SHELL, PLASTIC HOUSING, PROTECTIVE COVER, WIRE SIZE, CABLE EXIT AND GOLD PLATING OPTIONS -RoHS COMPLIANT			
DWG. NO.	P-DRP10-188-XXXXXX		
CODE ID NO.	03554	DWG SIZE: X	SCALE: 2:1
SHEET	3	OF	5

WIRE COLOR							
TIA-568A				TIA-568B			
WHITE/BLUE	BLUE	WHITE/ORANGE	ORANGE	WHITE/BLUE	BLUE	WHITE/GREEN	GREEN
BROWN	WHITE/BROWN	WHITE/GREEN	GREEN	BROWN	WHITE/BROWN	WHITE/ORANGE	ORANGE

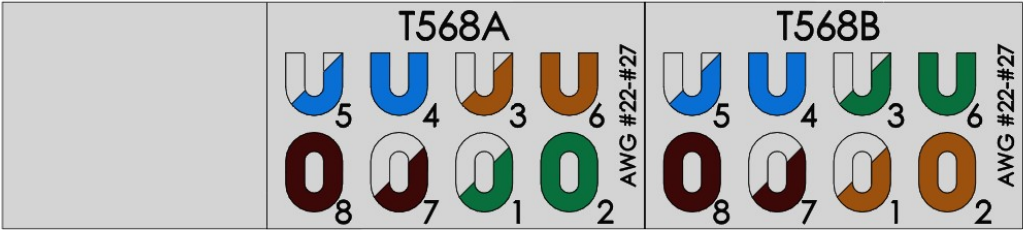

COLOR LABEL
(SCALE 5:1)

AMPHENOL PART NUMBER: DRP10-188-X X X X X

GOLD PLATING OPTION:
2 = 6u" GOLD PLATING
3 = 15u" GOLD PLATING
4 = 30u" GOLD PLATING
5 = 50u" GOLD PLATING

CABLE EXIT DIRECTION:
0 = 45 DEGREE IN 4 DIRECTIONS
1 = 90 DEGREE IN 4 DIRECTIONS
2 = STRAIGHT

PLASTIC & PCB MATERIAL OPTION:
0 = ENGINEERING THERMPLASTIC
1 = HALOGEN FREE PLASTIC & PCB

WIRE AWG OPTION:
1 = AWG 22 TO AWG 23
2 = AWG 24 TO AWG 27

PROTECTIVE COVER OPTION:
0 = WITHOUT PROTECTIVE COVER
1 = WITH PROTECTIVE COVER

HOUSING COLOR OPTION:
0 = BLACK COLOR
1 = BLUE COLOR
2 = RED COLOR
3 = GREEN COLOR
4 = WHITE COLOR
5 = YELLOW COLOR

NOTES:

- MATERIAL:
RJ TERMINAL: COPPER ALLOY,
PLATING: SELECTIVE GOLD PLATING ON MATING SURFACES
SEE PART NO. FOR THICKNESS,
100u" MIN MATTE TIN ON TAILS.
50u" MIN. NICKEL UNDERPLATE.
IDC TERMINAL: COPPER ALLOY,
PLATING: 100u" MIN. MATTE-TIN OVERALL,
50u" MIN. NICKEL UNDERPLATE.
HOUSING: ENGINEERING THERMOPLASTIC, FLAMMABILITY RATING UL 94V-0,
SEE PART NO. FOR COLOR OPTION.
SHIELD: ZINC ALLOY,
PLATING: 200~400u" NICKEL OVERALL,
400~600u" COPPER UNDERPLATE.
LATCH: STAINLESS STEEL
SPRING: STAINLESS STEEL
- ITEM 1 AND 2 ARE PACKED SEPARATELY FOR 45 AND 90 DEGREE VERSIONS.
- 45 DEGREE AND 90 DEGREE PLUG VERSIONS SHARE THE SAME MODULAR FRONT END.
- 45 DEGREE AND 90 DEGREE VERSIONS CAN BE CONFIGURED WITH FOUR DIFFERENT EXIT DIRECTIONS.
- REFER TO AMPHENOL OPERATION INSTRUCTIONS S6179P FOR ASSEMBLY PROCEDURES.
- THIS RJ PLUG CONNECTOR IS SUITABLE FOR $\phi 4.5\text{MM}$ TO $\phi 8.0\text{MM}$ CAT6A CABLE.
- WHEN MATCHING A STACKABLE RJ45 RECEPTACLE , A MINIMUM OF 6.4MM SPACING BETWEEN TOP AND BOTTOM PORTS IS REQUIRED.
- THE PACKAGING SPECIFICATION SEE PAGE 5.

PLUG CONNECTOR CABLE EXIT OPTIONS					REMARK
ITEM	COMPONENTS	45 DEGREE	90 DEGREE	STRAIGHT	
1	PLUG CONNECTOR ELEMENT QTY REQ'D	1	1(SEE NOTE 3)	1	SEE NOTE 2
2	REAR SHIELD SUB ASSEMBLY QTY REQ'D	1	1	N/A	



UNLESS SPECIFIED OTHERWISE	DRAWN	RONNIE.C	JUN17/20
PRIMARY UNITS MILLIMETERS	CHECKED	KELVIN.T	JUN17/20
SECONDARY INCHES	M.E. APP'D		
REFERENCE IN PARENTHESES	O.A. APP'D		
GENERAL TOLERANCES	DWG APPR.	A.GREEN	JUN22/20
1 DECIMAL PLACE ± 0.50	ENG. REL. NO.		
2 DECIMAL PLACES ± 0.38	REF.		
3 DECIMAL PLACES ± 0.25	THIRD ANGLE PROJECTION		
ANGULAR DEGREES $\pm 1.5^\circ$			

Amphenol Canada Corp. Commercial Products INDUSTRIAL CATEGORY 6A RJ45 FIELD TERMINABLE PLUG, ZINC ALLOY SHELL, PLASTIC HOUSING, PROTECTIVE COVER, WIRE SIZE, CABLE EXIT AND GOLD PLATING OPTIONS -RoHS COMPLIANT			
P-DRP10-188-XXXXXX			REV E
CODE ID NO. 03554	DWG SIZE: X	SCALE: 2:1	SHEET 4 OF 5

PLUG CONNECTOR ELEMENT

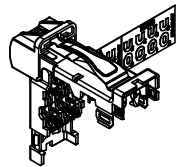

OR

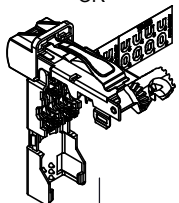

REAR SHIELD SUB ASSEMBLY

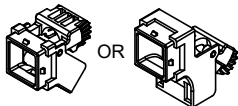

+

OPERATING INSTRUCTION

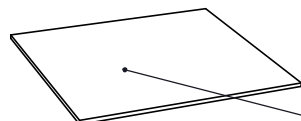

BUBBLE FILM

+

FOAM BOARD

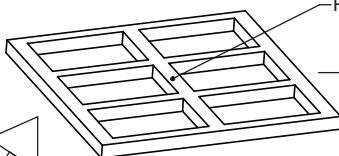

TOTAL 6 PE BAGS

+

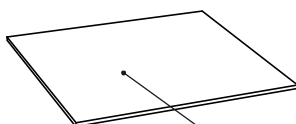

BUBBLE FILM

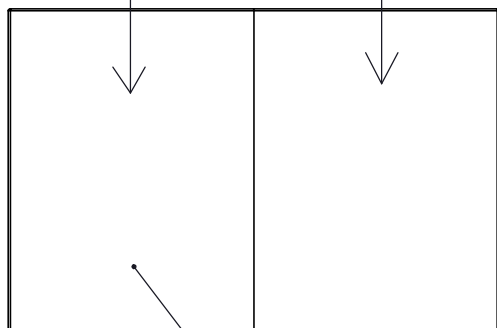

PE BAG

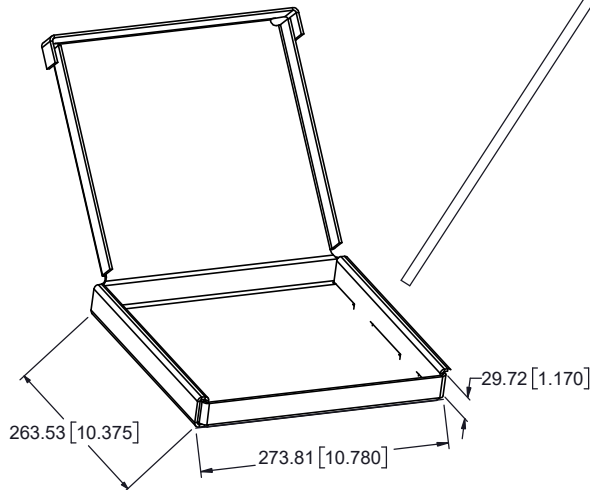

PACKAGING BOX REFERENCE
(DIMENSIONS SHOWN INSIDE OF BOX)

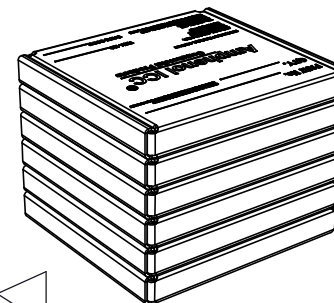

TOTAL 6 PACKAGING BOXES

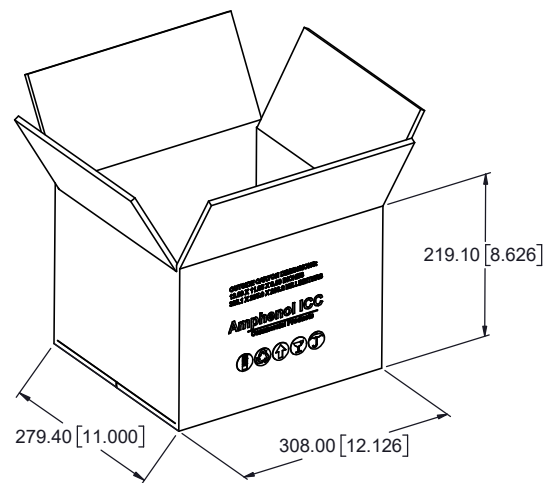

CARTON REFERENCE
(DIMENSIONS SHOWN INSIDE OF CARTON)

PACKAGING NOTES:

1. A PACKAGING BOX LOADED 6PCS CONNECTORS,
2. EACH CARTON CONTAINS 6 BOXES(36 CONNECTORS).

THIS DOCUMENT CONTAINS PROPRIETARY INFORMATION AND SUCH INFORMATION MAY NOT BE DISCLOSED TO OTHERS FOR ANY PURPOSE OR USED FOR MANUFACTURING PURPOSES WITHOUT WRITTEN PERMISSION FROM AMPHENOL CANADA CORP.

REVISIONS			
REV	DESCRIPTION, ECN, EAR NO.	DATE	APP'D
A	PROPOSAL DRAWING	JUN17/20	L.CHAN
B	REDUCE THE OUTSIDE SIZE	AUG07/20	L.CHAN
C	REDESIGN FOR A SHORTER VERSION AND ADD PACKAGE INFORMATION	OCT19/20	L.CHAN
D	UPDATE THE DRAWING	AUG20/21	L.CHAN
E	UPDATE THE COLOR LABEL	MAY12/22	KELVIN

UNLESS SPECIFIED OTHERWISE		DRAWN	RONNIE.C	JUN17/20
PRIMARY UNITS MILLIMETERS		CHECKED	KELVIN.T	JUN17/20
SECONDARY UNITS INCHES		M.E. APP'D		
REFERENCE IN PARENTHESES		Q.A. APP'D		
GENERAL TOLERANCES		DWG APPR.	A.GREEN	JUN22/20
1 DECIMAL PLACE		ENG. REL. NO.		
2 DECIMAL PLACES		REF.		
3 DECIMAL PLACES				
ANGULAR DEGREES		THIRD ANGLE PROJECTION		
		DO NOT SCALE DRAWING		

Amphenol Canada Corp. Commercial Products			
INDUSTRIAL CATEGORY 6A RJ45 FIELD TERMINABLE PLUG, ZINC ALLOY SHELL, PLASTIC HOUSING, PROTECTIVE COVER, WIRE SIZE, CABLE EXIT AND GOLD PLATING OPTIONS -RoHS COMPLIANT			
P-DRP10-188-XXXXXX			REV E
CODE ID NO. 03554	DWG SIZE: X	SCALE: 2:1	SHEET 5 OF 5