

SECTION A-A
 SCALE 2:1

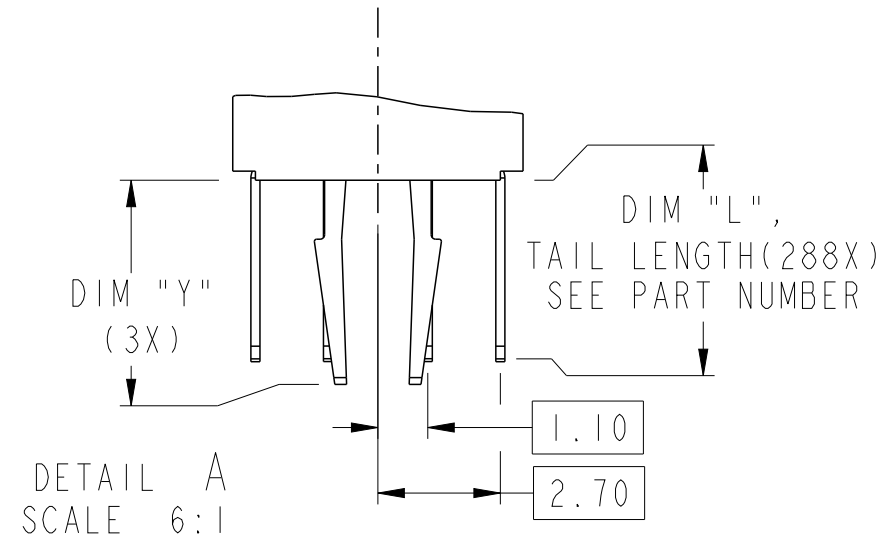

spec ref	dr	Art Lin	2014/07/08	projection	MM	size	A3	scale	2:1
tolerance std	eng	Girder Liang	2019/03/26			ecn no	ELX-DG-33011-1		
TOLERANCES UNLESS OTHERWISE SPECIFIED linear	chr	-	-			rel level	Released		
	ASME Y14.5	appr	Nickor Zuo	2019/03/29	product family	-	rel level	Released	
surface	linear	0.X	±0.30	Amphenol FCI www.fci.com		cat. no.	-	Product - Customer Drw	sheet 1 of 4
	angular	0°	±2°	DDR4 288P DIMM CONNECTOR ULP TH 0.85mm PITCH		dwg no	10129206	rev	D

DDR4 MODULE
 MORE INFORMATION REFER TO JEDEC MO-309

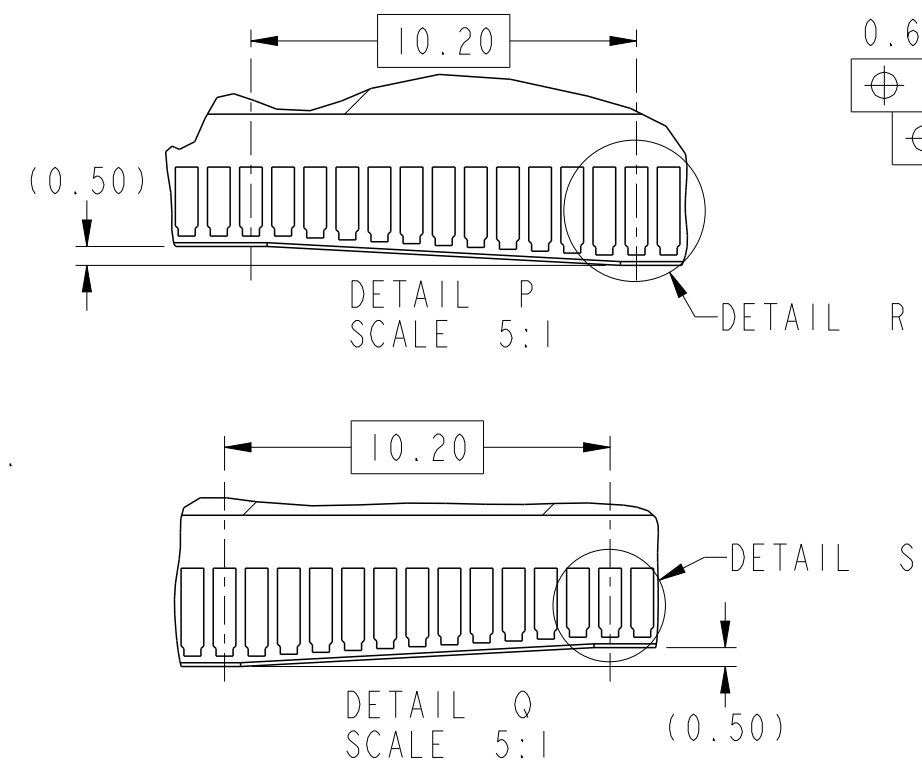
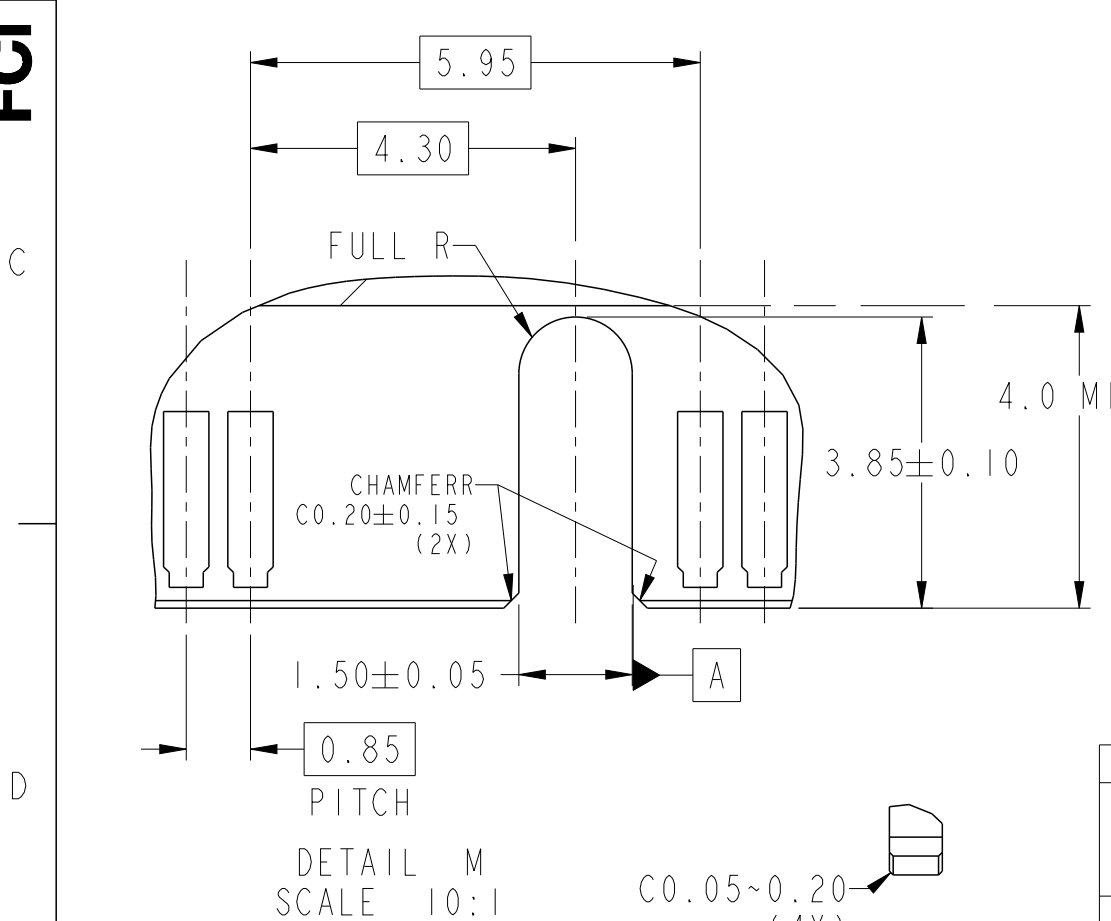
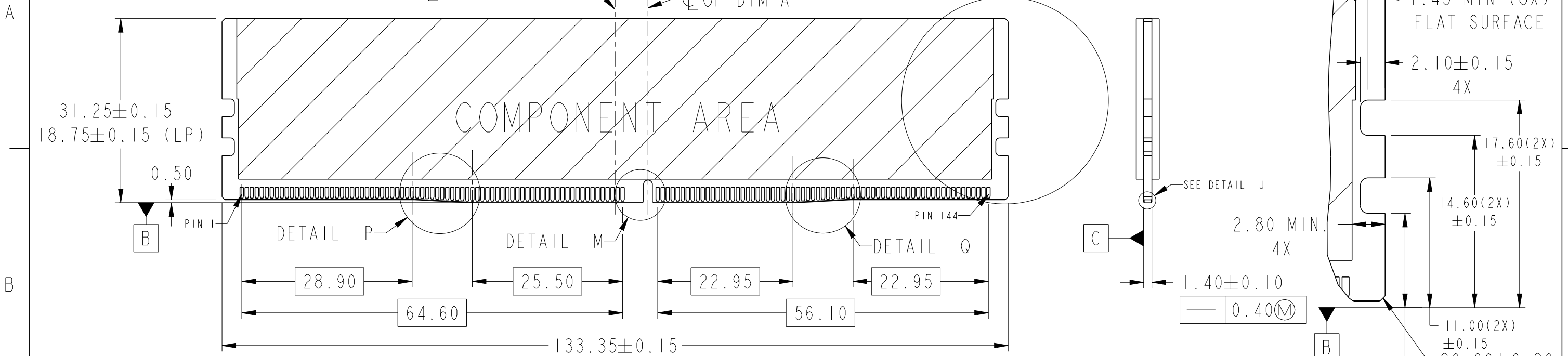

spec ref	dr	Art Lin	2014/07/08	projection	MM	size	A3	scale	3:2
tolerance std	eng	Girder Liang	2019/03/26			ecn no	ELX-DG-33011-1	rel level	Released
ASME Y14.5	chr	-	-			product family	-		
TOLERANCES UNLESS OTHERWISE SPECIFIED	appr	Nickor Zuo	2019/03/29	Amphenol FCI www.fci.com		DDR4 288P DIMM CONNECTOR ULP TH 0.85mm PITCH		cat. no. - Product - Customer Drw	dwg no 10129206
ASME Y14.5	surface	linear	0.X ±0.30 0.XX ±0.20 0.XXX ±0.10	rev D		sheet 2 of 4		angular 0° ±2°	

© 2016 AFCI
 Amphenol FCI

RECOMMENDED PCB LAYOUT
 MORE INFORMATION REFER TO JEDEC SO-016

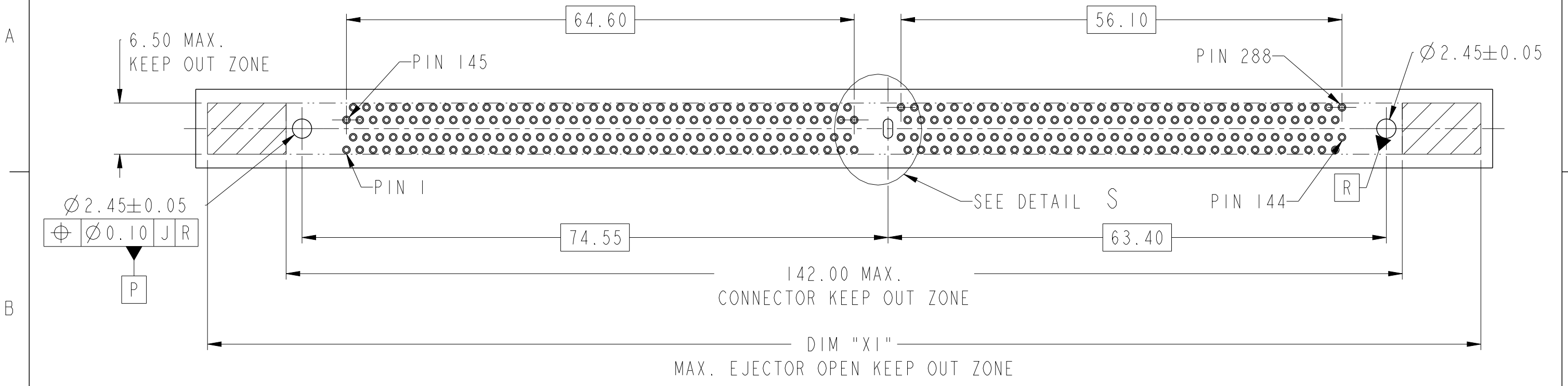

Amphenol
FCi

© 2016 AFCI

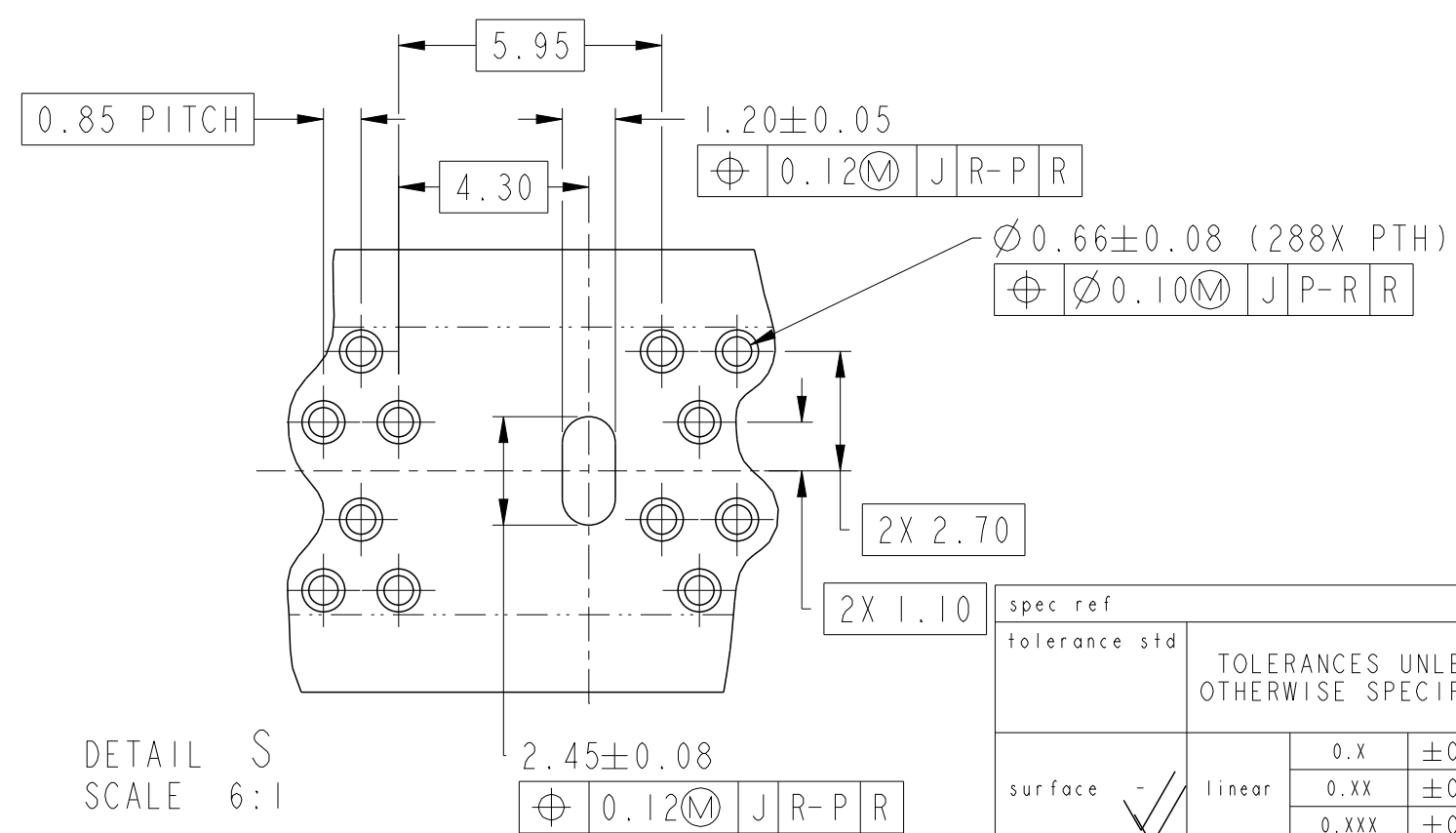

DETAIL S
 SCALE 6:1

spec ref	dr	Art Lin	2014/07/08	projection	MM	size	A3	scale	2:1
tolerance std	eng	Girder Liang	2019/03/26			ecn no	ELX-DG-33011-1	rel level	Released
TOLERANCES UNLESS OTHERWISE SPECIFIED		chr	-			product family	-		
surface	linear	ASME Y14.5	angular	0°	±2°	Amphenol FCi	www.fci.com	cat. no.	-
						DDR4 288P DIMM CONNECTOR	ULP TH 0.85mm PITCH	dwg no	10129206
						Product - Customer Drw	rev	D	sheet 3 of 4

PRODUCT PART NUMBER

10129206-□□□□□□□□

DIM "H", "XI"

- 0: H=19.3 MAX, XI=156 MAX. (WITH THE SOFT TRAY PACKING)
- 1: H=13.1 MAX, XI=152 MAX. (WITH THE SOFT TRAY PACKING)
- 2: H=19.3 MAX, XI=156 MAX. (WITH THE HARD TRAY PACKING)

DIM "Y", FORKLOCK LENGTH

- 0: 3 FORKLOCKS, DIM "Y"=4.00±0.25
- 1: 3 FORKLOCKS, DIM "Y"=4.50±0.25
- 2: 3 FORKLOCKS, DIM "Y"=3.20±0.25

DIM "L", TAIL LENGTH

- 0: 2.60±0.25
- 1: 3.20±0.25
- 2: 4.00±0.25
- 3: 2.95±0.25

HOUSING COLOR

- 0: NATURAL
- 1: BLACK
- 2: BLUE

EJECTOR COLOR

- 0: NATURAL
- 1: BLACK
- 2: BLUE

TAIL PLATING

LF: 100u" MIN. MATTE TIN

CONTACT AREA PLATING

CODE	CONTACT AREA	UNDERPLATING
1	15u" MIN. GOLD	90u" MIN. NICKEL
3	30u" MIN. GOLD	

CONTACTS LUBRICATION

- 0: WITHOUT
- 1: WITH

NOTES:

1. MATERIALS:
HOUSING: HIGH PERFORMANCE RESINS, GLASS FIBER FILLED, UL94 V-0 RATED.
EJECTOR: HIGH PERFORMANCE RESINS, GLASS FIBER FILLED, UL94 V-0 RATED.
TERMINAL: COPPER ALLOY
FORKLOCK: COPPER ALLOY
2. DATE CODE "MMDDYYL", MMDDYY IS ASSEMBLY DATE, L IS FCI PRODUCTION LINE.
3. SPECIFICATION:
PRODUCTION SPECIFICATION: FCI GS-12-1092.
PACKAGE SPECIFICATION: FCI GS-14-2267.
APPLICATION SPECIFICATION: FCI GS-20-0353.
4. LEAD FREE PRODUCT MEETS EUROPEAN UNION DIRECTIVES AND OTHER COUNTRY REGULATIONS AS DESCRIBED IN FCI GS-22-008.
5. THIS PRODUCT WILL WITHSTAND EXPOSURE TO 260°C PEAK TEMPERATURE FOR 10 SECONDS IN WAVE SOLDERING APPLICATION.

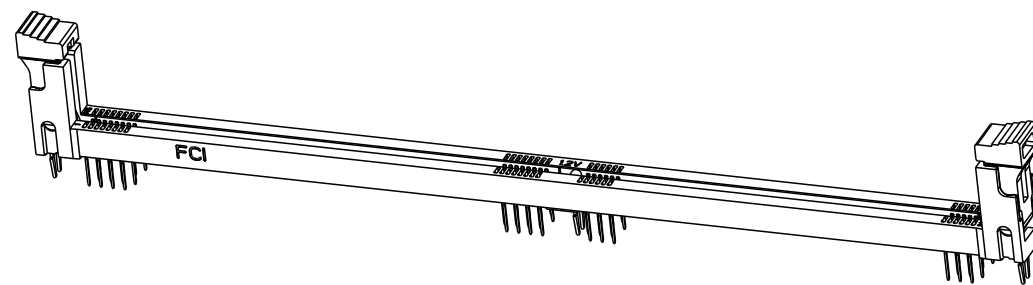

10129206-0XXXXXXXX/2XXXXXXXX

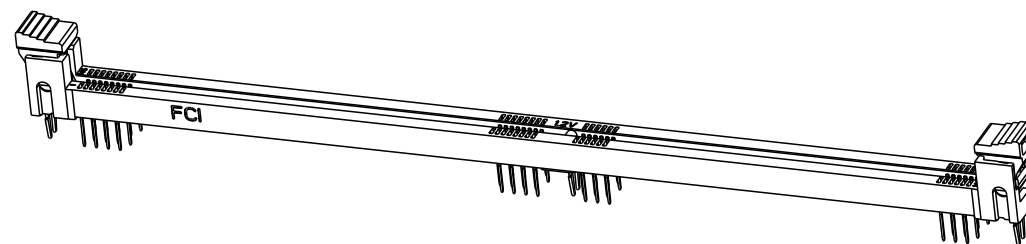

10129206-1XXXXXXXX ✓

dr	Art Lin	2014/07/08	projection	MM	size	A3	scale	1:1
eng	Girder Liang	2019/03/26			ecn no	ELX-DG-33011-1		
chr	-	-			rel level	Released		
appr	Nickor Zuo	2019/03/29	product family					
Amphenol FCI		DDR4 288P DIMM CONNECTOR ULP TH 0.85mm PITCH			dwg no 10129206	rev D		
www.fci.com		cat. no.	Product - Customer Drw			sheet 4 of 4		