

ITEM	DESCRIPTION	MATERIAL	FINISH
1	BODY	ZINC ALLOY	NICKEL PLATE
2	FRONT INSERT	PBT	BLACK
3	PINS (3/4/5)	BRASS	SILVER PLATE
4	GROUND	BRASS	SILVER PLATE
5	REAR COVER	PA6	BLACK
6	PRESSURE CAP	PP	BLACK
7	GROMMET	PVC	BLACK
8	CABLE CLAMP	POM	BLACK

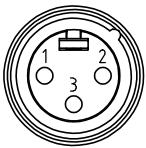

ISS.	AMEND	DATE
1	1st DRAWN	09/07/03
2	SPEC CHANGES	04/03/16
3	UPDATE	27/02/23

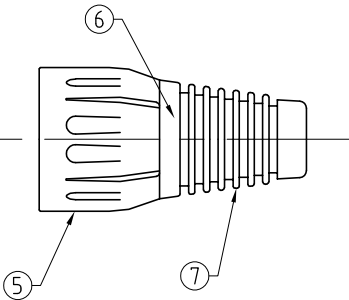
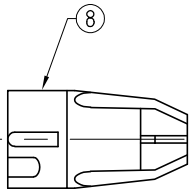
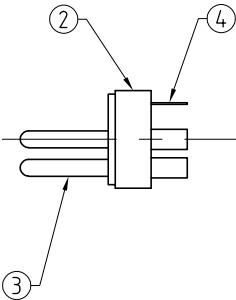
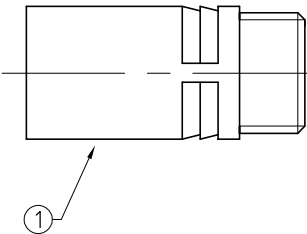
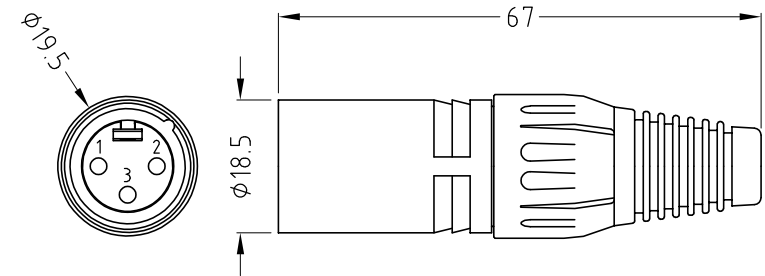

3APM/M
FC6130

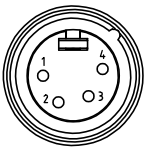

4APM/M
FC6155

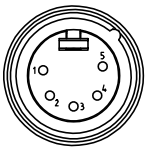

5APM/M
FC6160



SPECIFICATION							
PART NUMBER	POLE	MAX CURRENT @25°C (A)	MAX CABLE (mm²)	C (Pf)	CONTACT RESISTANCE (mΩ)	INSULATION RESISTANCE (MΩ)	WITHSTAND VOLTAGE (V)
FC6130	3	16	2.5	<4	<5	>5000	1400
FC6155	4	10	1.0	<7	<7	>5000	1400
FC6160	5	7.5	1.0	<7	<7	>5000	1400

RoHS COMPLIANT
TOLERANCE NO DEC. PLACE ± 1 DEC. PLACE ± 2 DEC. PLACE ± HOLE Ø ± ANGLES ± UNLESS OTHERWISE STATED

Cliff Electronic Components Ltd.
76 Holmethorpe Avenue, Holmethorpe Industrial Estate,
Redhill, Surrey, RH1 2PF, England, UK
Tel: 01737-771375 Fax: 01737-766012 Website: www.cliffuk.co.uk

DIMENSIONS IN MILLIMETERS UNLESS OTHERWISE STATED. WORK TO DIMENSIONS. REMOVE ALL BURRS. IF IN DOUBT ASK.

3rd ANGLE PROJECTION:

DO NOT SCALE

MATERIAL: SEE TABLE

TITLE: METAL XLR PLUG (MALE) APM/M (3/4/5 POLE)

FINISH: SEE TABLE

DRWG. No. FC6130

FORM: A4DRWGH

THE CONTENTS OF THIS DOCUMENT MUST NOT BE COPIED OR DISCLOSED TO A 3rd PARTY WITHOUT WRITTEN PERMISSION OF CLIFF UK. © 2003

DRAWN: CAMJ

APPROVED: RWT