

ORDERING CODE: **MHDR - A311 - 301**

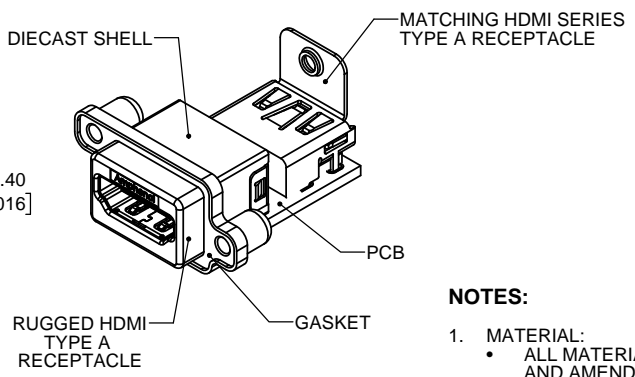
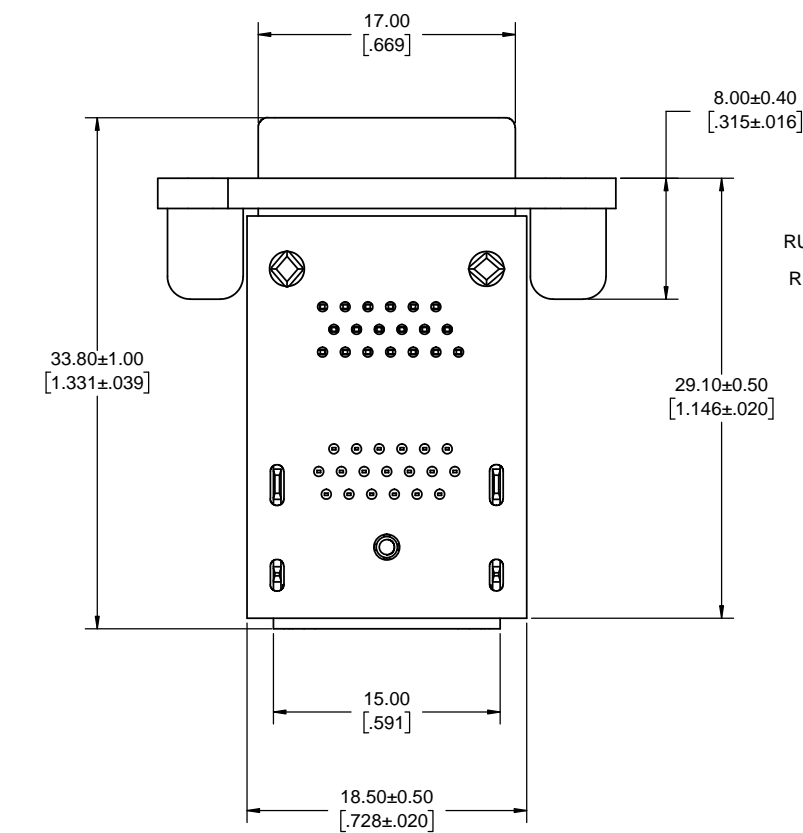

SERIES, RUGGED HDMI
HDMI TYPE 'A' RECEPTACLE, RIGHT ANGLE, ON PCB WITH MATCHING HDMI TYPE A RECEPTACLE
SHELL THREAD OPTION
3 = #4-40 THREAD
DUST COVER OPTION
0 = NO DUST COVERS SUPPLIED
UNIQUE SPECIAL CODE
1 = MATCHING HDMI WITH M3 THREADED SHIELD TAB

NOTES:

- MATERIAL:**
 - ALL MATERIALS ARE RoHS COMPLIANT PER EU DIRECTIVE 2011/65/EU AND AMENDMENTS
 - OUTER SHELL - DIECAST ZINC ALLOY, MATTE TIN OVER NICKEL PLATED
 - CONTACTS - COPPER ALLOY, PLATED WITH 0.76µm (30µ") GOLD OVER 1.27µm (50µ") MINIMUM NICKEL ON THE MATING AREA WITH MATTE TIN OVER NICKEL ON THE TAILS.
 - HDMI HOUSING - ENGINEERING THERMOPLASTIC, HIGH TEMPERATURE RESISTANT, FLAMMABILITY RATING UL94V-0, BLACK
 - HDMI SHIELD & BACK COVER - STAINLESS STEEL, PASSIVATED
 - GASKET - CONDUCTIVE SILICONE RUBBER, BLACK
 - PCB - FR-4 FIBREGLASS, LEAD FREE, UL94V-0 FLAMMABILITY RATING.
 - HDMI CONNECTOR - BLACK THERMOPLASTIC HOUSING, COPPER ALLOY CONTACTS WITH GOLD OVER NICKEL ON MATING AREA AND COPPER ALLOY SHELL WITH TIN OVER NICKEL PLATING.
- ENVIRONMENTAL PERFORMANCE PER IEC 60529 CODE IP67 FOR SEAL BETWEEN MATING AREA AND PCB SIDE OF CONNECTOR. GASKET PROVIDES SEAL TO INSIDE FACE OF ENCLOSURE PANEL.
- CURRENT & VOLTAGE RATING: 0.5 AMPERES, 40 VAC RMS.
- CONTACT RESISTANCE: 80 MILLIOHMS MAXIMUM, (SUBJECT TO VERIFICATION).
- OPERATING TEMPERATURE: -55°C TO +105°C.

THIS DOCUMENT CONTAINS PROPRIETARY INFORMATION AND SUCH INFORMATION MAY NOT BE DISCLOSED TO OTHERS FOR ANY PURPOSE OR USED FOR MANUFACTURING PURPOSES WITHOUT WRITTEN PERMISSION FROM AMPHENOL CANADA CORP.

UNLESS SPECIFIED OTHERWISE		DRAWN	I.GREWAL	SEP22/16	<div>Amphenol Canada Corp.</div> <div>www.amphenolcanada.com</div> <div>MHDR SERIES, RUGGED HDMI TYPE A RECEPTACLE, RIGHT ANGLE, 4-40 THREAD, ON PCB WITH HDMI M3 SHIELD TAB CONNECTOR, RoHS COMPLIANT</div>			
PRIMARY UNITS MILLIMETERS		CHECKED						
SECONDARY INCHES		M.E. APP'D						
REFERENCE IN PARENTHESES		Q.A. APP'D						
GENERAL TOLERANCES		DWG APPR.	K. LAMBIE	SEP22/16	<div>DWG. NO.</div> <div>P-MHDR-A311-301</div> <div>REV A</div>			
1 DECIMAL PLACE		ENG. REL. NO.		EAR 14491				
2 DECIMAL PLACES ±0.15		REF.						
3 DECIMAL PLACES		THIRD ANGLE PROJECTION						
ANGULAR DEGREES					<div>CODE ID NO. 03554</div> <div>DWG SIZE: X</div> <div>SCALE: 4:1</div> <div>SHEET 1 OF 2</div>			

REVISIONS			
REV	DESCRIPTION, ECN, EAR NO.	DATE	APP'D
A	PROPOSAL DRAWING (EAR 14491)	SEP22/16	K.L.

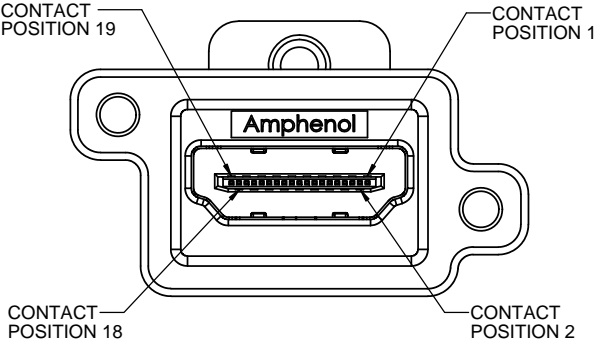

MHDR CONTACT ASSIGNMENT

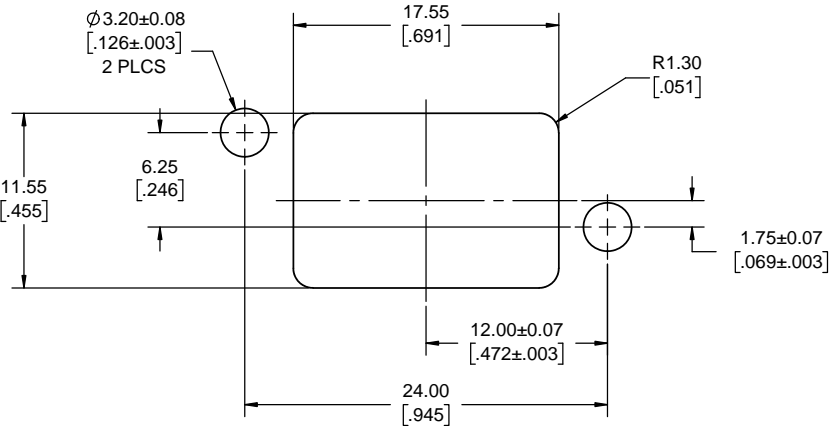

RECOMMENDED PANEL CUTOUT
OUTSIDE VIEW OF PANEL

MHDR TO HDMI
CONNECTION CHART

RUGGED HDMI CONNECTOR POSITION #	STANDARD HDMI CONNECTOR POSITION #
SHELL/GROUND	SHELL/GROUND
1	1
2	2
3	3
4	4
...	...
19	19

ALL CONNECTIONS 1 TO 1
UP TO 19 TO 19

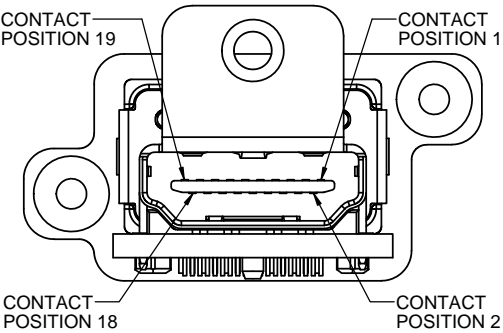

HDMI CONTACT ASSIGNMENT



UNLESS SPECIFIED OTHERWISE	DRAWN	I.GREWAL	SEP22/16
PRIMARY UNITS MILLIMETERS	CHECKED		
SECONDARY INCHES	M.E. APP'D		
REFERENCE IN PARENTHESES	Q.A. APP'D		
GENERAL TOLERANCES	DWG APPR.	K. LAMBIE	SEP22/16
1 DECIMAL PLACE	ENG. REL. NO.	EAR 14491	
2 DECIMAL PLACES ± 0.15	REF.		
3 DECIMAL PLACES	THIRD ANGLE PROJECTION		
ANGULAR DEGREES	DO NOT SCALE DRAWING		

Amphenol Canada Corp. www.amphenolcanada.com			
MHDR SERIES, RUGGED HDMI TYPE A RECEPTACLE, RIGHT ANGLE, 4-40 THREAD, ON PCB WITH HDMI M3 SHIELD TAB CONNECTOR, RoHS COMPLIANT			
P-MHDR-A311-301			REV A
CODE ID NO. 03554	DWG SIZE: X	SCALE: 4:1	SHEET 2 OF 2