

ASSEMBLY - VIEW FROM FRONT

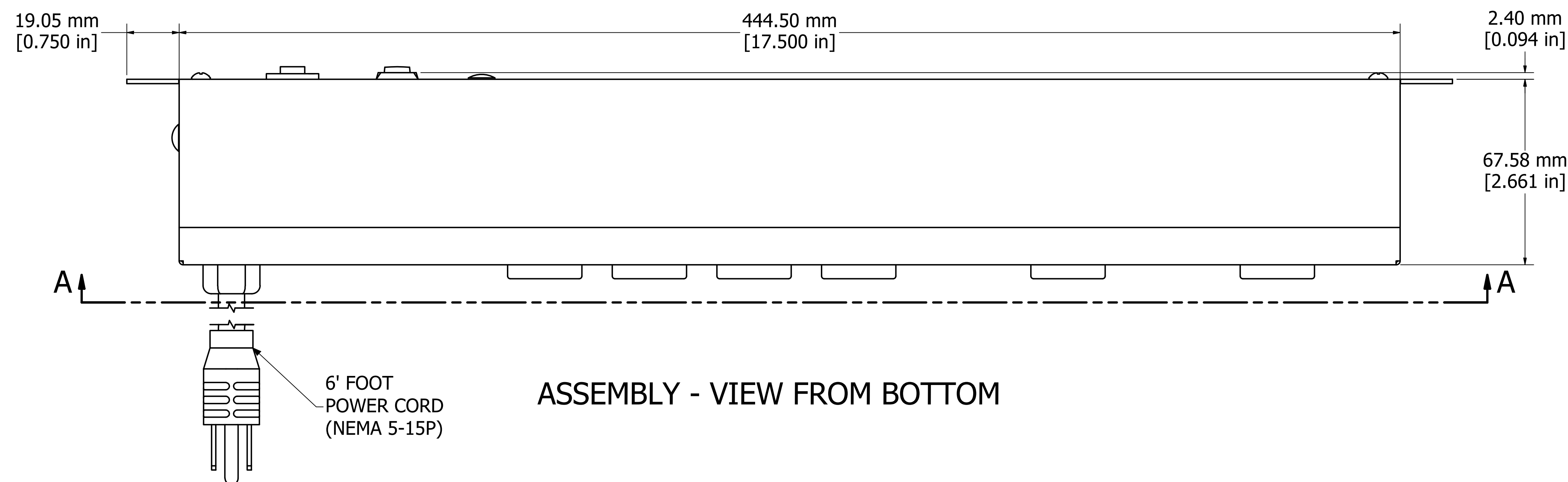

ASSEMBLY - VIEW FROM BOTTOM

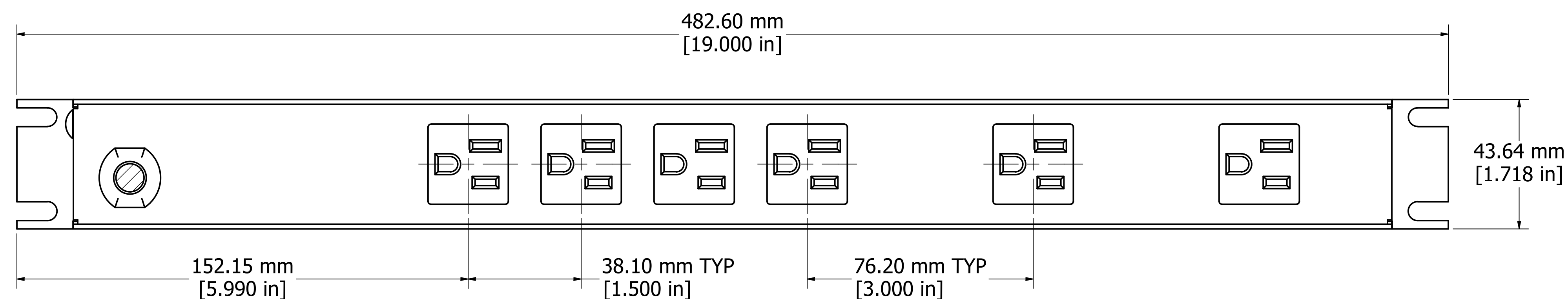

SECTION A-A

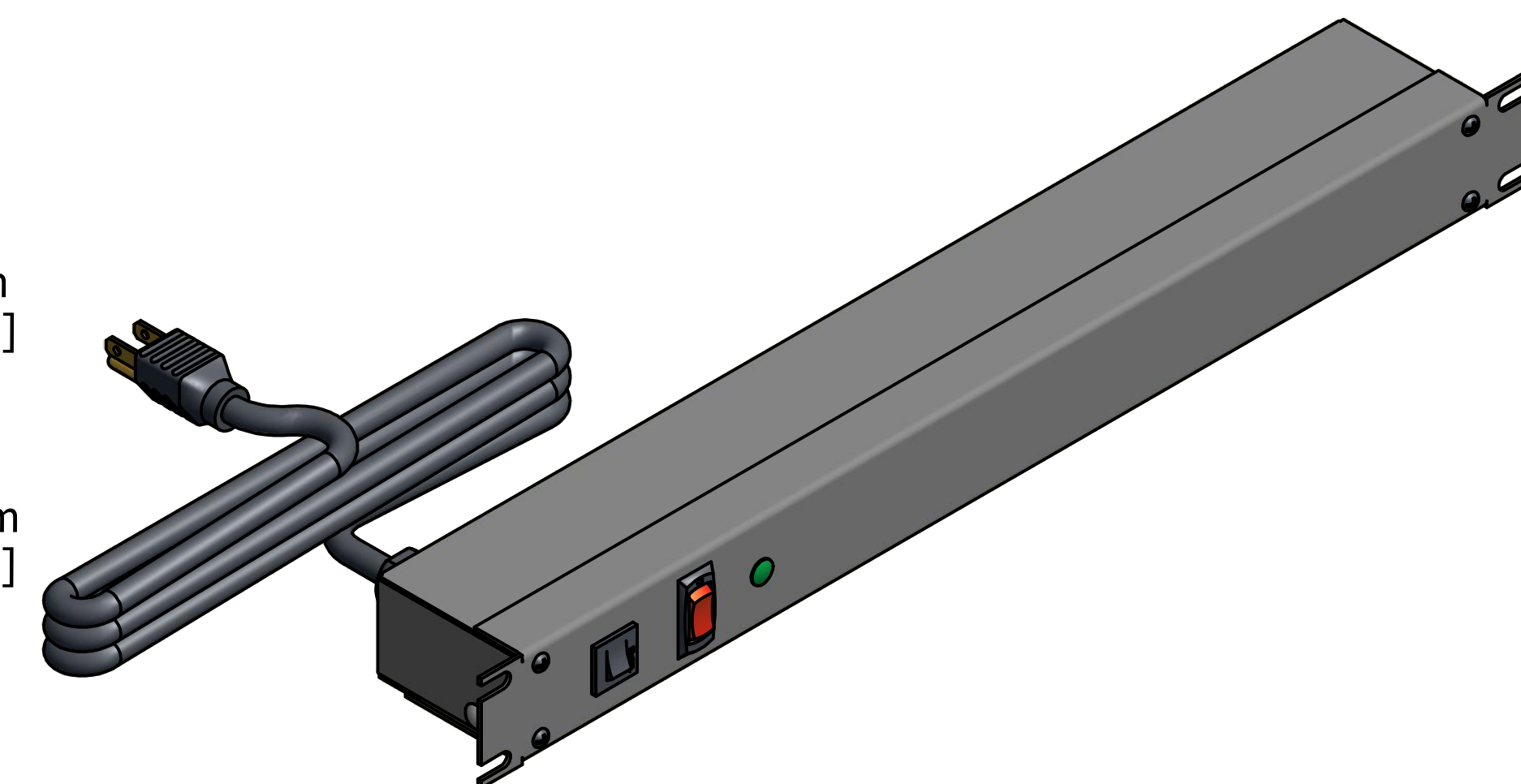

ISOMETRIC VIEW

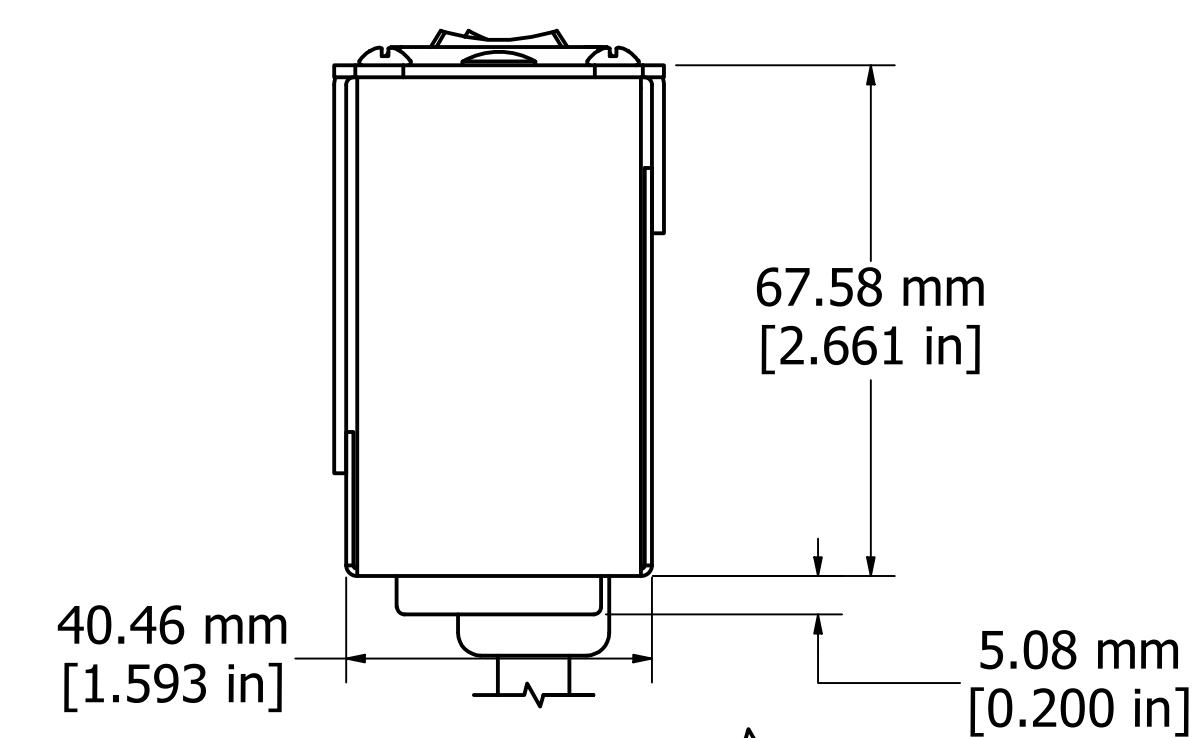

ASSEMBLY - VIEW FROM SIDE

1583H6A1S
Finish - Front - ASA 61 Grey Painted Steel
Back - ASA 61 Grey Painted Steel
Rated - 125 VAC, 60 Hz, 15 Amps
Approvals - cURus Recognized to: UL1449 & C22.2 No. 269.3-17
Surge Specs - 1080 Joules, 75000 Amps Transient Current
- 500V Voltage Protection Rating (VPR)

